

F.A.I. RTE	SECTION	COUNTY	TOTAL SHEETS	SHEET NO.
80/94	*	COOK	870	103
STA. 18+375		TO STA. 18+725		
FED ROAD DIST. NO.		ILLINOIS FED. AID PROJECT		

NOTE:
 AVAILABLE EXISTING TEMPORARY CONCRETE BARRIER SHALL BE USED FOR THE STAGE CONFIGURATION SHOWN AND PAID FOR AS RELOCATE TEMPORARY CONCRETE BARRIER (SPECIAL) (M704002).
 ALL SURPLUS TEMPORARY CONCRETE BARRIER NOT NEEDED FOR THIS STAGE OR FUTURE STAGES SHALL BE REMOVED AND PAID FOR AS REMOVE TEMPORARY CONCRETE BARRIER (MX704200). (SEE DWG. MT-2 FOR TEMPORARY CONCRETE BARRIER SCHEDULE)

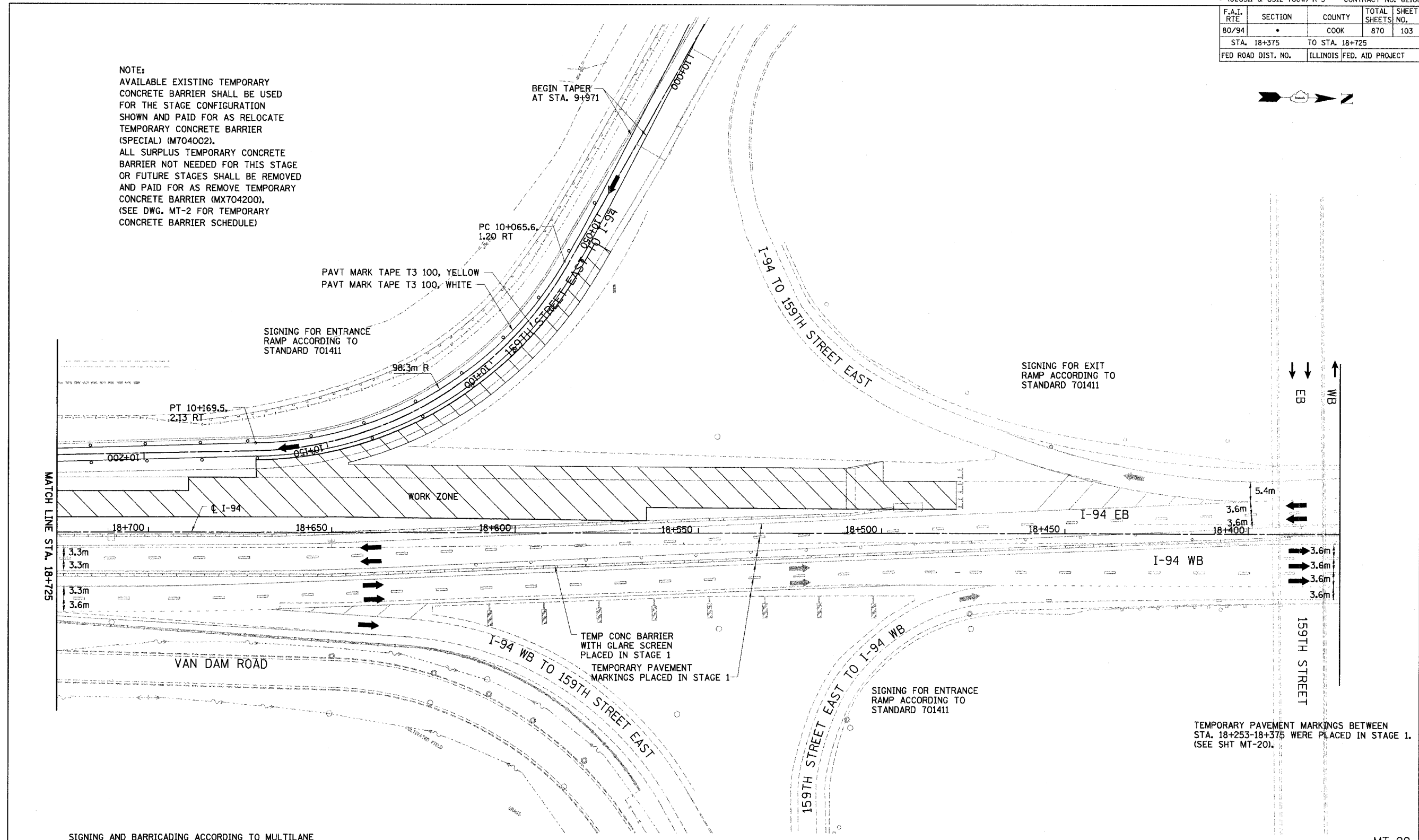

SIGNING AND BARRICADING ACCORDING TO MULTILANE WEAVE DETAIL FOR BOTH EB AND WB I-94

LEGEND	
	WORK ZONE
	TEMPORARY PAVEMENT
	TRAFFIC DIRECTION
	LANE CLOSURE
	DRUMS WITH STEADY BURN LIGHTS
	VERTICAL PANELS
	TYPE III BARRICADE WITH 2 FLASHING LIGHTS

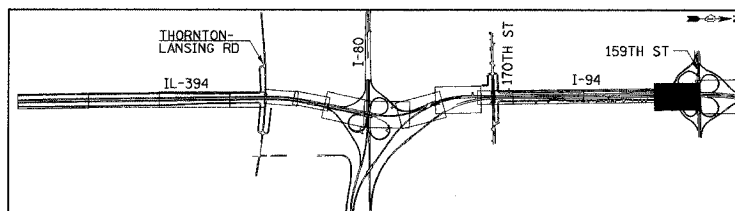

REVISIONS	
NAME	DATE

ILLINOIS DEPARTMENT OF TRANSPORTATION
 I-94 EAST BOUND / IL 394 SOUTH BOUND

MT-29

MAINTENANCE OF TRAFFIC
 I-94 - STAGE 2
 STA. 18+375 TO STA. 18+725

HORIZ SCALE: 1:500
 VERT SCALE: NONE
 DATE: JULY 18, 2005

DRAWN BY: STS
 CHECKED BY: JES

HNTB