

F.A.I. RTE.	SECTION	COUNTY	TOTAL SHEETS NO.	SHEET NO.
80/94	*	COOK	870	148
STA.		TO STA.		
FED ROAD DIST. NO.		ILLINOIS FED. AID PROJECT		

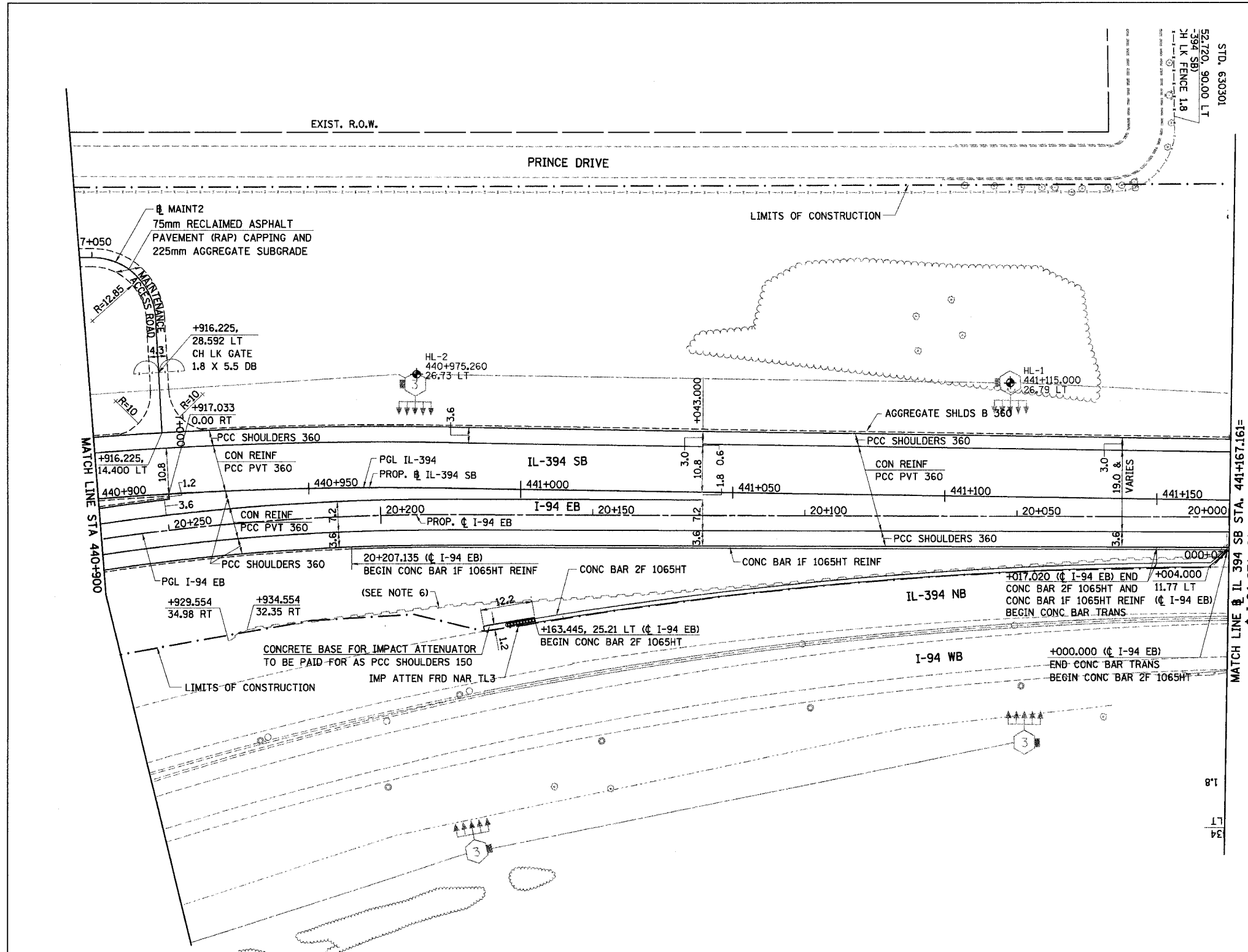

- NOTES:
1. ALL STATIONING AND OFFSET MEASUREMENTS OFF @ IL-394 SB UNLESS OTHERWISE NOTED
 2. ALL DIMENSIONS ARE IN METERS (m) UNLESS OTHERWISE NOTED.
 3. ALL TREE DIAMETERS ARE IN MILLIMETERS (mm) UNLESS OTHERWISE NOTED.
 4. WHERE EXISTING SIGNS INTERFERE WITH CONSTRUCTION OPERATIONS, SEE ARTICLE 107.25 OF THE STANDARD SPECIFICATIONS.
 5. SEE CONTRACT 62664 FOR LIGHTING REMOVAL.
 6. ADD GEOTECHNICAL FABRIC FOR FRENCH DRAINS ON FRONT FACE OF EXISTING MSE RETAINING WALL. SEE SHEETS 707A & 707B FOR DETAILS.

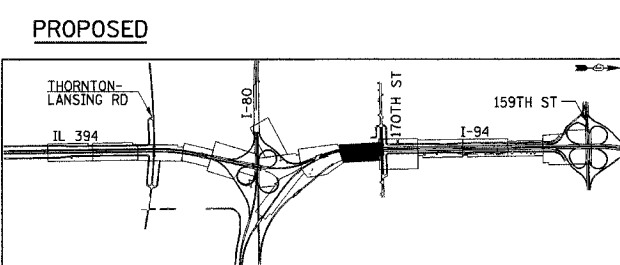

REVISIONS	
NAME	DATE

ILLINOIS DEPARTMENT OF TRANSPORTATION
 I-94 EAST BOUND / IL 394 SOUTH BOUND

PROPOSED PLAN
 IL-394 SB
 STA. 440+900 TO STA. 441+167.161

HORIZ SCALE: 1:500
 VERT SCALE:
 DATE: JULY 18, 2005

DRAWN BY: BAJ
 CHECKED BY: JES

HNTB