

F.A.I. RTE	SECTION	COUNTY	TOTAL SHEETS NO.	SHEET NO.
80/94		COOK	870	152
STA.	TO STA.			
FED ROAD DIST. NO.	ILLINOIS FED. AID PROJECT			

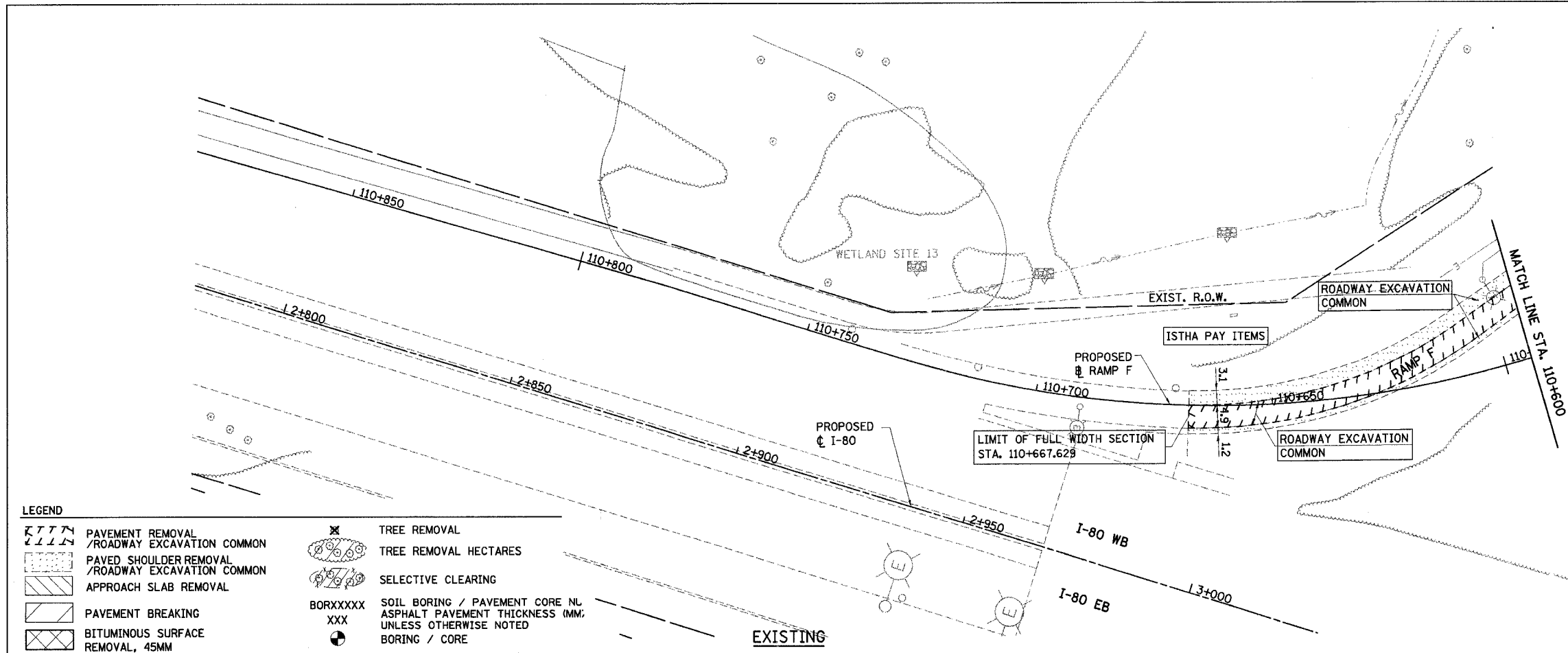

LEGEND

	PAVEMENT REMOVAL /ROADWAY EXCAVATION COMMON		TREE REMOVAL
	PAVED SHOULDER REMOVAL /ROADWAY EXCAVATION COMMON		TREE REMOVAL HECTARES
	APPROACH SLAB REMOVAL		SELECTIVE CLEARING
	PAVEMENT BREAKING		BORXXXXX XXX SOIL BORING / PAVEMENT CORE NL ASPHALT PAVEMENT THICKNESS (MM); UNLESS OTHERWISE NOTED BORING / CORE
	BITUMINOUS SURFACE REMOVAL, 45MM		

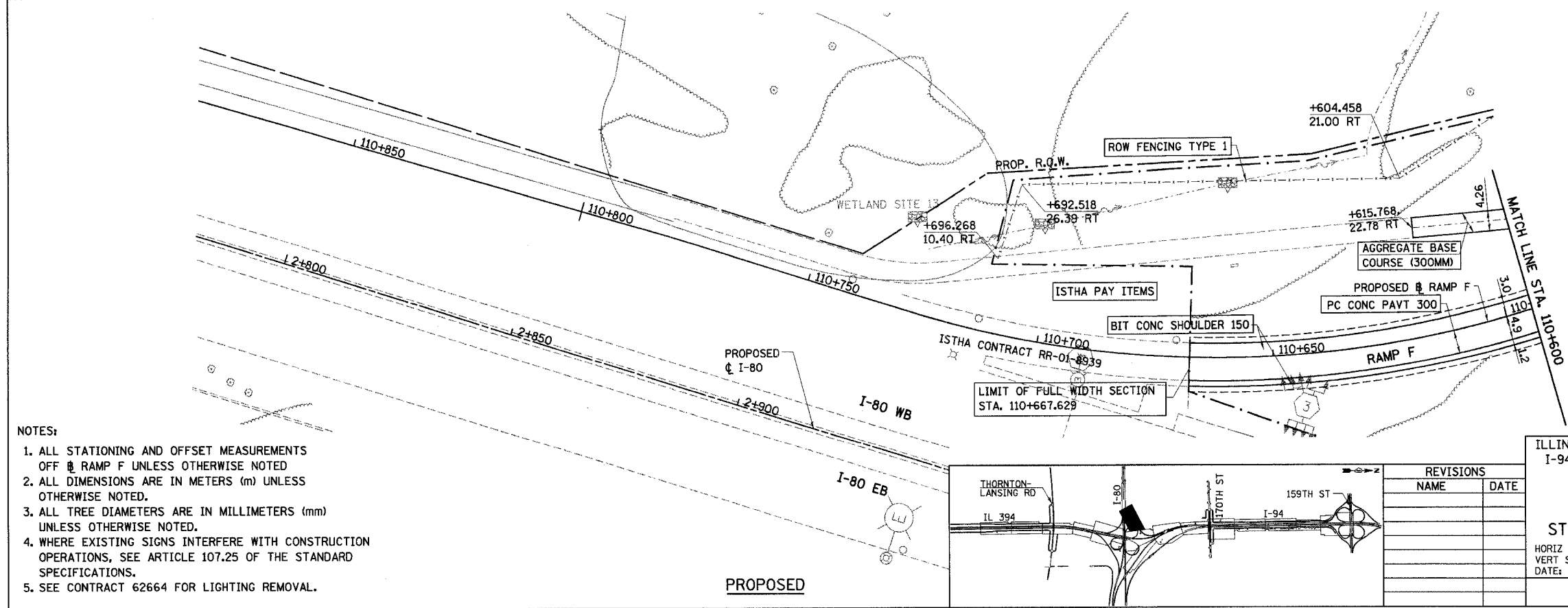

- NOTES:**
1. ALL STATIONING AND OFFSET MEASUREMENTS OFF RAMP F UNLESS OTHERWISE NOTED
 2. ALL DIMENSIONS ARE IN METERS (m) UNLESS OTHERWISE NOTED.
 3. ALL TREE DIAMETERS ARE IN MILLIMETERS (mm) UNLESS OTHERWISE NOTED.
 4. WHERE EXISTING SIGNS INTERFERE WITH CONSTRUCTION OPERATIONS, SEE ARTICLE 107.25 OF THE STANDARD SPECIFICATIONS.
 5. SEE CONTRACT 62664 FOR LIGHTING REMOVAL.

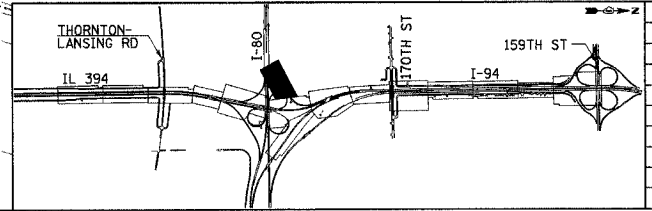

REVISIONS	
NAME	DATE

ILLINOIS DEPARTMENT OF TRANSPORTATION
I-94 EAST BOUND / IL 394 SOUTH BOUND

**PROPOSED PLAN
RAMP F
STA. 110+600 TO STA. 110+750**

HORIZ SCALE: 1:500
VERT SCALE: 1:500
DATE: JULY 18, 2005

DRAWN BY: BAJ
CHECKED BY: JES

HNTB