

F.A.I. RTE 80/94	SECTION •	COUNTY COOK	TOTAL SHEETS 870	SHEET NO. 163
STA.		TO STA.		
FED ROAD DIST. NO.		ILLINOIS FED. AID PROJECT		

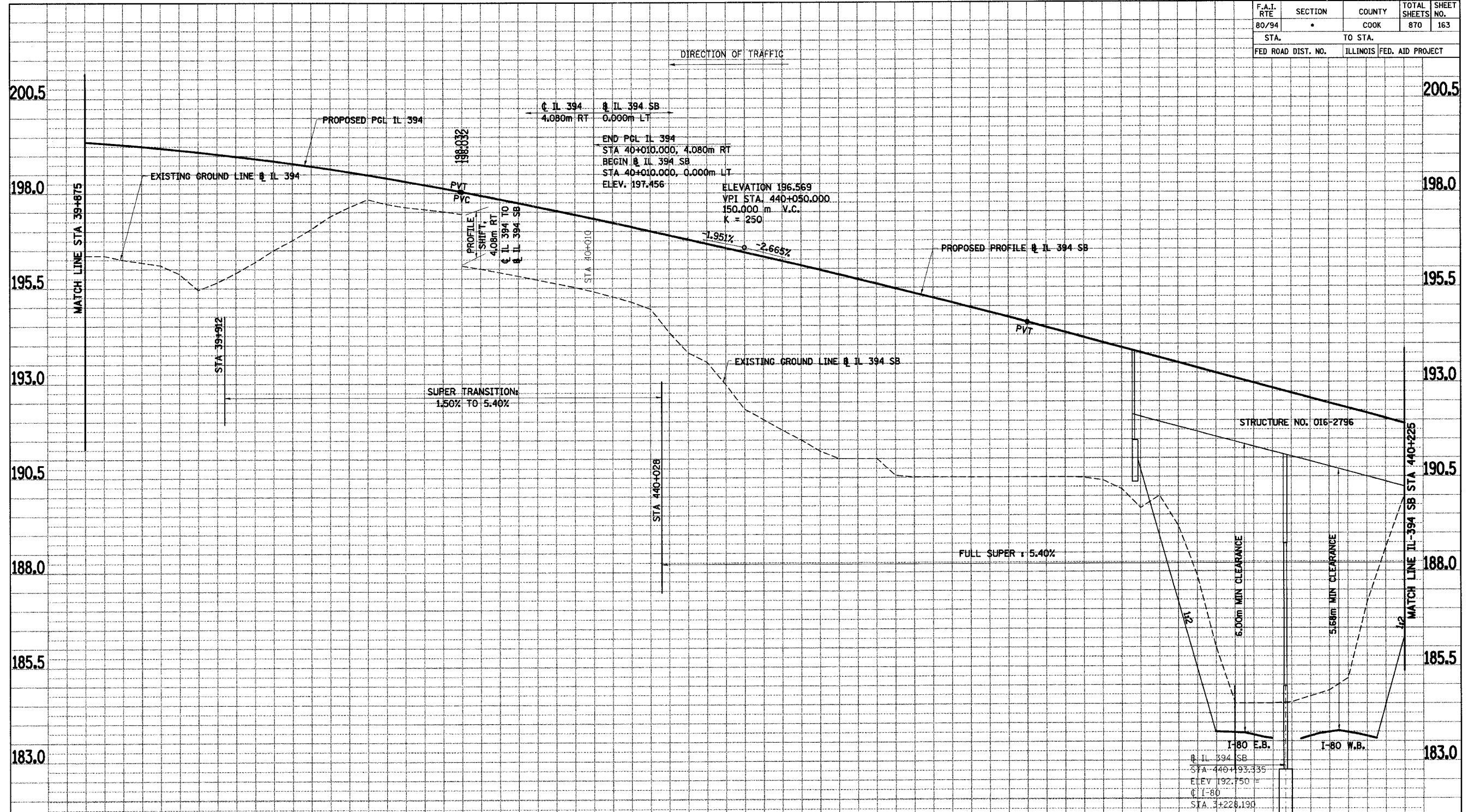

190.175	193.904	189.601	193.571	185.985	193.238	184.500	192.905	184.683	192.572	186.156	192.239	190.000	191.906
440+150	440+175	440+200	440+225										
ILLINOIS DEPARTMENT OF TRANSPORTATION I-94 EAST BOUND / IL 394 SOUTH BOUND													
<b>PROFILE IL-394 SB STA. 39+875 TO STA. 440+250</b>													
HORIZ SCALE: 1 : 500    VERT SCALE: 1 : 50    DATE: JULY 18, 2005    DRAWN BY: BAJ    CHECKED BY: JES													
<b>HNTB</b>													