

F.A.I. 80/94 (KINGERY EXPRESSWAY) BORING LOCATION PLAN ILLINOIS DEPARTMENT OF TRANSPORTATION, COOK COUNTY		F.A.I. RTE	SECTION	COUNTY	TOTAL SHEETS	SHEET NO.
DATE: 08/04 BY: WJS		80/94	*	COOK	870	185
 Wang Engineering, Inc. Geo-Environmental Engineers 1540 16th Street Lombard, IL 60146 630-253-9898		STA. 39+600	TO STA. 39+850		FED. ROAD DIST. NO. ILLINOIS FED. AID PROJECT	
BASED ON DRAWINGS PROVIDED BY AHTA CORPORATION		255-08-04				

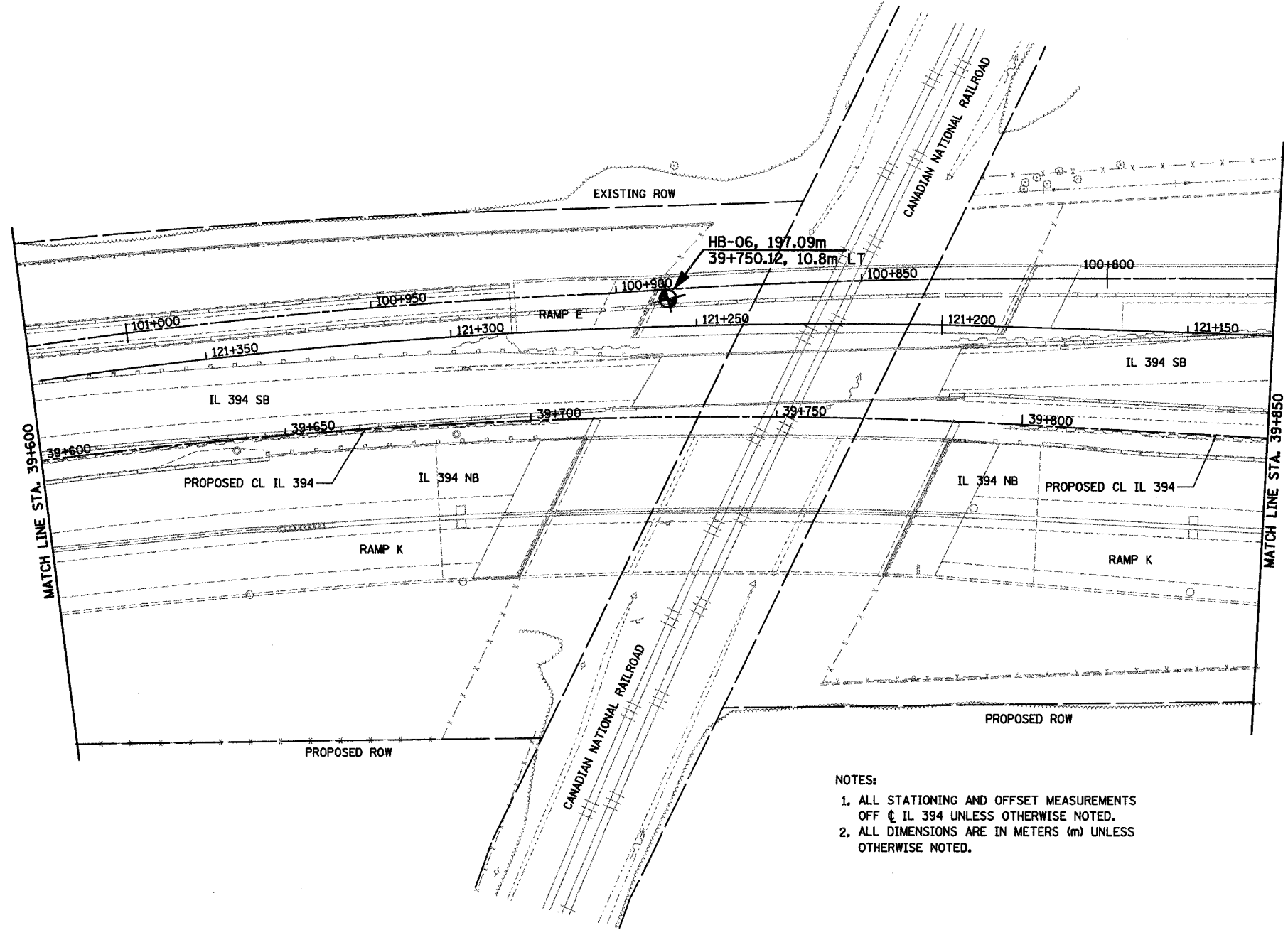

- NOTES:
1. ALL STATIONING AND OFFSET MEASUREMENTS OFF CL IL 394 UNLESS OTHERWISE NOTED.
 2. ALL DIMENSIONS ARE IN METERS (m) UNLESS OTHERWISE NOTED.

EXISTING

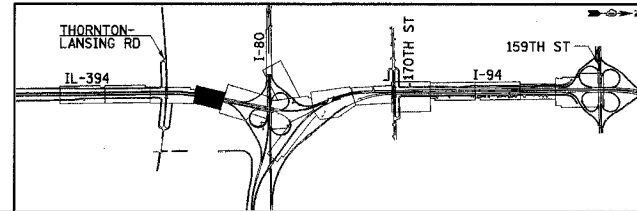

REVISIONS	
NAME	DATE

SB-13

ILLINOIS DEPARTMENT OF TRANSPORTATION
I-94 EAST BOUND / IL 394 SOUTH BOUND

SOIL BORING PLAN
IL 394
STA. 39+600 TO STA. 39+850

HORIZ SCALE: 1:500
VERT SCALE: 1:500
DATE: JULY 18, 2005

DRAWN BY:
CHECKED BY: