

F.A.I. 80/94 (KINGERY EXPRESSWAY) BORING LOCATION PLAN ILLINOIS DEPARTMENT OF TRANSPORTATION, COOK COUNTY		F.A.I. RTE	SECTION	COUNTY	TOTAL SHEETS NO.
Wang Engineering, Inc. Geo-Environmental Engineers		80/94	*	COOK	870
245 Main Street Lombard, IL 60148 630-963-9883		STA.	TO STA.		
MADE IN ACCORDANCE WITH THE SPECIFICATIONS		FED ROAD DIST. NO.	ILLINOIS FED. AID PROJECT		
255-08-04					

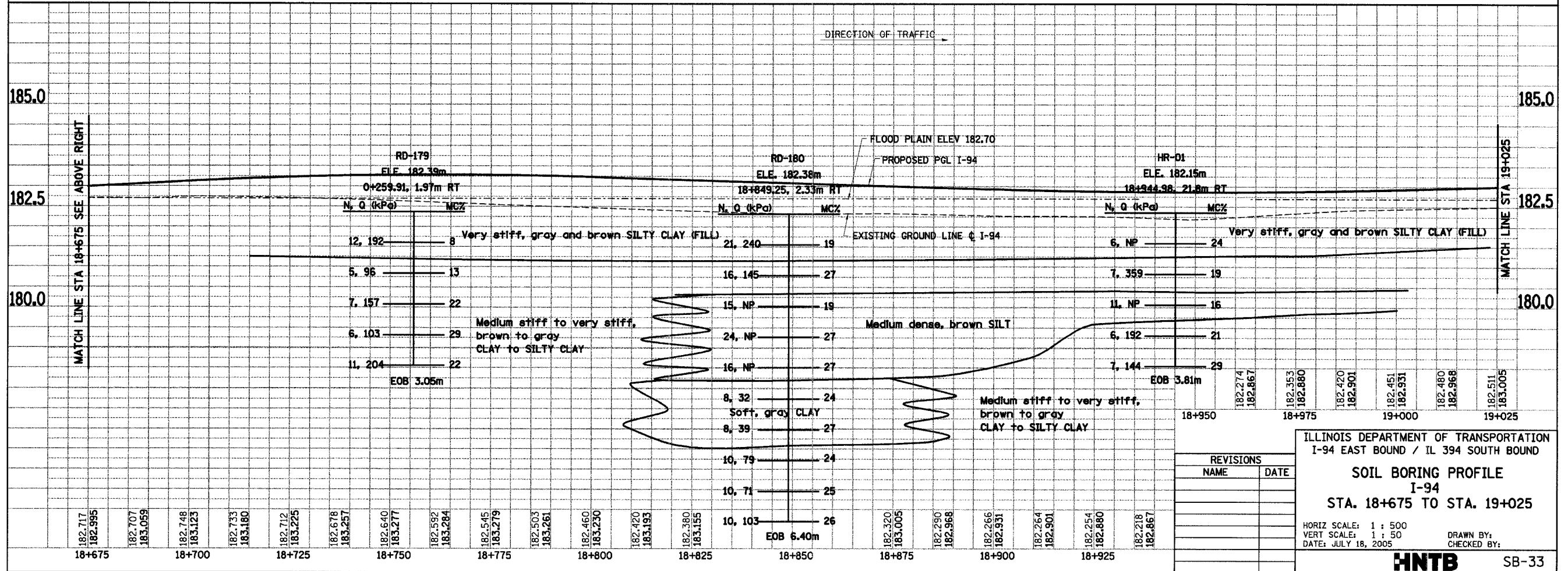
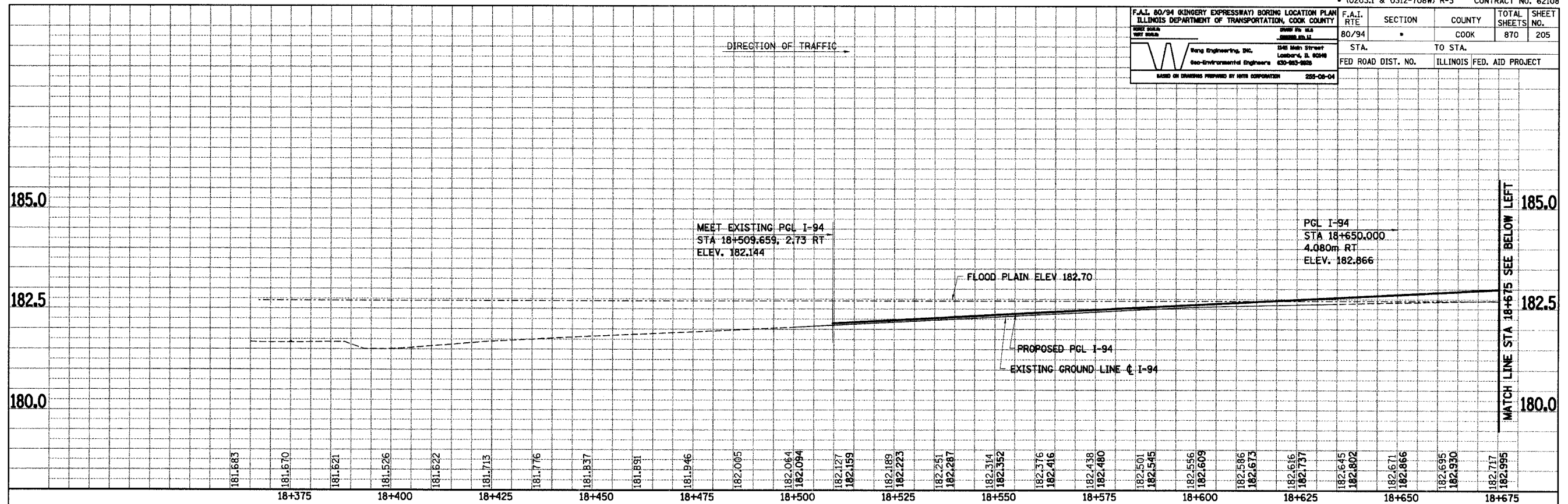

REVISIONS	
NAME	DATE

ILLINOIS DEPARTMENT OF TRANSPORTATION
I-94 EAST BOUND / IL 394 SOUTH BOUND

SOIL BORING PROFILE
I-94
STA. 18+675 TO STA. 19+025

HORIZ SCALE: 1 : 500
VERT SCALE: 1 : 50
DATE: JULY 18, 2005

DRAWN BY:
CHECKED BY:

HNTB SB-33