

F.A.I. 80/94 (KINGERY EXPRESSWAY) SOIL PROFILE ILLINOIS DEPARTMENT OF TRANSPORTATION, COOK COUNTY		F.A.I. RTE	SECTION	COUNTY	TOTAL SHEETS NO.
80/94				COOK	870
STATIONING: STA. 110+250.000 ELEV 187.152 = IL-394 SB STA 440+591.572, 24.450 LT		STA.	TO STA.		
FED ROAD DIST. NO.		ILLINOIS FED. AID PROJECT			
Fung Engineering, Inc. 240 Main Street Lombard, IL 60148 630-263-6686		252-09-04			

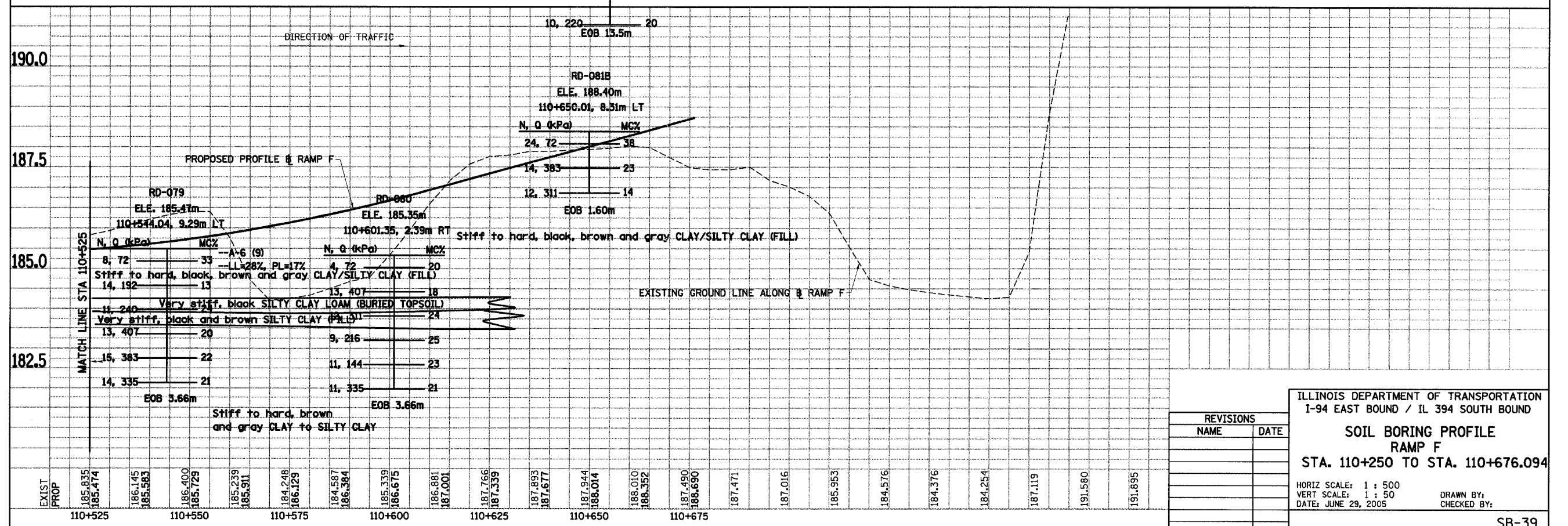
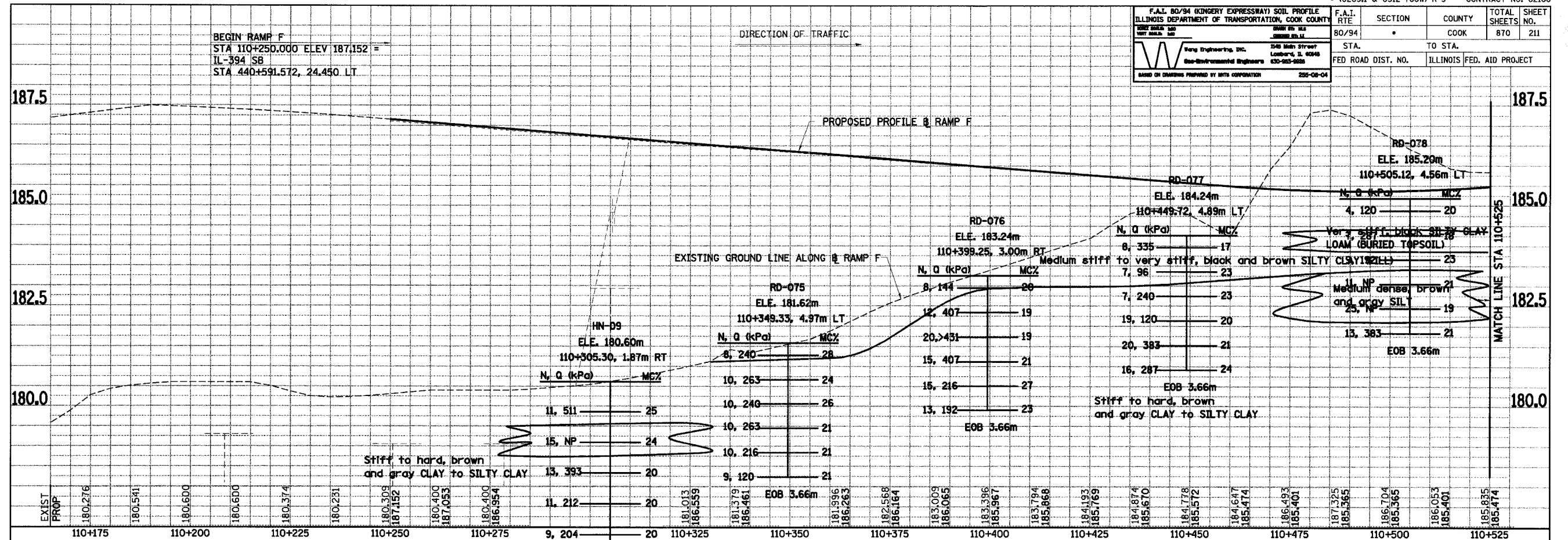

REVISIONS	
NAME	DATE

ILLINOIS DEPARTMENT OF TRANSPORTATION  
I-94 EAST BOUND / IL 394 SOUTH BOUND

**SOIL BORING PROFILE  
RAMP F  
STA. 110+250 TO STA. 110+676.094**

HORIZ SCALE: 1 : 500  
VERT SCALE: 1 : 50  
DATE: JUNE 29, 2005

DRAWN BY:  
CHECKED BY: