

F.A.I. RTE	SECTION	COUNTY	TOTAL SHEETS	SHEET NO.
80/94	*	COOK	870	212
STA.	18+363	TO STA.	18+725	
FED ROAD DIST. NO.	ILLINOIS	FED. AID PROJECT		

INTERIM DRAINAGE (TYPICAL)
 SUFFICIENT DRAINAGE FACILITIES SHALL BE MAINTAINED THROUGHOUT CONSTRUCTION TO FACILITATE SURFACE RUNOFF. WHEN ANY LOOSE MATERIAL IS DEPOSITED IN THE FLOW LINE OF DITCHES, GUTTER, OR DRAINAGE STRUCTURES SO THAT THE NATURAL FLOW OF WATER IS OBSTRUCTED, IT SHALL BE REMOVED AT THE CLOSE OF EACH WORKING DAY. AT THE CONCLUSION OF THE CONSTRUCTION OPERATIONS ALL DRAINAGE STRUCTURES SO AFFECTED SHALL BE FREE FROM DIRT AND DEBRIS. THIS WORK SHALL BE CONSIDERED AS INCLUDED IN THE CONTRACT. IT SHALL BE THE CONTRACTOR'S RESPONSIBILITY TO PLAN HIS OPERATIONS, WITH THE APPROVAL OF THE ENGINEER IN THE FIELD, SO AS TO UTILIZE THE FACILITIES PROVIDED TO PREVENT LOCAL FLOODING AND ENSURE PROPER SURFACE RUNOFF. ANY MINOR DITCH GRADING AND ANY BULKHEADING AS DIRECTED BY THE ENGINEER, NECESSARY TO PROVIDE FOR THE INTERIM DRAINAGE WILL NOT BE PAID FOR SEPARATELY BUT SHALL BE INCLUDED IN THE COST OF EARTH EXCAVATION.

MEDIAN DRAINAGE STRUCTURE INLET ADJUSTMENTS (TYPICAL)
 ALL MEDIAN INLETS INSTALLED IN PREVIOUS CONTRACTS ARE TO HAVE THE FRAME AND GRATE UNDER THE EB I-94 SHOULDERS AND CROSS-OVER LOCATIONS ADJUSTED TO FINISH GRADE. THIS WORK IS TO BE PAID FOR AS FRAMES AND GRATES TO BE ADJUSTED.

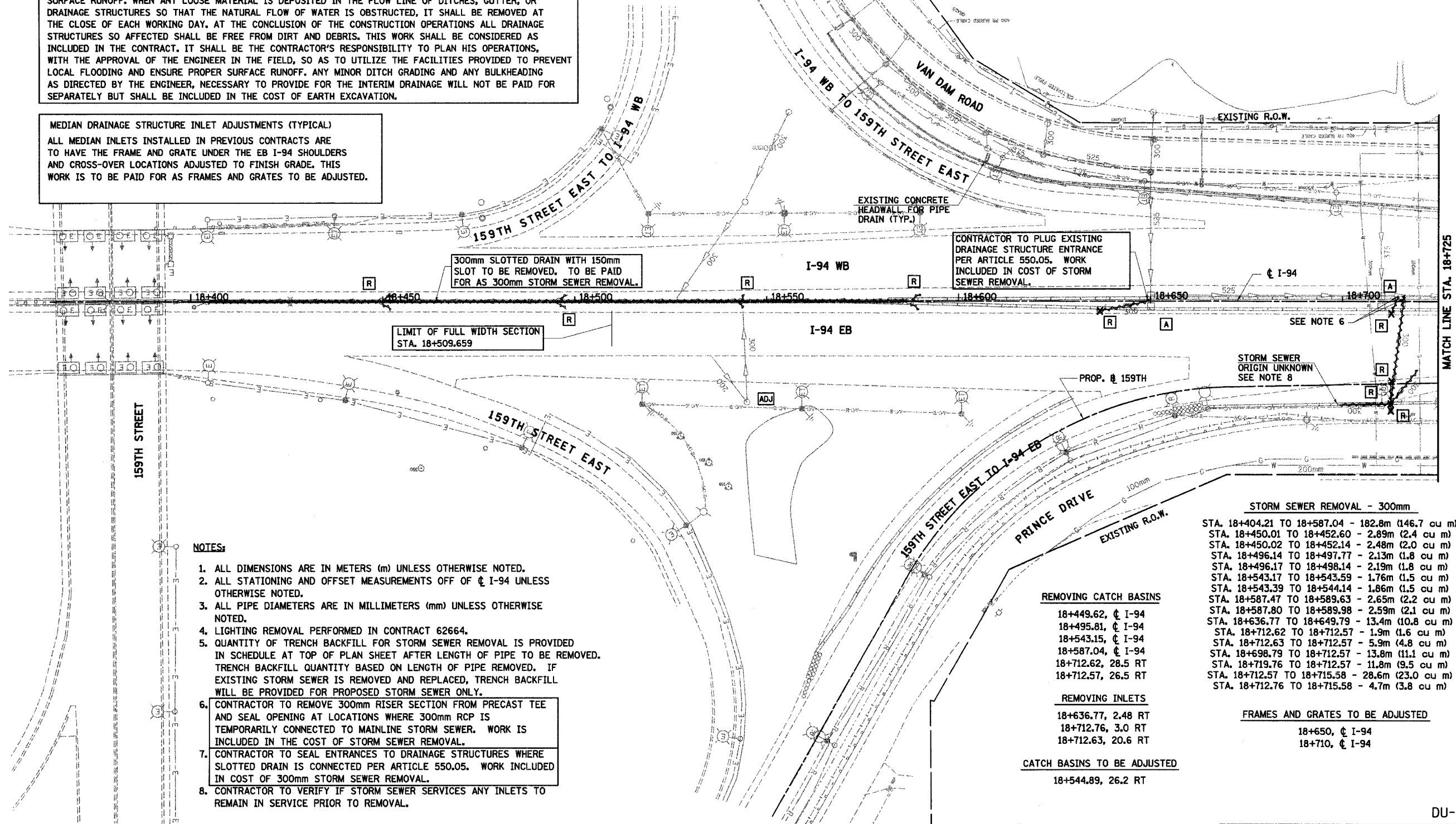

- NOTES:**
- ALL DIMENSIONS ARE IN METERS (m) UNLESS OTHERWISE NOTED.
 - ALL STATIONING AND OFFSET MEASUREMENTS OFF OF ϕ I-94 UNLESS OTHERWISE NOTED.
 - ALL PIPE DIAMETERS ARE IN MILLIMETERS (mm) UNLESS OTHERWISE NOTED.
 - LIGHTING REMOVAL PERFORMED IN CONTRACT 62664.
 - QUANTITY OF TRENCH BACKFILL FOR STORM SEWER REMOVAL IS PROVIDED IN SCHEDULE AT TOP OF PLAN SHEET AFTER LENGTH OF PIPE TO BE REMOVED. TRENCH BACKFILL QUANTITY BASED ON LENGTH OF PIPE REMOVED. IF EXISTING STORM SEWER IS REMOVED AND REPLACED, TRENCH BACKFILL WILL BE PROVIDED FOR PROPOSED STORM SEWER ONLY.
 - CONTRACTOR TO REMOVE 300mm RISER SECTION FROM PRECAST TEE AND SEAL OPENING AT LOCATIONS WHERE 300mm RCP IS TEMPORARILY CONNECTED TO MAINLINE STORM SEWER. WORK IS INCLUDED IN THE COST OF STORM SEWER REMOVAL.
 - CONTRACTOR TO SEAL ENTRANCES TO DRAINAGE STRUCTURES WHERE SLOTTED DRAIN IS CONNECTED PER ARTICLE 550.05. WORK INCLUDED IN COST OF 300mm STORM SEWER REMOVAL.
 - CONTRACTOR TO VERIFY IF STORM SEWER SERVICES ANY INLETS TO REMAIN IN SERVICE PRIOR TO REMOVAL.

STORM SEWER REMOVAL - 300mm

STA. 18+404.21 TO 18+587.04	- 182.8m (146.7 cu m)
STA. 18+450.01 TO 18+452.60	- 2.89m (2.4 cu m)
STA. 18+450.02 TO 18+452.14	- 2.48m (2.0 cu m)
STA. 18+496.14 TO 18+497.77	- 2.13m (1.8 cu m)
STA. 18+496.17 TO 18+498.14	- 2.19m (1.8 cu m)
STA. 18+543.17 TO 18+543.59	- 1.76m (1.5 cu m)
STA. 18+543.39 TO 18+544.14	- 1.86m (1.5 cu m)
STA. 18+587.47 TO 18+589.63	- 2.65m (2.2 cu m)
STA. 18+587.80 TO 18+589.98	- 2.59m (2.1 cu m)
STA. 18+636.77 TO 18+649.79	- 13.4m (10.8 cu m)
STA. 18+712.62 TO 18+712.57	- 1.9m (1.6 cu m)
STA. 18+712.63 TO 18+712.57	- 5.9m (4.8 cu m)
STA. 18+698.79 TO 18+712.57	- 13.8m (11.1 cu m)
STA. 18+719.76 TO 18+712.57	- 11.8m (9.5 cu m)
STA. 18+712.57 TO 18+715.58	- 28.6m (23.0 cu m)
STA. 18+712.76 TO 18+715.58	- 4.7m (3.8 cu m)

REMOVING CATCH BASINS

18+449.62, ϕ I-94
18+495.81, ϕ I-94
18+543.15, ϕ I-94
18+587.04, ϕ I-94
18+712.62, 28.5 RT
18+712.57, 26.5 RT

REMOVING INLETS

18+636.77, 2.48 RT
18+712.76, 3.0 RT
18+712.63, 20.6 RT

CATCH BASINS TO BE ADJUSTED

18+544.89, 26.2 RT

FRAMES AND GRATES TO BE ADJUSTED

18+650, ϕ I-94
18+710, ϕ I-94

LEGEND - EXISTING

	EXISTING INLET		EXISTING DRAINAGE STRUCTURE RECONSTRUCTED
	EXISTING CATCH BASIN		EXISTING FRAMES AND GRATES ADJUSTMENT
	EXISTING MANHOLE		EXISTING DRAINAGE STRUCTURES TO BE CLEANED
	EXISTING MEDIAN DRAINAGE STRUCTURE		EXISTING STORM SEWER TO BE REMOVED
	EXISTING DRAINAGE STRUCTURE REMOVAL		EXISTING STORM SEWER
	EXISTING DRAINAGE STRUCTURE ADJUSTMENT		EXISTING SLOTTED DRAIN
	EXISTING DITCH		EXISTING PIPE UNDERDRAIN

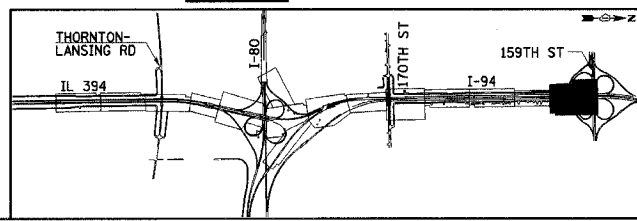

REVISIONS

NAME	DATE

ILLINOIS DEPARTMENT OF TRANSPORTATION
 I-94 EAST BOUND / IL 394 SOUTH BOUND

DRAINAGE AND UTILITIES
 I-94
 STA. 18+363 TO STA. 18+725

HORIZ SCALE: 1:500
 VERT SCALE: 1:500
 DATE: JULY 18, 2005

DRAWN BY: JPH
 CHECKED BY: MAM

HNTB