

F.A.I. RTE	SECTION	COUNTY	TOTAL SHEETS	SHEET NO.
80/94	*	COOK	870	217
STA. 19+700 TO STA. 20+000		ILLINOIS FED. AID PROJECT		

NOTES:

- ALL DIMENSIONS IN METERS (m) UNLESS OTHERWISE NOTED.
- ALL PIPE SIZES IN MILLIMETERS (mm) UNLESS OTHERWISE NOTED.
- ALL STATIONING AND OFFSET MEASUREMENTS OFF OF ϕ I-94 UNLESS OTHERWISE STATED.
- QUANTITY OF TRENCH BACKFILL FOR STORM SEWER REMOVAL IS PROVIDED IN SCHEDULE AT TOP OF PLAN SHEET AFTER LENGTH OF PIPE TO BE REMOVED. TRENCH BACKFILL QUANTITY BASED ON LENGTH OF PIPE REMOVED. IF EXISTING STORM SEWER IS REMOVED AND REPLACED, TRENCH BACKFILL WILL BE PROVIDED FOR PROPOSED STORM SEWER ONLY.
- CONTRACTOR TO REMOVE 300mm RISER SECTION FROM PRECAST TEE AND SEAL OPENING AT LOCATIONS WHERE 300mm RCP IS TEMPORARILY CONNECTED TO MAINLINE STORM SEWER. WORK INCLUDED IN THE COST OF STORM SEWER REMOVAL.
- CONTRACTOR TO PLUG ENTRANCE TO EXISTING DRAINAGE STRUCTURE PER ARTICLE 550.05. WORK INCLUDED IN COST OF STORM SEWER REMOVAL.

- REMOVING INLETS**
 19+702.1, 5.0 RT
 19+749.0, 4.7 RT
 19+839.3, 3.5 RT
 19+950.2, 23.5 RT
- REMOVING CATCH BASINS**
 19+704.0, 26.0 RT
 19+703.1, 25.0 RT
 19+980.4, 13.6 RT
- REMOVING MANHOLES**
 19+957.3, 17.9 RT
 19+998.0, 13.3 RT
 19+989.7, 157.1 LT

- STORM SEWER REMOVAL - 300mm**
 STA. 19+703.54 TO 19+703.13 - 14.2m (11.4 cu m)
 STA. 19+704.03 TO 19+703.13 - 1.4m (1.2 cu m)
 STA. 19+704.25 TO 19+703.13 - 11.9m (9.6 cu m)
 STA. 19+703.13 TO 19+699.67 - 26.54m (21.3 cu m)
 STA. 19+702.09 TO 19+699.67 - 6.76m (5.5 cu m)
 STA. 19+748.98 TO 19+746.63 - 7.7m (6.2 cu m)
 STA. 19+839.30 TO 19+841.83 - 7.7m (6.2 cu m)
 STA. 19+750.49 TO 19+823.70 - 73.2m (0 cu m)
 STA. 19+823.70 TO 19+860.43 - 36.7m (0 cu m)
 STA. 19+860.43 TO 19+875.00 - 14.6m (0 cu m)
 STA. 19+950.25 TO 19+957.26 - 9.0m (7.3 cu m)
 STA. 19+980.39 TO 19+998.05 - 17.7m (14.2 cu m)
 STA. 19+998.05 TO 20+000.00 - 2.4m (2.0 cu m)
- STORM SEWER REMOVAL - 450mm**
 STA. 19+956.62 TO 19+957.26 - 21.8m (27.4 cu m)
- STORM SEWER REMOVAL - 525mm**
 STA. 19+957.26 TO 19+957.35 - 18.0m (27.0 cu m)
- STORM SEWER REMOVAL - 750mm**
 STA. 20+000.0 TO 19+989.7 - 89.4m (203.0 cu m)

FRAMES AND GRATES TO BE ADJUSTED

- 19+750.00, ϕ I-94
 19+823.79, ϕ I-94
 19+859.81, ϕ I-94
 19+930.00, ϕ I-94
 19+957.00, ϕ I-94

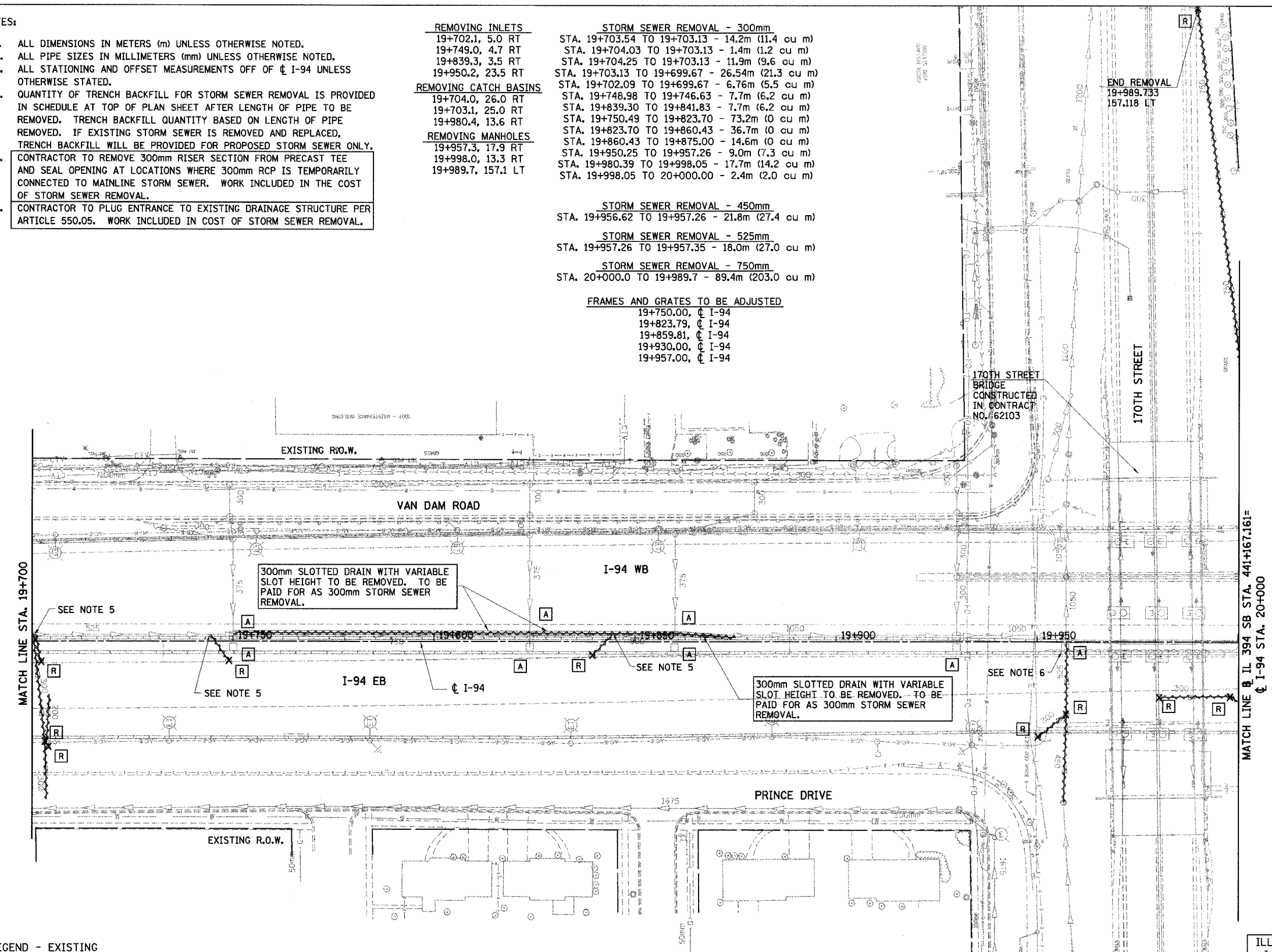

LEGEND - EXISTING

- | | |
|--|---|
| \circ EXISTING INLET | \square REC EXISTING DRAINAGE STRUCTURE RECONSTRUCTED |
| \circ EXISTING CATCH BASIN | \square A EXISTING FRAMES AND GRATES ADJUSTMENT |
| \circ EXISTING MANHOLE | \square C EXISTING DRAINAGE STRUCTURES TO BE CLEANED |
| \square EXISTING MEDIAN DRAINAGE STRUCTURE | --- EXISTING STORM SEWER TO BE REMOVED |
| \times R EXISTING DRAINAGE STRUCTURE REMOVAL | --- EXISTING STORM SEWER |
| ADJ EXISTING DRAINAGE STRUCTURE ADJUSTMENT | --- EXISTING SLOTTED DRAIN |
| --- EXISTING DITCH | --- EXISTING PIPE UNDERDRAIN |

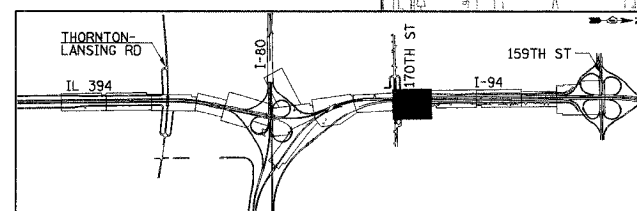

REVISIONS	
NAME	DATE

ILLINOIS DEPARTMENT OF TRANSPORTATION
 I-94 EAST BOUND / IL 394 SOUTH BOUND

DRAINAGE AND UTILITIES
 I-94
 STA. 19+700 TO STA. 20+000

HORIZ SCALE: 1:500
 VERT SCALE: 1:500
 DATE: JULY 18, 2005
 DRAWN BY: JPH
 CHECKED BY: MAM

