

F.A.I. RTE	SECTION	COUNTY	TOTAL SHEETS	SHEET NO.
80/94	•	COOK	870	223
STA. 39+250		TO STA. 39+600		
FED ROAD DIST. NO.		ILLINOIS		FED. AID PROJECT

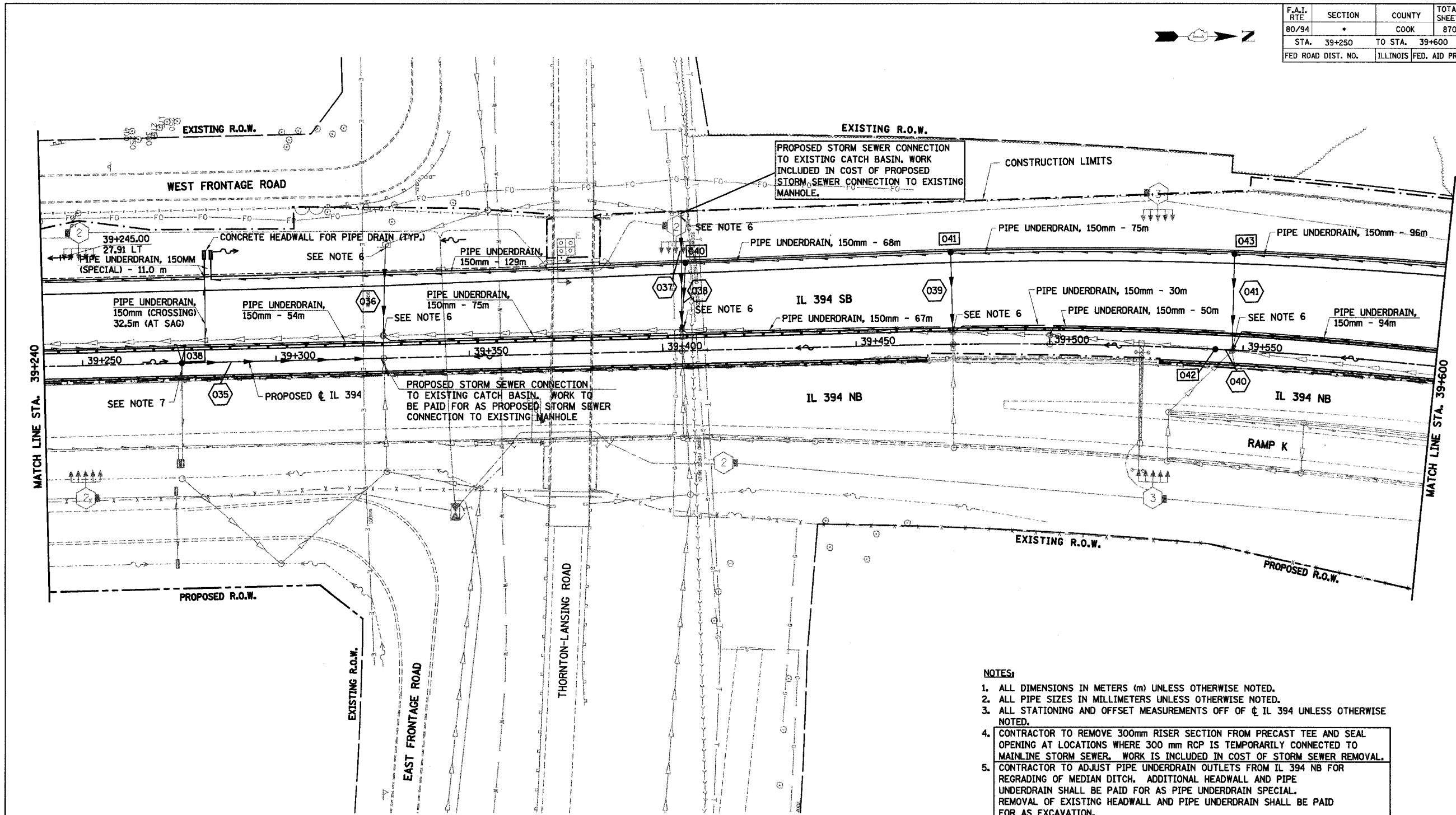

**NOTES:**

1. ALL DIMENSIONS IN METERS (m) UNLESS OTHERWISE NOTED.
2. ALL PIPE SIZES IN MILLIMETERS UNLESS OTHERWISE NOTED.
3. ALL STATIONING AND OFFSET MEASUREMENTS OFF OF CL IL 394 UNLESS OTHERWISE NOTED.
4. CONTRACTOR TO REMOVE 300mm RISER SECTION FROM PRECAST TEE AND SEAL OPENING AT LOCATIONS WHERE 300 mm RCP IS TEMPORARILY CONNECTED TO MAINLINE STORM SEWER. WORK IS INCLUDED IN COST OF STORM SEWER REMOVAL.
5. CONTRACTOR TO ADJUST PIPE UNDERDRAIN OUTLETS FROM IL 394 NB FOR REGRADING OF MEDIAN DITCH. ADDITIONAL HEADWALL AND PIPE UNDERDRAIN SHALL BE PAID FOR AS PIPE UNDERDRAIN SPECIAL. REMOVAL OF EXISTING HEADWALL AND PIPE UNDERDRAIN SHALL BE PAID FOR AS EXCAVATION.
6. PROPOSED STORM SEWER CONNECTION TO EXISTING MANHOLE.
7. CONTRACTOR TO CONNECT EXISTING PIPE UNDERDRAIN FROM IL 394 NB TO PROPOSED CATCH BASIN. REMOVAL OF EXISTING HEADWALL AND PIPE UNDERDRAIN NECESSARY FOR PROPOSED CONNECTION SHALL BE PAID FOR AS EXCAVATION.

**LEGEND - PROPOSED**

- |       |                        |   |   |
|-------|------------------------|---|---|
| —●—   | PROPOSED STORM SEWER   | — | PROPOSED INLET                              |
| —○—   | PROPOSED SUMMIT        | ● | PROPOSED CATCH BASIN                        |
| - - - | PROPOSED DITCH         | ○ | PROPOSED MANHOLE                            |
| —/—   | PROPOSED SLOTTED DRAIN | ■ | MEDIAN DRAINAGE STRUCTURE                   |
| —+—   | PROPOSED SWALE         | ▲ | PRECAST REINFORCED CONC. FLARED END SECTION |

**PROPOSED**

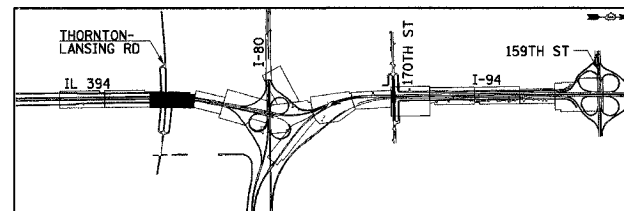

REVISIONS	
NAME	DATE

DU-12

ILLINOIS DEPARTMENT OF TRANSPORTATION  
I-94 EAST BOUND / IL 394 SOUTH BOUND

**DRAINAGE AND UTILITIES**  
**IL 394**  
**STA. 39+240 TO STA. 39+600**

HORIZ SCALE: 1:500  
VERT SCALE: NONE  
DATE: JULY 18, 2005

DRAWN BY: DKB  
CHECKED BY: MAM

**HNTB**