

F.A.I. RTE	SECTION	COUNTY	TOTAL SHEETS	SHEET NO.
80/94	*	COOK	870	249
STA. 20+200	TO STA. 20+875			
FED ROAD DIST. NO.	ILLINOIS FED. AID PROJECT			

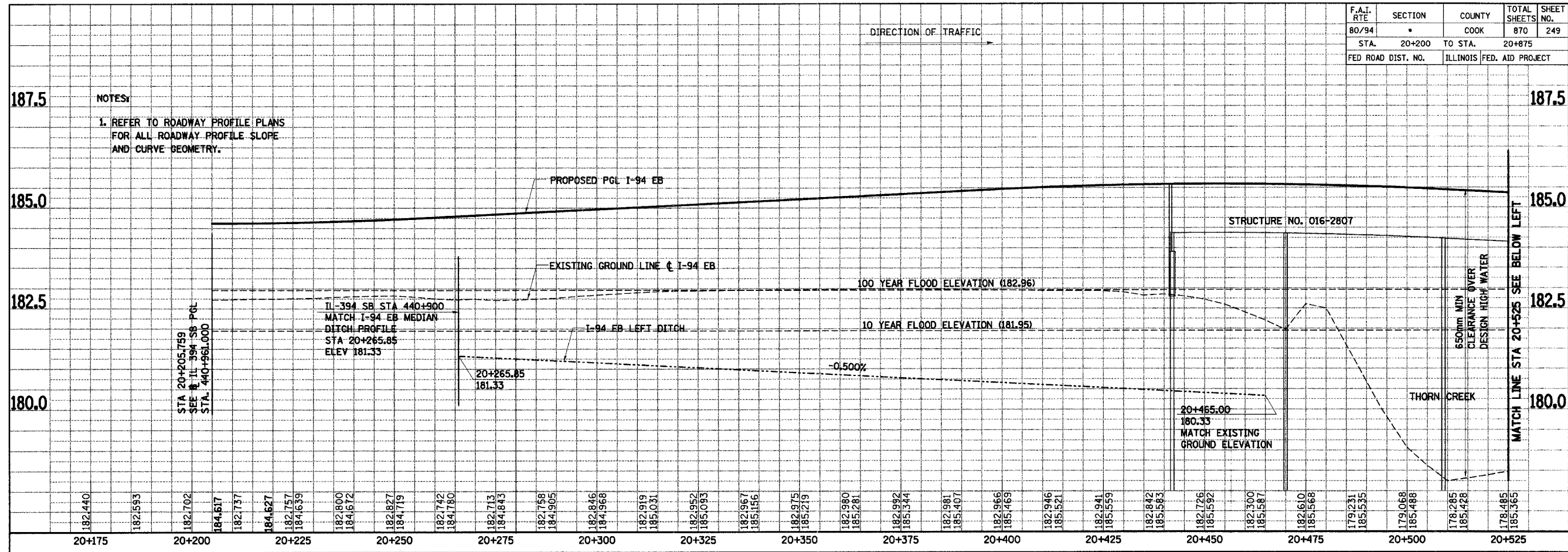

NOTES:
1. REFER TO ROADWAY PROFILE PLANS FOR ALL ROADWAY PROFILE SLOPE AND CURVE GEOMETRY.

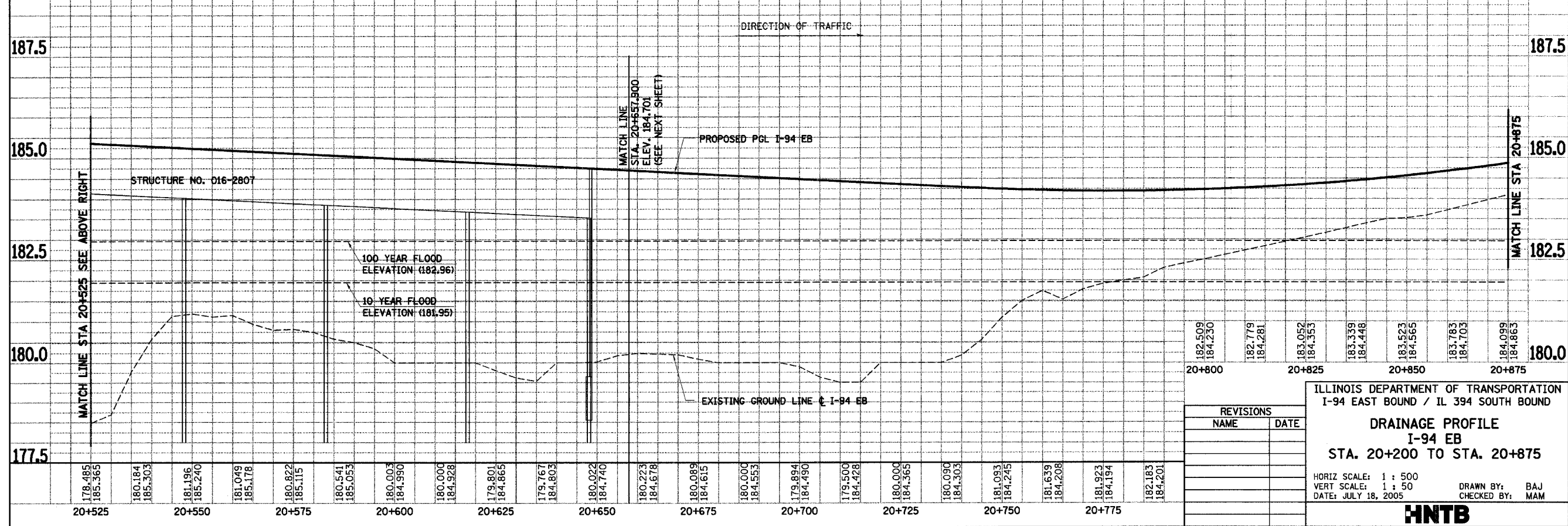

182.509	182.779	183.052	183.339	183.523	183.783	184.099
184.230	184.281	184.353	184.448	184.565	184.703	184.863
20+800		20+825		20+850		20+875

REVISIONS	
NAME	DATE

ILLINOIS DEPARTMENT OF TRANSPORTATION
I-94 EAST BOUND / IL 394 SOUTH BOUND
DRAINAGE PROFILE
I-94 EB
STA. 20+200 TO STA. 20+875
HORIZ SCALE: 1 : 500
VERT SCALE: 1 : 50
DATE: JULY 18, 2005
DRAWN BY: BAJ
CHECKED BY: MAM
HNTB