

PART of the SOUTHEAST QUARTER of SECTION 26, T36N., R14E., of the 3rd. P.M. COOK COUNTY, ILLINOIS

BY	DATE
R.O.W. PLAT	NOTEBOOK NO.

CURVE NO. 11
 $\Delta = 102^{\circ}56'51''$
 $CB = 537^{\circ}41'46''E$
 $CH = 305.106m [1001.00']$
 $L = 350.371m [1149.51']$
 $R = 195.000m [639.76']$
 $T = 244.919m [803.54']$
 $PC = STA. 100+378.506$
 $PI = STA. 100+623.425$
 $PT = STA. 100+728.877$

CURVE NO. 13
 $\Delta = 67^{\circ}43'29''$
 $CB = N41^{\circ}37'18''W$
 $CH = 203.935m [669.08']$
 $L = 216.309m [709.67']$
 $R = 183.000m [600.39']$
 $T = 122.796m [402.81']$

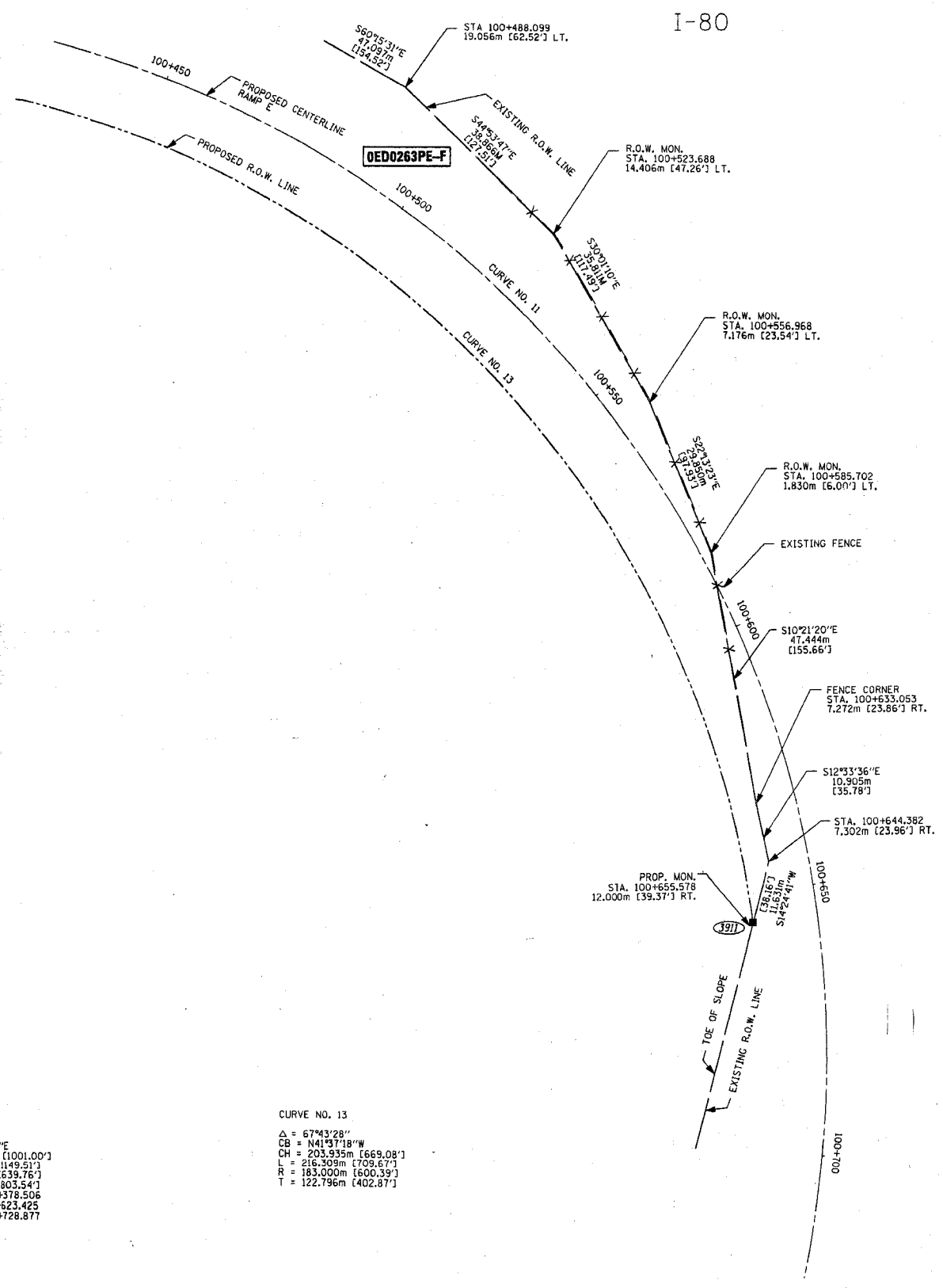

LEGEND

- SECTION CORNER
- QUARTER SECTION CORNER
- COORDINATE POSITION NUMBER
- SECTION LINE
- QUARTER SECTION LINE
- QUARTER, QUARTER SECTION LINE
- PROPOSED RIGHT OF WAY LINE
- PROPOSED EASEMENT
- EXISTING RIGHT OF WAY LINE
- CENTERLINE
- PLATTED LOT LINES
- PROPERTY (DEED) LINE
- APPARENT PROPERTY LINE
- (129.32) MEASURED ENGLISH DIMENSION
- (129.32) COMPUTED DIMENSION
- (129.32) RECORDED DIMENSION
- 129.32m METRIC DIMENSION
- + CUT CROSS FOUND OR SET
- EXISTING BUILDING
- IRON PIPE FOUND
- IRON PIPE SET
- T1 THESE STAKES REFERENCE FOUND MONUMENTATION. SET 5/8 INCH IRON ROD FLUSH WITH GROUND TO TIE FOUND IRON STAKE IDENTIFIED BY COLORED PLASTIC CAP BEARING SURVEYORS REGISTRATION NUMBER.
- BT1 THESE STAKES, IN CULTIVATED AREAS, REFERENCE FOUND MONUMENTATION. BURIED 5/8 INCH IRON ROD 20 INCHES BELOW GROUND TO TIE TP FOUND IRON STAKE. IDENTIFIED BY COLORED PLASTIC CAP BEARING SURVEYORS REGISTRATION NUMBER.
- STAKING OF PROPOSED RIGHT OF WAY. SET DIVISION OF HIGHWAYS SURVEY MARKER TO MONUMENT THE POSITION SHOWN. IDENTIFIED BY INSCRIPTION DATA AND SURVEYORS REGISTRATION NUMBER.
- STAKING OF PROPOSED RIGHT OF WAY IN CULTIVATED AREAS. BURIED 5/8 INCH METAL ROD 20 INCHES BELOW GROUND TO MARK FUTURE SURVEY DISK POSITION IDENTIFIED BY COLORED PLASTIC CAP BEARING SURVEYORS REGISTRATION NUMBER.
- PERMANENT SURVEY MARKER, I.D.O.T. STD. 2135 (TO BE SET BY OTHERS)
- RIGHT OF WAY STAKING PROPOSED TO BE SET.

STATE OF ILLINOIS)
)
 COUNTY OF WILL)
)
 THIS IS TO CERTIFY THAT I, ROBERT A. ROGINA, AN ILLINOIS PROFESSIONAL LAND SURVEYOR, HAVE SURVEYED THE PLAT OF HIGHWAYS SHOWN HERE ON BETWEEN SECTION 26, TOWNSHIP 36 NORTH, AND RANGE 14 EAST OF THE THIRD PRINCIPAL MERIDIAN, COOK COUNTY; THAT THE SURVEY IS TRUE AND COMPLETE AS SHOWN TO THE BEST OF MY KNOWLEDGE AND BELIEF; THAT THE PLAT CORRECTLY REPRESENTS SAID SURVEY, THAT ALL MONUMENTS FOUND AND ESTABLISHED ARE OF PERMANENT QUALITY AND OCCUPY THE POSITIONS SHOWN THEREON AND THAT THE MONUMENTS ARE SUFFICIENT TO ENABLE THE SURVEY TO BE RETRACED, MADE FOR THE DEPARTMENT OF TRANSPORTATION, STATE OF ILLINOIS.

DATED AT JOLIET, ILLINOIS THIS 15th DAY OF JANUARY, 2003 A.D.

 ILLINOIS PROFESSIONAL LAND SURVEYOR NO. 2017



NOTE:
 BASIS OF BEARINGS IS THE ILLINOIS STATE PLANE COORDINATE SYSTEM EAST ZONE, NAD 83



PLAT OF HIGHWAYS
 STATE OF ILLINOIS
 DEPARTMENT OF TRANSPORTATION
 FAI - 180/94

SECTION: COOK COUNTY
 PROJECT: JOB NO. R-90-010-01
 STATION 100 + 420.000 TO STATION 100 + 700.000
 SCALE: 1:500 SHEET: 43A OF 63A

BUREAU OF LAND ACQUISITION
 201 WEST CENTER COURT
 SCHAUMBURG, ILLINOIS 60196

10/21/02	PER IDOT REVIEW / ADDED COORDINATE POSITION NUMBERS	RPH/JAK
06/17/02	PER IDOT REVIEW	MHG/JAK
4/30/02	PER IDOT REVIEW	BLF/JAK
REV. DATE	REVISION	BLF/JAK

DGM/IDOT/123-0801/SH1500-43A.DGN