

F.A.I. RTE	SECTION	COUNTY	TOTAL SHEETS	SHEET NO.
80/94	*	COOK	870	399
STA.	39+850	TO STA.	440+200	
FED ROAD DIST. NO.	ILLINOIS FED. AID PROJECT			

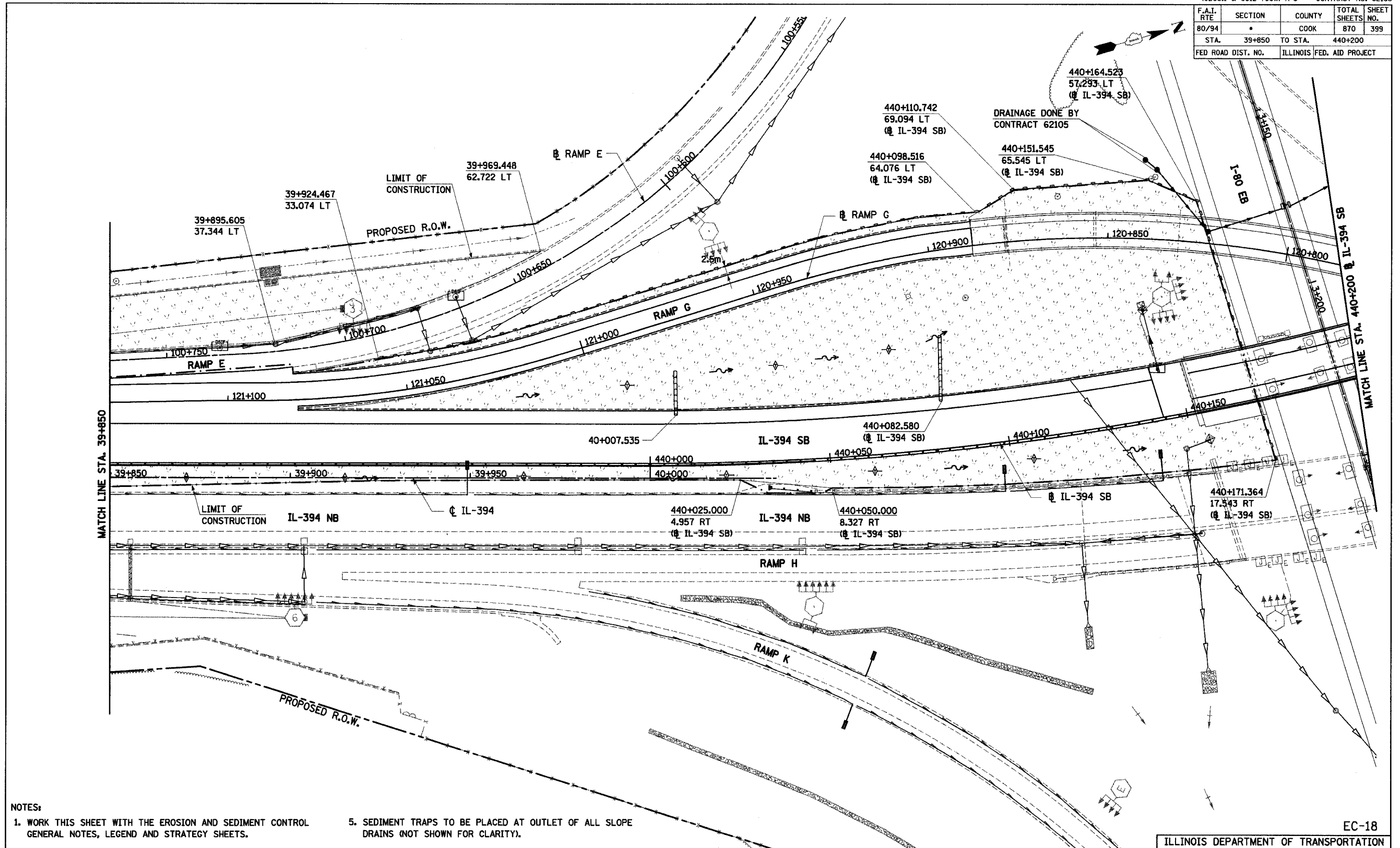

NOTES:

1. WORK THIS SHEET WITH THE EROSION AND SEDIMENT CONTROL GENERAL NOTES, LEGEND AND STRATEGY SHEETS.
2. ERODIBLE AREAS TO BE TEMPORARILY SEEDED DURING CONSTRUCTION AS REQUIRED BY THE EROSION AND SEDIMENT CONTROL GENERAL NOTES.
3. ALL STATIONING AND OFFSET MEASUREMENTS OFF ϕ IL-394 UNLESS OTHERWISE NOTED.
4. ALL DIMENSIONS ARE IN METERS (m) UNLESS OTHERWISE NOTED.
5. SEDIMENT TRAPS TO BE PLACED AT OUTLET OF ALL SLOPE DRAINS (NOT SHOWN FOR CLARITY).
6. TEMPORARY FENCE TO BE PLACED AT LOCATIONS ALONG ALL CONSTRUCTION LIMITS WHERE PERIMETER EROSION BARRIER IS NOT INDICATED (TEMPORARY FENCE NOT SHOWN AT THESE LOCATIONS FOR CLARITY).
7. COORDINATE EROSION CONTROL WITH CONTRACT 62348 AND CONTRACT 62105.

DURING CONSTRUCTION

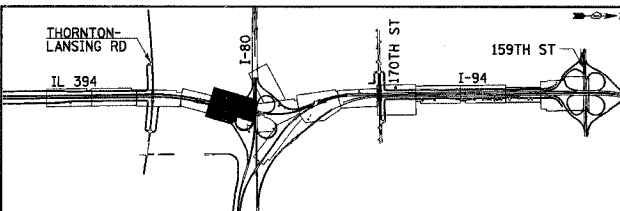

REVISIONS	
NAME	DATE

EC-18

ILLINOIS DEPARTMENT OF TRANSPORTATION
I-94 EAST BOUND / IL 394 SOUTH BOUND
EROSION CONTROL PLAN
IL 394
STA. 39+850 (ϕ IL 394) TO
STA. 440+200 (ϕ IL 394 SB)

HORIZ SCALE: 1:500
VERT SCALE: 1:500
DATE: JULY 18, 2005

DRAWN BY: JPH
CHECKED BY: MAM

HNTB