

ALL DIMENSIONS IN METERS EXCEPT PAY ITEMS AND UNLESS NOTED OTHERWISE

F.A.I. RTE.	SECTION	COUNTY	TOTAL SHEETS	SHEET NO.
80/94	2626.2-R-2	COOK/LAKE	1207	359
STA.	TO STA.			
FED. ROAD DIST. NO.	ILLINOIS	FED. AID PROJECT		
CONTRACT NO. 62114	INDOT DES. NO. 0100987			

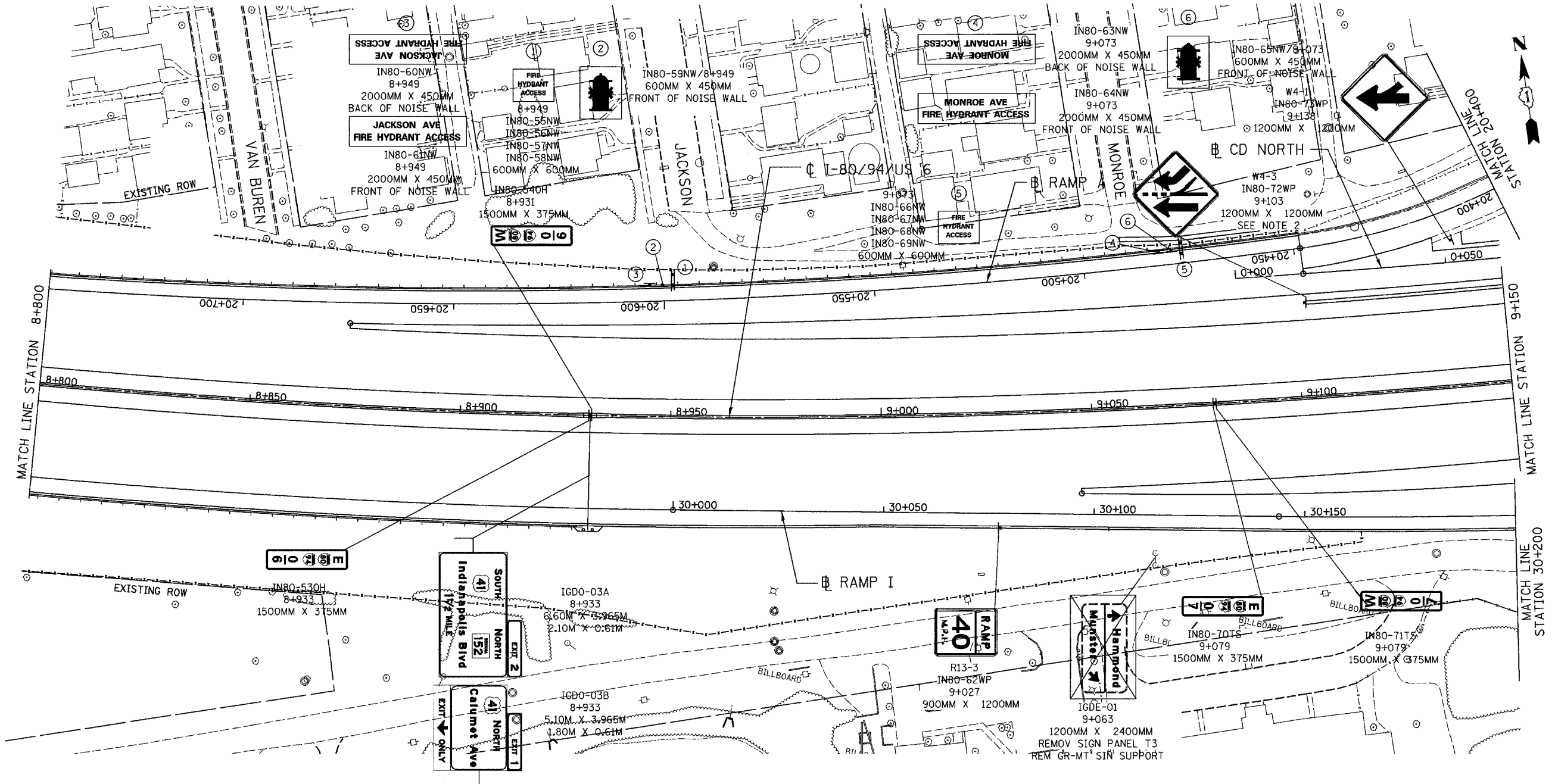

- NOTE:
- THE BANDING OF SIGNS TO THE OVERHEAD SIGN STRUCTURE SUPPORTS SHALL BE INCLUDED IN THE COST FOR SIGN PANELS.
 - CORE THROUGH SHOULDER TO INSTALL WOOD POST. COST OF CORING INCLUDED WITH PAY ITEM-SIGN POST, WOOD (INDIANA).

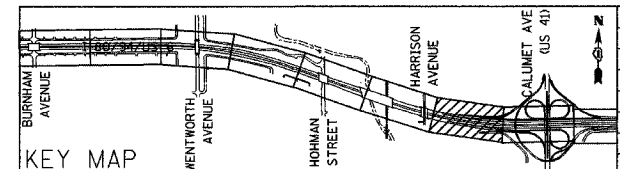

REVISIONS	
NAME	DATE

ILLINOIS DEPARTMENT OF TRANSPORTATION
 I-80/94/US 6
 KINGERY-BORMAN EXPRESSWAY
 BURNHAM ROAD TO US 41
SIGNING PLAN
 STA. 8+800 TO STA. 9+150
 SCALE 1:500
 DATE 07/05
 DRAWN BY ACE/CAD
 CHECKED BY TAE

AMERICAN
 CONSULTING ENGINEERS