

# WEIGH IN MOTION (WIM) STATION OVERVIEW

## STA. 8 + 337

F.A.I. RTE.	SECTION	COUNTY	TOTAL SHEETS	SHEET NO.
80/94	2626.2-R-1	COOK	1207	489
STA.	TO STA.			
FED. ROAD DIST. NO.	ILLINOIS	FED. AID PROJECT		
CONTRACT NO. 62114				

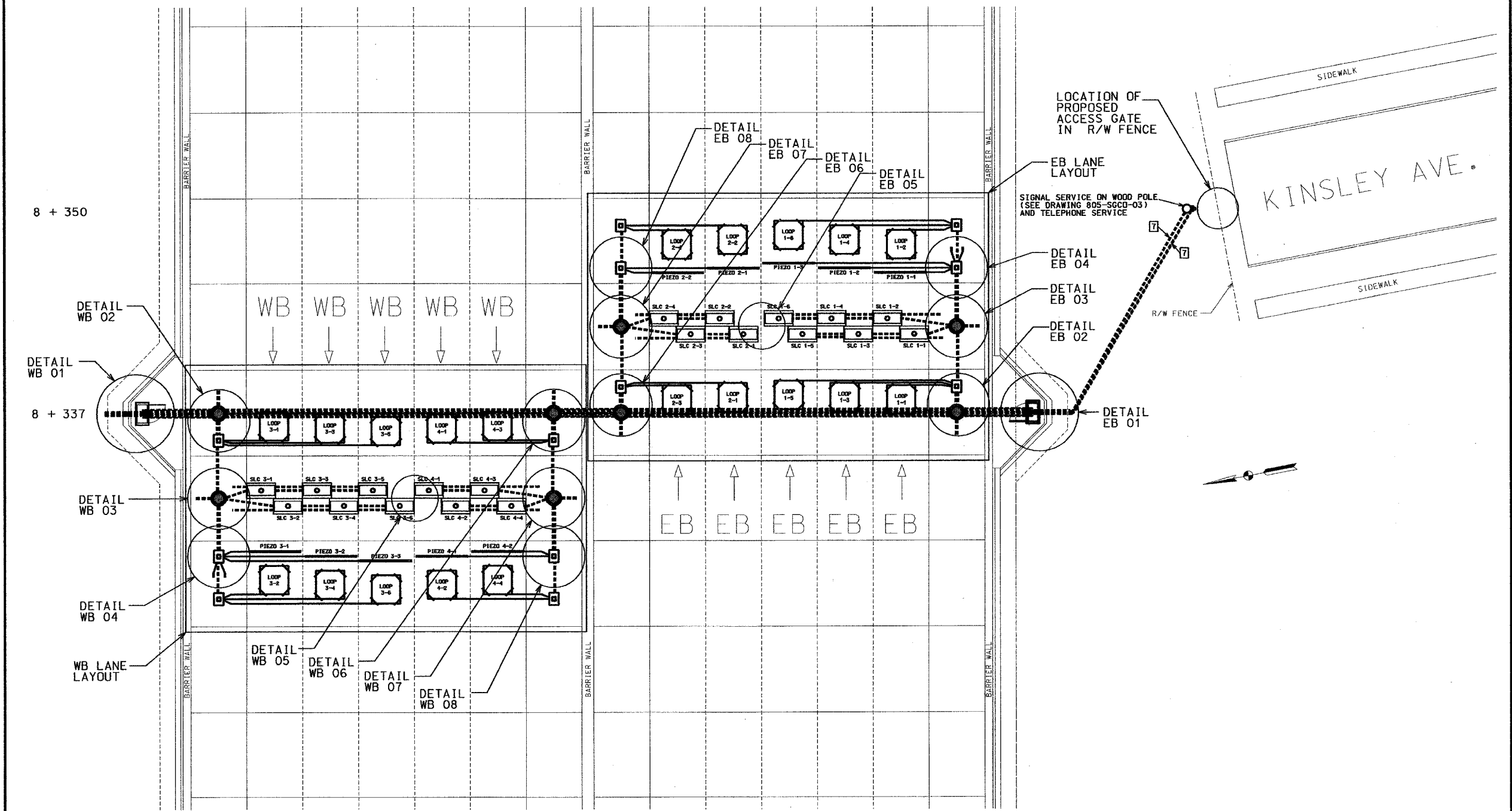

<p><b>LEGEND</b></p> <table style="width: 100%; border: none;"> <tr> <td style="width: 50%; border: none;"> <p>1 DETECTOR HOUSING (SEE DETAIL)</p> <p>2 WEIGH-IN-MOTION HANDHOLE WITH FRAME, FLANGE &amp; LID ASSEMBLY</p> <p>3 TYPE "R" SIGNAL CONTROLLER CABINET AND FOUNDATION</p> <p>4 CONNECT TO NEAREST CATCH BASIN</p> <p>5 76 MM PVC CONDUIT OR 76 MM HIGH DENSITY POLYETHYLENE EHMW PIPE</p> </td> <td style="width: 50%; border: none;"> <p>6 50 MM PVC CONDUIT OR 50 MM HIGH DENSITY POLYETHYLENE EHMW PIPE</p> <p>7 50 MM GALVANIZED STEEL CONDUIT</p> <p>8 TEMPERATURE SENSOR</p> <p>9 D1 CONTRACTION PAVEMENT JOINT</p> <p>10 LONGITUDINAL PAVEMENT JOINT</p> <p>11 100 MM PVC CONDUIT OR 100 MM HIGH DENSITY POLYETHYLENE EHMW PIPE</p> </td> </tr> </table>	<p>1 DETECTOR HOUSING (SEE DETAIL)</p> <p>2 WEIGH-IN-MOTION HANDHOLE WITH FRAME, FLANGE &amp; LID ASSEMBLY</p> <p>3 TYPE "R" SIGNAL CONTROLLER CABINET AND FOUNDATION</p> <p>4 CONNECT TO NEAREST CATCH BASIN</p> <p>5 76 MM PVC CONDUIT OR 76 MM HIGH DENSITY POLYETHYLENE EHMW PIPE</p>	<p>6 50 MM PVC CONDUIT OR 50 MM HIGH DENSITY POLYETHYLENE EHMW PIPE</p> <p>7 50 MM GALVANIZED STEEL CONDUIT</p> <p>8 TEMPERATURE SENSOR</p> <p>9 D1 CONTRACTION PAVEMENT JOINT</p> <p>10 LONGITUDINAL PAVEMENT JOINT</p> <p>11 100 MM PVC CONDUIT OR 100 MM HIGH DENSITY POLYETHYLENE EHMW PIPE</p>	<p><b>REVISIONS</b></p> <table border="1" style="width: 100%; border-collapse: collapse;"> <thead> <tr> <th style="width: 20%;">DATE</th> <th>DESCRIPTION</th> </tr> </thead> <tbody> <tr><td> </td><td> </td></tr> <tr><td> </td><td> </td></tr> <tr><td> </td><td> </td></tr> <tr><td> </td><td> </td></tr> </tbody> </table>	DATE	DESCRIPTION										<p>RECOMMENDED FOR APPROVAL: <i>Scott A. MacArthur</i> 6-9-05 DESIGN ENGINEER DATE</p> <table border="1" style="width: 100%; border-collapse: collapse;"> <tr> <td>DESIGNED: DRK</td> <td>DRAWN: DRK</td> </tr> <tr> <td>CHECKED: DRK</td> <td>CHECKED: DRK</td> </tr> </table>	DESIGNED: DRK	DRAWN: DRK	CHECKED: DRK	CHECKED: DRK	<p><b>INDIANA DEPARTMENT OF TRANSPORTATION</b></p> <p><b>WEIGH-IN-MOTION STATION OVERVIEW</b> STA. 8 + 337</p>	<p>I-80/94/US 6 KINGERY-BORMAN EXPRESSWAY BURNHAM ROAD TO US 41</p> <table border="1" style="width: 100%; border-collapse: collapse;"> <tr> <td>HORIZONTAL SCALE</td> <td rowspan="3" style="text-align: center; vertical-align: middle;"><b>WIM STATION DETAILS</b></td> </tr> <tr> <td>Not To Scale</td> </tr> <tr> <td>VERTICAL SCALE</td> </tr> <tr> <td>Not To Scale</td> <td> </td> </tr> </table>	HORIZONTAL SCALE	<b>WIM STATION DETAILS</b>	Not To Scale	VERTICAL SCALE	Not To Scale	
<p>1 DETECTOR HOUSING (SEE DETAIL)</p> <p>2 WEIGH-IN-MOTION HANDHOLE WITH FRAME, FLANGE &amp; LID ASSEMBLY</p> <p>3 TYPE "R" SIGNAL CONTROLLER CABINET AND FOUNDATION</p> <p>4 CONNECT TO NEAREST CATCH BASIN</p> <p>5 76 MM PVC CONDUIT OR 76 MM HIGH DENSITY POLYETHYLENE EHMW PIPE</p>	<p>6 50 MM PVC CONDUIT OR 50 MM HIGH DENSITY POLYETHYLENE EHMW PIPE</p> <p>7 50 MM GALVANIZED STEEL CONDUIT</p> <p>8 TEMPERATURE SENSOR</p> <p>9 D1 CONTRACTION PAVEMENT JOINT</p> <p>10 LONGITUDINAL PAVEMENT JOINT</p> <p>11 100 MM PVC CONDUIT OR 100 MM HIGH DENSITY POLYETHYLENE EHMW PIPE</p>																										
DATE	DESCRIPTION																										
DESIGNED: DRK	DRAWN: DRK																										
CHECKED: DRK	CHECKED: DRK																										
HORIZONTAL SCALE	<b>WIM STATION DETAILS</b>																										
Not To Scale																											
VERTICAL SCALE																											
Not To Scale																											