

STAGE I REMOVAL
(Looking North)

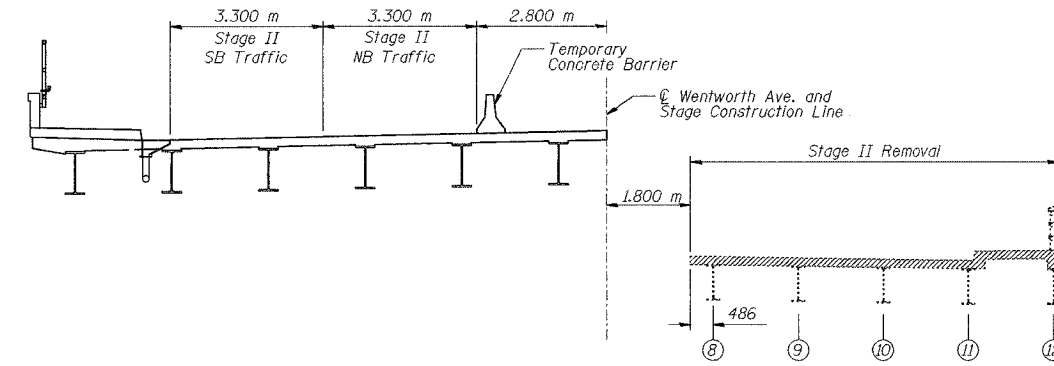

STAGE II REMOVAL
(Looking North)

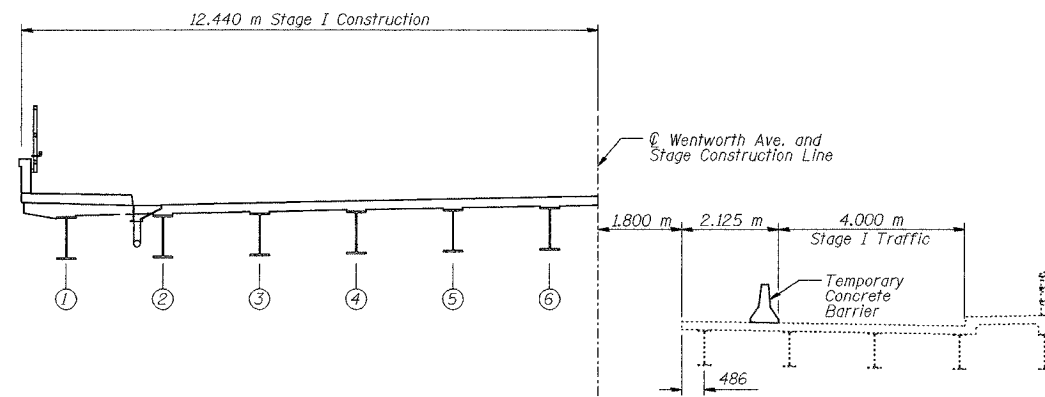

STAGE I CONSTRUCTION
(Looking North)

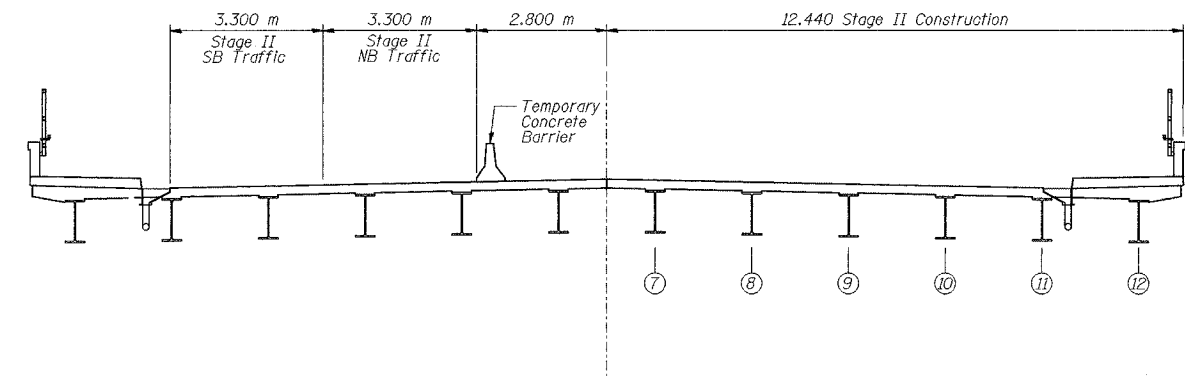

STAGE II CONSTRUCTION
(Looking North)

STAGE I REMOVAL

1. Install temporary concrete barrier as shown.
2. Provide one 4.0 m lane in the northbound direction.
3. Remove the existing deck to the limits shown.
4. Remove existing beams 1 through 7.
5. Install Temporary Soil Retention System and Braced Excavation and remove existing piers, north abutment and south abutment to the limits shown on Sheet S-3.

STAGE I CONSTRUCTION

1. Construct new center pier, north abutment and south abutment.
2. Install new bearings and erect new steel beams 1 through 6.
3. Construct new concrete deck, sidewalks, parapets, handrail and closed drainage system.
4. Install new deck expansion joints at the abutments.

STAGE II REMOVAL

1. Install Temporary Soil Retention System and Braced Excavation to support Stage II traffic to the limits shown on Sheet S-3.
2. Relocate temporary concrete barrier as shown.
3. Provide one 3.3 m lane in each direction.
4. Remove remaining existing concrete deck.
5. Remove existing beams 8 through 12.
6. Remove remaining existing piers, north abutment and south abutment.

STAGE II CONSTRUCTION

1. Construct remaining new center pier, north abutment and south abutment.
2. Install new bearings and erect new steel beams 7 through 12.
3. Construct remaining new concrete deck, sidewalks, parapets, handrail and closed drainage system.
4. Install remaining new deck expansion joints at the abutments.

DESIGNED	BPS
CHECKED	JDG
DRAWN	MJB
CHECKED	JDG

ILLINOIS DEPARTMENT OF TRANSPORTATION
F.A.I. ROUTE 80/94 (KINGERY EXPRESSWAY)
UNDER WENTWORTH AVE
STAGE CONSTRUCTION DETAILS
SUPERSTRUCTURE
SECTION 2626.1B
COOK COUNTY
STATION 7+579.488
STRUCTURE NO. 016-2790
DATE 07/05
AMERICAN
CONSULTING ENGINEERS

FOR INFORMATION ONLY