

F.A.I. RTE.	SECTION	COUNTY	TOTAL SHEETS	SHEET NO.
80/94	2626.2-R-2	COOK	1207	743
STA.	TO STA.			
FED. ROAD DIST. NO.	ILLINOIS	FED. AID PROJECT		

CONTRACT NO. 62114

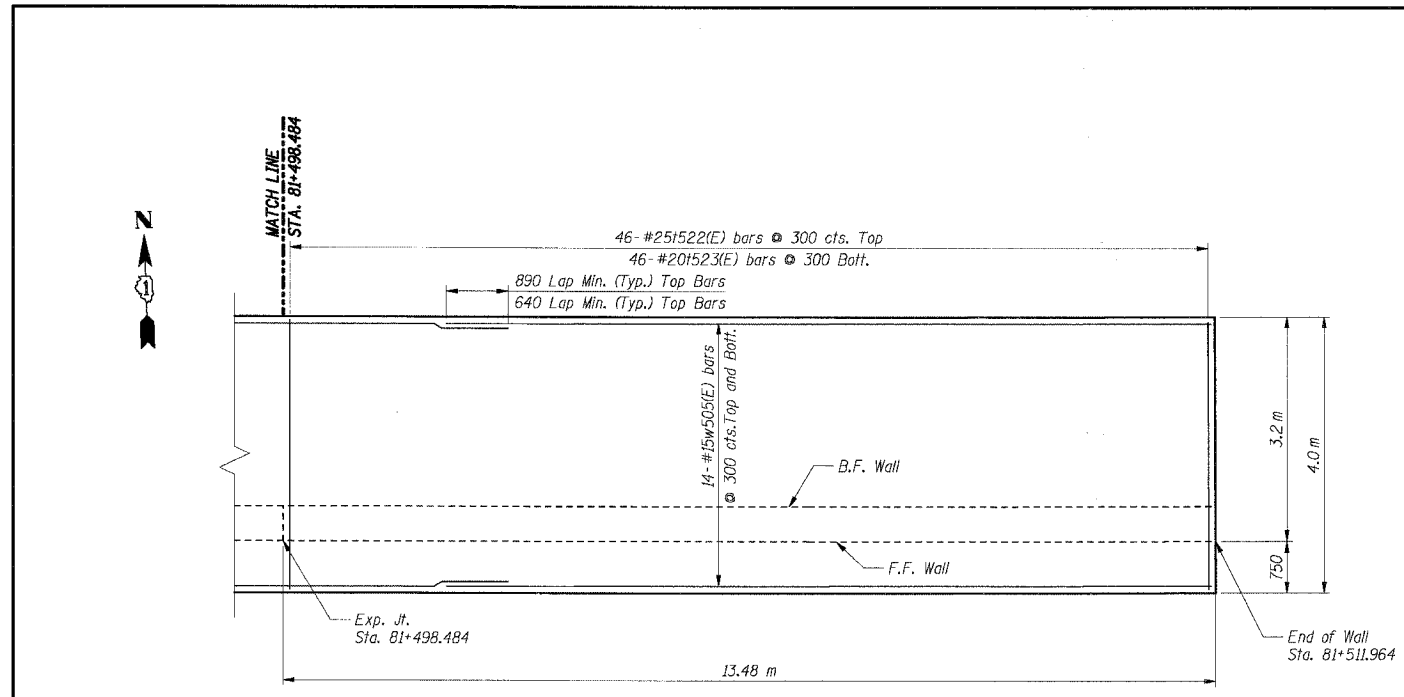

**FOOTING PLAN**

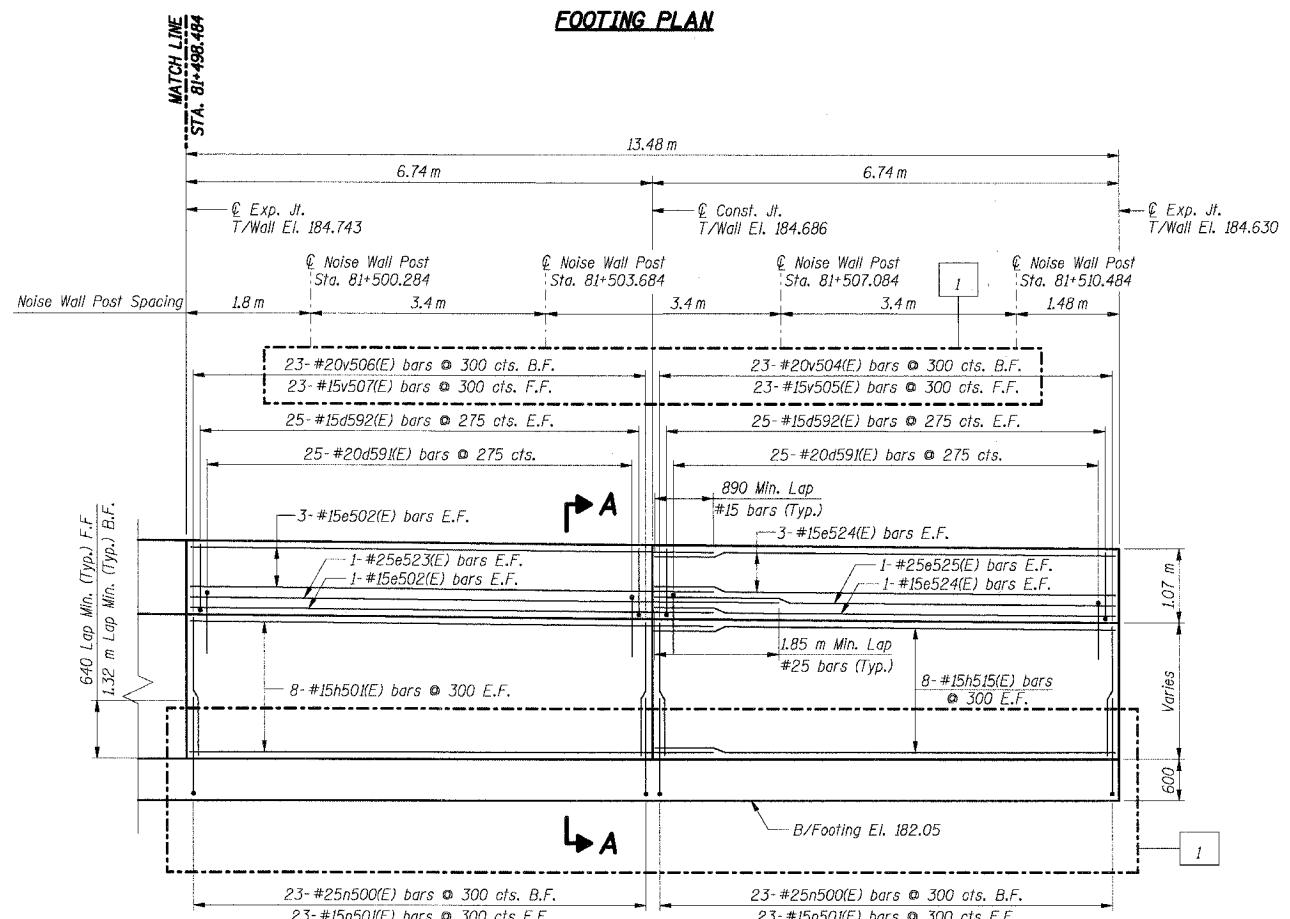

**ELEVATION**

**BAR LIST**

Bar	No.	Size	Length (m)	Shape
d59(E)	50	#20	2.59	U
d592(E)	100	#15	1.22	U
e502(E)	8	#15	7.65	—
e523(E)	2	#25	8.65	—
e524(E)	8	#15	6.75	—
e525(E)	2	#25	6.75	—
h50(E)	16	#15	7.65	—
h515(E)	16	#15	6.75	—
n500(E)	46	#25	2.30	—
n50(E)	46	#15	1.50	—
1522(E)	46	#25	4.40	—
1523(E)	46	#20	3.90	—
v504(E)	23	#20	1.95	—
v505(E)	23	#15	1.95	—
v506(E)	23	#20	2.00	—
v507(E)	23	#15	2.00	—
w505(E)	28	#15	11.50	—

**BILL OF MATERIAL**

Item	Unit	Total
Concrete Structures	Cu m	52.0
Reinforcement Bars, Epoxy Coated	kg	3,760

- Notes:**
- All dimensions are in millimeters (mm) except as noted.
  - Reinforcement bars designated (E) shall be epoxy coated.
  - All edges shall have a 20 mm chamfer unless noted otherwise.
  - For section A-A see Sheet RW835-26.
  - E.F. indicates each face.
  - B.F. indicates back face.
  - F.F. indicates front face.
  - For Noise Abatement Wall pilaster details see sheet RW835-30.
  - For Traffic Barrier details see Sht. RW835-30.
  - For Rustication Finish & joint details see Sht. RW835-32.
  - For Drainage and Reinforcement details see Sht. RW835-31.
  - Maximum Applied Soil Bearing Pressure,  $Q_{max} = 90$  kPa.
  - Bars indicated thus 4x2-#15 etc. indicates 4 lines of bars with 2 lengths per line.

**THIS SHEET FOR INFORMATION ONLY**

SHT. RW835-25 OF 34

REVISIONS	
NAME	DATE
MJK	6/21/04

ILLINOIS DEPARTMENT OF TRANSPORTATION  
 F.A.I. ROUTE 80/94 (KINGERY EXPRESSWAY)  
 IL ROUTE 83 RECONSTRUCTION  
 RETAINING WALL - STRUCTURE NO. 016-W835  
 SECTION 2425 R-3 & 2425-711B  
 COOK COUNTY

**FOOTING PLAN & WALL ELEVATION 21**

DATE: 02/20/2004  
 DRAWN BY: DG  
 CHECKED BY: SC

**TENG**  
 TENG & ASSOCIATES, INC.  
 ENGINEERS/ARCHITECTS/PLANNERS  
 CHICAGO, ILLINOIS

7-11-2005, 1333323  
 T:\DOCUMENT\831750\STRUCT\WORK\831750\21.DWG  
 2,3,4,5,6,7,8,9,10,11,12,13,14,15,16,17,18,19,20,21,22,23,24,25,26,27,28,29,30,31,32,33,34,35,36,37,38,39,40,41,42,43,44,45,46,47,48,49,50,51,52,53,54,55,56,57,58,59,60,61,62,63  
 BALZEK.J.