

F.A.I. RTE.	SECTION	COUNTY	TOTAL SHEETS	SHEET NO.
80/94	2626.2-R-2	COOK	1207	775
STA.	TO STA.			
FED. ROAD DIST. NO.	ILLINOIS	FED. AID PROJECT		

CONTRACT NO. 62114

BILL OF MATERIAL

Bar	No.	Size	Length (m)	Shape
d702(E)	258	#15	1.22	U
d804(E)	77	#15	1.30	U
e700(E)	16	#15	8.39	—
e701(E)	4	#25	9.35	—
e702(E)	8	#15	7.40	—
e703(E)	2	#25	7.40	—
e714(E)	8	#15	5.90	—
e715(E)	2	#25	5.90	—
e718(E)	8	#15	5.71	—
e719(E)	2	#25	5.71	—
e808(E)	33	#15	2.56	—
e812(E)	33	#15	2.20	—
u803(E)	77	#20	2.00	U
Item			Unit	Total
Concrete Structures			Cu m	16.6
Reinforcement Bars, Epoxy Coated			kg	2,010

For Bending Diagrams see Sht. RW850-47.

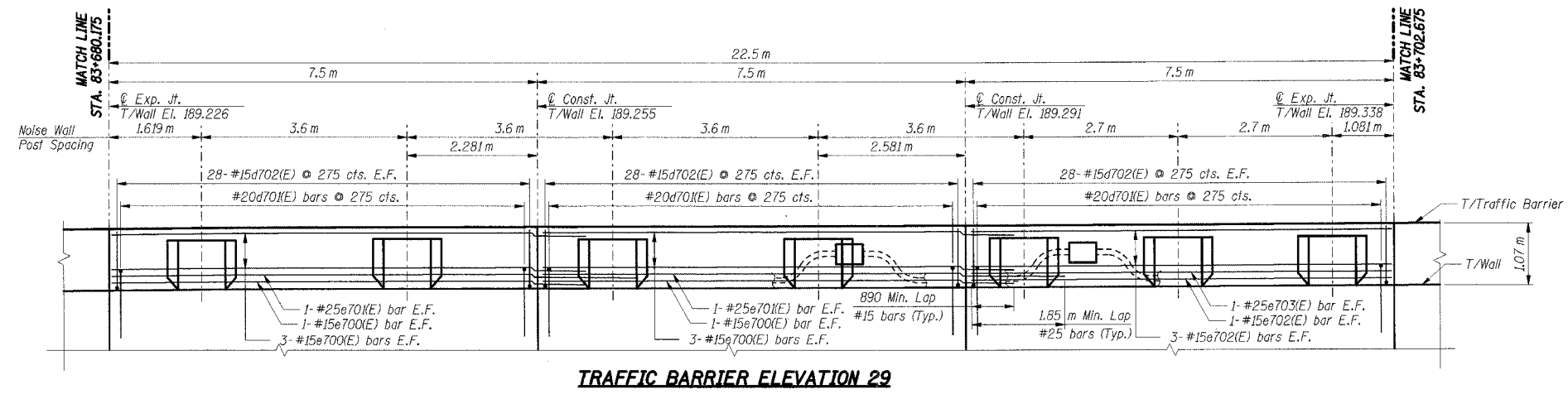

TRAFFIC BARRIER ELEVATION 29

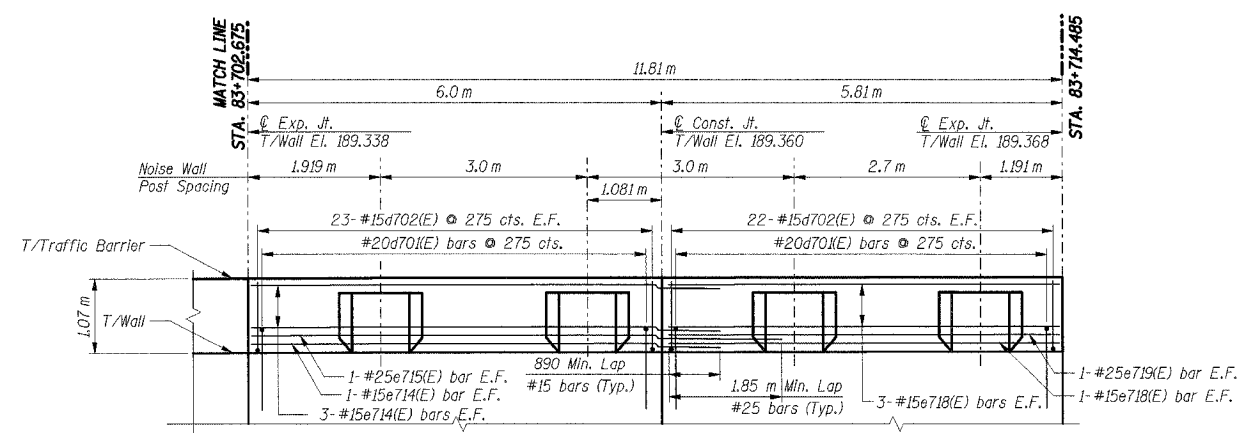

TRAFFIC BARRIER ELEVATION 30

THIS SHEET FOR INFORMATION ONLY

- Notes:**
- All dimensions are in millimeters (mm) except as noted.
 - All dimensions shown are along the front face of the retaining wall.
 - All vertical bars in wall stem and traffic barrier start at 50 mm from construction and expansion joint, U.N.O.
 - Reinforcement bars designated (E) shall be epoxy coated.
 - All edges shall have a 20 mm chamfer unless noted otherwise.
 - E.F. indicates each face, B.F. indicates back face, F.F. indicates front face.
 - For Traffic Barrier details and Noise Wall Pillaster details see Sht. RW850-47.

SHT. RW850-41 OF 58

REVISIONS	
NAME	DATE

*** 2001-167R, (2425 & 2626) R-1 AND (2425 & 2626) R-2
 ILLINOIS DEPARTMENT OF TRANSPORTATION
 F.A.I. ROUTE 80/94 (KINGERY EXPRESSWAY)
 EB & WB INSIDE LANES (MAINLINE) CONSTRUCTION
 RETAINING WALL - STRUCTURE NO. 016-W850
 SECTIONS ***
 COOK COUNTY

TRAFFIC BARRIER ELEVATION V

DATE: 7/18/2005
 DRAWN BY: GS
 CHECKED BY: MK

TENG
 TENG & ASSOCIATES, INC.
 ENGINEERS/ARCHITECTS/PLANNERS
 CHICAGO, ILLINOIS

 6/1/2005, 5:58:39
 I:\DOCUMENT\1071501\STRUCT\1\DCN\850\8024.DGN
 12.3.4.56.78.9.10.11.12.13.14.15.16.17.18.19.20.21.22.23.24.25.26.27.28.29.30.31.32.33.34.35.36.37.38.39.40.41.42.43.44.45.46.47.48.49.50.51.52.53.54.55.56.57.58.59.60.61.62.63