

# RAILROAD CROSSING REPAIR DETOUR SIGNING

## NOTES:

- FOR DETOURS OF UNMARKED ROUTES, SIGNS 5 - 9A SHALL BE MODIFIED TO USE THE M4-9 SIGN SERIES.
- FOR DETOURS OF MARKED ROUTES, THE ORDER OF THE SIGNS SHOWN IN THE SIGN ASSEMBLIES 5 - 9A SHALL BE MODIFIED TO MATCH TYPICAL ASSEMBLY SHOWN BELOW.
- ANY SIGNS THAT ARE TO BE IN PLACE FOR MORE THAN 4 DAYS MUST HAVE A VERTICAL CLEARANCE OF 7 FEET FROM TOP OF PAVEMENT TO THE BOTTOM OF THE SIGN (5 FEET IN RURAL AREAS). THESE SIGNS SHALL BE POST MOUNTED IN THE GROUND WHERE POSSIBLE PER ARTICLE 701.14 OF THE STANDARD SPECIFICATIONS FOR ROAD AND BRIDGE CONSTRUCTION AND HIGHWAY STANDARD 701901.
- FOR FREEWAY/EXPRESSWAY USE - M1-1100 36"x36" USED FOR ILLINOIS ROUTES, M1-4 36"x36" FOR U.S. ROUTES, OR ROAD NAMES SIGN WITH 6" LETTER MINIMUM BLACK LETTERS ON ORANGE BACKGROUND. ADDITIONALLY, USE M3 36" x 18", M4-8 30" x 15", M4-9 48" x 36", M5 30" x 21", and M6 30" x 21" SIGN SIZES.
- REFER TO DISTRICT DETAIL TC-21 FOR TYPICAL SIGN LAYOUT AND SPACING.

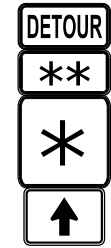

- \*** ILLINOIS M1-1100 24"x24" USED FOR ILLINOIS ROUTES.
- \*** M1-4 24"x24" USED FOR U.S. ROUTES.
- MAIN STREET** CUSTOM ROAD NAME SIGN WITH 5" MINIMUM UPPERCASE BLACK LETTERS ON ORANGE BACKGROUND.
- OR
- Main St** WHEN LOWER CASE LETTERS ARE USED, AS SHOWN, THEY SHALL BE 3/4 OF THE SIZE OF THE UPPER CASE LETTERS.
- FOR FREEWAY/EXPRESSWAY USE - SEE NOTE 4.

- \*\*** NORTH M3-1 24"x12"
- \*\*** SOUTH M3-2 24"x12"
- \*\*** EAST M3-3 24"x12"
- \*\*** WEST M3-4 24"x12"
- CARDINAL DIRECTION SIGNS SHALL BE USED DIRECTLY ABOVE THE ROUTE MARKER.

- 1A W20-3 48"x48"
- 3A W20-2a 48"x48"
- 4 W20-3 48"x48"
- 5 M1-1100 24"x24" (STATE ROUTE)  
M1-4 24"x24" (US ROUTE)  
FOR FREEWAY/EXPRESSWAY USE SEE NOTE 4.  
M4-8 24"x12"  
M5-1L 21"x15"
- 5A M5-2L 21"x15"
- 5B M5-3 21" x 15"
- 6 M1-1100 24"x24" (STATE ROUTE)  
M1-4 24"x24" (US ROUTE)  
FOR FREEWAY/EXPRESSWAY USE SEE NOTE 4.  
M4-8 24"x12"  
M6-1L 21"x15"
- 6A M6-2L 21"x15"
- 7 M1-1100 24"x24" (STATE ROUTE)  
M1-4 24"x24" (US ROUTE)  
FOR FREEWAY/EXPRESSWAY USE SEE NOTE 4.  
M4-8 24"x12"  
M6-3 21"x15"

- 8 M1-1100 24"x24" (STATE ROUTE)  
M1-4 24"x24" (US ROUTE)  
FOR FREEWAY/EXPRESSWAY USE SEE NOTE 4.  
M4-8 24"x12"  
M5-1R 21"x15"
- 8A M5-2R 21"x15"
- 9 M1-1100 24"x24" (STATE ROUTE)  
M1-4 24"x24" (US ROUTE)  
FOR FREEWAY/EXPRESSWAY USE SEE NOTE 4.  
M4-8 24"x12"  
M6-1R 21"x15"
- 9A M6-2R 21"x15"
- 10 R11-3a 60"x30"
- 11 R11-3a 60"x30"
- 12 R11-2 48"x30"
- 13 M4-10R 48"x18"
- 14 M4-10L 48"x18"
- 15 M4-8a 24"x18"

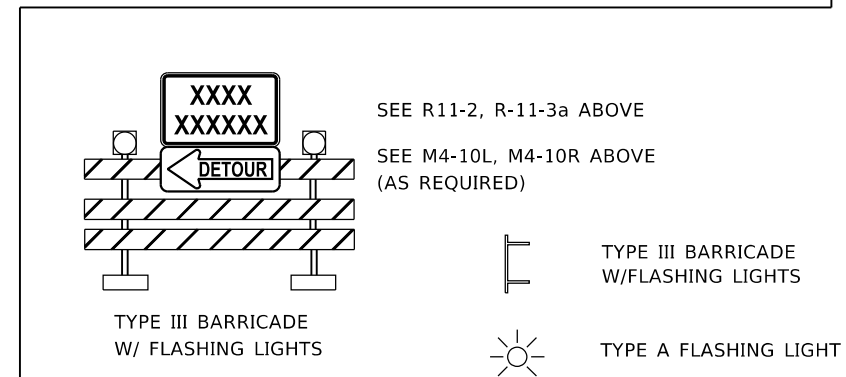
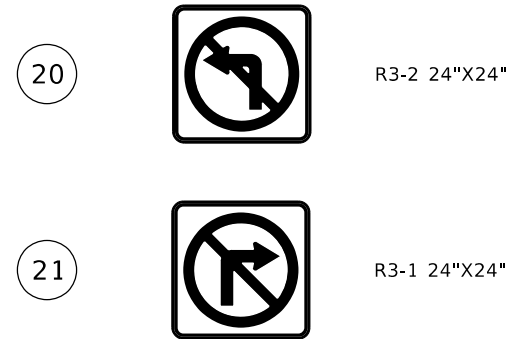
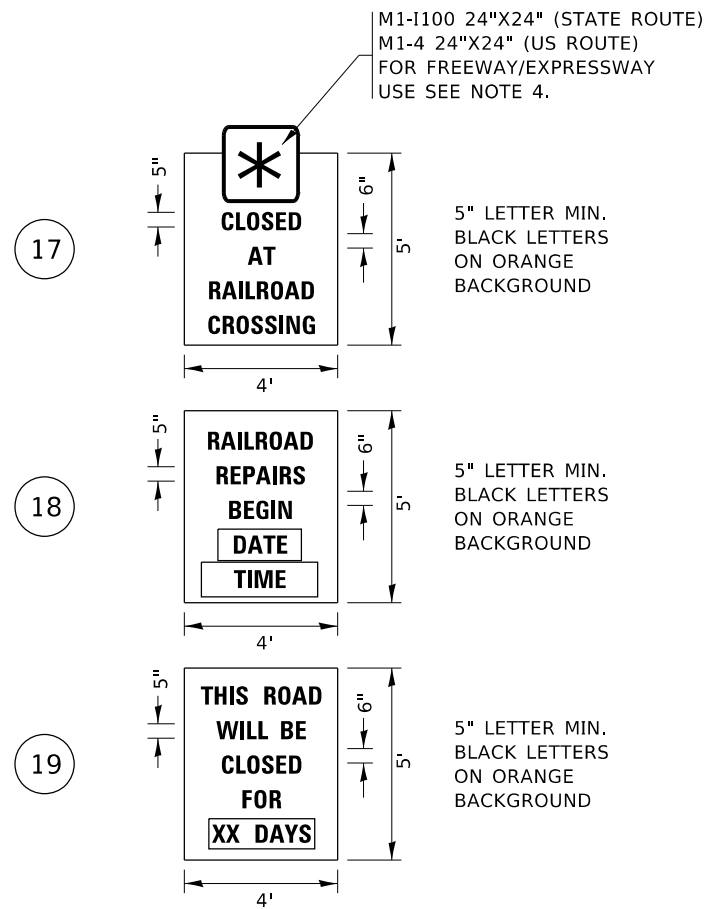

MODEL: Default  
FILE: \\nas01\paw\_bentley.com\PI\DOT\Documents\DOT\_Offices\Dir\et: \\projects\Illinois\2023\23CAD\Drawings\CAD\Project\TC28.dwg

USER NAME = Lawrence,DeManche	DESIGNED -	REVISED - A. SCHUETZE 09-16
	DRAWN -	REVISED - D. SENDERAK 03-05-25
PLOT SCALE = 100.0000' / in.	CHECKED -	REVISED -
PLOT DATE = 3/7/2025	DATE -	REVISED -

STATE OF ILLINOIS  
DEPARTMENT OF TRANSPORTATION

RAILROAD CROSSING REPAIR  
DETOUR SIGNING

SCALE: NONE SHEET 1 OF 1 SHEETS STA. TO STA.

F.A. RTE.	SECTION	COUNTY	TOTAL SHEETS	SHEET NO.
	TC-28			
ILLINOIS			CONTRACT NO.	
FED. AID PROJECT				