

QUANTITY
 4 (100) LINE = 64.1 ft. (19.7 m)
 21.1 sq. ft. (1.97 sq. m)

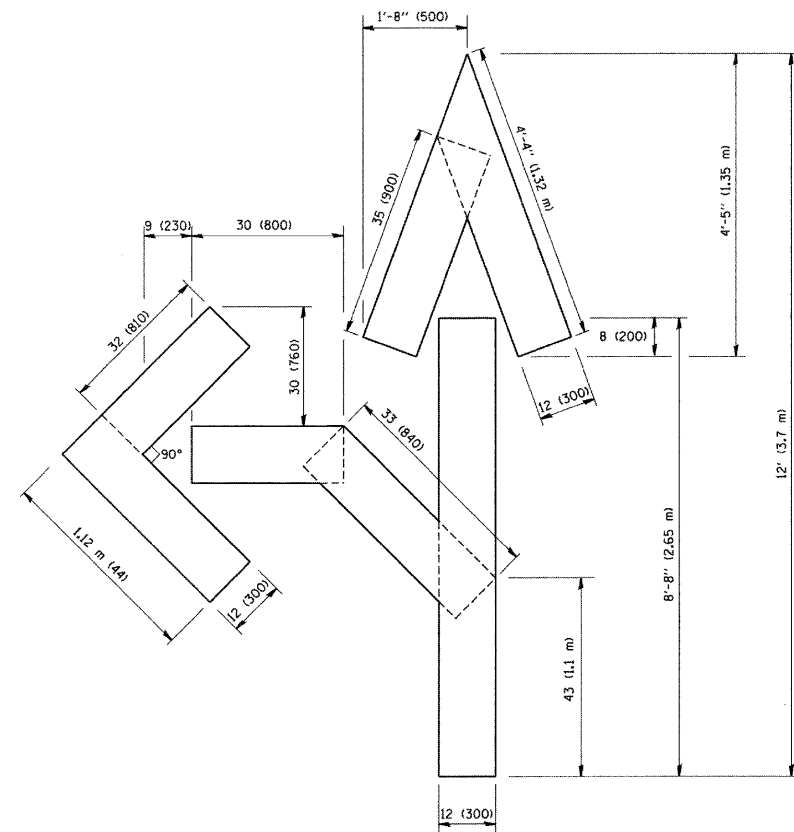

QUANTITY
 4 (100) LINE = 82.5 ft. (25.3 m)
 27.5 sq. ft. (2.53 sq. m)

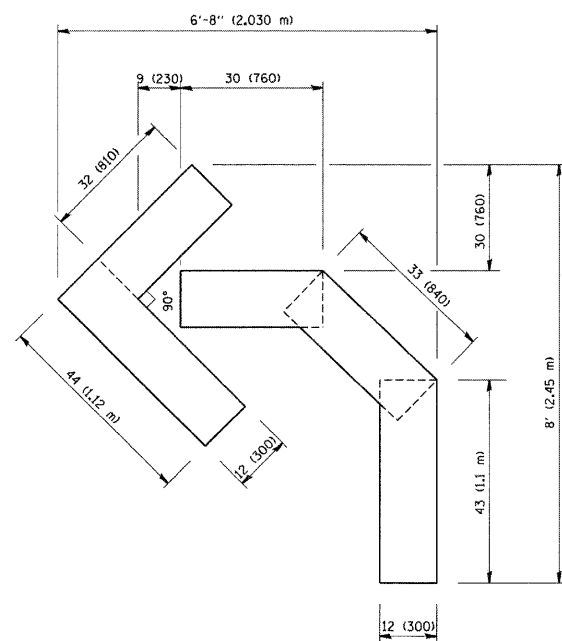

QUANTITY
 4 (100) LINE = 45.5 ft. (13.9 m)
 15.2 sq. ft. (1.39 sq. m)

All dimensions are in Inches (millimeters) unless otherwise shown.

DISTRICT ONE TYPICAL PAVEMENT MARKINGS

REVISIONS	
NAME	DATE
T. RAMMACHER	05/18/94
J. OBERLE	06/01/98
T. RAMMACHER	06/05/98
T. RAMMACHER	11/04/97
T. RAMMACHER	03/02/98
E. GOMEZ	08/28/00

LOCO, INC.
 CONSULTING ENGINEERS
 1560 WALL ST., SUITE 222
 NAPERVILLE, ILLINOIS 60563 PH 16301 577-9100

DESIGNED - MJY	REVISED -
DRAWN - ST, TSC	REVISED -
CHECKED - MJY, DC	REVISED -
DATE - 08/20/2009	REVISED -

STATE OF ILLINOIS
 DEPARTMENT OF TRANSPORTATION

DISTRICT ONE DETAIL SHEETS
 IL ROUTE 176 (ROCKLAND AVE) OVER US ROUTE 41 (SKOKIE HWY)

SCALE: NONE SHEET NO. 6 OF 7 SHEETS STA. 99+20 TO STA. 102+90

F.A.I. RTE.	SECTION	COUNTY	TOTAL SHEETS	SHEET NO.
1238	125SB-1-R	LAKE	38	37
D-91-045-08			CONTRACT NO. 60D57	
FED. ROAD DIST. NO.		ILLINOIS FED. AID PROJECT		