

FOR INDEX OF SHEETS, SEE SHEET NO. 2.

TRAFFIC DATA

ADT = 151,000 VEHICLES (I-290)
 ADT = 165,600 VEHICLES (I-355)
 POSTED SPEED LIMIT = 55 MPH

PROJECT LOCATED IN THE
 CITY OF ELMHURST,
 VILLAGE OF ADDISON
 AND VILLAGE OF ITASCA

STRUCTURE LOCATIONS

- I-355 OVER US 20 (LAKE ST)
SN 022-0112 (NB)
SN 022-0111 (SB)
- I-355 OVER IL 53 (ROHLWING RD)
SN 022-0137 (NB)
SN 022-0138 (SB)
- I-290 EB OVER I-355
SN 022-0092
- I-290 WB OVER I-290 EB & I-355
SN 022-0094
- I-290 OVER ADDISON RD
SN 022-0104 (EB)
SN 022-0095 (WB)
- I-290 OVER WOOD DALE RD
SN 022-0105 (EB)
SN 022-0100 (WB)
- I-290 OVER IL 83 (KINGERY HWY)
SN 022-0096 (EB)
SN 022-0097 (WB)
- I-290 OVER GRAND AVE
SN 022-0102 (EB)
SN 022-0101 (WB)
- I-290 OVER CHURCH RD
SN 022-0099 (EB)
SN 022-0098 (WB)

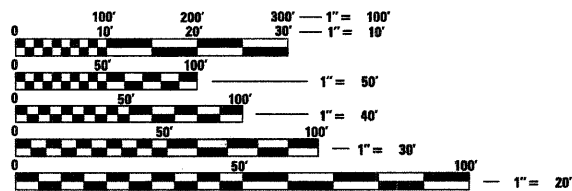

FULL SIZE PLANS HAVE BEEN PREPARED USING STANDARD ENGINEERING SCALES. REDUCED SIZED PLANS WILL NOT CONFORM TO STANDARD SCALES. IN MAKING MEASUREMENTS ON REDUCED PLANS, THE ABOVE SCALES MAY BE USED.

J.U.L.I.E.
 JOINT UTILITY LOCATION INFORMATION FOR EXCAVATION
 1-800-892-0123
 OR 811

PROJECT ENGINEER: CRAIG BAUER (847) 705-4265
 PROJECT MANAGER: LONG TRAN (847) 705-4232

CONTRACT NO. 60G51

STATE OF ILLINOIS
 DEPARTMENT OF TRANSPORTATION

DIVISION OF HIGHWAYS

**PROPOSED
 HIGHWAY PLANS**

FAI-290 (EISENHOWER EXPRESSWAY) &
 FAI-355 (NORTH-SOUTH TOLLWAY)

SECTION 22(1, 1-1, 2&3)RS-7

PROJECT: ACIM-0005(694)

I-290 FROM THORNDALE AVE. TO EAST OF CHURCH RD.
 I-355 FROM ARMY TRAIL RD. TO I-290
 RESURFACING AND ROADWAY AND STRUCTURE REPAIRS
 DUPAGE COUNTY
 C-91-492-09

NOTE: WHEREVER IN THESE PLANS TOTAL SHEETS-546 IS REFERENCED IT SHALL MEAN 661.

F.A.I. RTE.	SECTION	COUNTY	TOTAL SHEETS	SHEET NO.
*	22(1, 1-1, 2&3)RS-7	DUPAGE	661	1
FED. ROAD DIST. NO.	ILLINOIS	CONTRACT NO.	60G51	
			* 290, 355	

D-91-341-09

* 661 + 15 = 676
 * 676 + 1 = 677

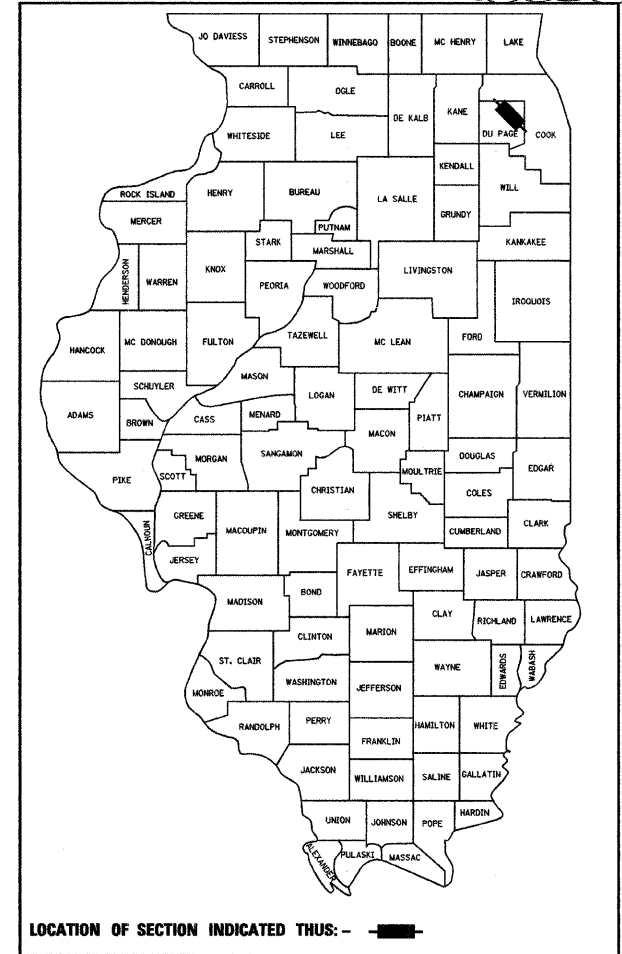

LOCATION OF SECTION INDICATED THUS: - [rectangle] -

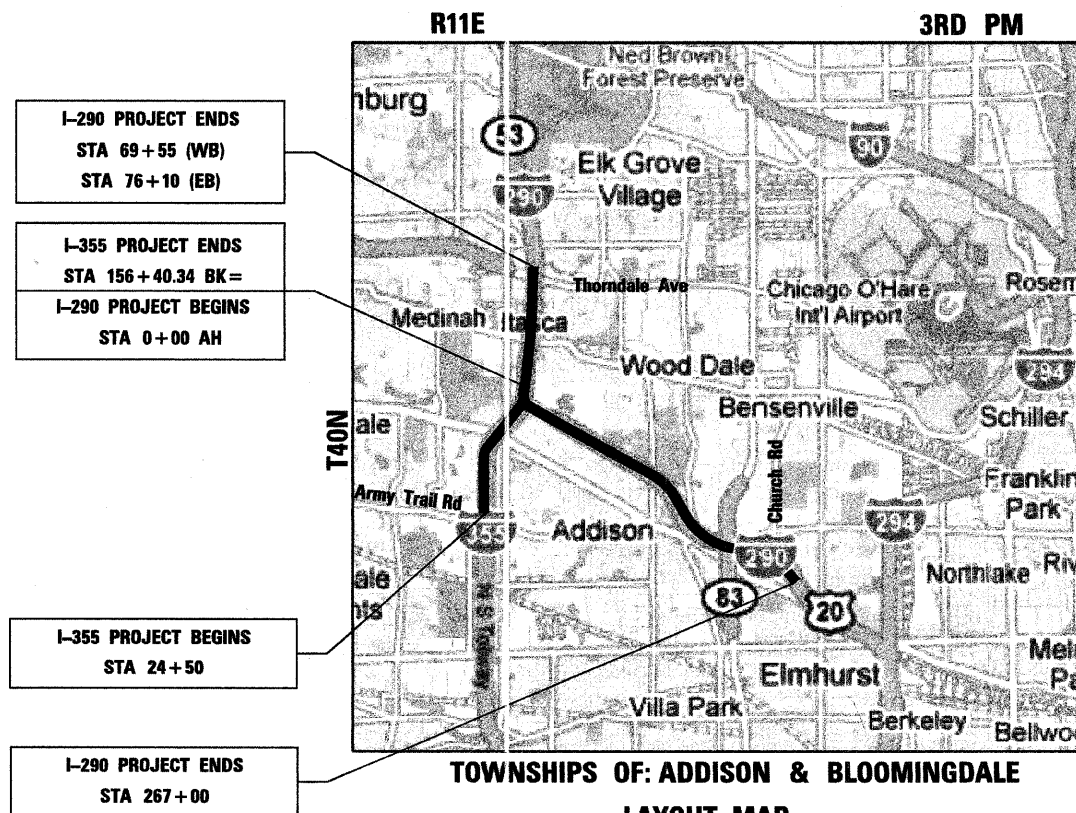

- I-290 PROJECT ENDS
STA 69+55 (WB)
STA 76+10 (EB)
- I-355 PROJECT ENDS
STA 156+40.34 BK=
I-290 PROJECT BEGINS
STA 0+00 AH
- I-355 PROJECT BEGINS
STA 24+50
- I-290 PROJECT ENDS
STA 267+00

TOWNSHIPS OF: ADDISON & BLOOMINGDALE

LAYOUT MAP

SCALE: 1 IN = 1.5 MI

GROSS LENGTH OF PROJECT = 47,500 LIN FT = 9.00 MILES
 NET LENGTH OF I-290 = 34,310 LIN FT = 6.50 MILES
 NET LENGTH OF I-355 = 13,190 LIN FT = 2.50 MILES

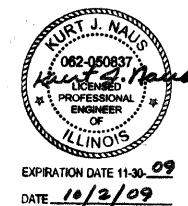

STATE OF ILLINOIS
 DEPARTMENT OF TRANSPORTATION
 DIVISION OF HIGHWAYS

SUBMITTED October 7, 2009

Diana M. O'Keefe DEPUTY DIRECTOR OF HIGHWAYS, REGION ENGINEER
December 4, 2009

Charles D. Ingersoll ENGINEER OF DESIGN AND ENVIRONMENT
December 4, 2009

Christine M. Reed DIRECTOR OF HIGHWAYS, CHIEF ENGINEER

PRINTED BY THE AUTHORITY
 OF THE STATE OF ILLINOIS

benesch
 alfred benesch & company
 Engineers • Surveyors • Planners
 205 North Michigan Avenue, Suite 2400
 Chicago, Illinois 60601
 312-565-0450

SPECIALTY ITEM	CODE NUMBER	ITEM	UNIT	TOTAL QUANTITY	CONSTRUCTION TYPE CODE			
					ROADWAY	SURVEILLANCE	BRIDGE SN 022-0101 SN 022-0102	BRIDGE (See Note A)
					90% FED 10% STATE	90% FED 10% STATE	90% FED 10% STATE	90% FED 10% STATE
			URBAN					
					1000-2A	Y032-1F	X271-2A	X271-2A
**	25000400	NITROGEN FERTILIZER NUTRIENT	POUND	41	41			
	20101500	PHOSPHORUS FERTILIZER NUTRIENT	POUND	41	41			
**	25000500	PHOSPHORUS FERTILIZER NUTRIENT	POUND	18	18			
	20101600	POTASSIUM FERTILIZER NUTRIENT	POUND	41	41			
**	25000600	POTASSIUM FERTILIZER NUTRIENT	POUND	18	18			
	20700220	POROUS GRANULAR EMBANKMENT	CU YD	313				313
	20700400	POROUS GRANULAR EMBANKMENT, SPECIAL	CU YD	132				132
	21101605	TOPSOIL EXCAVATION AND PLACEMENT	CU YD	371	371			
	25000350	SEEDING, CLASS 7	ACRE	0.5	0.5			
	25000210	SEEDING, CLASS 2A	ACRE	0.5	0.5			
	25100115	MULCH, METHOD 2	ACRE	1	1			
**	25001800	SEEDING, CLASS 4 (MODIFIED)	ACRE	0.7	0.7			
**	25100630	EROSION CONTROL BLANKET	SQ YD	4540	4540			
**	20100110	TREE REMOVAL (6 TO 15 UNITS DIAMETER)	UNIT	1440	1440			
	28000400	PERIMETER EROSION BARRIER	FOOT	1,100	1,100			
**	20100210	TREE REMOVAL (OVER 15 UNITS DIAMETER)	UNIT	480	480			
	28000510	INLET FILTERS	EACH	25	25			
**	20101300	TREE PRUNING (1 TO 10 INCH DIAMETER)	EACH	48	48			
	40600200	BITUMINOUS MATERIALS (PRIME COAT)	TON	545	545			
	40600300	AGGREGATE (PRIME COAT)	TON	2,723	2,723			
	40600400	MIXTURE FOR CRACKS, JOINTS, AND FLANGWAYS	TON	1,021	1,021			
**	21101625	TOPSOIL FURNISH AND PLACE, 6"	SQ YD	4540	4540			
	40600895	CONSTRUCTING TEST STRIP	EACH	2	2			
**	44003800	MEDIAN SURFACE REMOVAL	SQ FT	40,850	40,850			
	40600982	HOT-MIX ASPHALT SURFACE REMOVAL - BUTT JOINT	SQ YD	5,200	5,200			
**	20101350	TREE PRUNING (OVER 10 INCH DIAMETER)	EACH	48	48			
	40600985	PORTLAND CEMENT CONCRETE SURFACE REMOVAL - BUTT JOINT	SQ YD	1,500	1,500			
	40601005	HOT-MIX ASPHALT REPLACEMENT OVER PATCHES	TON	7,453	7,453			
	40603085	HOT-MIX ASPHALT BINDER COURSE, IL-19.0, N70	TON	29,597	29,597			
	40603340	HOT-MIX ASPHALT SURFACE COURSE, MIX "D", N70	TON	19,729	19,729			
	42001200	PAVEMENT FABRIC	SQ YD	226	226			
	42001300	PROTECTIVE COAT	SQ YD	253	253			
	42001420	BRIDGE APPROACH PAVEMENT CONNECTOR (PCC)	SQ YD	2,408	2,408			
	42001500	P.C. CONCRETE BRIDGE APPROACH SHOULDER PAVEMENT	SQ YD	23	23			
	42100800	PAVEMENT REINFORCEMENT 9"	SQ YD	2,408	2,408			
	44000162	HOT-MIX ASPHALT SURFACE REMOVAL, 3 1/4"	SQ YD	65,662	65,662			
	44000164	HOT-MIX ASPHALT SURFACE REMOVAL, 3 3/4"	SQ YD	193,845	193,845			
	44000165	HOT-MIX ASPHALT SURFACE REMOVAL, 4"	SQ YD	421,135	421,135			
	44000500	COMBINATION CURB AND GUTTER REMOVAL	FOOT	400	400			
	44000700	APPROACH SLAB REMOVAL	SQ YD	4,641	4,641			
	44001980	CONCRETE BARRIER REMOVAL	FOOT	412.5	412.5			
	44200553	CLASS A PATCHES, TYPE II, 10 INCH	SQ YD	334	334			
	44002920	CONCRETE-MEDIAN SURFACE REMOVAL	SQ FT	30,300	30,300			
	44002213	HOT-MIX ASPHALT REMOVAL OVER PATCHES, 3 1/4"	SQ YD	339	339			
	44002216	HOT-MIX ASPHALT REMOVAL OVER PATCHES, 4"	SQ YD	11,155	11,155			
	44200557	CLASS A PATCHES, TYPE III, 10 INCH	SQ YD	132	132			
	44002218	HOT-MIX ASPHALT REMOVAL OVER PATCHES, 4 1/2"	SQ YD	19,416	19,416			
⚠	44200557	CLASS A PATCHES, TYPE I, 9 INCH	SQ YD	187	187			
⚠	44200577	CLASS A PATCHES, TYPE II, 12 INCH	SQ YD	46	46			
⚠	44200541	CLASS A PATCHES, TYPE III, 9 INCH	SQ YD	20	20			
⚠	44200581	CLASS A PATCHES, TYPE III, 12 INCH	SQ YD	20	20			
⚠	44200543	CLASS A PATCHES, TYPE III, 9 INCH	SQ YD	187	187			
⚠	44200583	CLASS A PATCHES, TYPE IV, 12 INCH	SQ YD	187	187			
⚠	44200572	CLASS A PATCHES, TYPE IV, 9 INCH	SQ YD	234	234			
	44201740	CLASS D PATCHES, TYPE I, 9 INCH	SQ YD	234	234			
	44200549	CLASS A PATCHES, TYPE I, 10 INCH	SQ YD	335	335			
	44201763	CLASS D PATCHES, TYPE II, 9 INCH	SQ YD	6,026	6,026			

** FOR LOCATIONS AND EXTENT OF WORK NOT SHOWN IN THE PLANS, THE CONTRACTOR SHALL COORDINATE WITH THE ENGINEER AND CONTACT RICK WANNEE, ROADSIDE DEVELOPMENT ARCHITECT, IDOT ROADSIDE DEVELOPMENT UNIT AT (847) 705-4172 AT LEAST 72 HOURS PRIOR TO STARTING WORK.

NOTE A: SN 022-0092, SN 022-0194, SN 022-0095, SN 022-0096, SN 022-0097, SN 022-0098, SN 022-0099, SN 022-0100, SN 022-0104, SN 022-0105, SN 022-0111, SN 022-0112, SN 022-0137, SN 022-0138

FILE NAME =	DESIGNED - AJP	REVISED -	benesch	STATE OF ILLINOIS DEPARTMENT OF TRANSPORTATION	SUMMARY OF QUANTITIES				F.A.I. RTE.	SECTION	COUNTY	TOTAL SHEETS	SHEET NO.		
#FILEL#	DRAWN - TMB	REVISED -							*	2211, 1-1, 2&3RS-7	DUPAGE	546	3		
USER NAME = #USER#	CHECKED - JMM	REVISED -							*290,355		CONTRACT NO. 60G51				
PLOT DATE = #DATE#	DATE - 10/16/09	REVISED -							SCALE: N.T.S.	SHEET NO. 1	OF 4 SHEETS	STA.	TO STA.	FED. ROAD DIST. NO.	ILLINOIS FED. AID PROJECT
Rev. 1-8-10															

SPECIALTY ITEM	CODE NUMBER	ITEM	UNIT	TOTAL QUANTITY	CONSTRUCTION TYPE CODE			
					ROADWAY	SURVEILLANCE	BRIDGE SN 022-0101 SN 022-0102	BRIDGE (See Note A)
					90% FED 10% STATE	90% FED 10% STATE	90% FED 10% STATE	90% FED 10% STATE
			URBAN					
					1000-2A	Y032-1F	X211-2A	X271-2A
	44204757	CLASS D PATCHES, TYPE III, 9 INCH	SQ YD	1,600	1,600			
	44201761	CLASS D PATCHES, TYPE I, 10 INCH	SQ YD	34	34			
	44204758	CLASS D PATCHES, TYPE IV, 9 INCH	SQ YD	23,628	23,628			
	44201765	CLASS D PATCHES, TYPE II, 10 INCH	SQ YD	102	102			
	44213000	PATCHING REINFORCEMENT	SQ YD	1082	1082			
	44201769	CLASS D PATCHES, TYPE III, 10 INCH	SQ YD	102	102			
	44213200	SAW CUTS	FOOT	582	582			
	44201771	CLASS D PATCHES, TYPE IV, 10 INCH	SQ YD	102	102			
	44300900	STRIP REFLECTIVE CRACK CONTROL TREATMENT SYSTEM IA	FOOT	408,870	408,870			
	44201779	CLASS D PATCHES, TYPE I, 9 INCH	SQ YD	231	231			
	48203037	HOT MIX ASPHALT SHOULDERS, 10"	SQ YD	23,065	23,065			
	44201753	CLASS D PATCHES, TYPE II, 9 INCH	SQ YD	3,972	3,972			
	50102400	CONCRETE REMOVAL	CU YD	469.0		58.8	410.2	
	44201757	CLASS D PATCHES, TYPE III, 9 INCH	SQ YD	1,332	1,332			
	50104650	SLOPE WALL REMOVAL	SQ YD	224			224	
	44201759	CLASS D PATCHES, TYPE IV, 9 INCH	SQ YD	23,628	23,628			
	50157300	PROTECTIVE SHIELD	SQ YD	21,739		2,136	19,603	
	50200100	STRUCTURE EXCAVATION	CU YD	1,970			1,970	
	50300225	CONCRETE STRUCTURES	CU YD	276.2		0.4	275.8	
	50300255	CONCRETE SUPERSTRUCTURE	CU YD	1540.7		58.8	1490.3	
	50300280	BRIDGE DECK GROOVING	SQ YD	31,946		2,714	29,232	
	50300300	PROTECTIVE COAT	SQ YD	34,775		2,921	31,854	
	50501110	STRUCTURAL STEEL REMOVAL	POUND	7,910			7,910	
	50800205	REINFORCEMENT BARS, EPOXY COATED	POUND	363,740		10,570	353,170	
	50800515	BAR SPLICERS	EACH	1,804		144	1,660	
	51100100	SLOPE WALL 4 INCH	SQ YD	224			224	
	51205200	TEMPORARY SHEET PILING	SQ FT	2,068			2,068	
	52000110	PERFORMED JOINT STRIP SEAL	FOOT	2,239.5		275.5	1,964	
	54213447	END SECTIONS 12"	EACH	9	9			
	55039700	STORM SEWERS TO BE CLEANED	FOOT	600	600			
	58700300	CONCRETE SEALER	SQ FT	71,231		10,178	61,053	
	59100100	GEOCOMPOSITE WALL DRAIN	SQ YD	726			726	
	60100945	PIPE DRAINS 12"	FOOT	345	345			
	60109580	PIPE UNDERDRAINS FOR STRUCTURES 4"	FOOT	932			932	
	60208210	CATCH BASINS, TYPE C, TYPE 20 FRAME AND GRATE	EACH	2	2			
	60300205	FRAMES AND GRATINGS TO BE ADJUSTED (SPECIAL)	EACH	123	123			
	60247160	DRAINAGE STRUCTURES, TYPE I WITH TWO TYPE 20 FRAMES AND GRATINGS	EACH	1	1			
	60300310	FRAMES AND LIDS TO BE ADJUSTED (SPECIAL)	EACH	123	123			
	60500050	REMOVING CATCH BASINS	EACH	2	2			
	60605000	COMBINATION CURB AND GUTTER, TYPE B-6.24	FOOT	400	400			
	60500060	REMOVING INLETS	EACH	11	11			
	63000001	STEEL PLATE BEAM GUARD RAIL, TYPE A, 6 FOOT POSTS	FOOT	425	425			
	63300230	REMOVAL AND REINSTALLATION OF EXISTING STEEL PLATE BEAM GUARD RAIL ATTACHED TO STRUCTURES	FOOT	125	125			
	63000005	STEEL PLATE BEAM GUARD RAIL, TYPE B	FOOT	125	125			
	60900115	TYPE B INLET BOX, STANDARD 609001	EACH	3	3			
	63200305	STEEL PLATE BEAM GUARD RAIL REMOVAL	FOOT	550	550			
	60900215	TYPE C INLET BOX, STANDARD 609001	EACH	3	3			
	64200105	SHOULDER RUMBLE STRIP	FOOT	153,458	153,458			
	60900330	TYPE D INLET BOX, STANDARD 609001	EACH	6	6			
	67100100	MOBILIZATION	L SUM	1	1			
	60900515	CONCRETE THRUST BLOCKS	EACH	9	9			
	70106800	CHANGEABLE MESSAGE SIGN	CAL MO	48	48			
	70102550	TRAFFIC CONTROL AND PROTECTION FOR TEMPORARY DETOUR	EACH	6	6			
	70300220	TEMPORARY PAVEMENT MARKING - LINE 4	FOOT	180,768	180,768			
	70300230	TEMPORARY PAVEMENT MARKING - LINE 5	FOOT	41,600	41,600			
	70300240	TEMPORARY PAVEMENT MARKING - LINE 6	FOOT	41,470	41,470			

* Specialty Items
 Δ - Non-participating

NOTE A: SN 022-0092, SN 022-0194, SN 022-0095, SN 022-0096, SN 022-0097, SN 022-0098, SN 022-0099, SN 022-0100, SN 022-0104, SN 022-0105, SN 022-0111, SN 022-0112, SN 022-0137, SN 022-0138

Rev. 1-8-10

FILE NAME =	DESIGNED - AJP	REVISED -		STATE OF ILLINOIS DEPARTMENT OF TRANSPORTATION	SUMMARY OF QUANTITIES			F.A.I. RTE.	SECTION	COUNTY	TOTAL SHEETS	SHEET NO.
#FILE#	DRAWN - TMB	REVISED -			SCALE: N.T.S.	SHEET NO. 2 OF 4 SHEETS	STA.	TO STA.	220, 1-1, 2&3RS-7	DUPAGE	546	4
USER NAME = #USER#	CHECKED - JMM	REVISED -						*290,355		CONTRACT NO. 60G51		
PLOT DATE = #DATE#	DATE - 10/16/09	REVISED -						ILLINOIS FED. AID PROJECT				

Rev.

SPECIALTY ITEM	CODE NUMBER	ITEM	UNIT	TOTAL QUANTITY	ROADWAY		SURVEILLANCE		BRIDGE SN 022-0101 SN 022-0102		BRIDGE (See Note A)	
					90% FED 10% STATE	90% FED 10% STATE	90% FED 10% STATE	90% FED 10% STATE	90% FED 10% STATE	90% FED 10% STATE		
					CONSTRUCTION TYPE CODE							
	X0325822	CONCRETE BARRIER WALL REMOVAL AND REPLACEMENT (PARTIAL DEPTH REPAIR)	FOOT	8	8							
	X0325842	WET REFLECTIVE TEMPORARY TAPE, TYPE III, LETTERS AND SYMBOLS	SQ FT	1,634	1,634							
	X0325840	WET REFLECTIVE TEMPORARY TAPE TYPE III, 12 INCH	FOOT	8,119	8,119							
	X0325876	WET REFLECTIVE TEMPORARY TAPE, TYPE III, 8 INCH	FOOT	67,276	67,276							
	X0326090	ERECTING STRUCTURAL STEEL	POUND	9,260								9,260
	X0326107	WET REFLECTIVE TEMPORARY TAPE, TYPE III, 5 INCH	FOOT	41,690	41,690							
	X4066580	POLYMERIZED HOT-MIX ASPHALT SURFACE COURSE, STONE MATRIX ASPHALT, N80	TON	60,176	60,176							
	X4066685	POLYMERIZED HOT-MIX ASPHALT BINDER COURSE, STONE MATRIX ASPHALT, N80	TON	49,923	49,923							
	X7011015	TRAFFIC CONTROL AND PROTECTION (EXPRESSWAYS)	L SUM	1	1							
	X7013820	TRAFFIC CONTROL SURVEILLANCE, EXPRESSWAYS	CAL DA	149	149							
*	X8730312	ELECTRIC CABLE IN CONDUIT, LEAD-IN, NO. 18 4/C, TWISTED, SHIELDED	FOOT	11,546			11,546					
*	X8850102	INDUCTION LOOP	FOOT	3,139			3,139					
	Z0001800	APPROACH SLAB REPAIR (PARTIAL DEPTH)	SQ YD	99.6				28.3				71.3
	Z0003600	BEAM STRAIGHTENING	L SUM	1	1							
	Z0006220	BRIDGE DECK HYDRO-SCARIFICATION 2 1/4"	SQ YD	21,341				2,792				18,549
	Z0006225	BRIDGE DECK HYDRO-SCARIFICATION 2 1/2"	SQ YD	8,121								8,121
**	* X0322059	WEED CONTROL, PRE-EMERGENT GRANULAR HERBICIDE	POUND	10	10							
	Z0013798	CONSTRUCTION LAYOUT	L SUM	1	1							
**	* X0036120	MULCH PLACEMENT 4"	SQ YD	3600	3600							
	Z0016001	DECK SLAB REPAIR (FULL DEPTH, TYPE I)	SQ YD	370.0				39.8				330.2
**	X2010300	TREE REMOVAL (UNDER 6 UNITS DIAMETER)	UNIT	960	960							
	Z0016002	DECK SLAB REPAIR (FULL DEPTH, TYPE II)	SQ YD	894.0				55.2				838.8
**	Z0004800	SELECTIVE CLEARING	UNIT	600	600							
Δ	Z0018500	DRAINAGE STRUCTURES TO BE CLEANED	EACH	25	25							
**	* X0325222	WEED CONTROL, BASAL TREATMENT	GALLON	60	60							
	Z0018600	DRAINAGE STRUCTURES TO BE RECONSTRUCTED	EACH	8	8							
	Z0018700	DRAINAGE STRUCTURE TO BE REMOVED	EACH	1	1							
	Z0030250	IMPACT ATTENUATORS, TEMPORARY (NON-REDIRECTIVE) TEST LEVEL 3	EACH	12	12							
**	* X0322856	WEED CONTROL, NON-SELECTIVE AND NON-RESIDUAL	GALLON	2.4	2.4							
	Z0030260	IMPACT ATTENUATORS, TEMPORARY (FULLY REDIRECTIVE, NARROW), TEST LEVEL 3	EACH	5	5							
**	* X003660	MOWING CYCLES	EACH	2	2							
	Z0030270	IMPACT ATTENUATORS, TEMPORARY (FULLY REDIRECTIVE, WIDE), TEST LEVEL 3	EACH	2	2							
	Z0030330	IMPACT ATTENUATORS, RELOCATE (FULLY REDIRECTIVE), TEST LEVEL 3	EACH	5	5							
	Z0048685	RAILROAD PROTECTIVE LIABILITY INSURANCE	L SUM	1	1							
	Z0030350	IMPACT ATTENUATORS, RELOCATE (NON-REDIRECTIVE), TEST LEVEL 3	EACH	16	16							
	Z0073200	TEMPORARY SHORING CRIBBING	EACH	6	6							6
**	* X0326701	WEED CONTROL AND BROADLEAF IN TURF	POUND	1.4	1.4							
	Z0073351	TEMPORARY SLAB SUPPORT SYSTEM	L SUM	1	1							1
**	* A201212	TREE, AESCULUS AUTUMN SPLENDOR (AUTUMN SPLENDOR BUCKEYE) 1 3/4" CALIPER, BALLED AND BURLAPPED, MATCHING HEADS	EACH	25	25							32
	Z0073400	TEMPORARY SUPPORT SYSTEM	EACH	32	32							
	Z0075810	TIE BARS 3/4"	EACH	47	47							
	X0326768	CONDUIT IN TRENCH, HIGH DENSITY POLYETHYLENE, COIL ABLE	FOOT	100			100					
	X0326818	CONCRETE BARRIER REMOVAL AND REPLACEMENT SINGLE FACE	FOOT	100	100							
	X0326791	NOISE ABATEMENT WALL REPAIRS	L SUM	1	1							
	X0326819	CONCRETE BARRIER REMOVAL AND REPLACEMENT DOUBLE FACE	FOOT	230	230							
	X0326792	BRIDGE DECK LATEX CONCRETE OVERLAY, 2 3/4 INCHES	SQ YD	1,297								1,297
**	* A2002614	TREE, CARYA CORDIFORNIS (BITTERNUT HICKORY), 1 3/4" CALIPER, BALLED AND BURLAPPED	EACH	20	20							
	X0326793	BRIDGE DECK HYDRO-SCARIFICATION 2 3/4"	SQ YD	1,297								1,297
**	* A2002914	TREE, CELTIS OCCIDENTALIS (COMMON HACKBERRY), 1 3/4" CALIPER, BALLED AND BURLAPPED	EACH	25	25							
	X0326765	CLEANING AND PAINTING EXPOSED REBAR (SPECIAL)	SQ FT	770				69				701
**	* A2005014	TREE, GYMNOCLADUS DIOICUS (KENTUCKY COFFEE TREE), 1 3/4" CALIPER, BALLED AND BURLAPPED	EACH	45	45							
	X0326794	CLEAN AND RESEAL RELIEF JOINT (AND)	FOOT	901.5				163.5				738
**	* A2006514	TREE, QUERCUS BICOLOR (SWAMP WHITE OAK), 1 3/4" CALIPER, BALLED AND BURLAPPED	EACH	30	30							
	X0326795	MODIFY EXISTING PIN LINK CONNECTION (AND)	L SUM	1	1							1
**	* A2001664	TREE, CRATAEGUS CRUSGALLI INERMIS (THORNLESS COCKSPUR HAWTHORNE), 5' HEIGHT, SHRUB FORM BALLED AND BURLAPPED	EACH	30	30							
Δ	X0326796	CLEAN TROUGH	EACH	4	4							4
**	* B2000116	TREE SYRINGA PEKINENSIS MORTON (CHINA SYDOW PEKING ULAC), 2" CALIPER, TREE FORM, BALLED AND BURLAPPED	EACH	25	25							
	X0326797	REATTACH GUARD RAIL TO STRUCTURE	EACH	4	4							
	X0326798	PIN REPLACEMENT	EACH	32								32
	Z0076600	TRAINEES	HOUR	1,500	1,500							
	X0326799	CLIP EXISTING BEAM FLANGE	EACH	11								11

** FOR LOCATIONS AND EXTENTS OF WORK NOT SHOWN IN THE PLANS, THE CONTRACTOR SHALL COORDINATE WITH THE ENGINEER AND CONTACT RICK WANNER, ROADSIDE DEVELOPMENT ARCHITECT, IDOT ROADSIDE DEVELOPMENT UNIT AT (847) 705-4172 AT LEAST 72 HOURS PRIOR TO STARTING WORK.

1080
* Specialty Items

NOTE A: SN 022-0092, SN 022-0194, SN 022-0095, SN 022-0096, SN 022-0097, SN 022-0098, SN 022-0099, SN 022-0100, SN 022-0104, SN 022-0105, SN 022-0111, SN 022-0112, SN 022-0137, SN 022-0138
Δ Non-participating

Rev. 1-B-10

Rev

FILE NAME =	DESIGNED - AJP	REVISED -		STATE OF ILLINOIS DEPARTMENT OF TRANSPORTATION	SUMMARY OF QUANTITIES			F.A.I. RTE.	SECTION	COUNTY	TOTAL SHEETS	SHEET NO.
#FILE#	DRAWN - TMB	REVISED -			SCALE: N.T.S.	SHEET NO. 4 OF 4 SHEETS	STA.	TO STA.	2211, 1-1, 2&3RS-7	DUPAGE	546	6
USER NAME = #USER#	CHECKED - JMM	REVISED -						*290,355		CONTRACT NO. 60G51		
PLOT DATE = #DATE#	DATE - 10/16/09	REVISED -						FED. ROAD DIST. NO.		ILLINOIS FED. AID PROJECT		

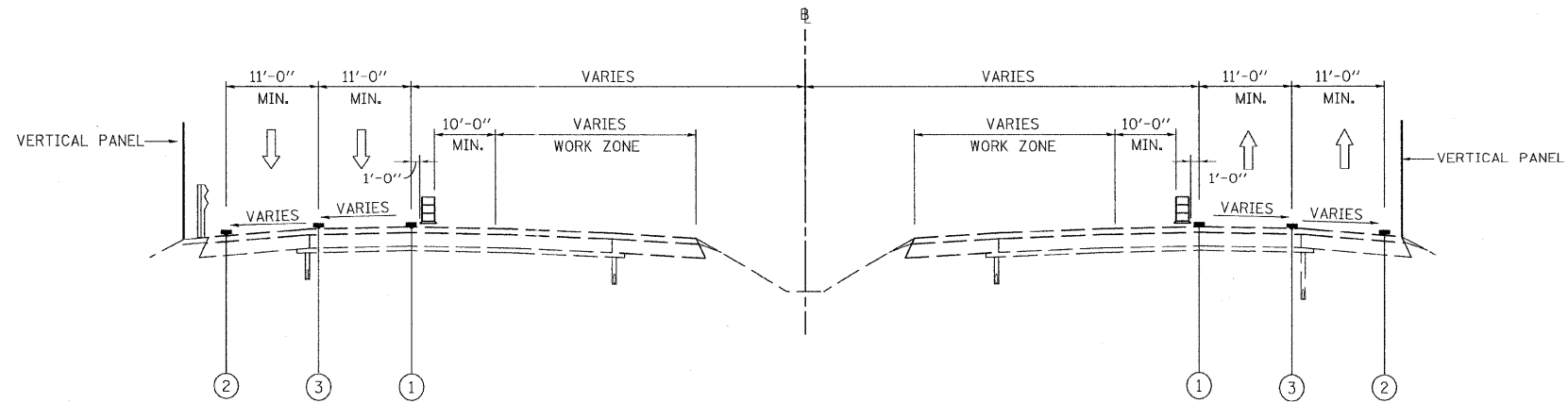

**I-290 MAINTENANCE OF TRAFFIC
TYPICAL SECTION
SHOULDER STAGING OPTION**
(OUTSIDE SHOULDER STAGING SHOWN)
(INSIDE SHOULDER STAGING SIMILAR - OPPOSITE HAND)

- LEGEND**
- ① WET REFLECTIVE TEMPORARY TAPE, - TYPE III, 4 INCH (YELLOW)
 - ② WET REFLECTIVE TEMPORARY TAPE, - TYPE III, 4 INCH (WHITE)
 - ③ WET REFLECTIVE TEMPORARY TAPE, - TYPE III, 5 INCH (WHITE)
 - ☐ TYPE II BARRIER, DRUM, OR VERTICAL BARRICADE WITH STEADY BURN MONODIRECTIONAL LIGHT

CONTRACTOR OPTION FOR STAGING ON SHOULDERS

AS AN ALTERNATIVE TO THE MAINTENANCE OF TRAFFIC SHOWN IN THE PLANS, THE CONTRACTOR HAS THE OPTION TO SHIFT TRAFFIC ONTO THE EXISTING SHOULDERS AT LOCATIONS WHERE THE SHOULDERS ARE A MINIMUM OF 10 FEET WIDE. ON THE CLOSED LANE ADJACENT TO LIVE TRAFFIC, THE CONTRACTOR SHALL MAINTAIN A 10 FOOT MINIMUM ROADWAY WIDTH WITHIN THE CLOSED LANE. THE CONTRACTOR SHALL NOT PLACE EQUIPMENT OR STORE MATERIALS WITHIN THE CLOSED LANE. ALL TRAFFIC LANES SHALL BE AT LEAST 11 FEET WIDE AND BE DELINEATED FROM THE WORK ZONE BY TYPE II BARRICADES OR DRUMS WITH STEADY BURNING MONODIRECTIONAL LIGHTS PLACED AT 100 FEET CENTER-CENTER.

ALL PATCHING, DRAINAGE STRUCTURE FRAME AND GRATE REPAIRS AND/OR ADJUSTMENTS, OR TEMPORARY PAVEMENT, REQUIRED ALONG THE SHOULDERS AND GOES IN PREPARATION TO SHIFT TRAFFIC WILL BE PAID FOR ACCORDING TO ARTICLE 109.04 OF THE STANDARD SPECIFICATIONS. ALL ADDITIONAL TRAFFIC CONTROL DEVICES, TEMPORARY PAVEMENT MARKINGS, SIGNING (TEMPORARY AND EXISTING OVERHEAD) AND INCIDENTAL COSTS ASSOCIATED WITH IMPLEMENTING THE SHOULDER STAGING OPTION SHALL BE AT THE CONTRACTOR'S EXPENSE. THE CONTRACTOR WILL BE REQUIRED TO SUBMIT PLANS OF THE SHOULDER STAGING OPTION TO THE ENGINEER FOR APPROVAL AT LEAST 2 WEEKS PRIOR TO SHIFTING TRAFFIC INTO THE STAGED CONFIGURATION. THE PLANS SHALL INCLUDE LANE CONFIGURATIONS, WORK ZONES, TRAFFIC CONTROL DEVICES, SIGNING (TEMPORARY AND EXISTING OVERHEAD) AND TEMPORARY PAVEMENT MARKINGS.

ALL DRAINAGE STRUCTURES LOCATED IN THE MEDIAN SHOULDERS BETWEEN THE I-290/I-355 INTERCHANGE AND U.S. ROUTE 20 (LAKE STREET) THAT WOULD BE LOCATED UNDER SHIFTED TRAFFIC SHALL EITHER 1) HAVE THEIR GRATES WELDED TO THE FRAMES USING THREE 4" LONG WELDS EQUALLY SPACED ALONG EACH OF THE LONG SIDES OF THE FRAME ACCORDING TO SECTION 505 OF THE STANDARD SPECIFICATIONS AND AS DIRECTED BY THE ENGINEER AND GRIND OUT WELDS SMOOTH AFTER TRAFFIC IS REMOVED FROM THE SHOULDERS OR 2) HAVE THEIR GRATES REMOVED, THE SEWER PIPES BRICKED CLOSED, THE DRAINAGE STRUCTURES FILLED WITH CA-6 AND COMPACTED AND CAPPED WITH 4" OF HMA SURFACE COURSE, MIX "D", N70 WITHIN THE FRAME OPENING AS DIRECTED BY THE ENGINEER. THESE MATERIALS SHALL BE REMOVED, THE DRAINAGE STRUCTURES AND SEWER PIPES CLEANED AND THE GRATES RE-INSTALLED AFTER TRAFFIC IS REMOVED FROM THE SHOULDERS. EITHER OF THESE DRAINAGE STRUCTURE OPTIONS WILL BE PAID FOR ACCORDING TO ARTICLE 109.04 OF THE STANDARD SPECIFICATIONS.

POSSIBLE 10' MINIMUM SHOULDER LOCATIONS (TO BE VERIFIED IN FIELD)

LOCATIONS:		EASTBOUND		WESTBOUND		NORTHBOUND		SOUTHBOUND	
		INSIDE SHOULDER	OUTSIDE SHOULDER	INSIDE SHOULDER	OUTSIDE SHOULDER	INSIDE SHOULDER	OUTSIDE SHOULDER	INSIDE SHOULDER	OUTSIDE SHOULDER
I-355	24+50 to 35+38					x	x	x	x
I-355	35+38 to 40+08							x	x
I-355	40+08 to 156+40					x	x	x	x
I-355/I-290	0+00 to 69+55 (SB end)					x	x	x	x
I-355/I-290	0+00 to 76+10 (NB end)					x	x	x	x
I-290	0+00 to 267+00	x	x	x	x				

△ ADDED SHEET 1/7/2010, ABC

FILE NAME =	DESIGNED - AJP	REVISED - 1/7/10	benesch	STATE OF ILLINOIS DEPARTMENT OF TRANSPORTATION	MAINTENANCE OF TRAFFIC TYPICAL SECTION - SHOULDER STAGING OPTION	F.A.T. RTE.	SECTION	COUNTY	TOTAL SHEETS	SHEET NO.
#FILEL#	DRAWN - TMB	REVISED -				* 224, 1-1, 2&3RS-7	DUPAGE	546	106A	
USER NAME = #USER#	CHECKED - JJT	REVISED -				*290,355	CONTRACT NO. 60C51			
PLOT DATE = #DATE#	DATE - 10/16/09	REVISED -				FED. ROAD DIST. NO.	ILLINOIS FED. AID PROJECT			
SCALE: N.T.S.						SHEET NO. 1 OF 1 SHEETS		STA.		TO STA.