

MATCH LINE A-A

EXISTING EQUIPMENT TO BE REMOVED LEGEND

TEMPORARY TRAFFIC SIGNAL LEGEND

- EXISTING SIGNAL HEAD TO BE REMOVED
- EXISTING SERVICE INSTALLATION TO BE REMOVED
- EXISTING STREET LIGHT, FOUNDATION AND LUMINAIRE TO REMAIN
- EXISTING CONTROLLER TO BE REMOVED
- EXISTING HANDHOLE TO BE REMOVED
- EXISTING PEDESTRIAN SIGNAL HEAD TO BE REMOVED
- EXISTING PEDESTRIAN PUSH BUTTON TO BE REMOVED
- EMERGENCY VEHICLE LIGHT DETECTOR TO BE REMOVED
- CONFIRMATION BEACON TO BE REMOVED
- EXISTING HEAVY-DUTY HANDHOLE TO BE REMOVED
- EXISTING SIGNAL POST AND FOUNDATION TO BE REMOVED
- EXISTING ALUMINUM MAST ARM POLE AND FOUNDATION TO BE REMOVED
- EXISTING STEEL MAST ARM POLE AND FOUNDATION TO BE REMOVED
- EXISTING CONDUIT TO BE ABANDONED
- GUY WIRE

- TEMPORARY TRAFFIC SIGNAL HEAD
- SPAN WIRE MOUNTED ORIGINAL LOCATION
- TEMPORARY TRAFFIC SIGNAL HEAD
- SPAN WIRE MOUNTED SECONDARY LOCATION
- TEMPORARY WOOD POLE (CLASS 5 OR BETTER) 45 FOOT MINIMUM
- TEMPORARY CONTROLLER CABINET
- TEMPORARY SPAN WIRE, TETHER WIRE, AND CABLE
- TEMPORARY SERVICE INSTALLATION
- TEMPORARY PEDESTRIAN SIGNAL HEAD, BRACKET MOUNTED
- TEMPORARY PEDESTRIAN PUSHBUTTON DETECTOR
- MICROWAVE VEHICLE SENSOR
- EMERGENCY VEHICLE LIGHT DETECTOR
- CONFIRMATION BEACON
- VEHICLE DETECTOR, INDUCTION LOOP
- COMMON TRENCH
- UNIT DUCT
- G.S. CONDUIT IN TRENCH OR PUSHED
- HANDHOLE
- HEAVY-DUTY HANDHOLE
- EXISTING WOOD POLE
- VIDEO DETECTOR
- WIRELESS INTERCONNECT (ANTENNA)
- VIDEO DETECTOR ZONE

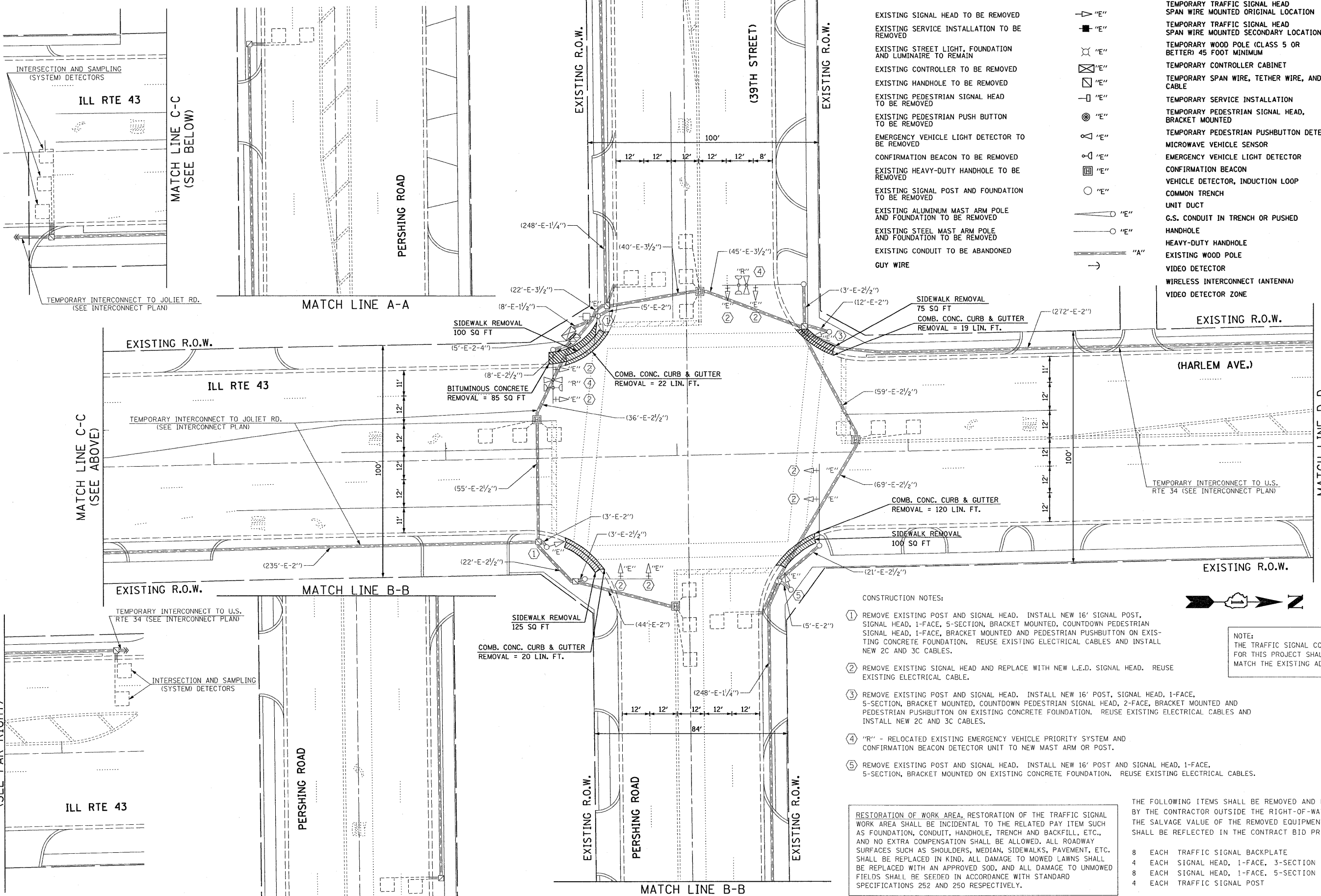

CONSTRUCTION NOTES:

- 1 REMOVE EXISTING POST AND SIGNAL HEAD. INSTALL NEW 16' SIGNAL POST, SIGNAL HEAD, 1-FACE, 5-SECTION, BRACKET MOUNTED, COUNTDOWN PEDESTRIAN SIGNAL HEAD, 1-FACE, BRACKET MOUNTED AND PEDESTRIAN PUSHBUTTON ON EXISTING CONCRETE FOUNDATION. REUSE EXISTING ELECTRICAL CABLES AND INSTALL NEW 2C AND 3C CABLES.
- 2 REMOVE EXISTING SIGNAL HEAD AND REPLACE WITH NEW L.E.D. SIGNAL HEAD. REUSE EXISTING ELECTRICAL CABLE.
- 3 REMOVE EXISTING POST AND SIGNAL HEAD. INSTALL NEW 16' POST, SIGNAL HEAD, 1-FACE, 5-SECTION, BRACKET MOUNTED, COUNTDOWN PEDESTRIAN SIGNAL HEAD, 2-FACE, BRACKET MOUNTED AND PEDESTRIAN PUSHBUTTON ON EXISTING CONCRETE FOUNDATION. REUSE EXISTING ELECTRICAL CABLES AND INSTALL NEW 2C AND 3C CABLES.
- 4 "R" - RELOCATED EXISTING EMERGENCY VEHICLE PRIORITY SYSTEM AND CONFIRMATION BEACON DETECTOR UNIT TO NEW MAST ARM OR POST.
- 5 REMOVE EXISTING POST AND SIGNAL HEAD. INSTALL NEW 16' POST AND SIGNAL HEAD, 1-FACE, 5-SECTION, BRACKET MOUNTED ON EXISTING CONCRETE FOUNDATION. REUSE EXISTING ELECTRICAL CABLES.

NOTE:
THE TRAFFIC SIGNAL CONTROLLER EQUIPMENT FOR THIS PROJECT SHALL BE "EAGLE" TO MATCH THE EXISTING ADJACENT SYSTEM.

RESTORATION OF WORK AREA. RESTORATION OF THE TRAFFIC SIGNAL WORK AREA SHALL BE INCIDENTAL TO THE RELATED PAY ITEM SUCH AS FOUNDATION, CONDUIT, HANDHOLE, TRENCH AND BACKFILL, ETC., AND NO EXTRA COMPENSATION SHALL BE ALLOWED. ALL ROADWAY SURFACES SUCH AS SHOULDERS, MEDIAN, SIDEWALKS, PAVEMENT, ETC. SHALL BE REPLACED IN KIND. ALL DAMAGE TO MOWED LAWNS SHALL BE REPLACED WITH AN APPROVED SOD, AND ALL DAMAGE TO UNMOWED FIELDS SHALL BE SEEDED IN ACCORDANCE WITH STANDARD SPECIFICATIONS 252 AND 250 RESPECTIVELY.

THE FOLLOWING ITEMS SHALL BE REMOVED AND DISPOSED OF BY THE CONTRACTOR OUTSIDE THE RIGHT-OF-WAY AT THEIR EXPENSE. THE SALVAGE VALUE OF THE REMOVED EQUIPMENT SHALL BE REFLECTED IN THE CONTRACT BID PRICE.

- 8 EACH TRAFFIC SIGNAL BACKPLATE
- 4 EACH SIGNAL HEAD, 1-FACE, 3-SECTION
- 8 EACH SIGNAL HEAD, 1-FACE, 5-SECTION
- 4 EACH TRAFFIC SIGNAL POST

FILE NAME =	USER NAME = kcanthaphixaybc	DESIGNED - TCM/BPR	REVISED - 09/08/2009 PER IDOT	STATE OF ILLINOIS DEPARTMENT OF TRANSPORTATION	TEMPORARY TRAFFIC SIGNAL INSTALLATION AND REMOVE EXISTING TRAFFIC SIGNAL EQUIPMENT PLAN - ILL RTE 43 (HARLEM AVE.) AT PERSHING ROAD			F.A.P. RTE. 348	SECTION 2009 078 TS	COUNTY COOK	TOTAL SHEETS 33	SHEET NO. 12
DRAWN - TCM/BPR	CHECKED - TCM	DATE - 07/02/2009	REVISED -		SCALE: 1"=20'	SHEET NO.	OF SHEETS	STA.	TO STA.	CONTRACT NO. 60115		
PLOT SCALE = #SCALESHORT#	PLOT DATE = 11/9/2009									FED. ROAD DIST. NO.	ILLINOIS	FED. AID PROJECT

10:36:17 11/09/2009