

NOTE:
THE TRAFFIC SIGNAL CONTROLLER EQUIPMENT
FOR THIS PROJECT SHALL BE "EAGLE" TO
MATCH THE EXISTING ADJACENT SYSTEM.

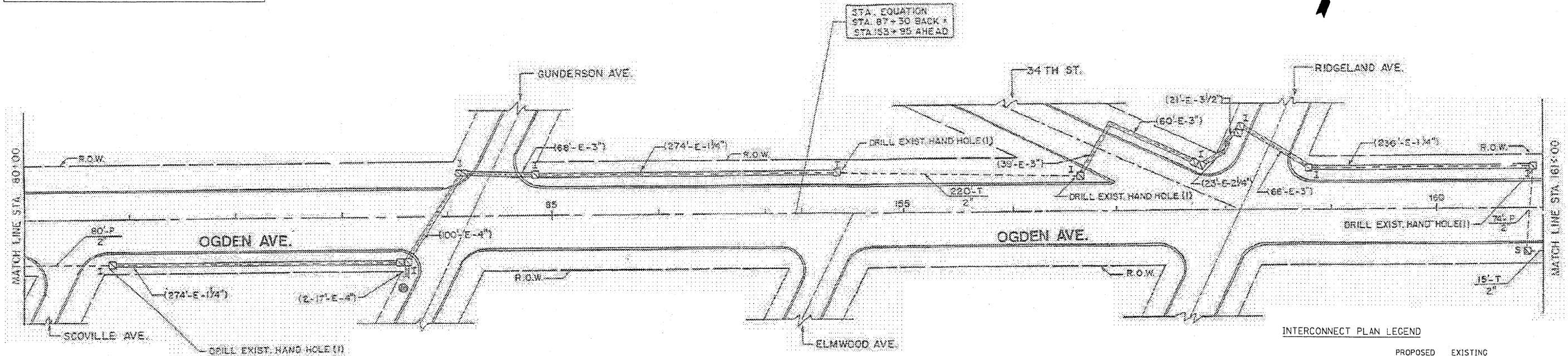

FOR INFORMATION ONLY

INTERCONNECT PLAN LEGEND

	PROPOSED	EXISTING
CONTROLLER		
HANDHOLE		
DOUBLE HANDHOLE		
HEAVY-DUTY HANDHOLE		
G.S. CONDUIT IN TRENCH (T) OR PUSHED (P)		
DETECTOR LOOP		
SYSTEM		
INTERSECTION		
UNIT DUCT		
COMMON TRENCH		
WIRELESS INTERCONNECT ANTENNA		

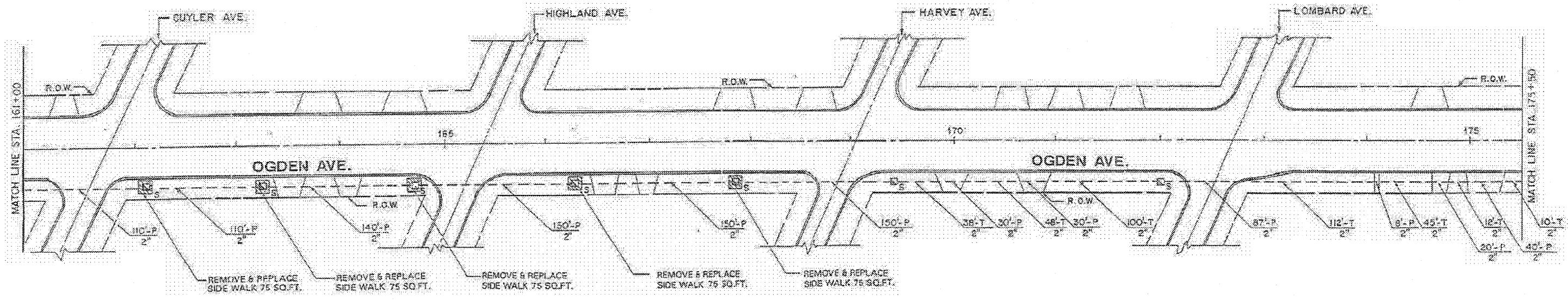

FILE NAME = P:\P-07-1600-7-10\Design\SH1821r.dgn	USER NAME = rdehan	DESIGNED - TCM/BPR	REVISED - 09/08/2009 PER JDGT
		DRAWN - TCM/BPR	REVISED -
		CHECKED - TCM	REVISED -
		DATE - 07/02/2009	REVISED -

**STATE OF ILLINOIS
DEPARTMENT OF TRANSPORTATION**

**INTERCONNECT PLAN (SHEET 4 OF 6)
U.S. RTE 34 (OGDEN AVE.)
FROM ILL RTE 43 (HARLEM AVE.) TO CENTRAL AVE.**

SCALE: 1"=50' SHEET NO. OF SHEETS STA. TO STA.

F.A.P. RTE.	SECTION	COUNTY	TOTAL SHEETS	SHEET NO.
34B	2009 078 TS	COOK	33	29
FED. ROAD DIST. NO.		ILLINOIS	FED. AID PROJECT	
			CONTRACT NO. 60115	

