

F.A.P. RTE.	SECTION	COUNTY	TOTAL SHEETS	SHEET NO.
3578	15VB-1-R-1	COOK	243	27
STA.		TO STA.		
FED. ROAD DIST. NO.		ILLINOIS	FED. AID PROJECT	
		CONTRACT NO. 62388		

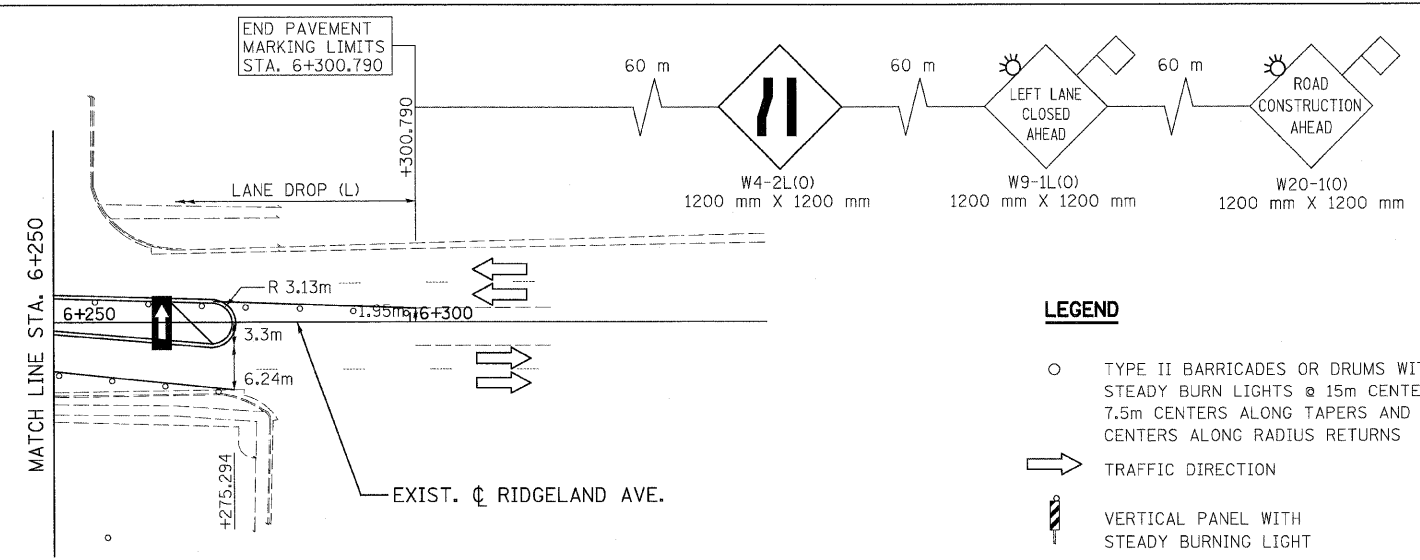
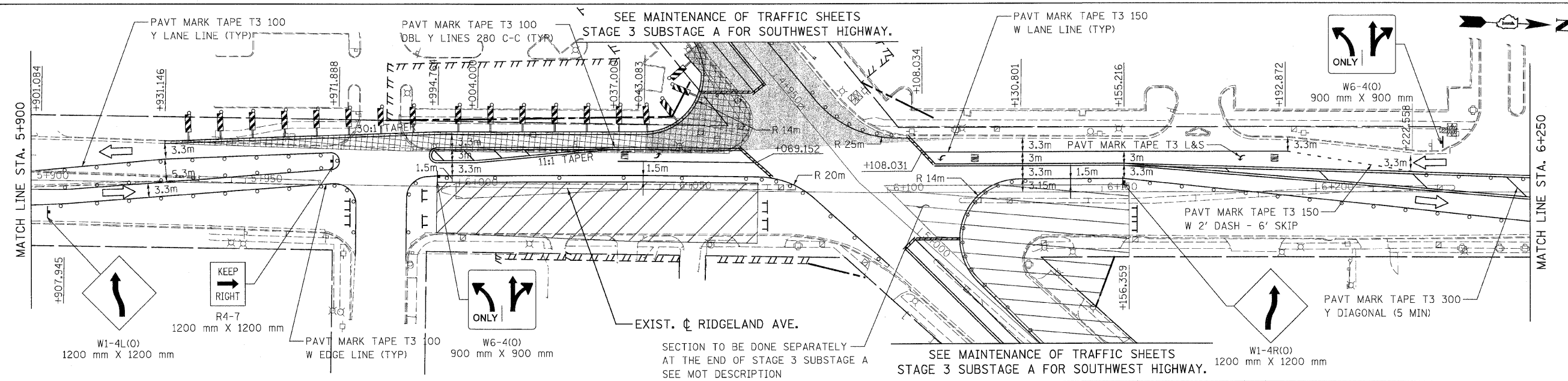
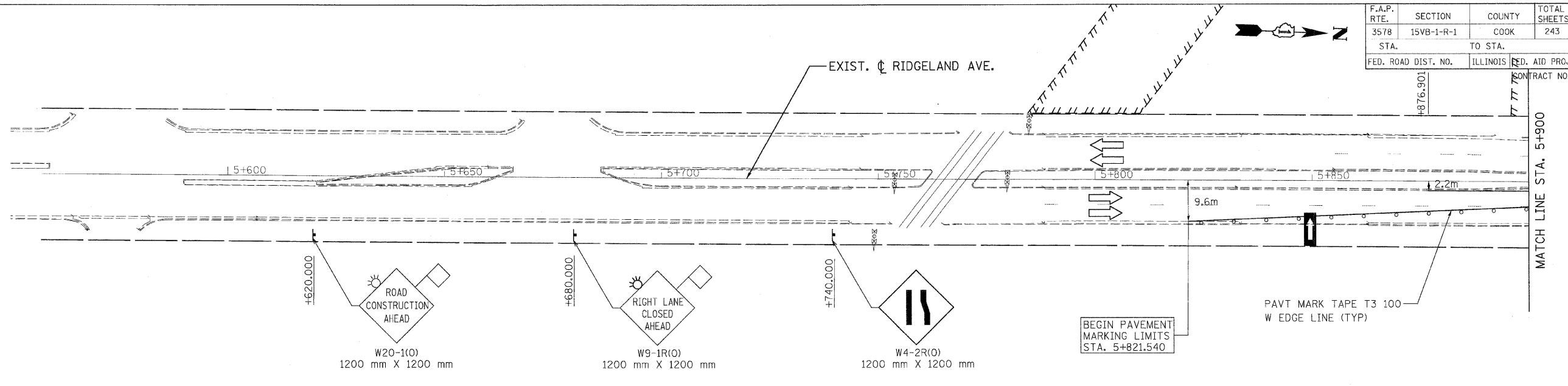

LEGEND

- TYPE II BARRICADES OR DRUMS WITH STEADY BURN LIGHTS @ 15m CENTERS, 7.5m CENTERS ALONG TAPERS AND 3.5m CENTERS ALONG RADIUS RETURNS
- TRAFFIC DIRECTION
- VERTICAL PANEL WITH STEADY BURNING LIGHT
- TYPE III BARRICADES WITH FLASHING LIGHTS
- TEMPORARY HMA RAMP
- WORK ZONE
- TEMPORARY PAVEMENT
- ARROW BOARD
- TEMPORARY CONCRETE BARRIER
- IMPACT ATTENUATORS

REVISIONS	
NAME	DATE

ILLINOIS DEPARTMENT OF TRANSPORTATION
 FAU 3578 (SOUTHWEST HIGHWAY) OVER B&O
 RAILROAD AND STONY CREEK
 SUGGESTED STAGING OF CONSTRUCTION
 & TRAFFIC CONTROL
 RIDGELAND AVENUE STAGE 3
 SUBSTAGE A

SCALE: 1:500
 DATE: 6/17/09

DRAWN BY: CPK
 CHECKED BY: DES

PATRICK ENGINEERING INC. LISLE, ILLINOIS
 +koeppen(Rdwy-Lisle)
 6/26/2009 1:34:37 AM
 G:\DOT\9556-A0\Drawings\RDW\shfts\MOT\S_mot_03_06_subd_rdgind.dgn