

F.A.P. RTE.	SECTION	COUNTY	TOTAL SHEETS	SHEET NO.
3578	15VB-1-R-1	COOK	243	29
STA.		TO STA.		
FED. ROAD DIST. NO.		ILLINOIS	FED. AID PROJECT	
		CONTRACT NO. 62388		

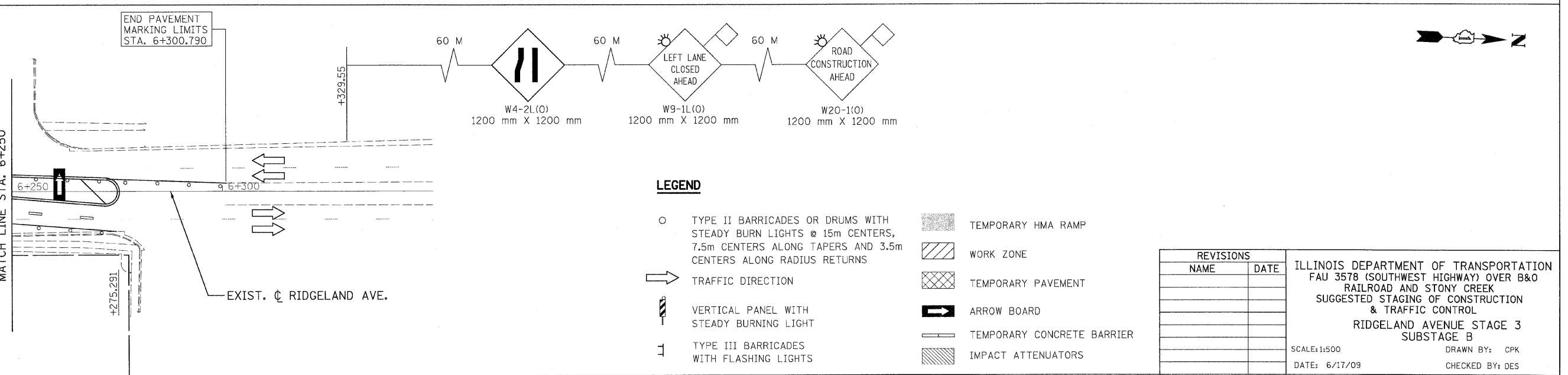
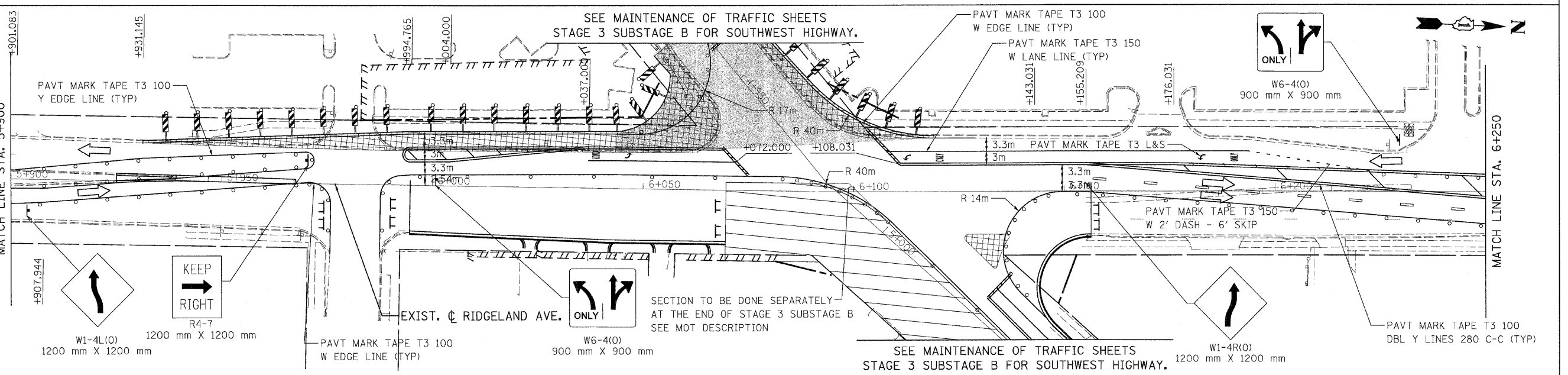
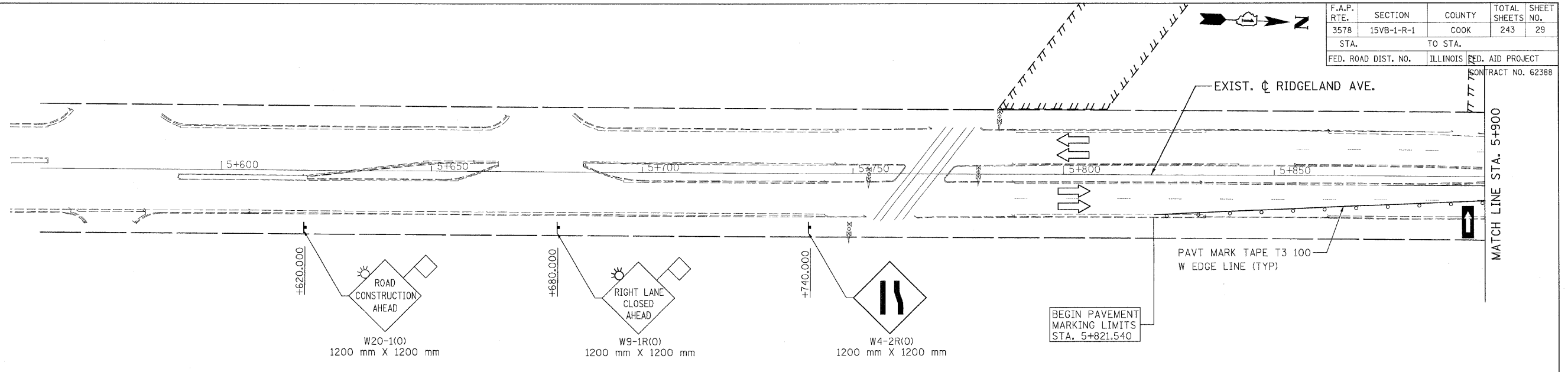

LEGEND

○	TYPE II BARRICADES OR DRUMS WITH STEADY BURN LIGHTS @ 15m CENTERS, 7.5m CENTERS ALONG TAPERS AND 3.5m CENTERS ALONG RADIUS RETURNS	▨	TEMPORARY HMA RAMP
→	TRAFFIC DIRECTION	▨	WORK ZONE
⊥	VERTICAL PANEL WITH STEADY BURNING LIGHT	▨	TEMPORARY PAVEMENT
⊥	TYPE III BARRICADES WITH FLASHING LIGHTS	▨	ARROW BOARD
		▨	TEMPORARY CONCRETE BARRIER
		▨	IMPACT ATTENUATORS

REVISIONS	
NAME	DATE

ILLINOIS DEPARTMENT OF TRANSPORTATION
FAU 3578 (SOUTHWEST HIGHWAY) OVER B&O RAILROAD AND STONY CREEK
SUGGESTED STAGING OF CONSTRUCTION & TRAFFIC CONTROL
RIDGELAND AVENUE STAGE 3 SUBSTAGE B

SCALE: 1:500
DATE: 6/17/09
DRAWN BY: CPK
CHECKED BY: DES

tkoepen(Rdwy_Lisle) 6/26/2009 10:34:52 AM PDF(Grey_Large).plt Q:\IDOT\9556-A0\Drawings\RDWY\shfts\MOT\S_mot_03_08_subb_rdgind.dgn

