

| | | | |
|---------------------|---------------------------|--------------|-----------|
| SECTION | COUNTY | TOTAL SHEETS | SHEET NO. |
| 15VB-1-R-1 | Cook | 243 | 42 |
| STA. | TO STA. | | |
| FED. ROAD DIST. NO. | ILLINOIS FED. AID PROJECT | | |

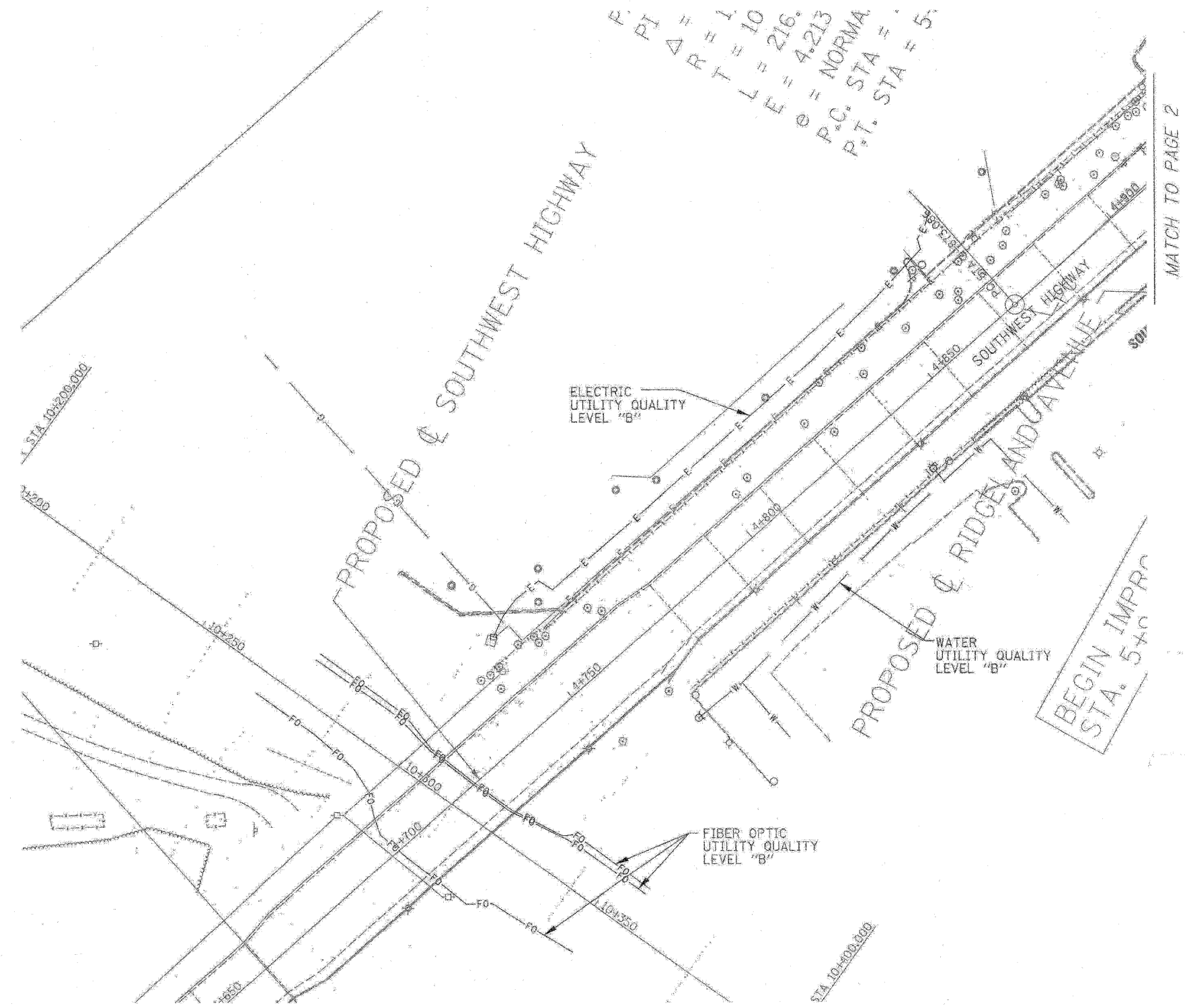

$E \cdot P \cdot I = 1$
 $\Delta R \cdot T = 10$
 $L = 216$
 $E = 4.213$
 $\theta = \text{NORMA}$
 $P \cdot C \cdot \text{STA} = 5$
 $P \cdot T \cdot \text{STA} = 5$



| | |
|---------|-------------|
| —T—T— | TELEPHONE |
| —W—W— | WATER |
| —G—G— | GAS |
| —FO—FO— | FIBER OPTIC |
| —E—E— | ELECTRIC |



TBE GROUP, INC.
 CIVIL ENGINEERING * TRANSPORTATION * ENVIRONMENTAL
 * PLANNING * UTILITY ENGINEERING * LOCATING

ILO9500240
 Checked by: *Sandra J. RE*
 PAGE 1 OF 2
 Utility Quality Level "B" : Designating

Utility shown on these plans as depicted in the legend have been investigated by TBE Group, Inc in accordance with SUE Industry Standards. All other information shown has been provided to TBE Group, Inc by others. TBE's SUE field investigation was performed during the period 10-03-05 through 12-02-05. Changes to utilities after these dates may have been made and therefore may result in variances from this plan. Consideration should be given to updating this plan if deemed advisable prior to final design and construction.



205 W. WACKER DRIVE
 SUITE 1020
 CHICAGO, IL 60606
 (312) 704-1970

| REVISIONS | |
|-----------|------|
| NAME | DATE |
| | |
| | |
| | |
| | |
| | |
| | |
| | |
| | |
| | |

ILLINOIS DEPARTMENT OF TRANSPORTATION
 Southwest Highway over B&O Railroad,
 Stoney Creek and at Ridgeland Avenue,
 Cook County, IL
 Section No. 15VB-1-R-1
 Contract No. 62388
 DRAWN BY - KLC
 SCALE : 1:500