

F.A.P. RTE.	SECTION	COUNTY	TOTAL SHEETS	SHEET NO.
3578	15VB-1-R-1	COOK	248	70
STA.		TO STA.		
FED. ROAD DIST. NO.		ILLINOIS FED. AID PROJECT		
CONTRACT NO. 62388				

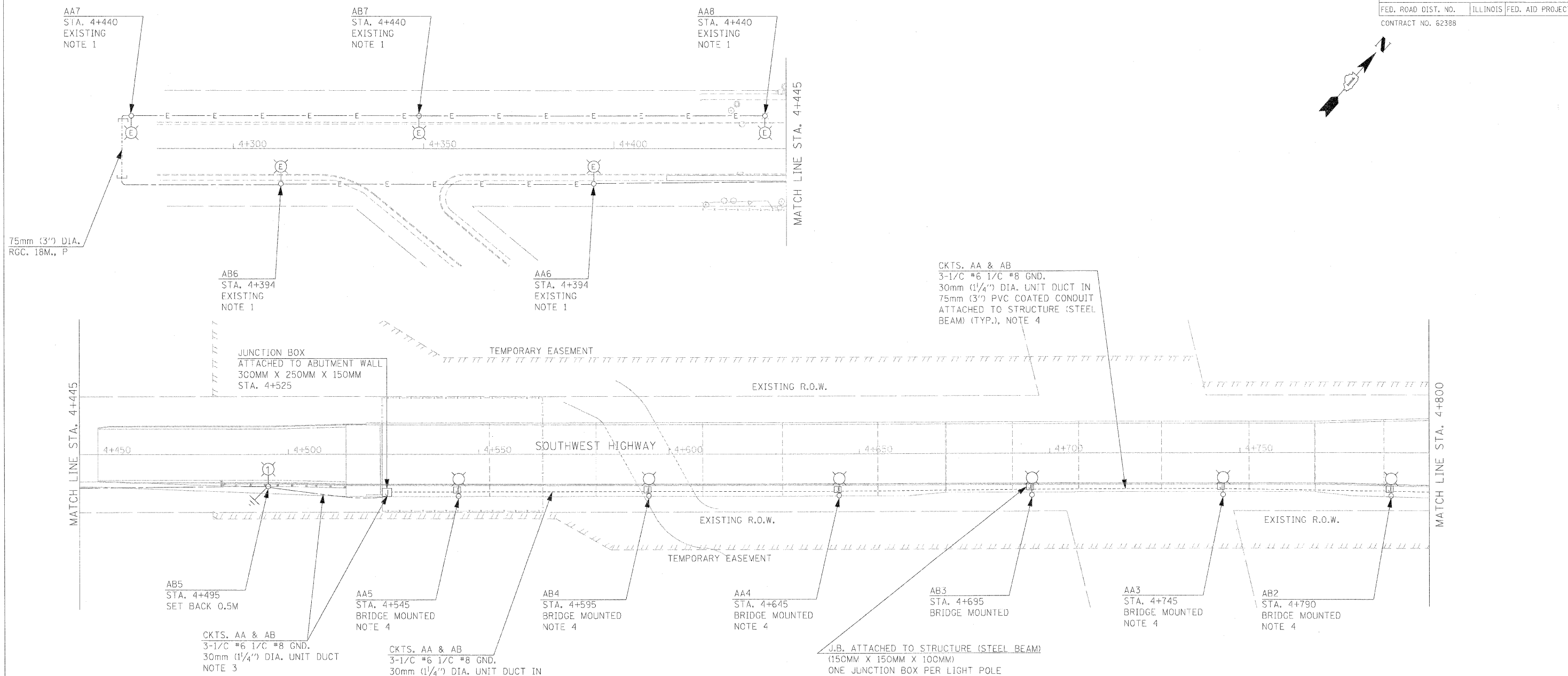
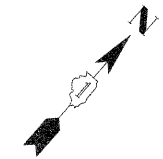

- NOTES:**
1. THE CONTRACTOR SHALL VERIFY THE WIRING OF THESE LIGHT POLES IN THE FIELD, AND WITH THE VILLAGE OF CHICAGO RIDGE PUBLIC WORKS DEPARTMENT. THE EXISTING LIGHT POLES TO REMAIN THAT WERE CONNECTED TO THE EXISTING LIGHTING CONTROLLER SHALL BE CONNECTED TO THE NEW VILLAGE OF CHICAGO RIDGE MAINTAINED LIGHTING CONTROLLER LOCATED AT THE INTERSECTION OF RIDGELAND AVENUE AND SOUTHWEST HIGHWAY.
 2. THE CONTRACTOR SHALL INSTALL NEW UNIT DUCT IN TRENCH FROM POLE* AB5 TO PROPOSED WALL MOUNTED JUNCTION BOX ON ABUTMENT WALL AS SHOWN. THE CONTRACTOR SHALL THEN INSTALL THE UNIT DUCT IN A PVC COATED STEEL CONDUIT ATTACHED TO ABUTMENT WALL UP TO THE PROPOSED JUNCTION BOX.
 3. THE CONTRACTOR SHALL INSTALL NEW UNIT DUCT IN TRENCH FROM POLE* AB5 TO PROPOSED WALL MOUNTED JUNCTION BOX ON ABUTMENT WALL AS SHOWN. THE CONTRACTOR SHALL THEN INSTALL THE UNIT DUCT IN A PVC COATED STEEL CONDUIT ATTACHED TO ABUTMENT UP TO THE PROPOSED JUNCTION BOX.
 4. CONDUITS AND JUNCTION BOXES CALLED OUT TO BE ATTACHED TO STRUCTURE SHALL BE ATTACHED TO BRIDGE STEEL BEAM CLOSEST TO LIGHT POLE. ALL CONNECTIONS AND CLAMPS USED SHALL BE WEATHER PROOF. ALL CLAMPS AND BRACKETS SHALL BE ATTACHED WITH SCREWS OR BOLTS, NO WELDING TO THE BRIDGE BEAMS IS ALLOWED. SEE STRUCTURAL DETAILS FOR MORE INFORMATION.

PATRICK
ENGINEERING INC.
LISLE, ILLINOIS

GA GANDHI AND ASSOCIATES, INC.
ENGINEERS AND PLANNERS
6035 N. NORTHWEST HIGHWAY
SUITE 306
CHICAGO, ILLINOIS 60631 TEL: (773) 774-5910

REVISIONS	
NAME	DATE

ILLINOIS DEPARTMENT OF TRANSPORTATION
FAU 3578 (SOUTHWEST HIGHWAY)
OVER B&O RAILROAD AND STONY CREEK
PROPOSED ROADWAY LIGHTING
SHEET 1 OF 2

SCALE: 1:500
DATE: JUNE 17, 2009
DRAWN BY: RDP/KGP
CHECKED BY: PKG/MAE