

| | | | | |
|---------------------|------------|----------|------------------|-----------|
| F.A.P. RTE. | SECTION | COUNTY | TOTAL SHEETS | SHEET NO. |
| 3578 | 15VB-1-R-1 | COOK | 248 | 71 |
| STA. | | TO STA. | | |
| FED. ROAD DIST. NO. | | ILLINOIS | FED. AID PROJECT | |
| CONTRACT NO. 62388 | | | | |

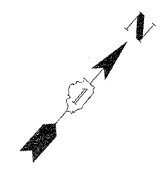
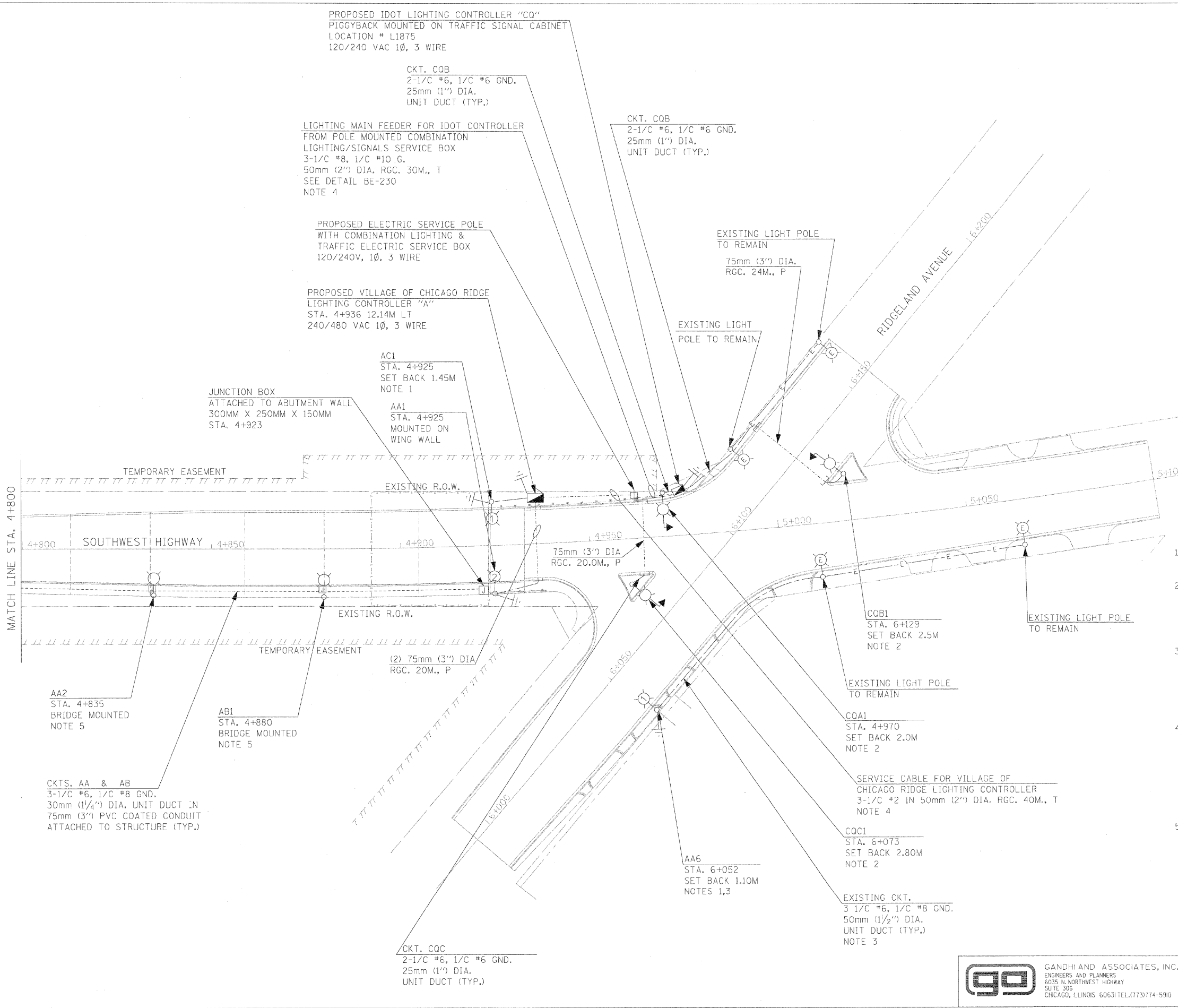

- NOTES:
1. ALL PROPOSED GROUND MOUNTED LIGHT POLES SHALL HAVE TRANSFORMER BASES.
 2. COMBINATION TRAFFIC SIGNALS AND LIGHTING POLES; MOUNTING HEIGHT IS 13.72M AND LIGHTING MAST ARM IS 4.5M LONG. PAY ITEM FOR COMBINATION POLE IS LISTED UNDER TRAFFIC SIGNALS QUANTITIES. COMBINATION POLE PAY ITEM INCLUDES LIGHTING MAST ARM BUT LUMINAIRE IS NOT INCLUDED IN COMBINATION POLE ITEM.
 3. THE CONTRACTOR SHALL CONNECT THE PROPOSED LIGHT POLE TO THE EXISTING LIGHTING CONTROLLER LOCATED AT MERRIMAC AVENUE, WHICH IS MAINTAINED BY THE VILLAGE OF OAK LAWN. THE EXISTING CIRCUIT THAT SHALL BE ASSIGNED TO THE PROPOSED POLE SHALL BE THE SAME AS THE ONE THAT WAS ASSIGNED TO THE POLE BEING REMOVED THAT IS CLOSEST TO THE INTERSECTION.
 4. ALL MATERIALS, EQUIPMENT, AND LABOR NEEDED TO INSTALL AND CONNECT THE ELECTRIC SERVICE FROM THE COMED UTILITY TRANSFORMER TO THE LIGHTING CONTROLLER CABINET SHALL BE PART OF PAY ITEM NO. 80400100 - ELECTRIC SERVICE INSTALLATION. THAT SHALL INCLUDE THE APPROVED METER SOCKET, COMBINATION SERVICE BOX, CABLE, CONDUIT AND TRENCHING FOR THE CONDUIT SHOWN ON THE PLANS. ALL CONNECTIONS, SPLICING, AND WIRING TO THE NEW LIGHTING CONTROLLER SHALL ALSO INCLUDED UNDER THE SAME PAY ITEM.
 5. CONDUITS AND JUNCTION BOXES CALLED OUT TO BE ATTACHED TO STRUCTURE SHALL BE ATTACHED TO BRIDGE STEEL BEAM CLOSEST TO LIGHT POLE. ALL CONNECTIONS AND CLAMPS USED SHALL BE PVC COATED. ALL CLAMPS AND BRACKETS SHALL BE ATTACHED WITH SCREWS OR BOLTS, NO WELDING TO THE BRIDGE BEAMS IS ALLOWED. SEE STRUCTURAL DETAILS FOR MORE INFORMATION.

| REVISIONS | |
|-----------|------|
| NAME | DATE |
| | |
| | |
| | |
| | |
| | |

ILLINOIS DEPARTMENT OF TRANSPORTATION
FAU 3578 (SOUTHWEST HIGHWAY)
OVER B&O RAILROAD AND STONY CREEK
PROPOSED ROADWAY LIGHTING
SHEET 2 OF 2

SCALE: 1:500
DATE: JUNE 17, 2009

DRAWN BY: RDP/KGP
CHECKED BY: PKG/MAE

GANDHI AND ASSOCIATES, INC.
ENGINEERS AND PLANNERS
6035 N. NORTHWEST HIGHWAY
SUITE 306
CHICAGO, ILLINOIS 60631 TEL: (773) 774-5910

PATRICK
ENGINEERING INC.
LISLE, ILLINOIS