

F.A.P. RTE.	SECTION	COUNTY	TOTAL SHEETS	SHEET NO.
3578	15VB-1-R-1	COOK	248	75
STA.		TO STA.		
FED. ROAD DIST. NO.		ILLINOIS FED. AID PROJECT		
CONTRACT NO. 62388				

NOTES:

1. THE CONTRACTOR SHALL VERIFY IN THE FIELD THE CONNECTIONS AND WIRING OF ALL EXISTING LIGHT POLES TO BE REMOVED. ANY USABLE EXISTING UNDERGROUND CONDUITS OR UNIT DUCTS THAT CAN BE USED, SHALL BE UTILIZED SPECIALLY IN AREAS WHERE NO PROPOSED ROADWAY IMPROVEMENTS ARE PLANNED.
2. THE TEMPORARY LIGHTING SYSTEM MUST BE INSTALLED AND FULLY OPERATIONAL BEFORE ANY EXISTING LIGHTING UNITS ARE DISCONNECTED OR REMOVED.
3. THE CONTRACTOR SHALL DISCONNECT THE WIRING OF THE LIGHTING UNITS TO BE REMOVED AT THE CONTROLLER BEFORE THE LIGHTING UNITS ARE REMOVED. THE CONTRACTOR SHALL MAKE SURE THAT ANY WIRING DISCONNECTED DOESN'T ADVERSELY AFFECT ANY EXISTING LIGHTING EQUIPMENT THAT SHALL REMAIN OPERATIONAL IN PLACE.
4. ALL EXISTING CONDUITS/UNIT DUCTS THAT ARE CONNECTED TO ANY EXISTING LIGHT POLES THAT ARE AFFECTED BY THE LIGHTING IMPROVEMENTS MUST BE FIELD VERIFIED BY THE CONTRACTOR. THIS IS DUE TO THE LACK OF AS BUILT LIGHTING PLANS THAT SHOW THE EXISTING UNDERGROUND WIRING, AND CONDUIT/UNIT DUCT ROUTING. MINOR FIELD ADJUSTMENTS AND/OR MODIFICATIONS MIGHT BE NECESSARY BASED ON THE FINDINGS BY THE CONTRACTOR, AND ANY CHANGES OR DEVIATION FROM THESE PLANS MUST BE APPROVED BY THE RESIDENT ENGINEER BEFORE ANY WORK CAN BEGIN.
5. REMOVE LUMINAIRE FROM COMBINATION POLE. COMBINATION POLE REMOVAL AND OTHER ITEMS ATTACHED TO IT SHALL BE REMOVED UNDER THE APPROPRIATE TRAFFIC SIGNAL PAY ITEM. SEE TRAFFIC SIGNAL REMOVAL PLANS (BY OTHERS).

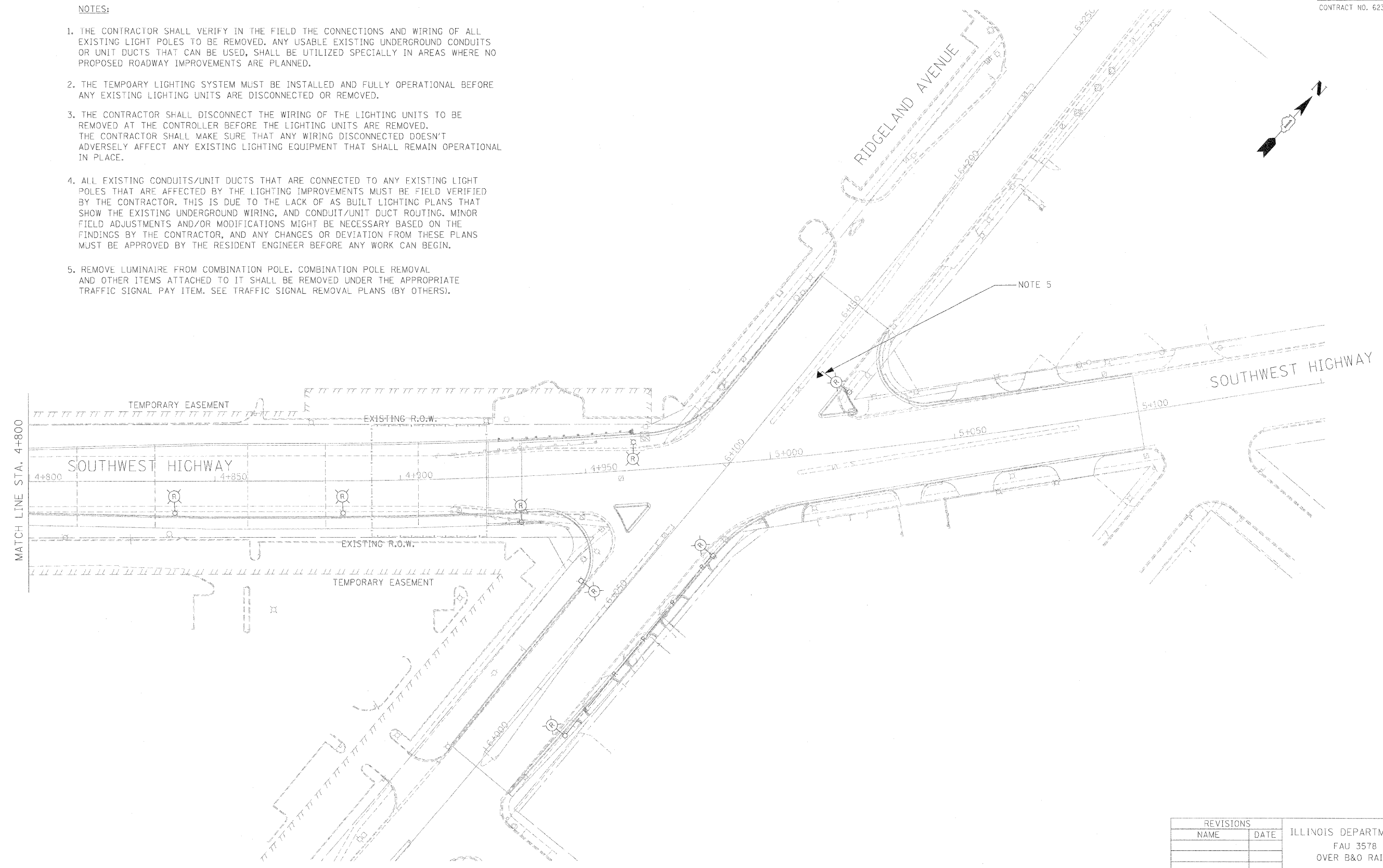

PATRICK
ENGINEERING INC.
LISLE, ILLINOIS

GA GANDHI AND ASSOCIATES, INC.
ENGINEERS AND PLANNERS
6035 N. NORTHWEST HIGHWAY
SUITE 306
CHICAGO, ILLINOIS 60631 TEL: (773) 774-5910

REVISIONS	
NAME	DATE

ILLINOIS DEPARTMENT OF TRANSPORTATION
FAU 3578 (SOUTHWEST HIGHWAY)
OVER B&O RAILROAD AND STONY CREEK
LIGHTING REMOVAL PLAN
SHEET 2 OF 2
SCALE: 1:500
DATE: JUNE 17, 2009
DRAWN BY: RDP/KGP
CHECKED BY: PKG/MAE