

☐ SOUTHWEST HIGHWAY

F.A. RTE.	SECTION	COUNTY	TOTAL SHEETS	SHEET NO.
			243	225
STA. 4+600		TO STA. 4+600		
FED. ROAD DIST. NO.		ILLINOIS FED. AID PROJECT		
CONTRACT NO. 62388				

FINAL SURVEY	SURVEYED	DATE
NOTE BOOK NO.	PLOTTED	
	AREAS CHECKED	

ORIGINAL SURVEY	SURVEYED	DATE
NOTE BOOK NO.	PLOTTED	
	AREAS CHECKED	

PATRICK ENGINEERING INC.
LISLE, ILLINOIS

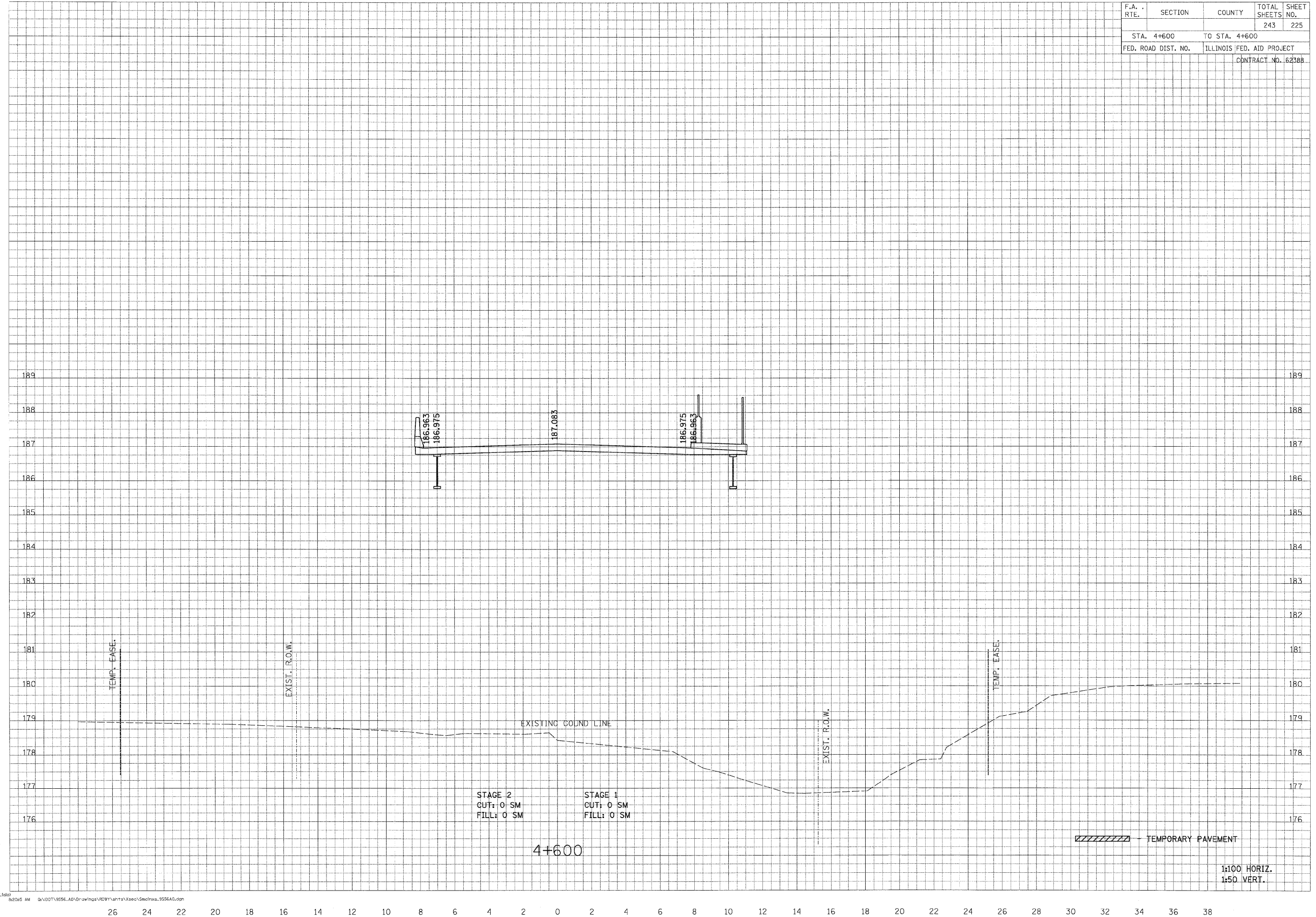

STAGE 2
CUT: 0' SM
FILL: 0' SM

STAGE 1
CUT: 0' SM
FILL: 0' SM

4+600

TEMPORARY PAVEMENT

1:100 HORIZ.
1:50 VERT.

h:\kappeler\pawley\l11d\1 8/26/2009 8:26:55 AM G:\1001\9556.A0\Drawings\RD\BY\anta\Xeco\Smelnsk_9556A0.dgn

26 24 22 20 18 16 14 12 10 8 6 4 2 0 2 4 6 8 10 12 14 16 18 20 22 24 26 28 30 32 34 36 38