

| F.A.P. RTE. | SECTION | COUNTY | TOTAL SHEET NO. |
|----------------------|---------|---------------------------|-----------------|
| 326 | | McHENRY | 502 |
| STA. 9+35.22 | | TO STA. 142+08.53 | |
| FED. ROAD DIST. NO. | | ILLINOIS FED. AID PROJECT | |
| • (105X & 106) WRS-2 | | | |

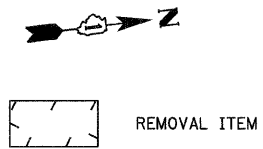

| | |
|------|----------|
| DATE | BY |
| | |
| PLAN | SURVEYED |
| | PLOTTED |
| | CHECKED |
| | BY |
| | DATE |
| | NO. |
| | NO. |
| | NO. |

| | |
|---------|----------|
| DATE | BY |
| | |
| PROFILE | SURVEYED |
| | PLOTTED |
| | CHECKED |
| | BY |
| | DATE |
| | NO. |
| | NO. |
| | NO. |

PLOT DATE = Thursday, December 17, 2009
 FILE NAME = S:\11-CADD\11-ha-V034-ppa-ahv07.dgn
 PLOT SCALE = 49.999941
 USER NAME = 3699

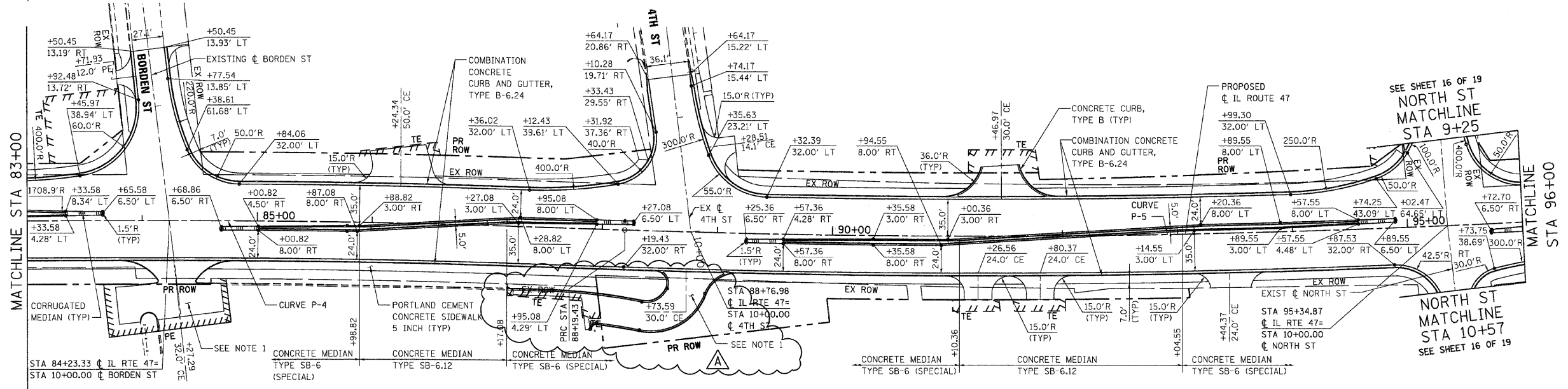
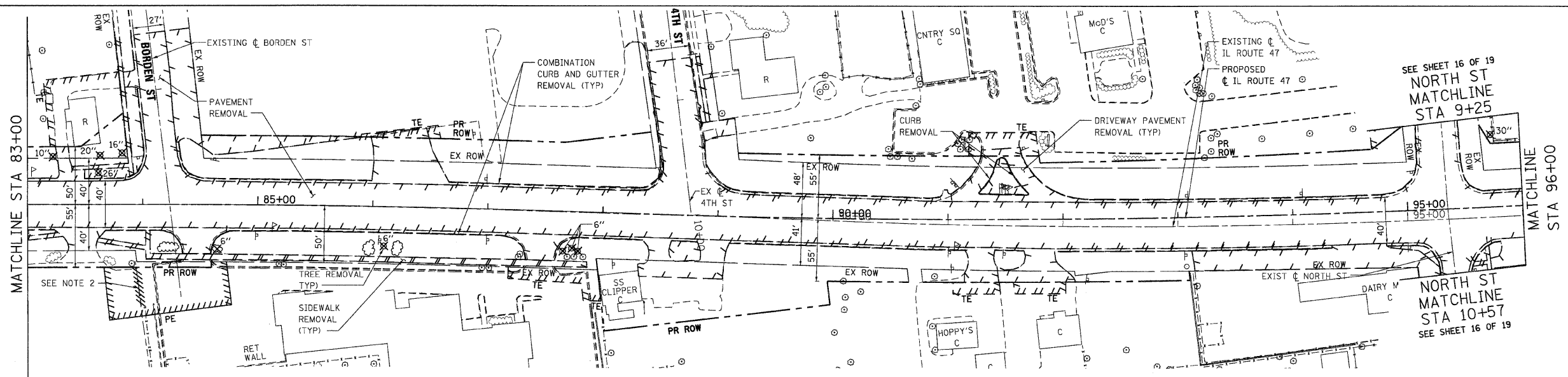

- NOTES:**
- SEE MISCELLANEOUS ROADWAY DETAIL SHEET FOR DRIVEWAY DETAILS.
 - REMOVAL OF TIMBER FENCE SHALL NOT BE PAID FOR SEPARATELY BUT SHALL BE CONSIDERED INCIDENTAL TO THE CONTRACT.

| REVISIONS | |
|------------|----------|
| NAME | DATE |
| ADDENDUM A | 12/21/09 |

