

F.A.P. RTE.	SECTION	COUNTY	TOTAL SHEETS	SHEET NO.
326		McHENRY	502	81
STA. 9+35.22		TO STA. 142+08.53		
FED. ROAD DIST. NO.		ILLINOIS FED. AID PROJECT		
• (105X & 106) WRS-2				

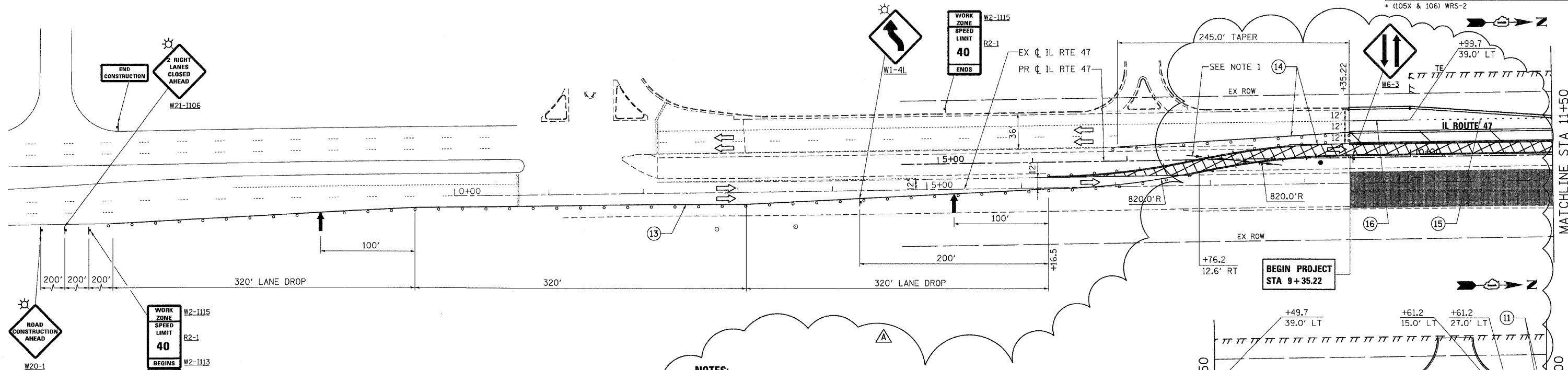

NOTES:

1. INSTALL PIPE CULVERT, CLASS A, TYP A, 12" (TEMPORARY) AT STA 7+63.00, 5.0' LT, INV 888.71, TO STA 8+64.00, 7.0' RT, INV 888.46.
2. TEMPORARY PAVEMENT MARKING AND PAVEMENT MARKING TAPE ALONG KREUTZER ROAD SHALL REMAIN IN PLACE. SEE MOT - STAGE 1B SHEET 2 OF 4 FOR ADDITIONAL INFORMATION.

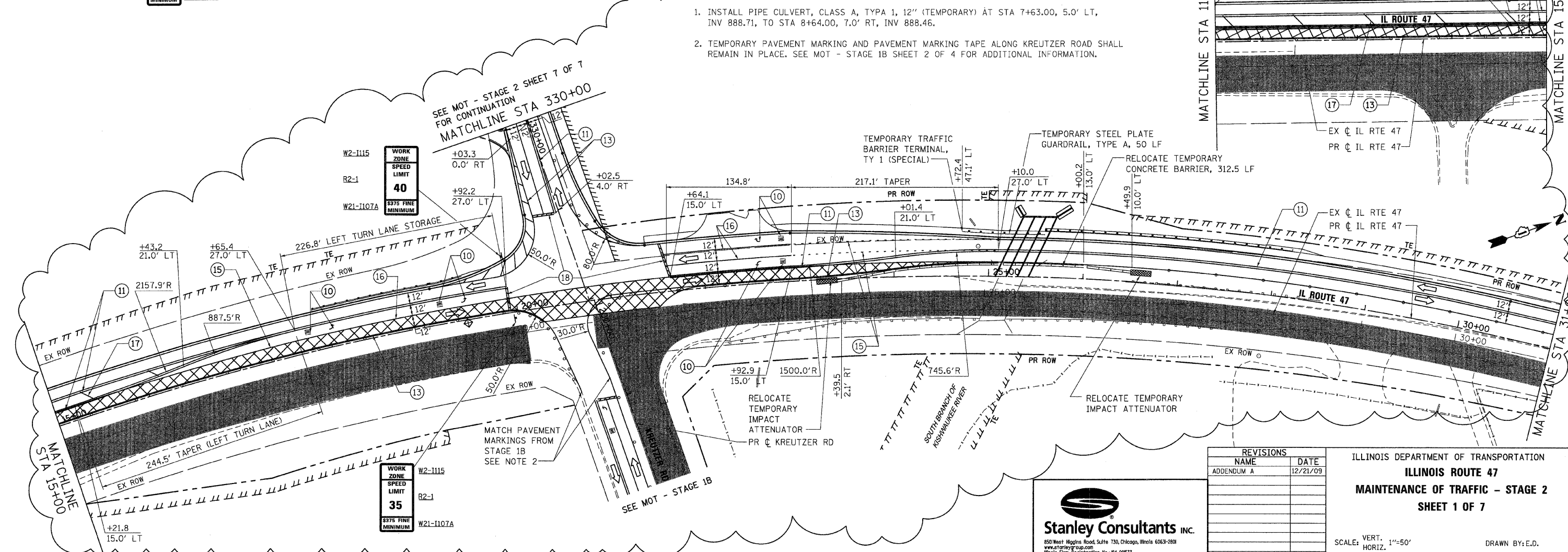

REVISIONS	
NAME	DATE
ADDENDUM A	12/21/09

ILLINOIS DEPARTMENT OF TRANSPORTATION
ILLINOIS ROUTE 47
MAINTENANCE OF TRAFFIC - STAGE 2
SHEET 1 OF 7

SCALE: VERT. 1"=50'
 HORIZ. 1"=50'
 DATE: 8/5/2009

DRAWN BY: E.D.
 CHECKED BY: A.A.C.

PLOT DATE = Thursday, December 17, 2009
 FILE NAME = S:\N1-CADD\01-ahs\881_inoc_s2_ahs1.dgn
 PLOT SCALE = 50%
 USER NAME = 36%