

F.A.P. RTE.	SECTION	COUNTY	TOTAL SHEETS	SHEET NO.
326	*	McHENRY	502	87
STA. 9+35.22		TO STA. 142+08.53		
FED. ROAD DIST. NO.		ILLINOIS FED. AID PROJECT		
• (105X & 106) WRS-2				

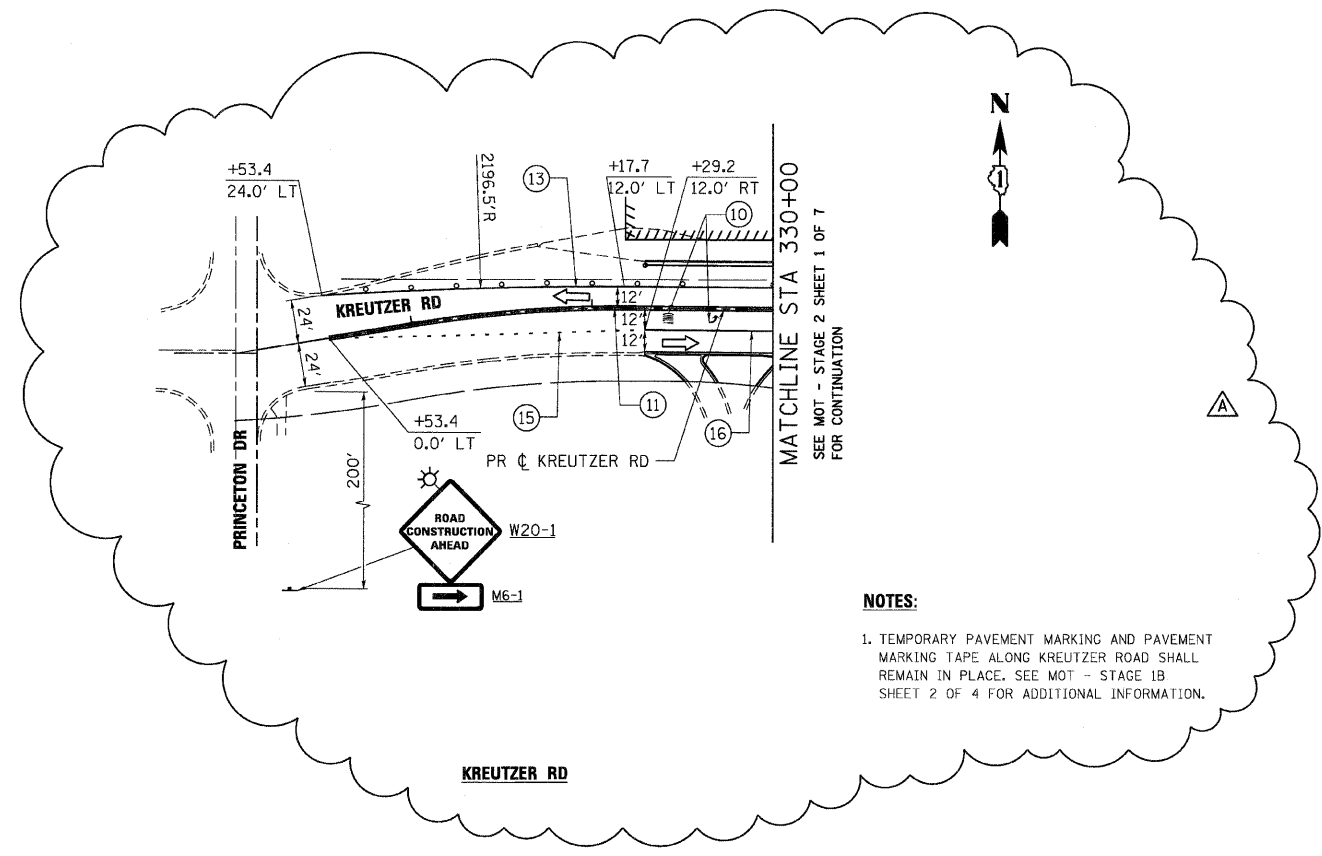

NOTES:
 1. TEMPORARY PAVEMENT MARKING AND PAVEMENT MARKING TAPE ALONG KREUTZER ROAD SHALL REMAIN IN PLACE. SEE MOT - STAGE 1B SHEET 2 OF 4 FOR ADDITIONAL INFORMATION.

PLOT DATE = Thursday, December 17, 2009
 FILE NAME = S:\11-CADD\11-11-09\11-11-09\11-11-09.dgn
 PLOT SCALE = 5/8"=1'
 USER NAME = 3659

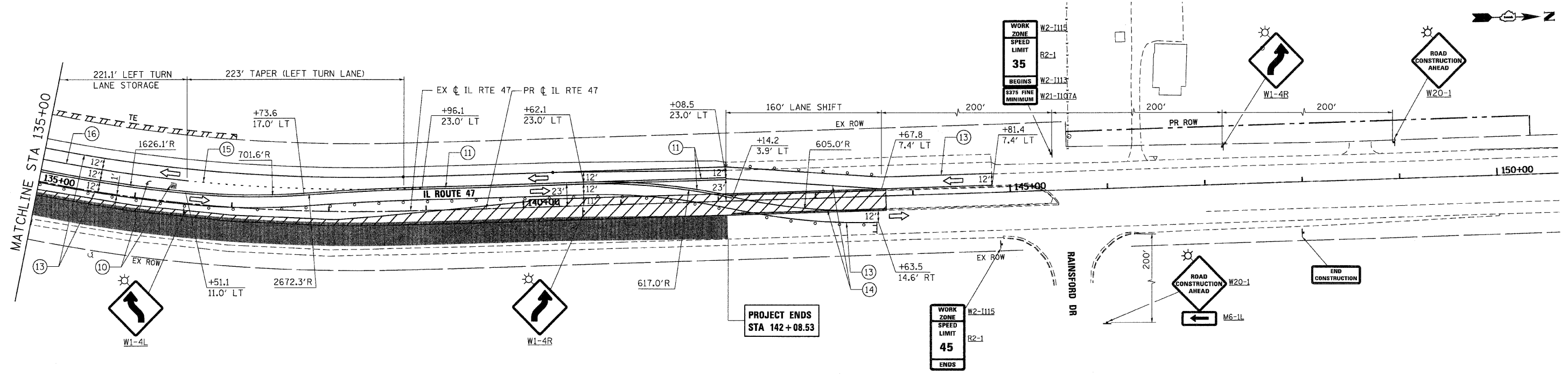

REVISIONS	
NAME	DATE
ADDENDUM A	12/21/09

ILLINOIS DEPARTMENT OF TRANSPORTATION
**ILLINOIS ROUTE 47 AND KREUTZER RD
 MAINTENANCE OF TRAFFIC - STAGE 2
 SHEET 7 OF 7**

SCALE: VERT. 1"=50'
 HORIZ. 1"=50'
 DATE: 8/5/2009

DRAWN BY: E.D.
 CHECKED BY: A.A.C.