

F.A.P. RTE.	SECTION	COUNTY	TOTAL SHEETS	SHEET NO.
326	*	McHENRY	502	250
STA. 9+35.22		TO STA.142+08.53		
FED. ROAD DIST. NO.		ILLINOIS FED. AID PROJECT		
*(105X & 106) WRS-2				

LEGEND:

- CONSTRUCTION JOINT W/TIE BARS
- SAWED LONGITUDINAL JOINT W/TIE BARS
- SEPARATION JOINT WITH SLEEPER SLAB (SEE DETAIL ON THIS SHEET)
- SAWED CONTRACTION JOINT
- PROPOSED TRAFFIC SIGNAL HEAVY DUTY HANDHOLE (SEE STANDARD 814001 FOR MORE INFORMATION)
- PROPOSED MANHOLE
- PROPOSED CATCH BASIN
- PROPOSED INLET (SEE STANDARDS 420001, 420101, AND 420111 FOR MORE INFORMATION)
- HIGH EARLY STRENGTH PORTLAND CEMENT CONCRETE PAVEMENT, 10" (JOINTED) AGGREGATE SUBGRADE
- PANEL WITH DOWEL BARS ON ALL SIDES

NOTES:

1. ALL JOINTS EXCEPT SEPARATION JOINT WITH SLEEPER SLAB SHALL BE INCLUDED IN THE COST OF PORTLAND CEMENT CONCRETE PAVEMENT, 10" (JOINTED).
2. SEPARATION JOINT FILLER SHALL CONSIST OF A SHEET OF 1/2" BITUMINOUS PREFORMED FIBER JOINT FILLER CONFORMING TO ARTICLE 1051.03 OF THE STANDARD SPECIFICATIONS.
3. THE SEPARATION JOINT SHALL BE SEALED WITH A HOT POUR JOINT SEALER CONFORMING TO ARTICLE 1050.02 OF THE STANDARD SPECIFICATIONS.
4. A SINGLE LAYER OF FELT ROOFING PAPER SHALL SERVE AS A BOND BREAKER.
5. JOINT SHALL CONTINUE THROUGH COMBINATION CURB & GUTTER OR PCC SHOULDER.
6. PAVEMENT SEPARATION JOINT IS TO BE PAID FOR AS "SLEEPER SLAB" AND IS TO BE MEASURED IN PLACE PER LINEAL FOOT.
7. BOND BREAKER AND 1/2" JOINT AND FILLER SHALL BE INCIDENTAL TO THE PAY ITEM "SLEEPER SLAB".

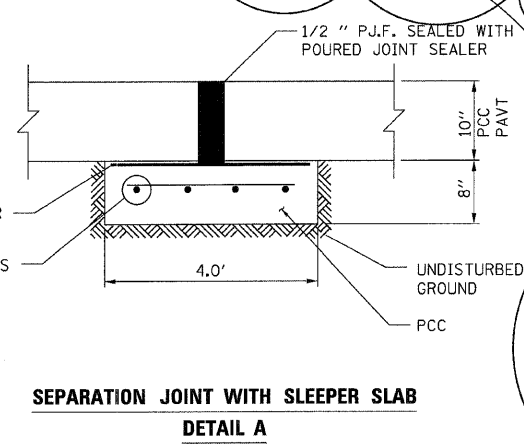
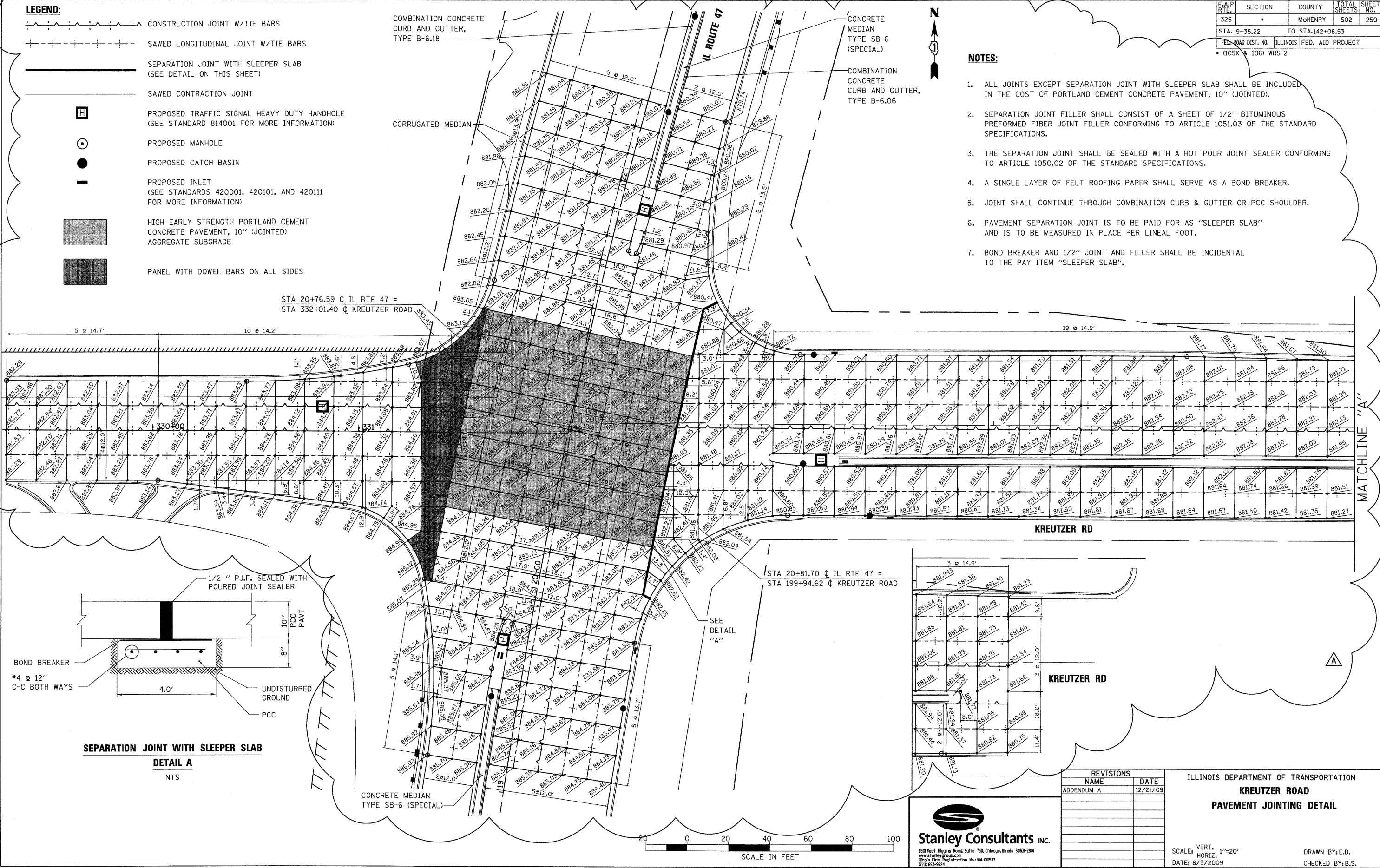

REVISIONS	
NAME	DATE
ADDENDUM A	12/21/09

ILLINOIS DEPARTMENT OF TRANSPORTATION
KREUTZER ROAD
PAVEMENT JOINTING DETAIL

SCALE: VERT. 1"=20'
 HORIZ. 1"=200'
 DATE: 8/5/2009

DRAWN BY: E.D.
 CHECKED BY: B.S.

Stanley Consultants INC.
 850 West Higgins Road, Suite 130, Chicago, Illinois 60633-2800
 www.stanleyconsultants.com
 Illinois State Registration No. 84-00633
 (773) 652-2800

PLOT DATE = Thursday, December 17, 2009
 FILE NAME = S:\1-CADD\81-mh\250-1-rc.dwg\11a_kreutzer.dgn
 PLOT SCALE = 200
 USER NAME = 3659