

F.A.P. RTE.	SECTION	COUNTY	TOTAL SHEETS	SHEET NO.
326	*	McHENRY	502	277
STA.		TO STA.		
FED. ROAD DIST. NO.		ILLINOIS	FED. AID PROJECT:	

• (105X & 106) WRS-2

**TEMPORARY TRAFFIC SIGNAL LEGEND**

- ← TEMPORARY TRAFFIC SIGNAL HEAD SPAN WIRE MOUNTED ORIGINAL LOCATION
- ← TEMPORARY TRAFFIC SIGNAL HEAD SPAN WIRE MOUNTED SECONDARY LOCATION
- ⊗ TEMPORARY WOOD POLE (CLASS 5 OR BETTER) 45 FOOT (13.7m) MINIMUM
- ⊠ TEMPORARY CONTROLLER CABINET
- TEMPORARY SPAN WIRE, TETHER WIRE, AND CABLE
- ⊕ TEMPORARY SERVICE INSTALLATION
- ⊠ TEMPORARY PEDESTRIAN SIGNAL HEAD, BRACKET MOUNTED
- ⊠ MICROWAVE VEHICLE SENSOR
- ⊠ PEDESTRIAN PUSHBUTTON DETECTOR
- ⊠ EMERGENCY VEHICLE LIGHT DETECTOR
- ⊠ CONFIRMATION BEACON
- ⊠ VEHICLE DETECTOR, INDUCTION LOOP
- CT COMMON TRENCH
- UD UNIT DUCT
- G.S. CONDUIT IN GROUND
- ⊠ HANDHOLE
- ⊠ HEAVY DUTY HANDHOLE
- ⊠ VIDEO CAMERA ASSEMBLY

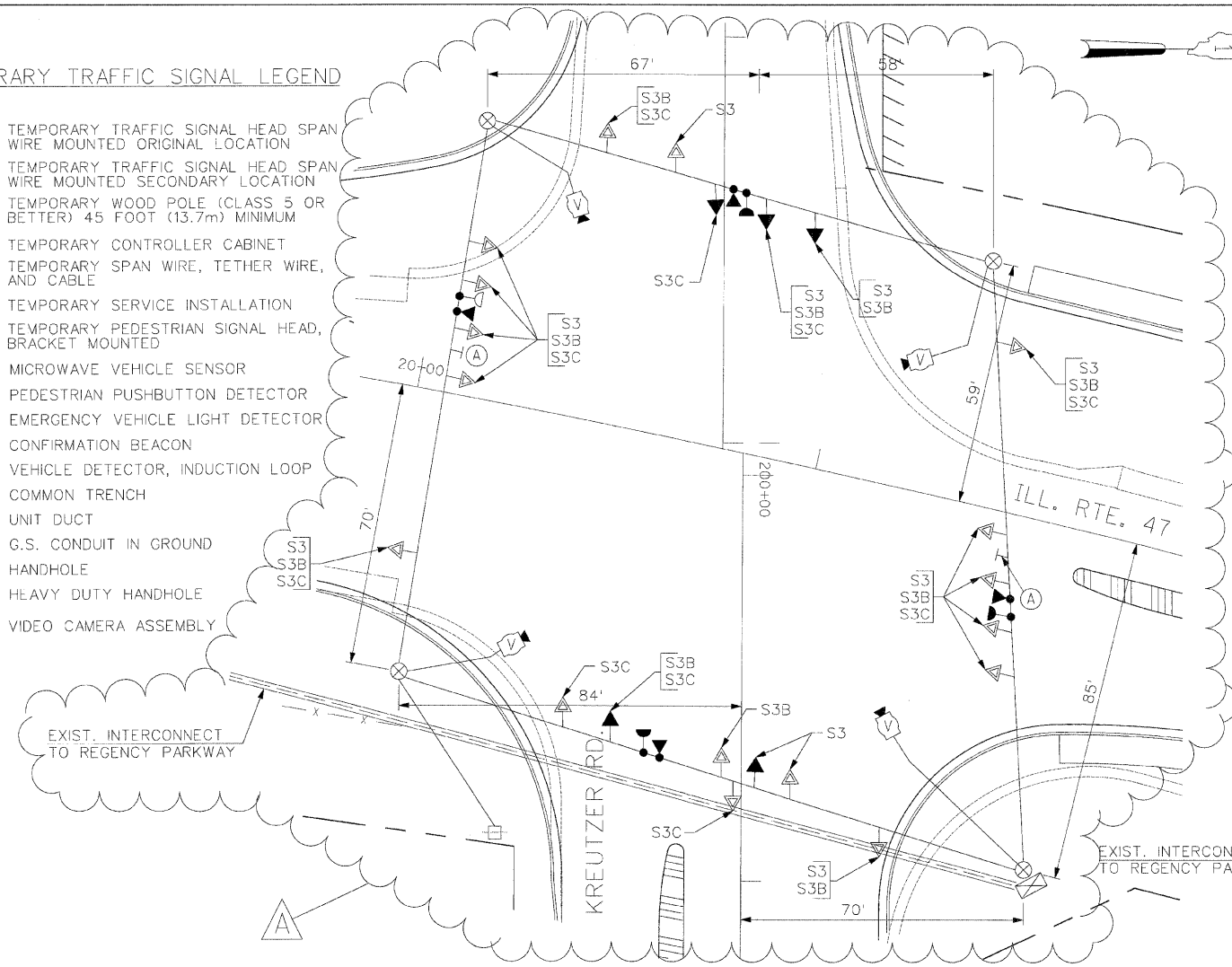

**TEMPORARY TRAFFIC SIGNAL PLAN**  
 (SCALE: 1"=20')  
 STAGES: STAGE 3, STAGE 3B, AND STAGE 3C

(A)  
 LEFT ON GREEN ARROW ONLY  
 R10-5, 24" X 30"  
 (2 REQUIRED, INCIDENTAL)

**TEMPORARY CABLE DIAGRAM LEGEND**

- ⊠ TEMPORARY TRAFFIC SIGNAL SECTION OR PEDESTRIAN SIGNAL SECTION 12" (300mm)
- ⊠ TEMPORARY CONTROLLER CABINET
- ⊠ TEMPORARY SERVICE INSTALLATION
- ⊠ INDICATES NUMBER OF CONDUCTORS IN CABLE. ALL CONDUCTORS TO BE NUMBER 14 AWG WIRE UNLESS OTHERWISE NOTED.
- ⊠ EMERGENCY VEHICLE LIGHT DETECTOR
- ⊠ CONFIRMATION BEACON
- ⊠ VEHICLE DETECTOR, INDUCTION LOOP
- ⊠ PEDESTRIAN PUSHBUTTON DETECTOR
- ⊠ 12" (300mm) PEDESTRIAN SIGNAL SECTION
- ⊠ VIDEO CAMERA ASSEMBLY
- ⊠ CO-AXIAL VIDEO CABLE

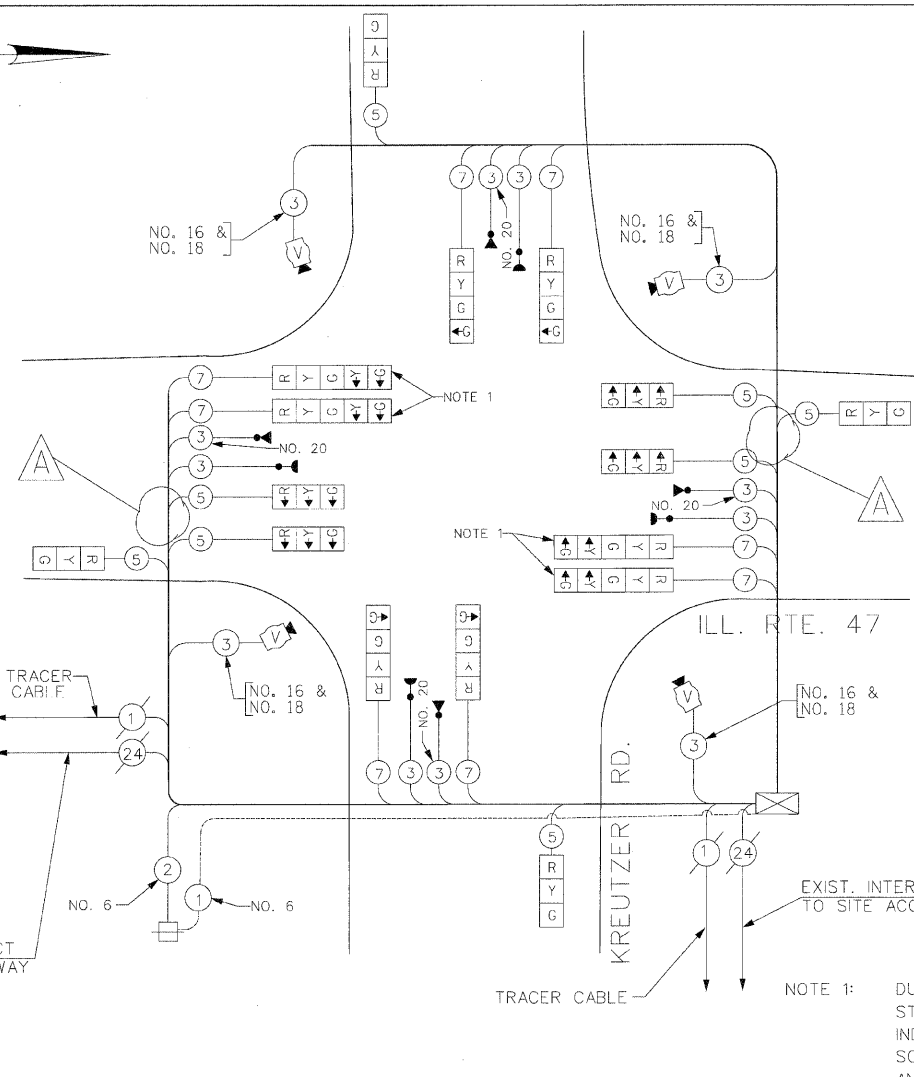

**TEMPORARY CABLE PLAN**  
 (NOT TO SCALE)  
 STAGES: STAGE 3, STAGE 3B, AND STAGE 3C

- NOTE 1: DURING CONSTRUCTION STAGES STAGE 3, STAGE 3B, AND STAGE 3C, THE GREEN AND YELLOW LEFT ARROW INDICATION SECTIONS FOR THE NORTHBOUND AND SOUTHBOUND DIRECTION OF TRAFFIC SHALL BE BAGGED AND DISCONNECTED AT THE CONTROLLER. THEY SHALL BE UNBAGGED AND CONNECTED AFTER CONSTRUCTION STAGE 3C AS DIRECTED BY THE ENGINEER.
- NOTE 2: ALL THE VIDEO DETECTION ZONES SHALL BE REDEFINED FOR EACH CONSTRUCTION STAGE. THIS WORK IS INCIDENTAL TO THE PAY ITEM "MODIFY TEMPORARY TRAFFIC SIGNAL INSTALLATION".
- NOTE 3: ALL THE TEMPORARY TRAFFIC SIGNAL HEADS SHALL BE LED TYPE.

I.D.O.T. TRAFFIC SIGNAL INSTALLATION ELECTRICAL SERVICE REQUIREMENTS					TOTAL WATTAGE
TYPE	NO LAMPS	WATTAGE		%OPERATION	
		INCAND.	LED		
SIGNAL (RED)	16	35	17	0.50	136
(YELLOW)	16	35	25	0.25	100
ARROW (GREEN)	20	35	15	0.25	75
PED. SIGNAL		35	12	0.10	
CONTROLLER	1	90	25	1.00	100
ILLUM. SIGN		100	100	0.05	
FLASHER				0.50	
ENERGY COSTS TO:				TOTAL =	411

ILLINOIS DEPARTMENT OF TRANSPORTATION  
 201 WEST CENTER COURT  
 SCHAMBURG, ILLINOIS 60196-1096

ENERGY SUPPLY CONTACT: KATIE OLIVA  
 PHONE: (847) 608-2338  
 COMPANY: COMED

THE TRAFFIC SIGNAL CONTROL EQUIPMENT FOR THIS PROJECT SHALL BE "EAGLE" TO MATCH THE EXISTING ADJACENT SYSTEM.

ILLINOIS DEPARTMENT OF TRANSPORTATION

TEMPORARY TRAFFIC SIGNAL INSTALLATION PLAN, TEMPORARY CABLE PLAN  
 ILLINOIS ROUTE 47 AT KREUTZER ROAD  
 STAGE 3, STAGE 3B, AND STAGE 3C  
 (SHEET 5 OF 7)

SCALE: 1"=20'  
 DATE: APRIL 17, 2009

DRAWN BY: ME,MA,YB  
 DESIGNED BY: PKG/RRM  
 CHECKED BY: PKG/RRM

**GO** GANDHI AND ASSOCIATES, INC.  
 ENGINEERS AND PLANNERS  
 6035 N. NORTHWEST HIGHWAY  
 SUITE 306  
 CHICAGO, ILLINOIS 60631 TEL: (773) 774-5900

REVISIONS	
NAME	DATE
ADDENDUM A	12/21/2009

projects 2008\1 rte 47\104\_08A-L470KREUTZER RD\_Temp\_int2\_CD2.dgn  
 12/16/2009  
 6149631.PDM