

F.A.P. RTE.	SECTION	COUNTY	TOTAL SHEETS	SHEET NO
326	*	McHENRY	502	310
STA.	TO STA.			
FED. ROAD DIST. NO.	ILLINOIS	FED. AID PROJECT:		

\* (105X & 106) WRS-2

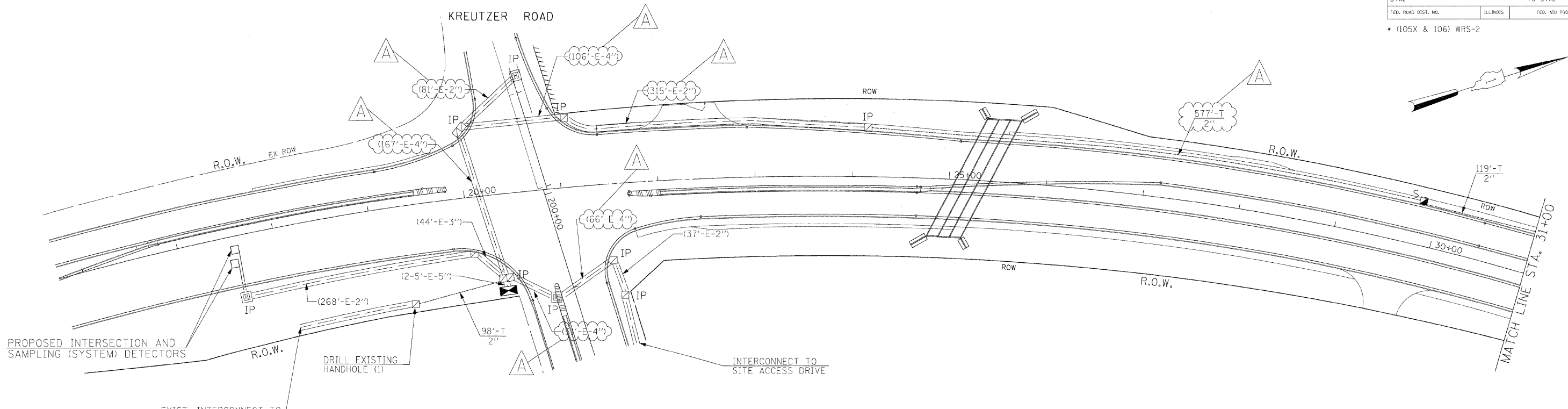

THE PROPOSED HANDHOLES SHALL BE CONSTRUCTED OUTSIDE OF THE PROPOSED SIDEWALK AREA.

RESTORATION OF WORK AREA. RESTORATION OF THE TRAFFIC SIGNAL WORK AREA SHALL BE INCIDENTAL TO THE RELATED PAY ITEMS SUCH AS FOUNDATION, CONDUIT, HANDHOLE, TRENCH, AND BACKFILL, ETC., AND NO EXTRA COMPENSATION SHALL BE ALLOWED. ALL ROADWAY SURFACES SUCH AS SHOULDERS, MEDIANS, SIDEWALKS, PAVEMENT, ETC. SHALL BE REPLACED IN KIND. ALL DAMAGE TO MOWED LAWNS SHALL BE REPLACED WITH AN APPROVED SOD, AND ALL DAMAGE TO UNMOWED FIELDS SHALL BE SEEDING IN ACCORDANCE WITH STANDARD SPECIFICATIONS 252 AND 250 RESPECTIVELY.

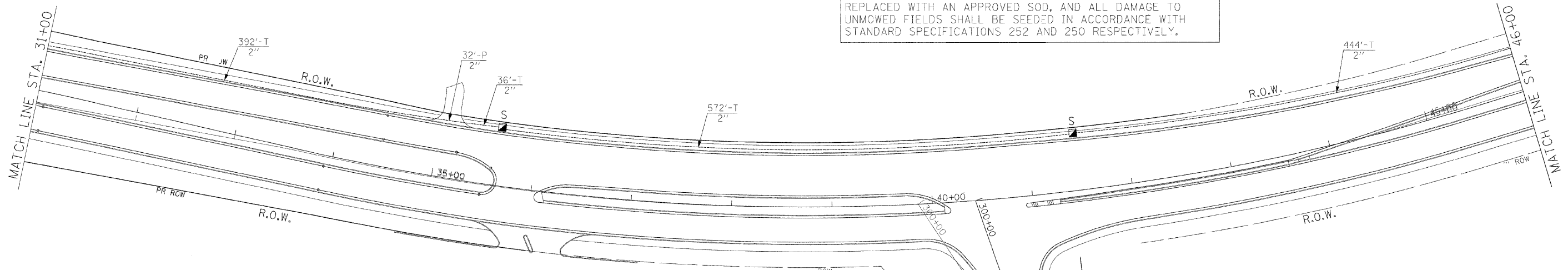

**INTERCONNECT PLAN LEGEND**

	PROPOSED	EXISTING
CONTROLLER		
HANDHOLE		
DOUBLE HANDHOLE		
HEAVY DUTY HANDHOLE		
GALVANIZED STEEL CONDUIT IN TRENCH OR PUSHED		
DETECTOR LOOP		
COMMON TRENCH	CT	
UNIT DUCT	UD	
SYSTEM	S	
INTERSECTION	IP	I
TELEPHONE CONNECTION	T	T

**GENERAL NOTE**  
 PRIOR TO TURNING PROPOSED TRAFFIC SIGNAL INSTALLATION ON, THE EXISTING INTERCONNECT AND TRACER CABLES GOING SOUTH AND EAST FROM THE TEMPORARY SIGNAL CONTROLLER AT ILL. RTE. 47 AND KREUTZER ROAD, SHALL BE DISCONNECTED AND CONNECTED INTO THE PROPOSED TRAFFIC SIGNAL CONTROLLER AT ILL. RTE. 47 AND KREUTZER ROAD. THE ACCESS CABLES PROVIDED FOR THIS PROPOSE, DURING INSTALLATION OF TEMPORARY TRAFFIC SIGNAL SHOULD ELIMINATE THE NECESSITY OF PROVIDING NEW CABLES. THIS WORK SHALL BE PAID FOR AT THE CONTRACT UNIT PRICE PER FOOT "REMOVE AND REINSTALL ELECTRIC CABLE FROM CONDUIT" AND NO ADDITIONAL COMPENSATION SHALL BE ALLOWED FOR THE SAME.

THE TRAFFIC SIGNAL CONTROL EQUIPMENT FOR THIS PROJECT SHALL BE "EAGLE" TO MATCH THE EXISTING ADJACENT SYSTEM.

ILLINOIS DEPARTMENT OF TRANSPORTATION  
 PROPOSED INTERCONNECT PLAN  
 ILLINOIS ROUTE 47 FROM  
 KRFUTZFR ROAD TO  
 REED ROAD  
 (SHEET 1 OF 4)

SCALE: 1"=50'  
 DATE: APRIL 17, 2009

DRAWN BY: MAA  
 DESIGNED BY: PKG/RRM  
 CHECKED BY: PKG/RRM

REVISIONS	
NAME	DATE
ADDENDUM A	12/21/2009

**ga** GANDHI AND ASSOCIATES, INC.  
 ENGINEERS AND PLANNERS  
 6035 N. NORTHWEST HIGHWAY  
 SUITE 306  
 CHICAGO, ILLINOIS 60631 TEL. (773) 774-5910