

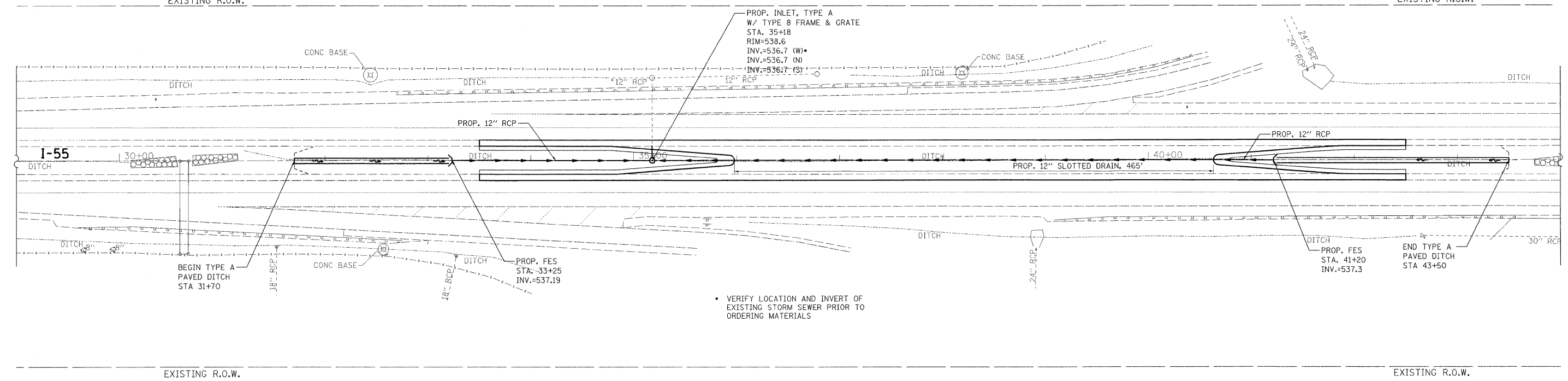

EXISTING R.O.W.

EXISTING R.O.W.



EXISTING R.O.W.

EXISTING R.O.W.

PLAN SURVEYED BY DATE
 PLOTTED BY
 CHECKED BY
 RT. OF WAY CHECKED BY
 NO. PAID FILE NAME

PROFILE SURVEYED BY DATE
 PLOTTED BY
 CHECKED BY
 STRUCTURE NOTATIONS CHKD BY
 NO.

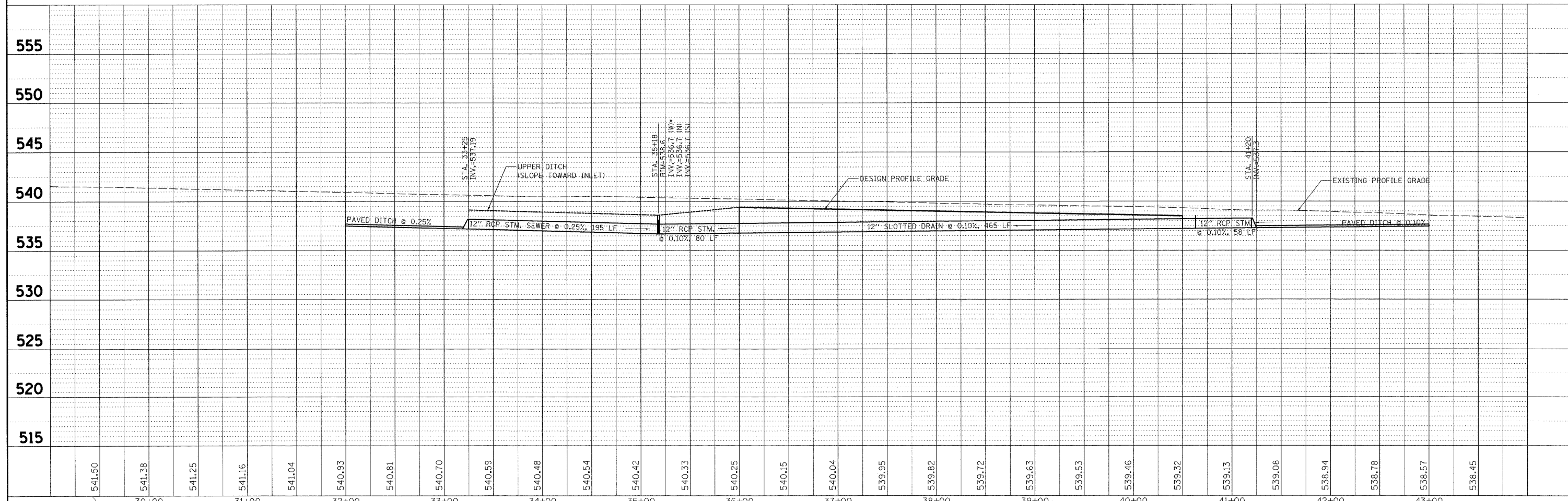

541.50	541.38	541.25	541.16	541.04	540.93	540.81	540.70	540.59	540.48	540.54	540.42	540.33	540.25	540.15	540.04	539.95	539.82	539.72	539.63	539.53	539.46	539.32	539.13	539.08	538.94	538.78	538.57	538.45
30+00		31+00		32+00		33+00		34+00		35+00		36+00		37+00		38+00		39+00		40+00		41+00		42+00		43+00		



200 West Front Street
 Wheaton, IL 60187

DESIGNED -	REVISED -
DRAWN -	REVISED -
CHECKED -	REVISED -
DATE -	REVISED -

STATE OF ILLINOIS
 DEPARTMENT OF TRANSPORTATION

**SOUTH CROSSOVER
 DRAINAGE PLAN & PROFILE**

SCALE: 1" = 50' SHEET NO. 1 OF 2 SHEETS STA. 29+00.00 TO STA. 44+00.00

F.A.I. RTE.	SECTION	COUNTY	TOTAL SHEETS	SHEET NO.
55	BB (B&B-1) BR	WILL	72	22
FED. ROAD DIST. NO.		ILLINOIS FED. AID PROJECT		
CONTRACT NO. 62930				