

F.A.U. RTE.	SECTION	COUNTY	TOTAL SHEETS	SHEET NO.
2662	08-00041-00-RS	DuPAGE	25	7
STA. 1+25		TO STA. 13+00		
ILLINOIS		FED. AID PROJECT		
CONTRACT NO. 63098				

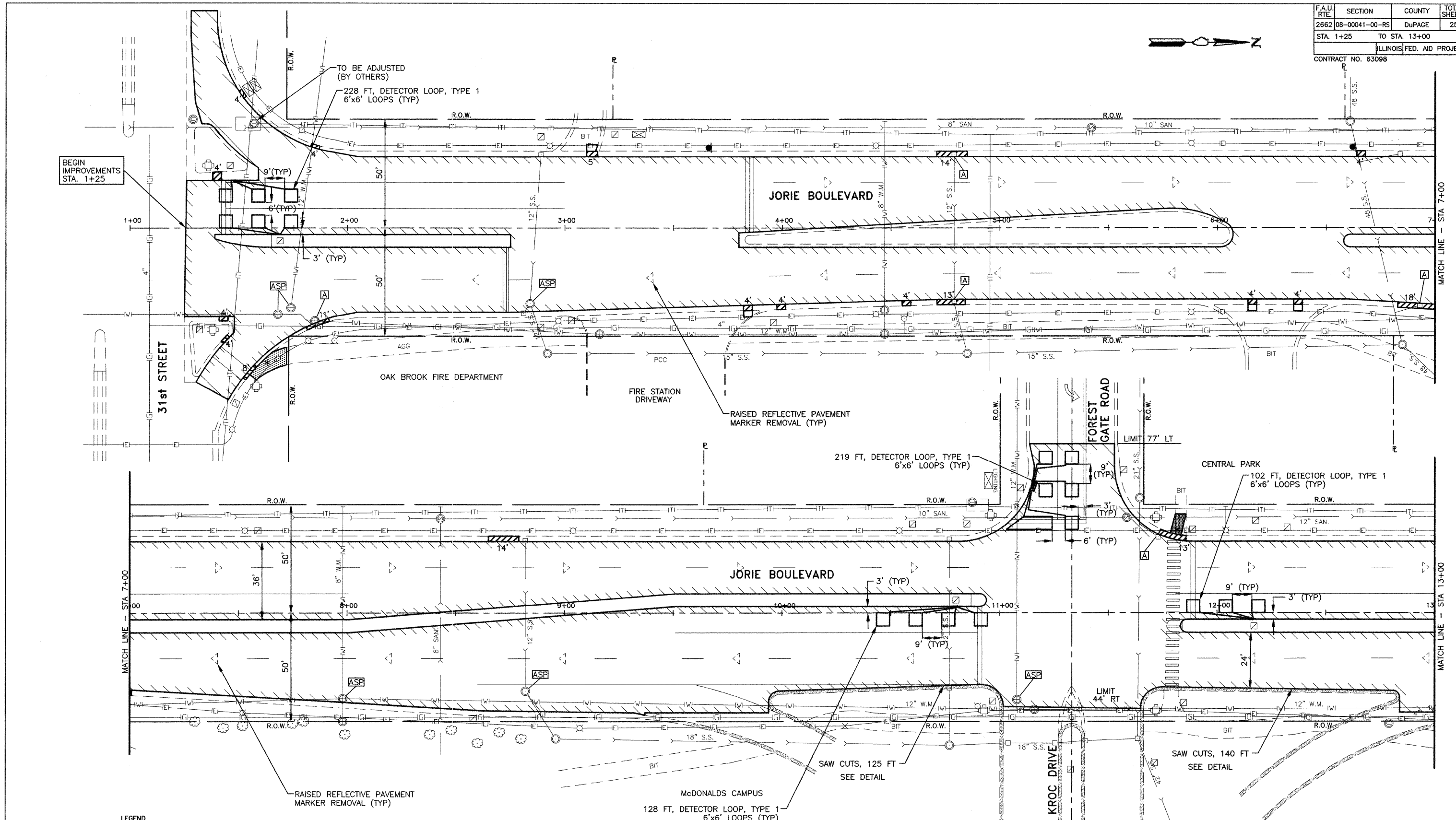

**LEGEND**

- (A) STRUCTURE TO BE ADJUSTED
- (B) STRUCTURE TO BE ADJUSTED WITH NEW FRAME & LID
- (C) STRUCTURE TO BE RECONSTRUCTED
- (D) STRUCTURE TO BE REMOVED
- (ASP) STRUCTURE TO BE ADJUSTED SPECIAL
- (R) STRUCTURE TO BE RECONSTRUCTED WITH NEW FRAME & LID
- (RM) STRUCTURE TO BE REMOVED
- HOT-MIX ASPHALT SURFACE REMOVAL LIMIT
- COMBINATION CURB AND GUTTER REMOVAL OR CURB REMOVAL
- SIDEWALK REMOVAL
- DRIVEWAY REMOVAL AND REPLACEMENT AT CURB REPAIRS
- \* DETECTIBLE WARNINGS

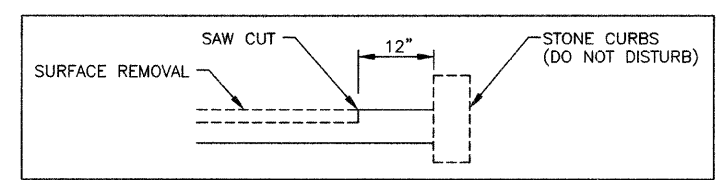

**JAMES J. BENES & ASSOCIATES, INC.**  
 950 Warrenville Road, Suite 101, Lisle, Illinois 60532  
 Tel. (630) 719-7570 • Fax (630) 719-7589

REVISIONS	
NAME	DATE

ILLINOIS DEPARTMENT OF TRANSPORTATION  
 F.A.U. ROUTE 2662  
 JORIE BOULEVARD  
 PLAN VIEW  
 STA 1+25 TO STA 13+00  
 SCALE: 1"=20'  
 DATE: 03/04/08  
 DRAWN BY: BCD  
 CHECKED BY: JDM