

F.A. RTE.	SECTION	COUNTY	TOTAL SHEETS	SHEET NO.
3514	09-00209-00-SW	COOK	11	1
FED. ROAD DIST. NO. 1-	ILLINOIS	CONTRACT NO. 63276		

# STATE OF ILLINOIS DEPARTMENT OF TRANSPORTATION DIVISION OF HIGHWAYS

## PLANS FOR PROPOSED FEDERAL AID HIGHWAY

F.A.U. ROUTE 3514 : ALGONQUIN ROAD  
CITY OF DES PLAINES  
COOK COUNTY

SECTION NO. 09-00209-00-SW  
PROJECT NO. ARA-9003 (430)  
JOB NO. C-91-863-09  
CONSTRUCTION OF SIDEWALK ALONG ALGONQUIN ROAD  
FROM SEYMOUR AVENUE TO MT. PROSPECT ROAD

**INDEX OF SHEETS**

DESCRIPTION	SHEET NO.
TITLE SHEET	1
GENERAL NOTES, SUMMARY OF QUANTITIES AND HIGHWAY STANDARDS	2
EXISTING AND PROPOSED TYPICAL SECTIONS	3
ALGONQUIN ROAD SIDEWALK GEOMETRIC PLAN	4-5
ALGONQUIN ROAD SIDEWALK PLAN & PROFILE	6-9
DETAILS	10-11

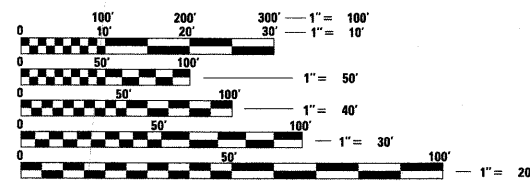
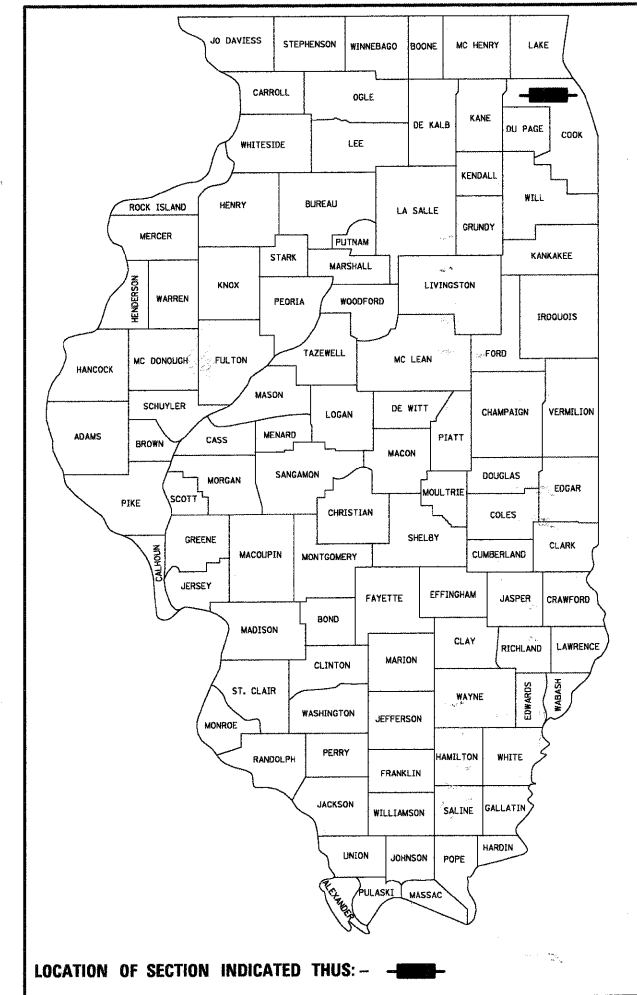

FULL SIZE PLANS HAVE BEEN PREPARED USING STANDARD ENGINEERING SCALES. REDUCED SIZED PLANS WILL NOT CONFORM TO STANDARD SCALES. IN MAKING MEASUREMENTS ON REDUCED PLANS, THE ABOVE SCALES MAY BE USED.

J.U.L.I.E.  
JOINT UTILITY LOCATION INFORMATION FOR EXCAVATION  
8-1-1 OR 1-800-892-0123

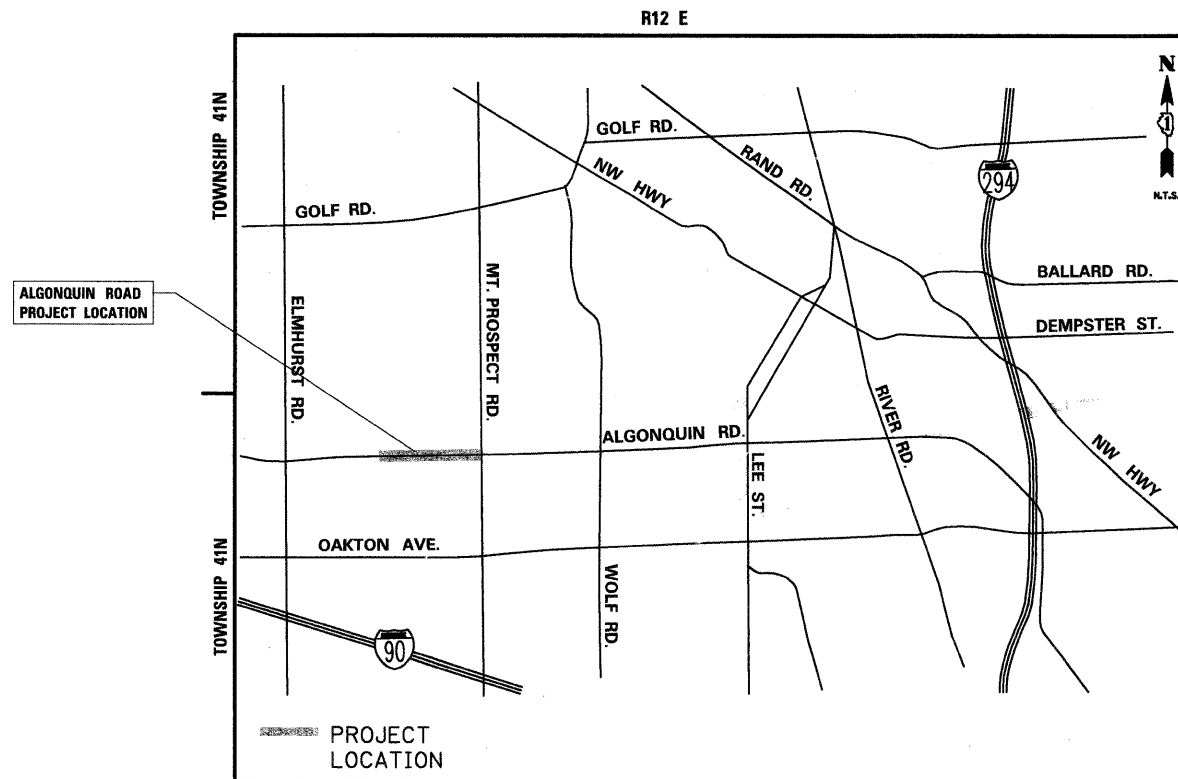

**LOCATION MAP**

ALGONQUIN ROAD  
GROSS LENGTH OF PROJECT = 3,267 LINEAL FEET (0.62 MILES)  
NET LENGTH OF PROJECT = 3,161 LINEAL FEET (0.60 MILES)

**TRAFFIC DATA**

ALGONQUIN ROAD  
ADT = 16,500  
SPEED LIMIT = 35 MPH  
FUNCTIONAL CLASSIFICATION : MINOR ARTERIAL



**CONSULTING ENGINEERS  
SITE DEVELOPMENT ENGINEERS  
LAND SURVEYORS**

9575 W. Higgins Road, Suite 700,  
Rosemont, Illinois 60018  
Phone: (847) 696-4060 Fax: (847) 696-4065

**STATE OF ILLINOIS  
DEPARTMENT OF TRANSPORTATION  
DIVISION OF HIGHWAYS**

APPROVED October 19, 2009  
*[Signature]*  
CITY ENGINEER, CITY OF DES PLAINES

PASSED OCTOBER 26, 2009  
*[Signature]*  
DISTRICT 1 ENGINEER OF LOCAL ROADS AND STREETS

RELEASING FOR  
BID BASED ON  
LIMITED REVIEW OCTOBER 26, 2009  
*[Signature]*  
DEPUTY DIRECTOR OF HIGHWAYS, REGION ONE ENGINEER

**STATE OF ILLINOIS  
DEPARTMENT OF TRANSPORTATION  
DIVISION OF HIGHWAYS**

*[Signature]* 10-19-09  
ENGINEER DATE

**MICHAEL S. MONDUS**  
ILLINOIS REGISTRATION No. 062-052057  
EXPIRATION DATE: 11/30/2011

ASSOCIATE FIELD ENGINEER: KEVIN STALLWORTH (847) 705-4169

**GENERAL NOTES:**

1. BEFORE STARTING ANY EXCAVATION, THE CONTRACTOR SHALL CALL "JULIE" AT (800) 892-0123 OR 811 FOR FIELD LOCATIONS OF BURIED ELECTRIC, TELEPHONE AND GAS FACILITIES. (48 HOUR NOTIFICATION REQUIRED)
2. THE CONTRACTOR WILL NOT BE ABLE TO SET UP A STORAGE AREA OR FIELD OFFICE ON STATE PROPERTY WITHOUT THE WRITTEN PERMISSION OF THE DEPARTMENT.
3. THE RESIDENT ENGINEER SHALL CONTACT MR. WALLY CZARNY, AREA TRAFFIC FIELD ENGINEER AT (773) 685-8386 A MINIMUM OF 2 WEEKS PRIOR TO PLACEMENT OF FINAL PAVEMENT MARKINGS.
4. THE RESIDENT ENGINEER SHALL CONTACT THE TRAFFIC SUPERVISOR AT (847) 705-4470 A MINIMUM OF 72 HOURS PRIOR TO THE INSTALLATION OF ANY TEMPORARY TRAFFIC CONTROL DEVICES.
5. DIMENSIONS: IT SHALL BE THE CONTRACTOR'S RESPONSIBILITY TO VERIFY ALL DIMENSIONS AND CONDITIONS EXISTING IN THE FIELD PRIOR TO ORDERING MATERIALS AND BEGINNING CONSTRUCTION.
6. ALL SAW CUTTING SHALL BE INCLUDED TO REMOVE ITEMS AND SHALL BE PERFORMED PRIOR TO BEGINNING REMOVAL. ANY ITEMS OF WORK REMOVED PRIOR TO SAW CUTTING WILL NOT BE MEASURED FOR PAYMENT.
7. THE THICKNESS OF HOT MIX ASPHALT MIXTURES SHOWN IN THE PLANS ARE NOMINAL. DEVIATIONS MAY OCCUR DUE TO IRREGULARITIES IN THE SURFACES OR BASIS ON WHICH THEY ARE TO BE PLACED. PLAN THICKNESS SHOULD BE CONSIDERED THE MINIMUM THICKNESS PERMITTED.
8. DEPRESSED CURB: RAMPS OR DEPRESSED CURBS ACCESSIBLE TO THE HANDICAPPED SHALL BE PROVIDED AT ALL CROSSWALKS. NON-ADA DEPRESSED CURB SHALL BE PROVIDED AT ALL ALLEYS OR DRIVEWAYS.
9. PAVEMENT GRADES: THE ELEVATIONS INDICATED ON THE PLANS ARE FINISHED GRADES OF PROPOSED PAVEMENT OR SURFACE COURSE, UNLESS OTHERWISE INDICATED.
10. ONLY THOSE TREES DESIGNATED BY THE ENGINEER SHALL BE REMOVED. THE CONTRACTOR SHALL PROTECT ALL REMAINING TREES FROM DAMAGE DUE TO HIS OPERATIONS.
11. ALL BRUSH CLEARING AND RIGHT OF WAY RESTORATION SHALL BE COMPLETED BY THE CONTRACTOR AND CONSIDERED INCIDENTAL TO THE PROJECT.
12. GRASS AREAS DISTURBED BY SIDEWALK CONSTRUCTION SHALL BE RESTORED WITH 6" OF TOPSOIL AND SODDED.
13. ANY DAMAGE TO DRIVEWAYS AND ENTRANCES SHALL BE RESTORED BY THE CONTRACTOR IN ACCORDANCE WITH THE CITY OF DES PLAINES DRIVEWAY APPROACH STANDARDS INCLUDED ON SHEET 10.

**HIGHWAY STANDARDS**

STANDARD NUMBER	DESCRIPTION
000001-05	STANDARD SYMBOLS, ABBREVIATIONS AND PATTERNS
280001-05	TEMPORARY EROSION CONTROL SYSTEMS
424001-05	CURB RAMPS FOR SIDEWALKS
542301-02	PRECAST REINFORCED CONCRETE FLARED END SECTION
542501-02	INLET - TYPE A
604001-03	FRAMES AND LIDS TYPE 1
606001-04	CONCRETE CURB TYPE B AND COMBINATION CONCRETE CURB AND GUTTER
701011-02	OFF-RD MOVING OPERATIONS, 2L, 2W, DAY ONLY
701501-05	URBAN LANE CLOSURE, 2L, 2W, UNDIVIDED
701801-04	LANE CLOSURE MULTILANE 1W OR 2W CROSSWALK OR SIDEWALK CLOSURE
701901-01	TRAFFIC CONTROL DEVICES
720001-01	SIGN PANEL MOUNTING DETAILS
720006-02	SIGN PANEL ERECTION DETAILS
729001-01	APPLICATIONS OF TYPES A & B METAL POSTS (FOR SIGNS & MARKERS)
780001-02	TYPICAL PAVEMENT MARKINGS

SUMMARY OF QUANTITIES					SFTY-1B
ITEM #	SPECIALTY ITEM	PAY CODE	DESCRIPTION	UNIT	ALGONQUIN ROAD QUANTITY
1		20100110	TREE REMOVAL (6 TO 15 UNITS DIAMETER)	UNIT	42
2		20200100	EARTH EXCAVATION	CU YD	440
3		21101625	TOPSOIL FURNISH AND PLACE 6"	SQ YD	2435
4		25200100	SODDING	SQ YD	2435
5		35101600	AGGREGATE BASE COURSE, TYPE B 4"	SQ YD	1760
6		42400200	PORTLAND CEMENT CONCRETE SIDEWALK 5 INCH	SQ FT	15840
7		42400800	DETECTABLE WARNINGS	SQ FT	60
8		44000600	SIDEWALK REMOVAL	SQ FT	106
9		54213657	PRECAST REINFORCED CONCRETE FLARED END SECTIONS 12"	EACH	1
10		550A0050	STORM SEWERS, CLASS A, TYPE 1 12"	FOOT	15
11		60234200	INLETS, TYPE A, TYPE 1 FRAME, OPEN LID	EACH	1
12		60300305	FRAMES AND LIDS TO BE ADJUSTED	EACH	1
13		60603800	COMBINATION CONCRETE CURB AND GUTTER, TYPE B-6.12	FOOT	135
14		67100100	MOBILIZATION	L SUM	1
15		70101700	TRAFFIC CONTROL AND PROTECTION	L SUM	1
16		70102620	TRAFFIC CONTROL AND PROTECTION, STANDARD 701501	L SUM	1
17		70102640	TRAFFIC CONTROL AND PROTECTION, STANDARD 701801	L SUM	1
18		72400500	RELOCATE SIGN PANEL ASSEMBLY - TYPE A	EACH	3
19		78000400	THERMOPLASTIC PAVEMENT MARKING - LINE 6"	FOOT	369
20		78000600	THERMOPLASTIC PAVEMENT MARKING - LINE 12"	FOOT	204
21		20017200	DOWEL BARS 1 1/4"	EACH	12
22		20062400	SAWING BITUMINOUS CONCRETE PAVEMENT	FOOT	135
23		X0656100	DRIVEWAY PAVEMENT REMOVAL AND REPLACEMENT	SQ YD	80

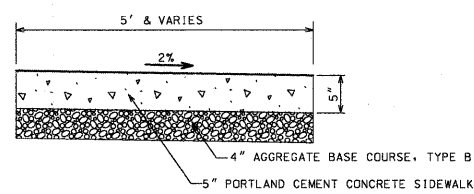
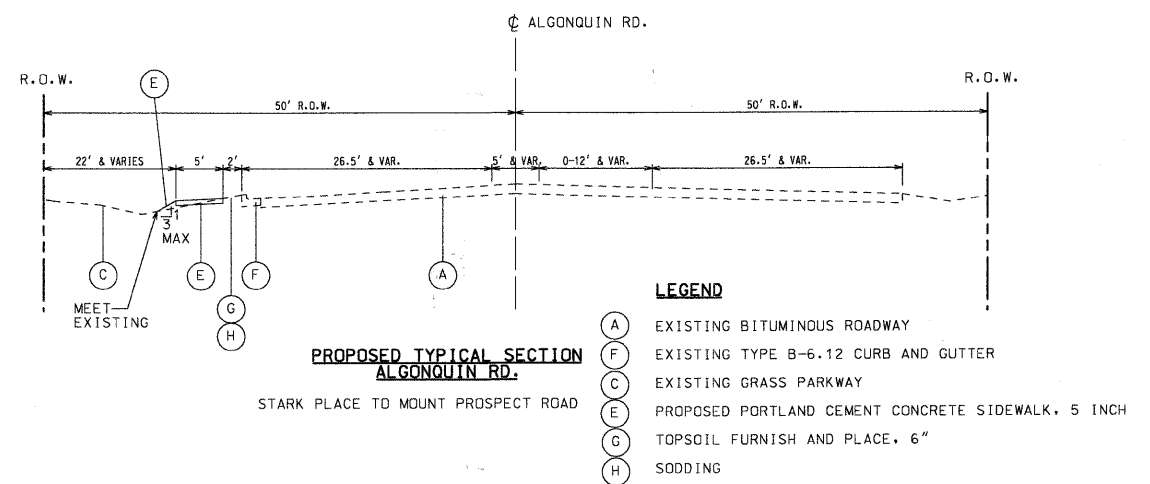
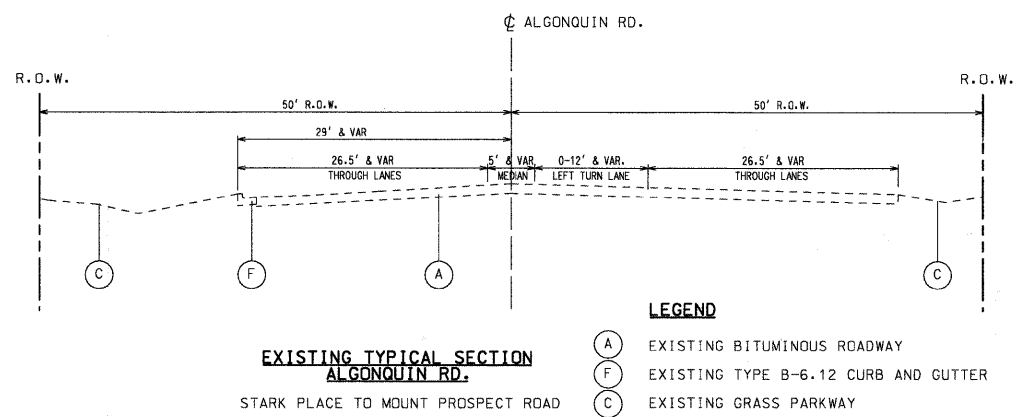
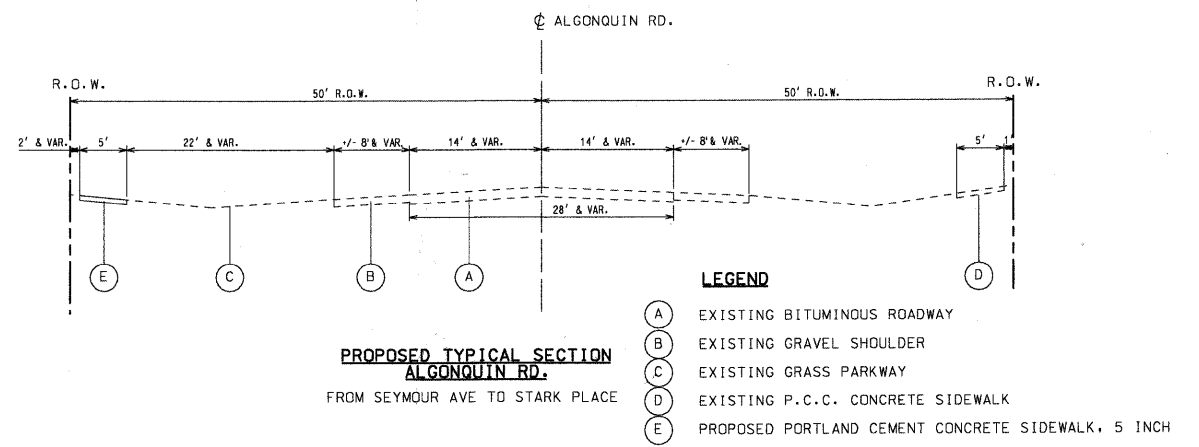
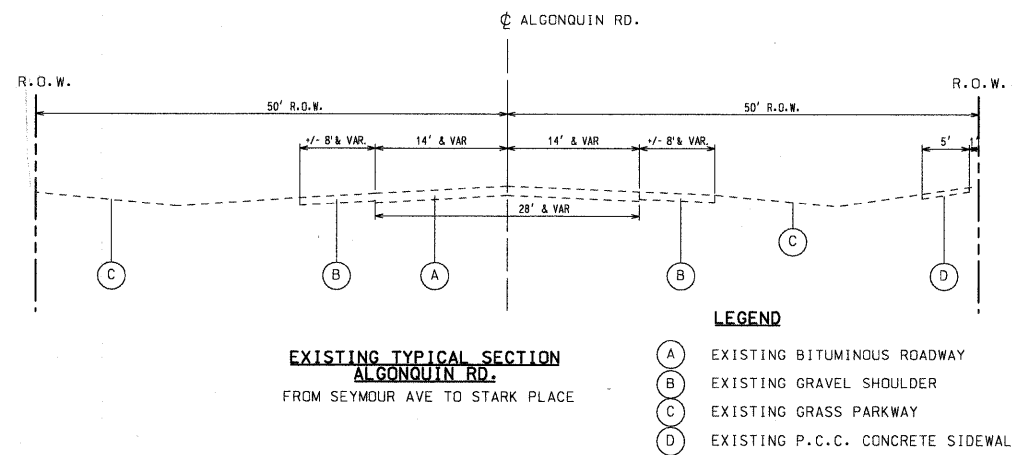

FILE NAME = 6049GN02.dgn  
\*FILEL\*

USER NAME = *USER*	DESIGNED -	REVISED -
PLOT SCALE = *SCALE*	CHECKED -	REVISED -
PLOT DATE = *DATE*	DRAWN -	REVISED -
	CHECKED -	REVISED -

**STATE OF ILLINOIS  
DEPARTMENT OF TRANSPORTATION**

**ALGONQUIN ROAD SIDEWALK PROJECT  
EXISTING AND PROPOSED TYPICAL SECTIONS**

SCALE: SHEET NO. 3 OF 11 SHEETS STA. TO STA.

F.A. RTE.	SECTION	COUNTY	TOTAL SHEETS	SHEET NO.
3514	09-00209-00-SW	COOK	11	3
CONTRACT NO. 63276				
FED. ROAD DIST. NO. 1 ILLINOIS FED. AID PROJECT				

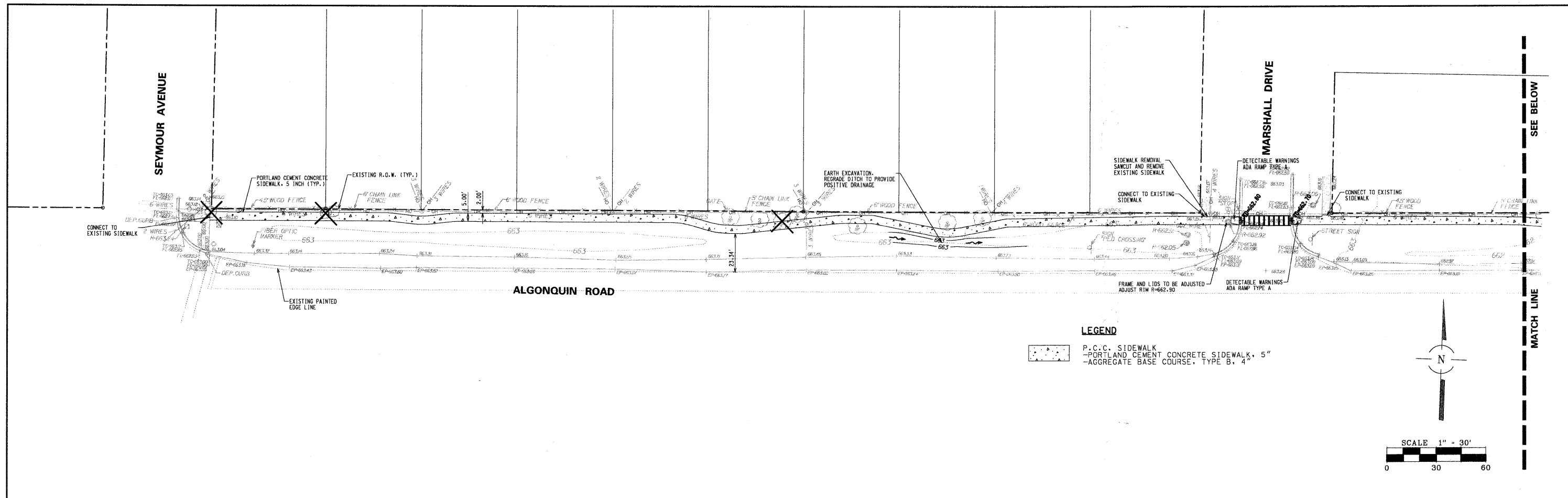

**LEGEND**  
 [Pattern] P.C.C. SIDEWALK  
 [Pattern] PORTLAND CEMENT CONCRETE SIDEWALK, 5"  
 [Pattern] AGGREGATE BASE COURSE, TYPE B, 4"

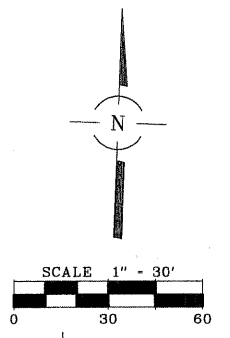
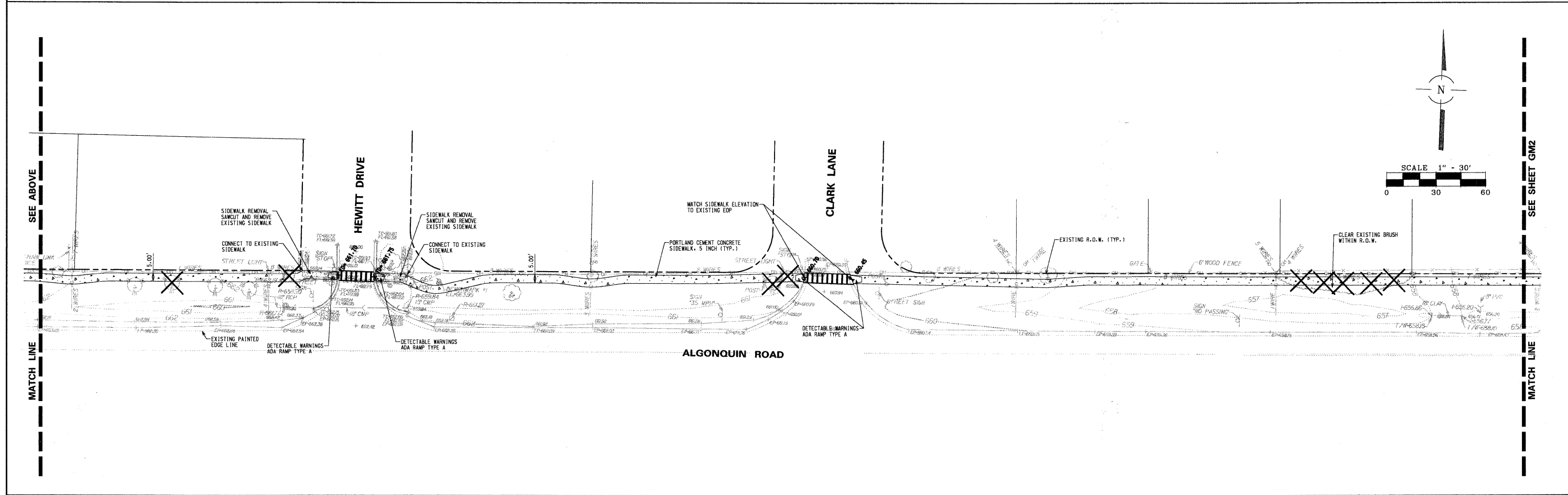
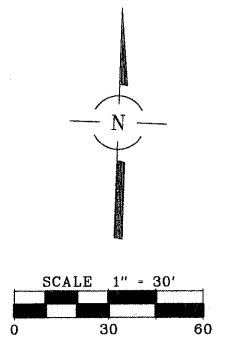

FILE NAME = #FILE#	USER NAME = #USER#	DESIGNED -	REVISED -	<b>STATE OF ILLINOIS DEPARTMENT OF TRANSPORTATION</b>	<b>ALGONQUIN ROAD SIDEWALK PLAN</b>	F.A. R.T.E. 3514	SECTION 09-00209-00-SW	COUNTY COOK	TOTAL SHEETS 11	SHEET NO. 4	
PLOT SCALE = #SCALE#	DRAWN -	REVISED -	SCALE:			SHEET NO. 4 OF 11 SHEETS	STA. TO STA.	FED. ROAD DIST. NO. 1 [ILLINOIS] FED. AID PROJECT			
PLOT DATE = #DATE#	CHECKED -	REVISED -	CONTRACT NO. 63276								

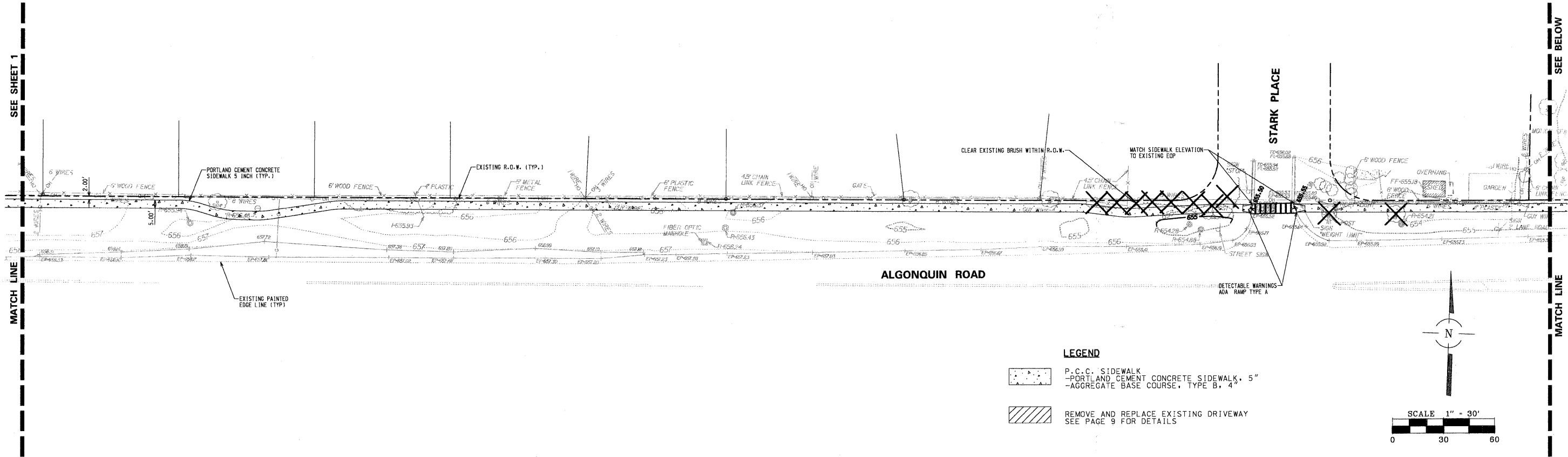

**LEGEND**

- P.C.C. SIDEWALK
- PORTLAND CEMENT CONCRETE SIDEWALK, 5"
- AGGREGATE BASE COURSE, TYPE B, 4"
- REMOVE AND REPLACE EXISTING DRIVEWAY

SEE PAGE 9 FOR DETAILS

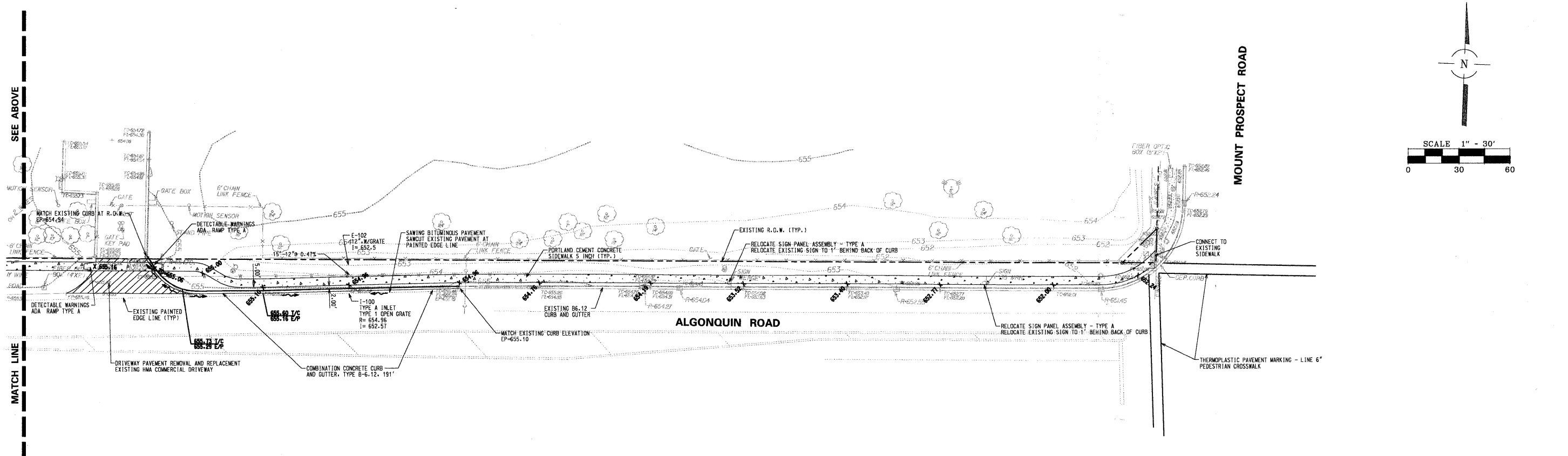

FILE NAME = *FILE*	USER NAME = *USER*	DESIGNED -	REVISED -	<b>STATE OF ILLINOIS DEPARTMENT OF TRANSPORTATION</b>	<b>ALGONQUIN ROAD SIDEWALK PLAN</b>	F.A. RTE.	SECTION	COUNTY	TOTAL SHEETS	SHEET NO.
	PLOT SCALE = *SCALE*	CHECKED -	REVISED -			3514	09-00209-00-SW	COOK	11	5
	PLOT DATE = *DATE*	DRAWN -	REVISED -			CONTRACT NO. 63276				
	CHECKED -	REVISED -		SCALE:	SHEET NO. 5 OF 11 SHEETS	STA.	TO STA.		FED. ROAD DIST. NO. 1 ILLINOIS FED. AID PROJECT	

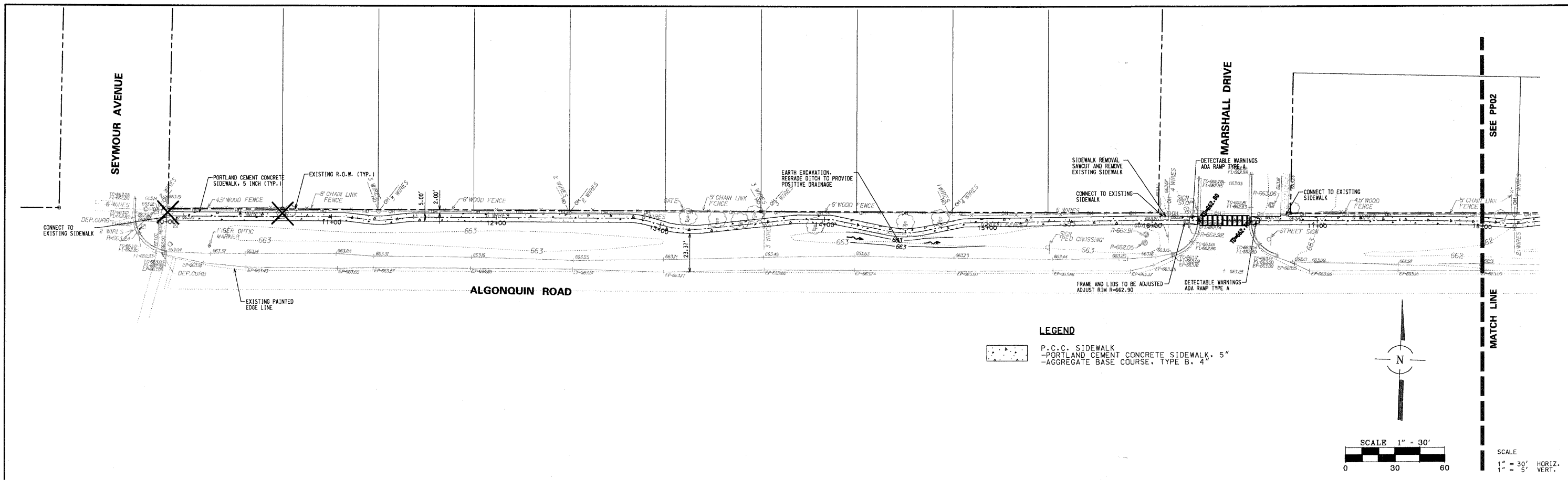

**LEGEND**

- P.C.C. SIDEWALK
- PORTLAND CEMENT CONCRETE SIDEWALK, 5"
- AGGREGATE BASE COURSE, TYPE B, 4"

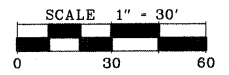
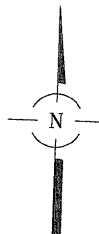

SCALE  
1" = 30'  
HORIZ.  
VERT.

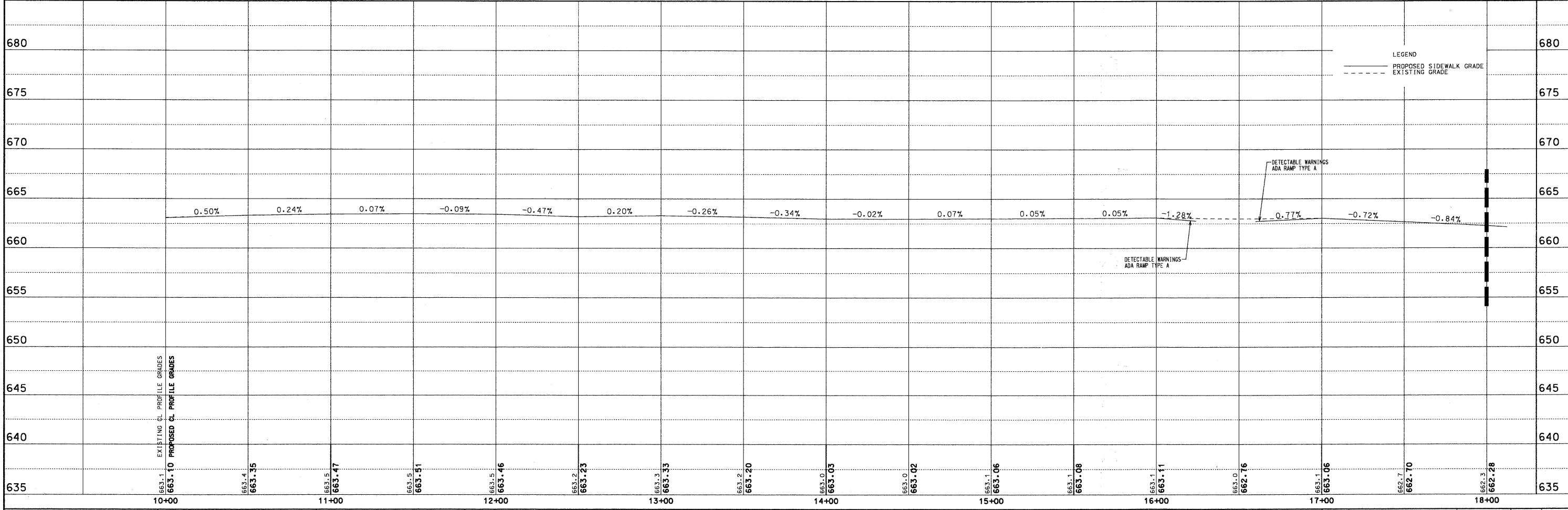

- LEGEND**
- PROPOSED SIDEWALK GRADE
  - EXISTING GRADE

FILE NAME =	USER NAME = #USER#	DESIGNED -	REVISED -	<b>STATE OF ILLINOIS DEPARTMENT OF TRANSPORTATION</b>	<b>ALGONQUIN ROAD SIDEWALK PLAN &amp; PROFILE</b>	F.A. RTE.	SECTION	COUNTY	TOTAL SHEETS	SHEET NO.	
#FILE#		CHECKED -	REVISED -			3514	09-00209-00-SW	COOK	11	6	
		DRAWN -	REVISED -			CONTRACT NO. 63276					
		CHECKED -	REVISED -			FED. ROAD DIST. NO. 1 ILLINOIS FED. AID PROJECT					

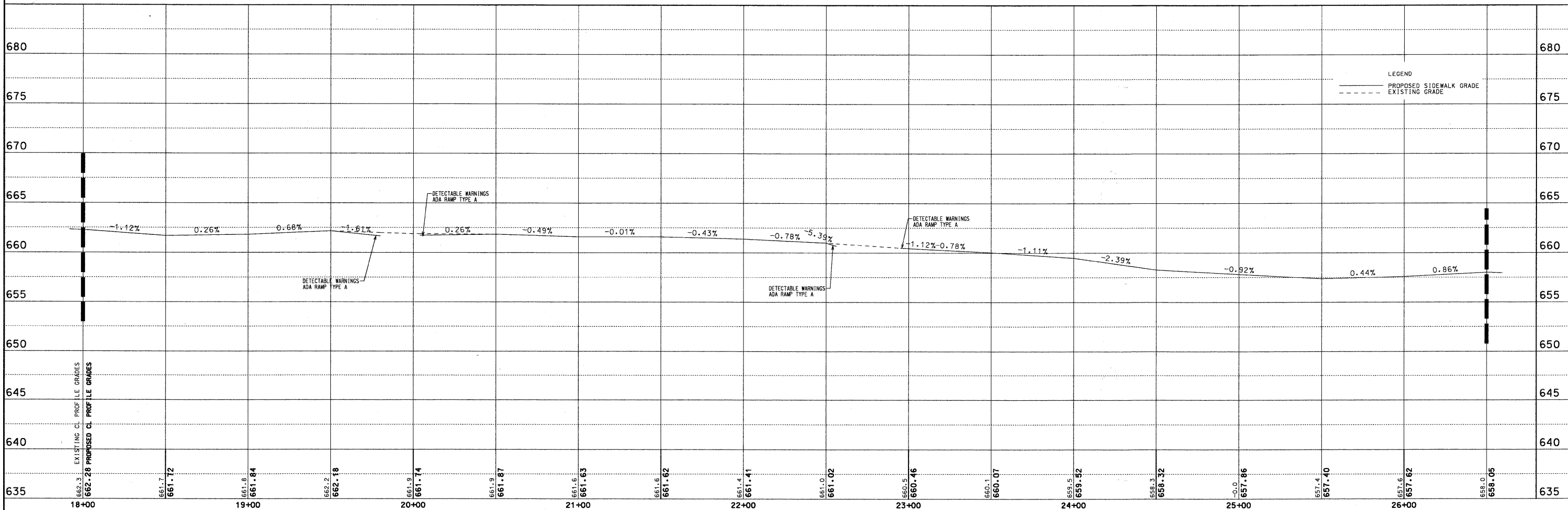
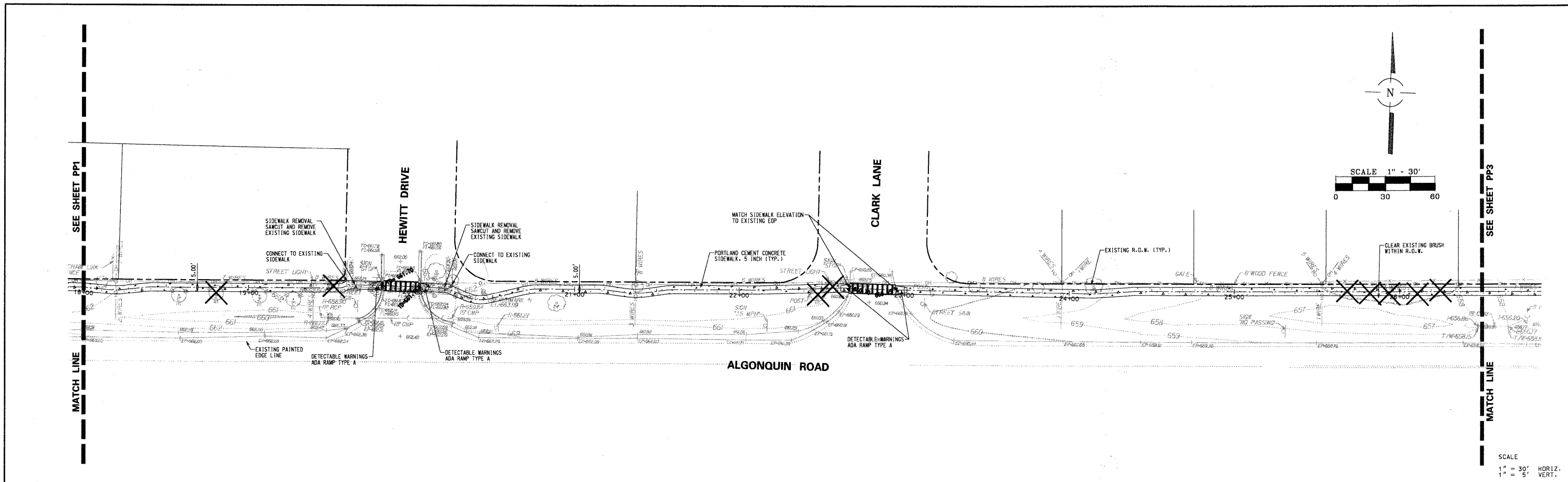

FILE NAME =	USER NAME = #USER#	DESIGNED -	REVISED -	<b>STATE OF ILLINOIS DEPARTMENT OF TRANSPORTATION</b>	<b>ALGONQUIN ROAD SIDEWALK PLAN &amp; PROFILE</b>	F.A. RTE.	SECTION	COUNTY	TOTAL SHEETS	SHEET NO.	
#FILE#		CHECKED -	REVISED -			3514	09-00209-00-SW	COOK	11	7	
		DRAWN -	REVISED -			CONTRACT NO. 63276					
		CHECKED -	REVISED -			FED. ROAD DIST. NO. 1 ILLINOIS FED. AID PROJECT					
					SCALE:	SHEET NO. 7 OF 11 SHEETS		STA. 18+00 TO STA. 26+50			

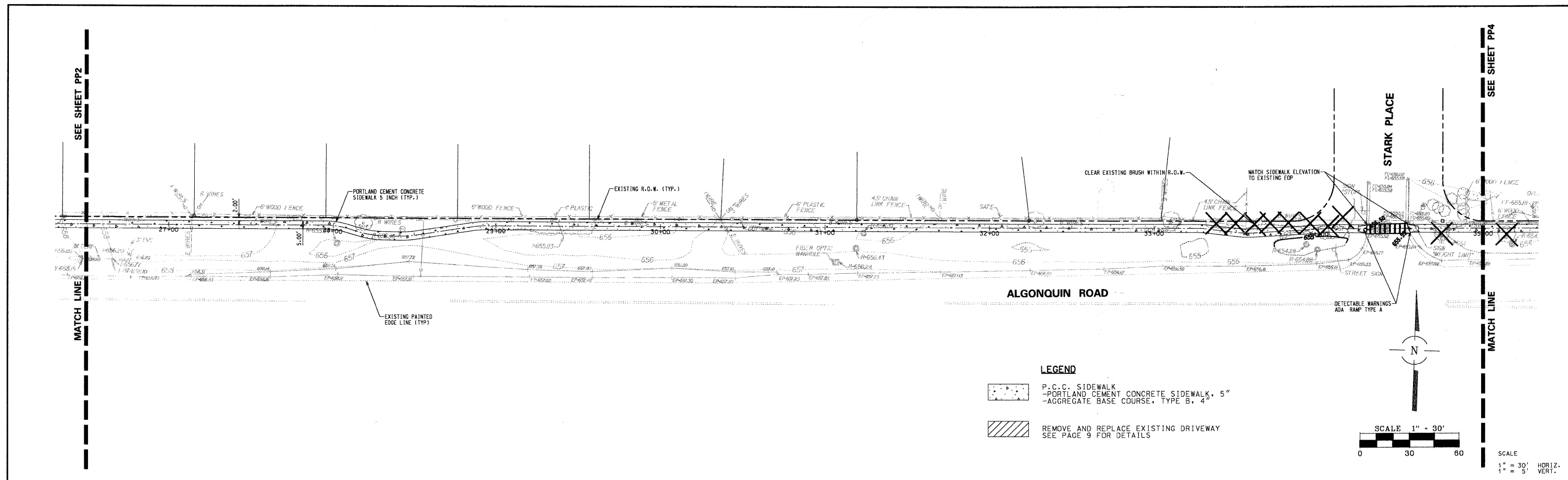

**LEGEND**

P.C.C. SIDEWALK  
 - PORTLAND CEMENT CONCRETE SIDEWALK, 5"  
 - AGGREGATE BASE COURSE, TYPE B, 4"  
 REMOVE AND REPLACE EXISTING DRIVEWAY  
 SEE PAGE 9 FOR DETAILS

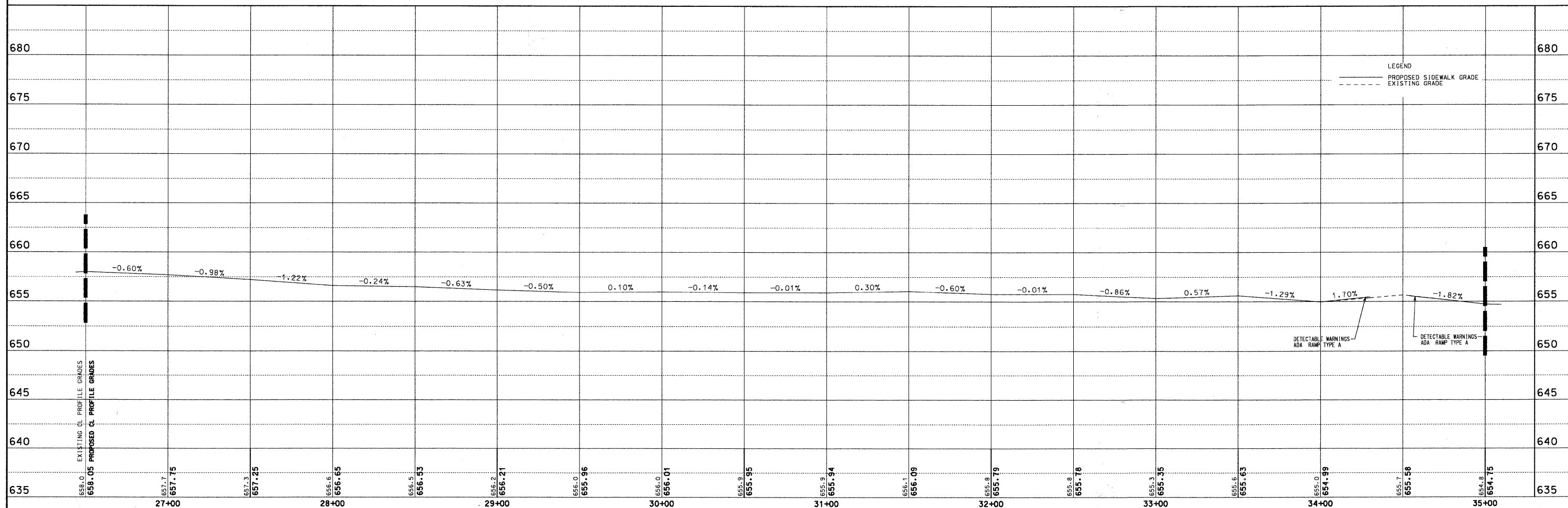

FILE NAME = *FILEL*	USER NAME = *USER*	DESIGNED -	REVISED -	<b>STATE OF ILLINOIS DEPARTMENT OF TRANSPORTATION</b>	<b>ALGONQUIN ROAD SIDEWALK PLAN &amp; PROFILE</b>	F.A. RTE.	SECTION	COUNTY	TOTAL SHEETS	SHEET NO.	
	PLOT SCALE = *SCALE*	CHECKED -	REVISED -			3514	09-00209-00-SW	COOK	11	8	
	PLOT DATE = *DATE*	DRAWN -	REVISED -			CONTRACT NO. 63276					
		CHECKED -	REVISED -			FED. ROAD DIST. NO. 1 [ILLINOIS] FED. AID PROJECT					



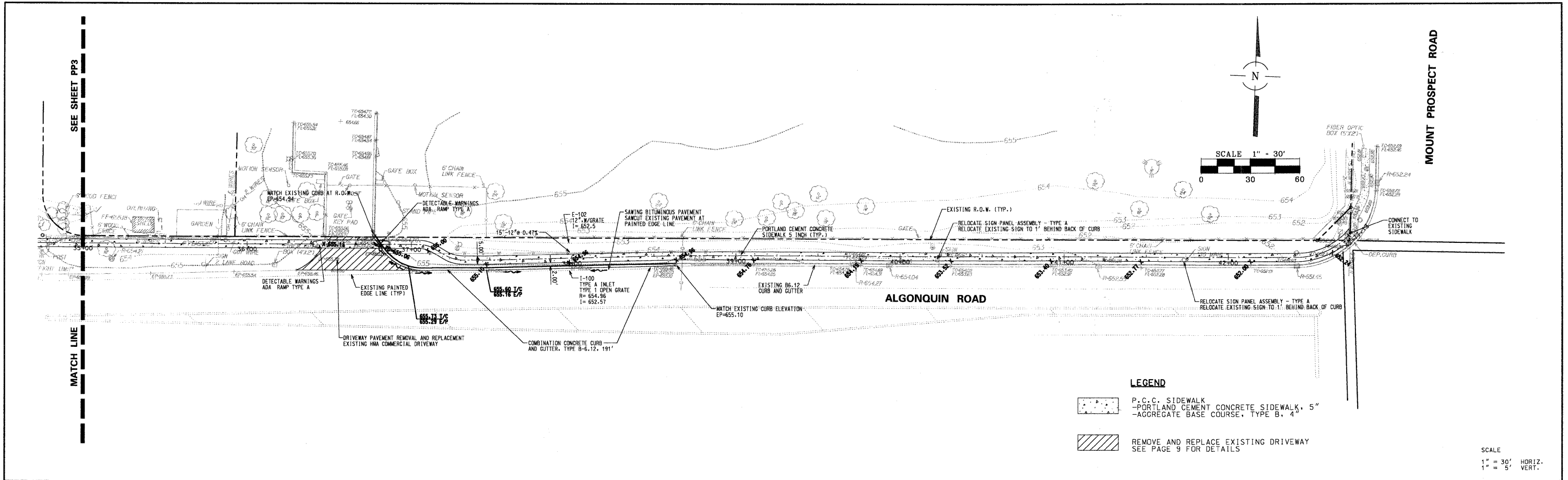

**LEGEND**

P.C.C. SIDEWALK  
 PORTLAND CEMENT CONCRETE SIDEWALK, 5" AGGREGATE BASE COURSE, TYPE B, 4"  
 REMOVE AND REPLACE EXISTING DRIVEWAY SEE PAGE 9 FOR DETAILS

SCALE  
 1" = 30' HORIZ.  
 1" = 5' VERT.

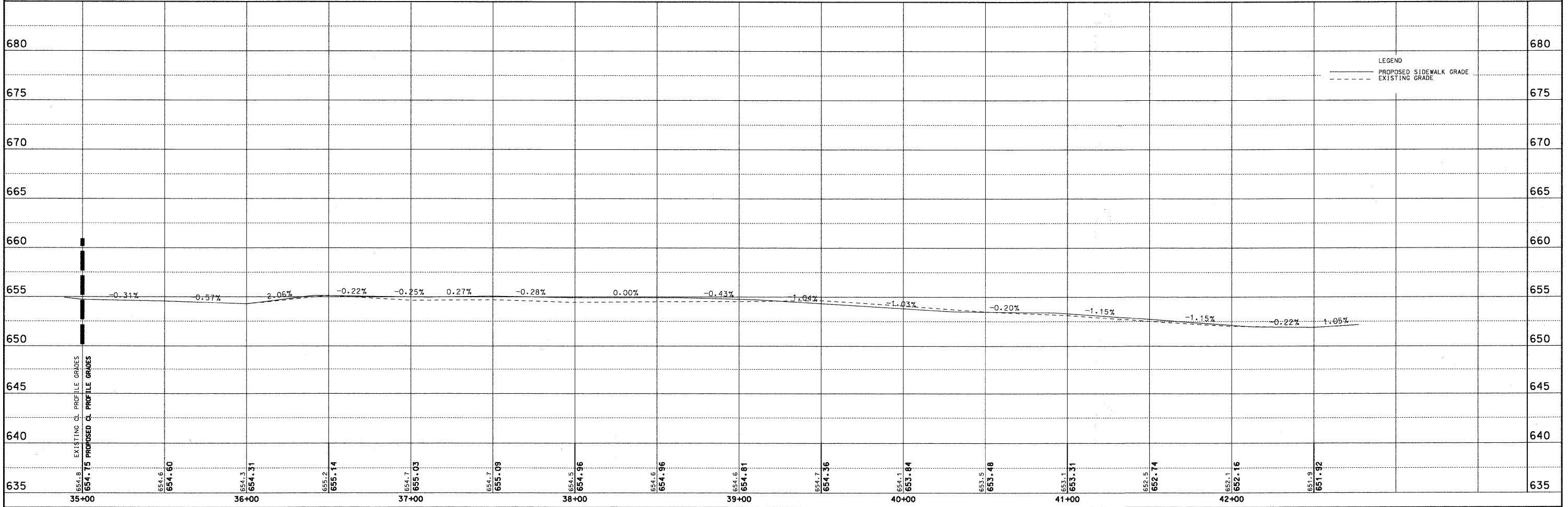

FILE NAME =	USER NAME = #USER#	DESIGNED -	REVISED -	<b>STATE OF ILLINOIS DEPARTMENT OF TRANSPORTATION</b>	<b>ALGONQUIN ROAD SIDEWALK PLAN &amp; PROFILE</b>	F.A. RTE.	SECTION	COUNTY	TOTAL SHEETS	SHEET NO.	
#FILE#		CHECKED -	REVISED -			3514	09-00209-00-SW	COOK	11	9	
PLOT SCALE = #SCALE#		DRAWN -	REVISED -			CONTRACT NO. 63276					
PLOT DATE = #DATE#		CHECKED -	REVISED -			FED. ROAD DIST. NO. 1 ILLINOIS FED. AID PROJECT					

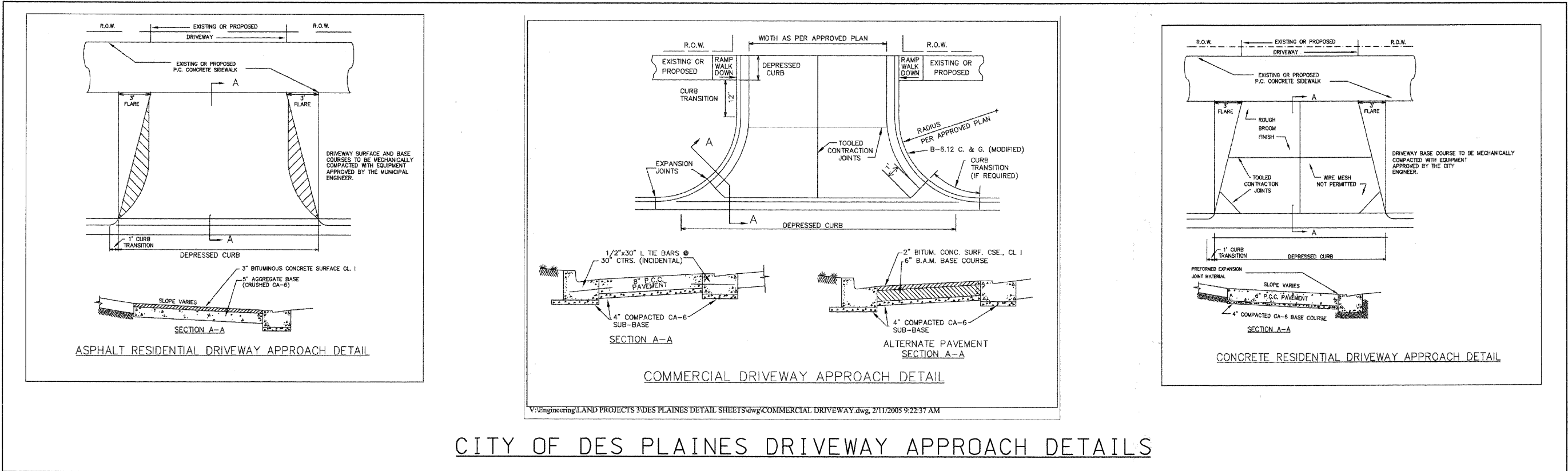

CITY OF DES PLAINES DRIVEWAY APPROACH DETAILS

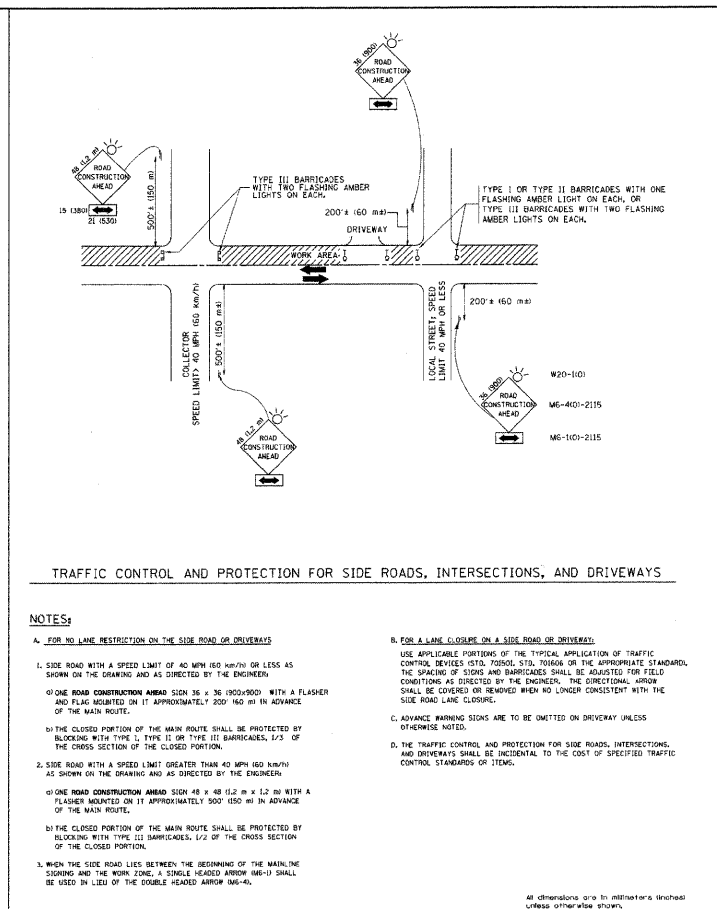
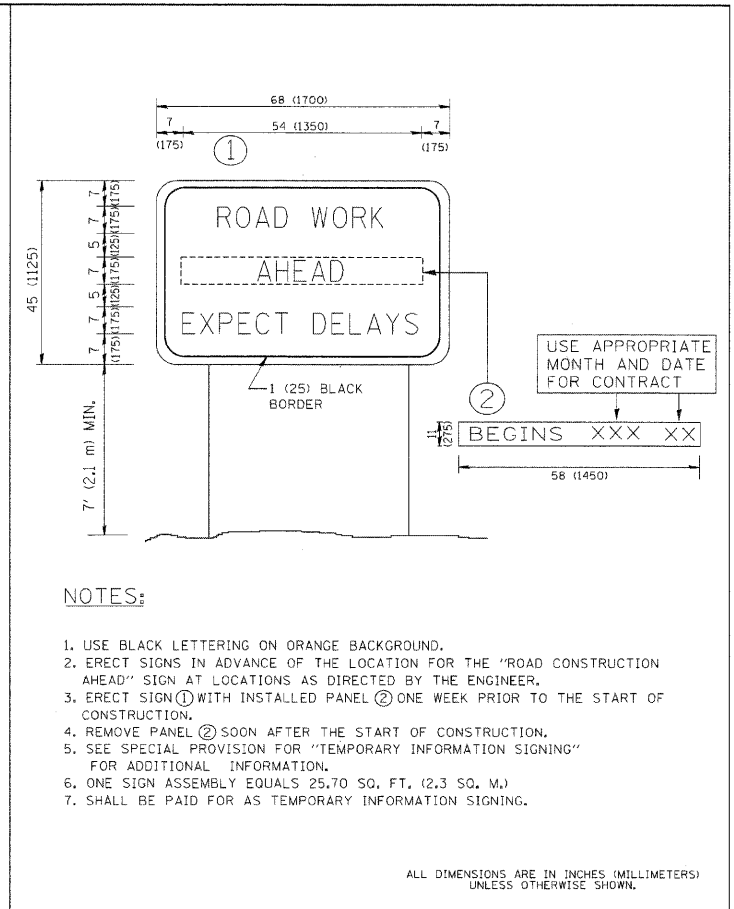

FILE NAME =	USER NAME = #USER#	DESIGNED -	REVISED -	F.A. STA.	SECTION	COUNTY	TOTAL SHEETS	SHEET NO.
#FILE#		CHECKED -	REVISED -	3514	09-0209-00-SW	COOK	11	10
		DRAWN -	REVISED -	ALGONQUIN ROAD SIDEWALK PROJECT DETAILS				CONTRACT NO. 63276
		PLOT SCALE = #SCALE#	REVISED -	SCALE: SHEET NO. 10 OF 11 SHEETS STA. TO STA.				FED. ROAD DIST. NO. 1 ILLINOIS FED. AID PROJECT
		PLOT DATE = #DATE#	REVISED -					
STATE OF ILLINOIS DEPARTMENT OF TRANSPORTATION		ARTERIAL ROAD INFORMATION SIGN		STATE OF ILLINOIS DEPARTMENT OF TRANSPORTATION				TRAFFIC CONTROL AND PROTECTION FOR SIDE ROADS, INTERSECTIONS, AND DRIVEWAYS
SCALE: NONE SHEET NO. 10 OF 11 SHEETS 1 STA. TO STA.		F.A. STA. SECTION COUNTY TOTAL SHEETS SHEET NO.		SCALE: NONE SHEET NO. 10 OF 11 SHEETS 1 STA. TO STA.				F.A. STA. SECTION COUNTY TOTAL SHEETS SHEET NO.

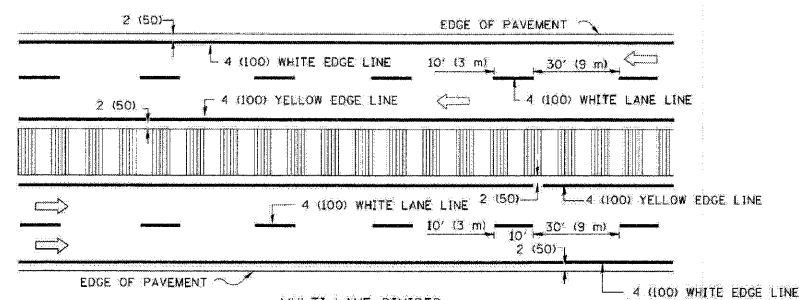
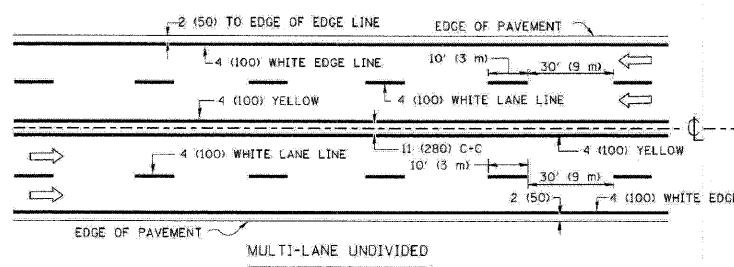
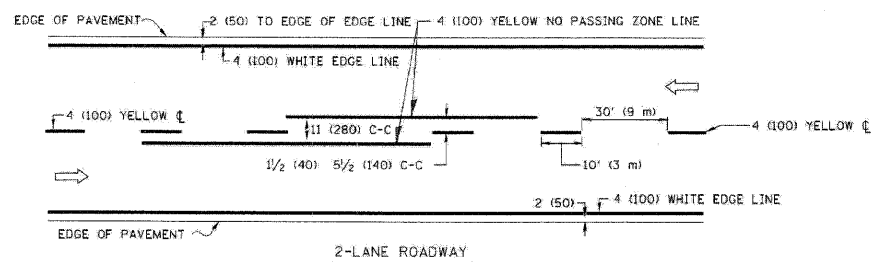

TYPICAL LANE AND EDGE LINE MARKING

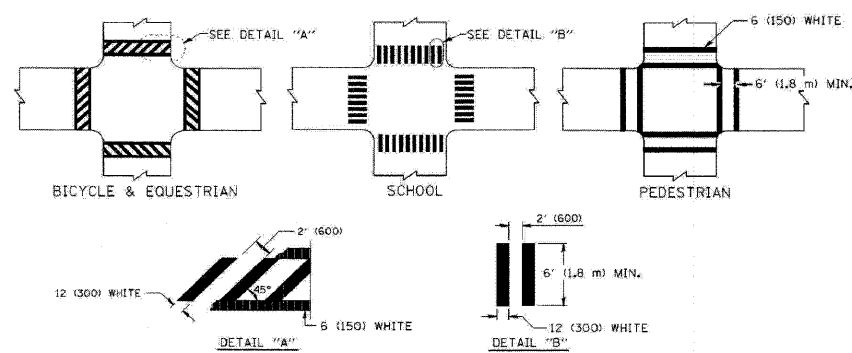

TYPICAL CROSSWALK MARKING

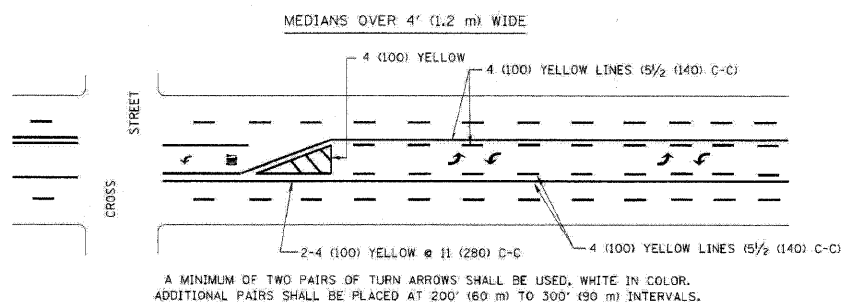
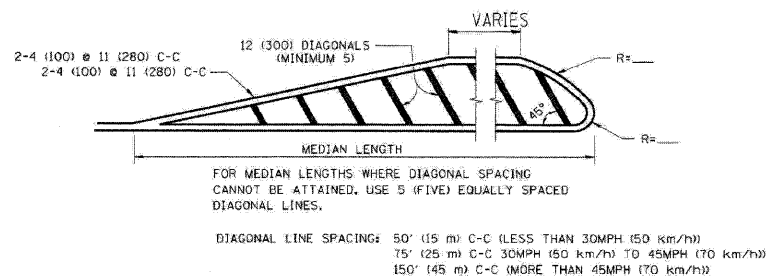
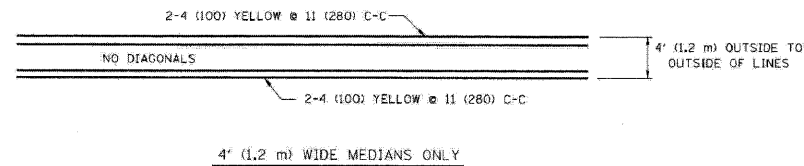

TYPICAL PAINTED MEDIAN MARKING

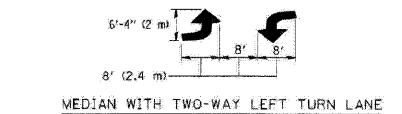

TYPICAL TURN LANE MARKING

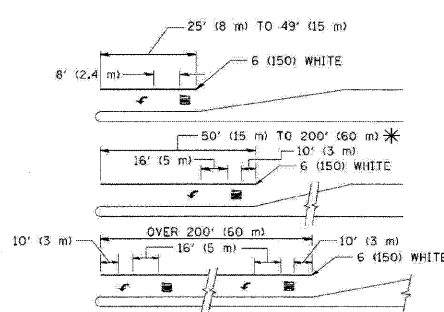

TYPICAL TURN LANE MARKING

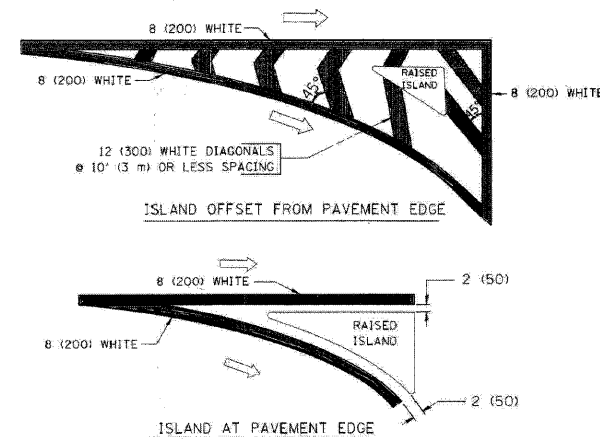

TYPICAL ISLAND MARKING

TYPE OF MARKING	WIDTH OF LINE	PATTERN	COLOR	SPACING / REMARKS
CENTERLINE ON 2 LANE PAVEMENT	4 (100)	SKIP-DASH	YELLOW	10' (3 m) LINE WITH 30' (9 m) SPACE
CENTERLINE ON MULTI-LANE UNDIVIDED PAVEMENT	2 @ 4 (100)	SOLID	YELLOW	11 (280) C-C
NO PASSING ZONE LINES FOR ONE DIRECTION FOR BOTH DIRECTIONS	4 (100) 2 @ 4 (100)	SOLID SOLID	YELLOW YELLOW	5/2 (140) C-C FROM SKIP-DASH CENTERLINE 11 (280) C-C OMIT SKIP-DASH CENTERLINE BETWEEN
LANE LINES	4 (100) 5 (125) ON FREEWAYS	SKIP-DASH SKIP-DASH	WHITE WHITE	10' (3 m) LINE WITH 30' (9 m) SPACE
DOTTED LINES (EXTENSIONS OF CENTER, LANE OR TURN LANE MARKINGS)	SAME AS LINE BEING EXTENDED	SKIP-DASH	SAME AS LINE BEING EXTENDED	2' (600) LINE WITH 6' (1.8 m) SPACE
EDGE LINES	4 (100)	SOLID	YELLOW-LEFT WHITE-RIGHT	OUTLINE MOUNTABLE MEDIANS IN YELLOW; EDGE LINES ARE NOT USED NEXT TO BARRIER CURB
TURN LANE MARKINGS	6 (150) LINE, FULL SIZE LETTERS & SYMBOLS (8' (2.4m))	SOLID	WHITE	SEE TYPICAL TURN LANE MARKING DETAIL
TWO WAY LEFT TURN MARKING	2 @ 4 (100) EACH DIRECTION 8' (2.4m) LEFT ARROW	SKIP-DASH AND SOLID IN PAIRS	YELLOW WHITE	10' (3 m) LINE WITH 30' (9 m) SPACE FOR SKIP-DASH; 5/2 (140) C-C BETWEEN SOLID LINE AND SKIP-DASH LINE SEE TYPICAL TWO-WAY LEFT TURN MARKING DETAIL
CROSSWALK LINES (PEDESTRIAN) A. DIAGONALS (BIKE & EQUESTRIAN) B. LONGITUDINAL BARS (SCHOOL)	2 @ 6 (150) 12 (300) @ 45° 12 (300) @ 90°	SOLID SOLID SOLID	WHITE WHITE WHITE	NOT LESS THAN 6' (1.8 m) APART 2' (600) APART SEE TYPICAL CROSSWALK MARKING DETAILS.
STOP LINES	24 (600)	SOLID	WHITE	PLACE 4' (1.2 m) IN ADVANCE OF AND PARALLEL TO CROSSWALK, IF PRESENT; OTHERWISE, PLACE AT DESIRED STOPPING POINT, PARALLEL TO CROSSROAD CENTERLINE, WHERE POSSIBLE
PAINTED MEDIANS	2 @ 4 (100) WITH 12 (300) DIAGONALS @ 45° NO DIAGONALS USED FOR 4' (1.2 m) WIDE MEDIANS	SOLID	YELLOW; TWO WAY TRAFFIC WHITE; ONE WAY TRAFFIC	11 (280) C-C FOR THE DOUBLE LINE SEE TYPICAL PAINTED MEDIAN MARKING.
GORE MARKING AND CHANNELIZING LINES	8 (200) WITH 12 (300) DIAGONALS @ 45°	SOLID	WHITE	DIAGONALS: 15' (4.5 m) C-C (LESS THAN 30MPH (50 km/h)) 20' (6 m) C-C 30MPH (50 km/h) TO 45MPH (70 km/h) 30' (9 m) C-C (OVER 45MPH (70 km/h))
RAILROAD CROSSING	24 (600) TRANSVERSE LINES; "RR" IS 6' (1.8 m) LETTERS; 6 (150) LINE FOR "X"	SOLID	WHITE	SEE STATE STANDARD 780001 AREA OF: "R"=3.6 SQ. FT. (0.33 m <sup>2</sup> ) EACH "X"=54.0 SQ. FT. (5.0 m <sup>2</sup> )
SHOULDER DIAGONALS	12 (300) @ 45°	SOLID	WHITE - RIGHT YELLOW - LEFT	50' (15 m) C-C (LESS THAN 30MPH (50 km/h)) 75' (25 m) C-C (30 MPH (50 km/h) TO 45MPH (70 km/h)) 150' (45 m) C-C (OVER 45MPH (70 km/h))

FOR FURTHER DETAILS ON PAVEMENT MARKING REFER TO STANDARD SPECIFICATIONS FOR ROAD AND BRIDGE CONSTRUCTION AND STATE STANDARD 780001.

All dimensions are in inches (millimeters) unless otherwise shown.