

STATE OF ILLINOIS
DEPARTMENT OF TRANSPORTATION
DIVISION OF HIGHWAYS

PLANS FOR PROPOSED FEDERAL AID HIGHWAY

STREET RESURFACING
FAU 2927 (WOODLAWN AVENUE)
FAU 3778 (LINCOLN HIGHWAY) TO 8TH PLACE
LOCAL AGENCY PRESERVATION PROGRAM
SECTION NO.: 09-00012-00-RS
PROJECT NO.: ARA-9003 (429)
JOB NO. C-91-864-09
VILLAGE of FORD HEIGHTS

COOK COUNTY
RANGE R E

PROJECT ENDS
WOODLAWN AVENUE
STA 46+72

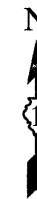

P. A. U. I. D. NO.	SECTION	COUNTY	TOTAL SHEETS	SHEET NO.
2927	09-00012-00-RS	COOK	13	1
STA. 10+48		TO STA. 46+72		
FED. ROAD DIST. NO. 1	ILLINOIS	FED. AID PROJECT ARA-9003 (429)		

CONTRACT #63305

INDEX OF SHEETS

1. COVER SHEET
2. SUMMARY OF QUANTITIES AND GENERAL NOTES
3. TYPICAL CROSS SECTIONS
- 4.-5. PAVEMENT PLANS
- 6.-7. PAVEMENT MARKING PLANS
- 8.-13. IDOT DISTRICT 1 STANDARD DETAILS

STATE STANDARDS

- 000001-05 STANDARD SYMBOLS, ABBREVIATIONS AND PATTERNS
- 424001-05 CURB RAMPS FOR SIDEWALKS
- 442201-03 CLASS C AND D PATCHES
- 602001-01 CATCH BASIN, TYPE A
- 606001-04 CONCRETE CURB TYPE B AND COMBINATION CONCRETE CURB AND GUTTER
- 701606-06 URBAN LANE CLOSURE, MULTILANE, 2W WITH MOUNTABLE MEDIAN
- 701701-06 URBAN LANE CLOSURE, MULTILANE INTERSECTION
- 701801-04 LANE CLOSURE, MULTILANE 1W OR 2W CROSSWALK OR SIDEWALK CLOSURE
- 701901-01 TRAFFIC CONTROL DEVICES
- 780001-02 TYPICAL PAVEMENT MARKINGS
- 781001-03 TYPICAL APPLICATIONS RAISED REFLECTIVE PAVEMENT MARKERS
- 886001-01 DETECTOR LOOP INSTALLATIONS
- 886006-01 TYPICAL LAYOUT FOR DETECTION LOOPS

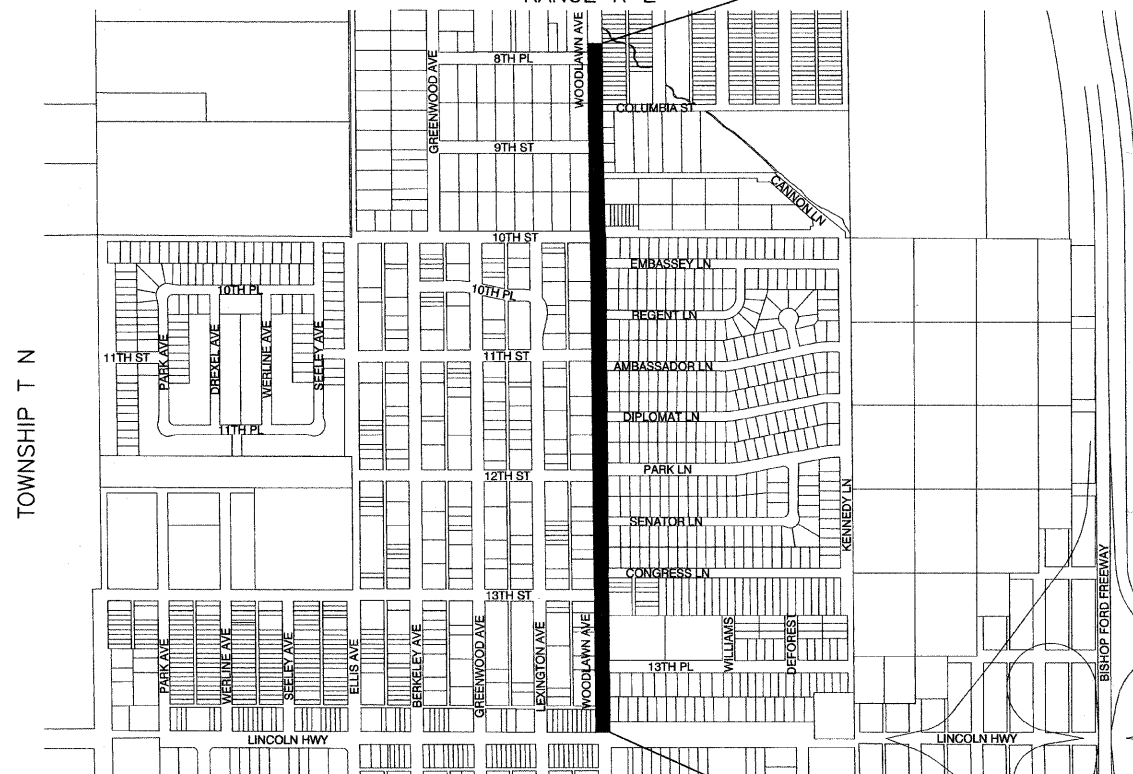
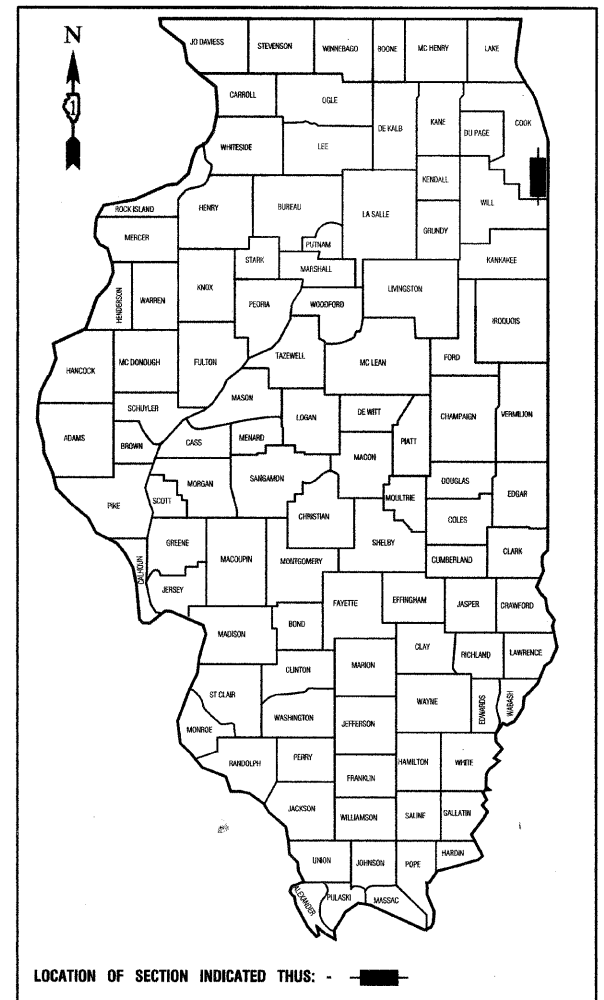

SCALES
 PLAN - 1"=50'
 PROFILE HORIZ. - 1"=50'
 PROFILE VERT. - 1"=5'
 CROSS SECTIONS - 1"=10'

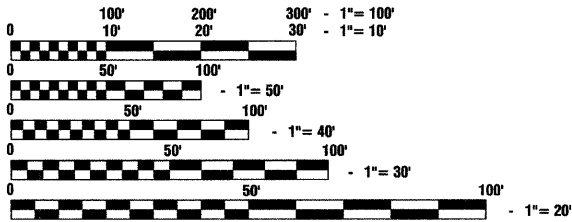

FULL SIZE PLANS HAVE BEEN PREPARED USING STANDARD ENGINEERING SCALES, REDUCED SIZED PLANS WILL NOT CONFORM TO STANDARD SCALES, IN MAKING MEASUREMENTS ON REDUCED PLANS, THE ABOVE SCALES MAY BE USED.

J. U. L. I. E.
 JOINT UTILITY LOCATION INFORMATION FOR EXCAVATION
 1 - 800 - 892 - 0123 or 811

— INDICATES PROPOSED IMPROVEMENT

PROJECT BEGINS
WOODLAWN AVENUE
STA 10+48

LOCATION MAP

GROSS LENGTH= 3,624 FEET= 0.69
 NET LENGTH= 3,624 FEET= 0.69

WOODLAWN AVENUE ARTERIAL
 ADT= 5,700 (2009)
 = 5,700 (2030)

DESIGN SPEED= 35 MPH
 SPEED LIMIT = 35 MPH

STATE OF ILLINOIS DEPARTMENT OF TRANSPORTATION
DIVISION OF HIGHWAYS

Approved October 9, 2009

 Charles Stapp
 President, Village of Ford Heights

Passed October 26, 2009

 Charles Stapp
 District 1 Engineer of Local Roads & Streets

Released for Bid
 Based on Limited
 Review October 26, 2009

 Diane M. O'Keefe
 Deputy Director of Highways, Region 1 Engineer

PRINTED BY THE AUTHORITY OF
THE STATE OF ILLINOIS

PREPARED BY OR UNDER THE
DIRECT SUPERVISION OF:

10/5/09

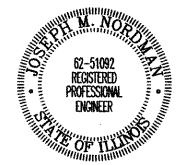

I.D.O.T. FIELD ENGINEER: MELCHOR MANGOBA 847-705-4408
 CONSULTANTS: ROBINSON ENGINEERING, LTD. 708-331-6700

CONTRACT NO. 63305

SUMMARY OF QUANTITIES					PAVEMENT	MARKINGS	LANDSCAPE
S.I.	CODE NO.	PAY ITEM	UNIT	QUAN	CONSTRUCTION TYPE CODE		
					1000	SFTY-1D	Y003
	40600100	BITUMINOUS MATERIALS (PRIME COAT)	GALLON	1800	1800		
	40600895	CONSTRUCTING TEST STRIP	EACH	1	1		
	40600982	HOT-MIX ASPHALT SURFACE REMOVAL - BUTT JOINT	SQ YD	400	400		
	40603335	HOT-MIX ASPHALT SURFACE COURSE, MIX "D", N50	TON	1500	1500		
	42400200	PORTLAND CEMENT CONCRETE SIDEWALK 5 INCH	SQ FT	3000	3000		
	42400800	DETECTABLE WARNINGS	SQ FT	232	232		
	44000157	HOT-MIX ASPHALT SURFACE REMOVAL, 2" INCH	SQ YD	14000	14000		
	44000600	SIDEWALK REMOVAL	SQ FT	3000	3000		
	44001700	COMBINATION CONCRETE CURB AND GUTTER REMOVAL AND REPLACEMENT	FOOT	1640	1640		
	44201749	CLASS D PATCHES, TYPE I, 9 INCH	SQ YD	50	50		
	44201753	CLASS D PATCHES, TYPE II, 9 INCH	SQ YD	100	100		
	44201757	CLASS D PATCHES, TYPE III, 9 INCH	SQ YD	100	100		
	44201759	CLASS D PATCHES, TYPE IV, 9 INCH	SQ YD	250	250		
	60200105	CATCH BASINS, TYPE A, 4'- DIAMETER FRAME, TYPE 1 FRAME, OPEN LID	EACH	1	1		
	60250200	CATCH BASINS TO BE ADJUSTED	EACH	46	46		
	60253000	CATCH BASINS TO BE RECONSTRUCTED WITH NEW TYPE 1 FRAME, OPEN LID	EACH	2	2		
	60255500	MANHOLES TO BE ADJUSTED	EACH	39	39		
	60266600	VALVE BOXES TO BE ADJUSTED	EACH	6	6		
	60500050	REMOVING CATCH BASINS	EACH	1	1		
	67100100	MOBILIZATION	L SUM	1	1		
	70102625	TRAFFIC CONTROL AND PROTECTION, STANDARD 701606	L SUM	1	1		
	70102635	TRAFFIC CONTROL AND PROTECTION, STANDARD 701701	L SUM	1	1		
	70102640	TRAFFIC CONTROL AND PROTECTION, STANDARD 701801	L SUM	1	1		
	70300100	SHORT-TERM PAVEMENT MARKING	FOOT	910	910		
*	78000200	THERMOPLASTIC PAVEMENT MARKING - LINE 4"	FOOT	7600	7600		
*	78000650	THERMOPLASTIC PAVEMENT MARKING - LINE 24"	FOOT	310	310		
X	88600600	DETECTOR LOOP REPLACEMENT	FOOT	40	40		
	X4067107	POLYMERIZED LEVELING BINDER (MACHINE METHOD), IL-4.75, N50	TON	1000	1000		
	XX006947	HOT-MIX ASPHALT DRIVEWAY REMOVAL AND REPLACEMENT	SQ YD	50	50		

GENERAL NOTES

- BEFORE STARTING ANY EXCAVATION THE CONTRACTOR SHALL CALL "J.U.L.I.E." AT (800) 892-0123 AND (312) 744-7000 FOR FIELD LOCATIONS OF BURIED ELECTRIC, TELEPHONE AND GAS UTILITIES. (48 HOUR NOTIFICATION REQUIRED)
- UTILITIES INDICATED ON THE PLANS ARE PROVIDED FOR THE CONTRACTORS USE AND ARE BASED UPON INFORMATION AVAILABLE AT THE TIME OF THE ADVERTISEMENT FOR BIDS. THE OWNER AND ENGINEER DO NOT GUARANTEE THE ACCURACY OF UTILITY INFORMATION.
- IT SHALL BE THE CONTRACTOR'S RESPONSIBILITY TO VERIFY ALL DIMENSIONS AND CONDITIONS EXISTING IN THE FIELD PRIOR TO CONSTRUCTION AND ORDERING OF MATERIALS.
- SCHEDULES INCLUDED IN THE PLANS HAVE BEEN PREPARED FROM FIELD NOTES. EXACT LOCATIONS FOR PATCHING SHALL BE DETERMINED IN THE FIELD BY THE ENGINEER.
- ANY REFERENCE TO STANDARDS THROUGHOUT THE PLANS OR SPECIAL PROVISIONS SHALL BE INTERPRETED TO BE THE LATEST STANDARDS OF THE ILLINOIS DEPARTMENT OF TRANSPORTATION.
- THE THICKNESS OF HMA MIXTURE STATED IN THE SPECIFICATIONS IS THE NOMINAL THICKNESS. DEVIATIONS FROM THE NOMINAL THICKNESS WILL BE PERMITTED WHEN SUCH DEVIATIONS OCCUR DUE TO IRREGULARITIES IN THE EXISTING SURFACE OR BASE ON WHICH THE HMA SURFACE IS PLACED.
- ACCESS TO DRIVEWAYS SHALL BE MAINTAINED AT ALL TIMES BY LIMITING CURB AND GUTTER REPAIR TO ONE-HALF THE DRIVEWAY WIDTH AT ONE TIME AS WELL AS TEMPORARY AGGREGATE.

* - INDICATES SPECIALTY ITEMS

FILE NAME = 08295-QUAN-01 - P01	USER NAME =	DESIGNED -- RES	REVISION --	STATE OF ILLINOIS DEPARTMENT OF TRANSPORTATION	WOODLAWN AVENUE STREET RESURFACING SUMMARY OF QUANTITIES AND GENERAL NOTES				F.A.U. RTE.	SECTION	COUNTY	TOTAL SHEETS	SHEET NO.
		CHECKED -- JMN	REVISION --		2827	09-00012-00-RS	COOK	13	2				
	PLOT SCALE =	DRAWN -- MJD	REVISION --		CONTRACT NO. 63305								
	PLOT DATE = 10-13-09	CHECKED -- RES	REVISION --		SCALE: N/A	SHEET NO. 2	OF 13 SHEETS	STA. N/A	TO STA. N/A	FED. ROAD DIST. NO. 1	ILLINOIS	FED. AID PROJECT	ARA-9003 (429)

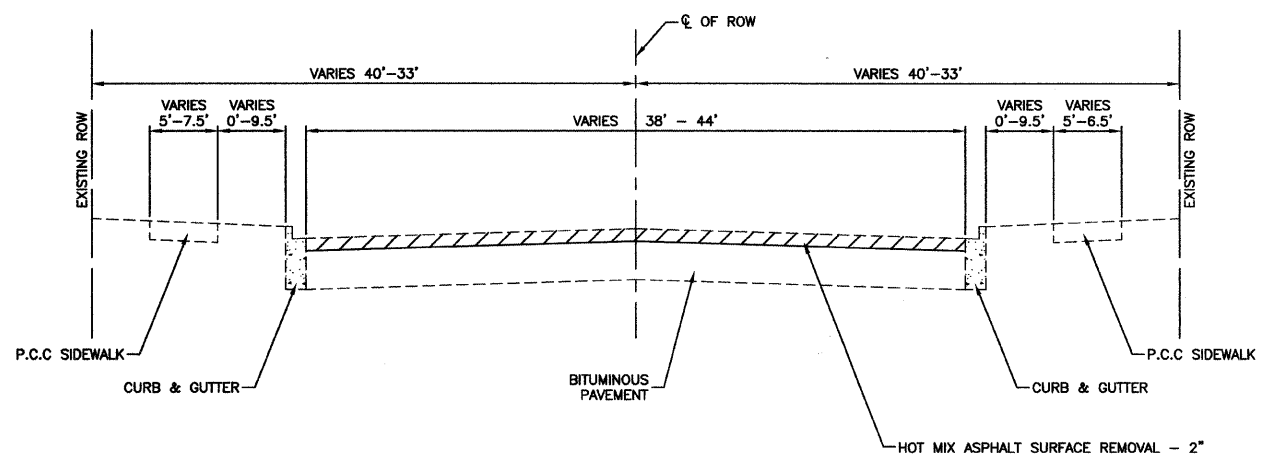

EXISTING TYPICAL SECTION
WOODLAWN AVENUE
STA. 10+48 TO STA. 46+72

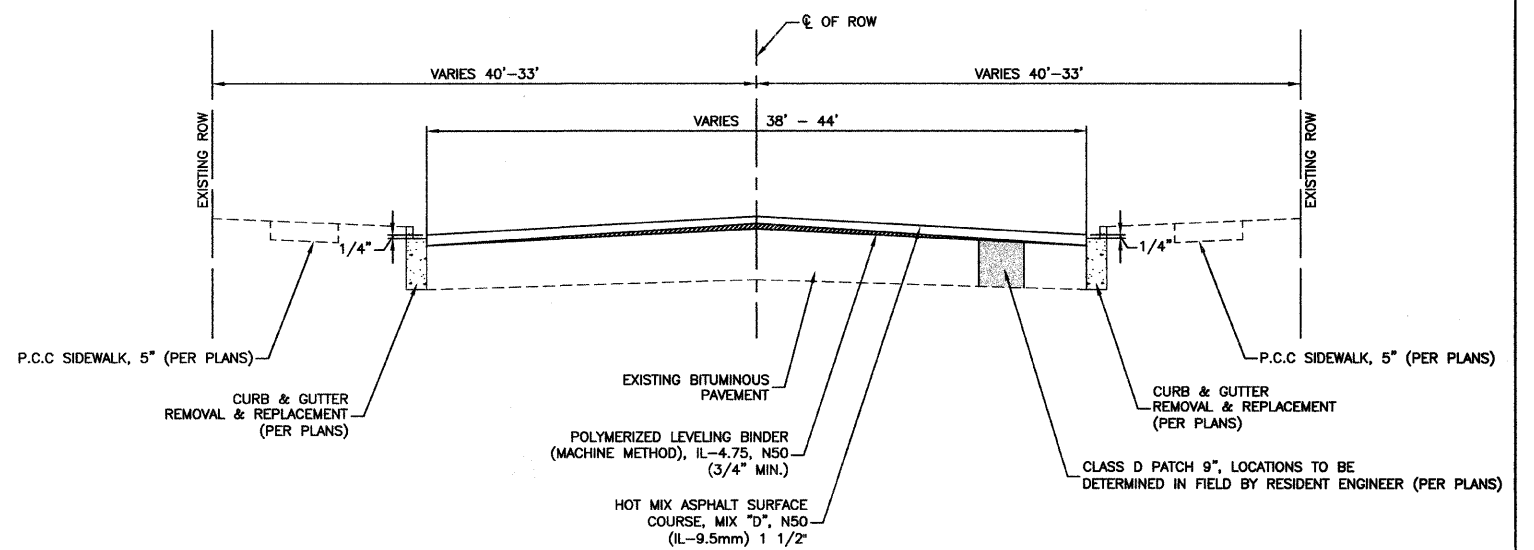

PROPOSED TYPICAL SECTION
WOODLAWN AVENUE
STA. 10+48 TO STA. 46+72

NOTE: CONTRACTOR SHALL MILL BEFORE PATCHING

HOT-MIX ASPHALT MIXTURE REQUIREMENTS

MIXTURE TYPE	AIR VOIDS
HOT MIX ASPHALT SURFACE COURSE, MIX "D", N50(IL-9.5mm); 1 1/2"	4% @ 50 Gyr.
POLYMERIZED LEVELING BINDER (MACHINE METHOD), IL-4.75, N50, (3/4" MIN.)	4% @ 50 Gyr.
DRIVEWAYS	
HOT MIX ASPHALT SURFACE COURSE, MIX "C", N50(IL-9.5mm); 2"	4% @ 50 Gyr.
HOT MIX ASPHALT BASE COURSE, (HMA BINDER IL-19.0mm), PE-6", CE-8"	4% @ 50 Gyr.
PATCHING	
CLASS D PATCHES, TYPE I, II, III, IV, 9" (HMA BINDER IL-19.0mm)	4% @ 70 Gyr.

NOTE:
"THE "AC TYPE" FOR POLYMERIZED HMA MIXES SHALL BE "SBS/SBR PG 70-22" AND FOR NON-POLYMERIZED HMA THE "AC TYPE" SHALL BE "PG 64-22" UNLESS MODIFIED BY DISTRICT ONE SPECIAL PROVISIONS." FOR "PERCENT OF RAP" SEE DISTRICT ONE SPECIAL PROVISION.
THE UNIT WEIGHT USED TO CALCULATE ALL HMA SURFACE MIXTURE QUANTITIES IS 112 LBS/SQ YD/IN.

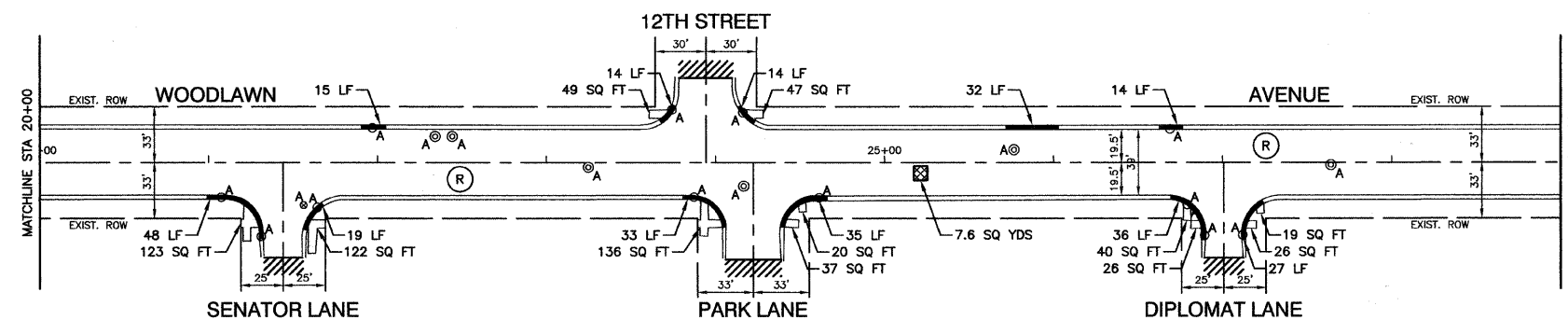
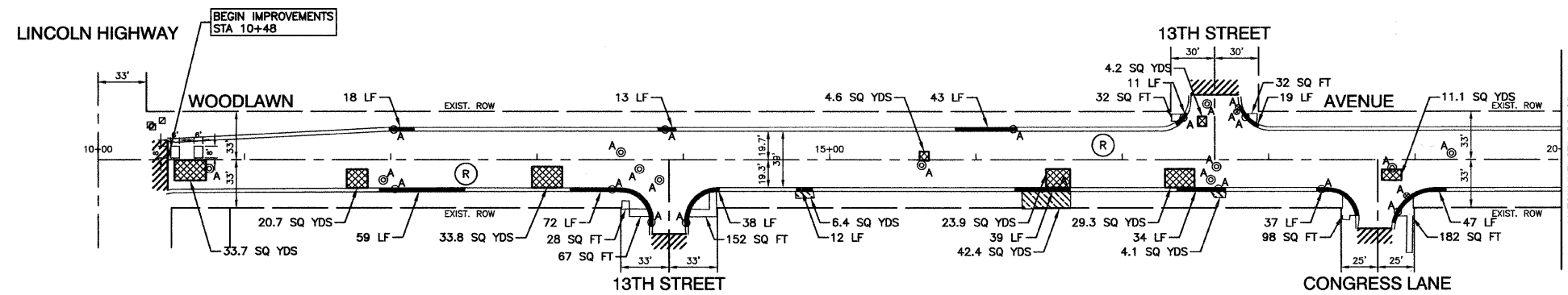

NOTES:

1. DETECTABLE WARNINGS ARE TO BE INSTALLED AT LOCATIONS OF SIDEWALK REMOVAL AND REPLACEMENT. CONTRACTOR TO POSITION AND PLACE DETECTABLE WARNINGS AT THE DIRECTION OF THE ENGINEER.
2. LIMIT OF CONSTRUCTION ON ALL SIDE STREETS IS THE RADIUS RETURN PLUS 10' BUTT JOINT

LEGEND

- HMA PAVEMENT REPAIR
- HMA DRIVEWAY REMOVAL AND REPLACEMENT
- CONCRETE SIDEWALK REMOVAL AND REPLACEMENT
- BUTT JOINTS
- CURB REMOVAL
- STRUCTURE TO BE ADJUSTED
- STRUCTURE TO BE RECONSTRUCTED
- STRUCTURE TO BE REMOVED AND REPLACED
- STRUCTURE TO BE ADJUSTED AND REPLACE LID
- DETECTOR LOOP

FILE NAME = 09325-PLAN-01 - IDOT P01	USER NAME =	DESIGNED -- RES	REVISED --	STATE OF ILLINOIS DEPARTMENT OF TRANSPORTATION	WOODLAWN AVENUE STREET RESURFACING PAVEMENT PLAN	F.A.U. RTE. 2927	SECTION 09-00012-00-RS	COUNTY COOK	TOTAL SHEETS 13	SHEET NO. 4
	PLOT SCALE =	DRAWN -- MJD	REVISED --			CONTRACT NO. 63305			FED. AID PROJECT ARA-9003 (429)	
PLOT DATE = 10-13-09	CHECKED -- RES	REVISED --		SCALE: 1"=50'		SHEET NO. 4 OF 13 SHEETS		STA. 10+48 TO STA. 29+00		

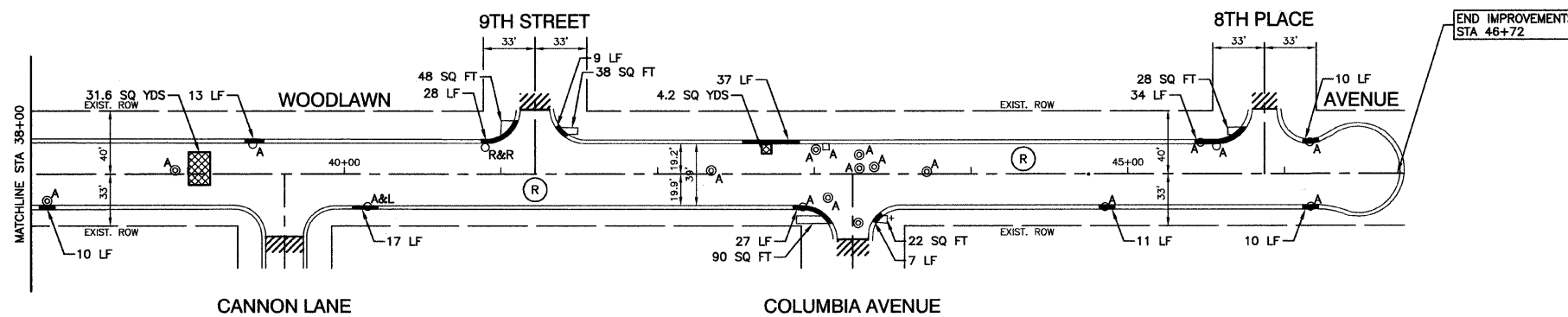
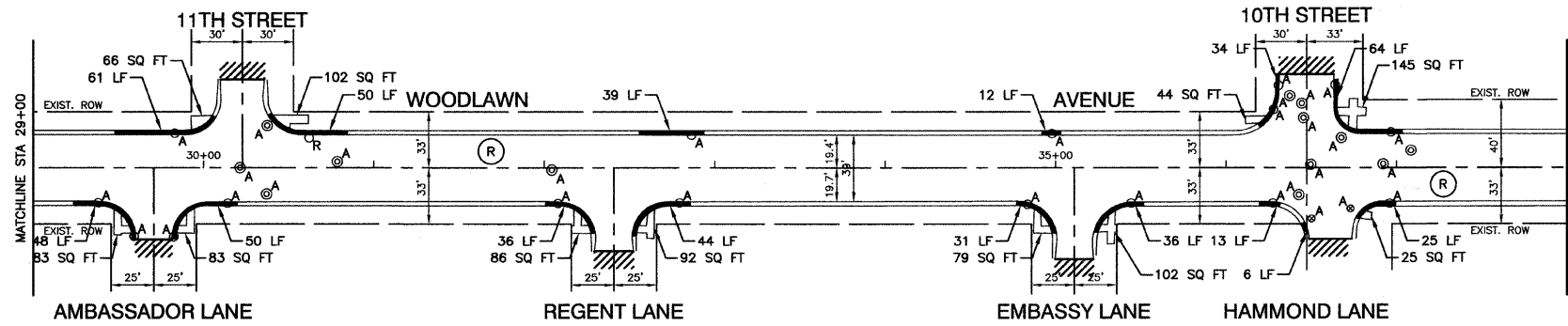

NOTES:

1. DETECTABLE WARNINGS ARE TO BE INSTALLED AT LOCATIONS OF SIDEWALK REMOVAL AND REPLACEMENT. CONTRACTOR TO POSITION AND PLACE DETECTABLE WARNINGS AT THE DIRECTION OF THE ENGINEER.
2. LIMIT OF CONSTRUCTION ON ON ALL SIDE STREETS IS THE RADIUS RETURN PLUS 10' BUTT JOINT

LEGEND

- HMA PAVEMENT REPAIR
- HMA DRIVEWAY REMOVAL AND REPLACEMENT
- CONCRETE SIDEWALK REMOVAL AND REPLACEMENT
- BUTT JOINTS
- CURB REMOVAL
- STRUCTURE TO BE ADJUSTED
- HOT-MIX ASPHALT SURFACE REMOVAL, 2" POLYMERIZED LEVELING BINDER (MACHINE METHOD), N50 3/4" HOT-MIX ASPHALT SURFACE COURSE, MIX "D", IL. 9.5MM, N50 1 1/2"
- STRUCTURE TO BE RECONSTRUCTED
- STRUCTURE TO BE REMOVED AND REPLACED
- STRUCTURE TO BE ADJUSTED AND REPLACE LID
- DETECTOR LOOP

FILE NAME = 0925-PLAN-01 - IDOT P02

USER NAME =	DESIGNED -- RES	REVISED --
	CHECKED -- JMN	REVISED --
PLOT SCALE =	DRAWN -- MJD	REVISED --
PLOT DATE = 10-13-09	CHECKED -- RES	REVISED --

STATE OF ILLINOIS
DEPARTMENT OF TRANSPORTATION

WOODLAWN AVENUE
STREET RESURFACING
PAVEMENT PLAN

SCALE: 1"=50' SHEET NO. 5 OF 13 SHEETS STA. 29+00 TO STA. 46+72

F.A.U. RTE.	SECTION	COUNTY	TOTAL SHEETS	SHEET NO.
2927	09-00012-00-RS	COOK	13	5
CONTRACT NO. 63305				
FED. ROAD DIST. NO. 1 ILLINOIS FED. AID PROJECT ARA-9003 (429)				

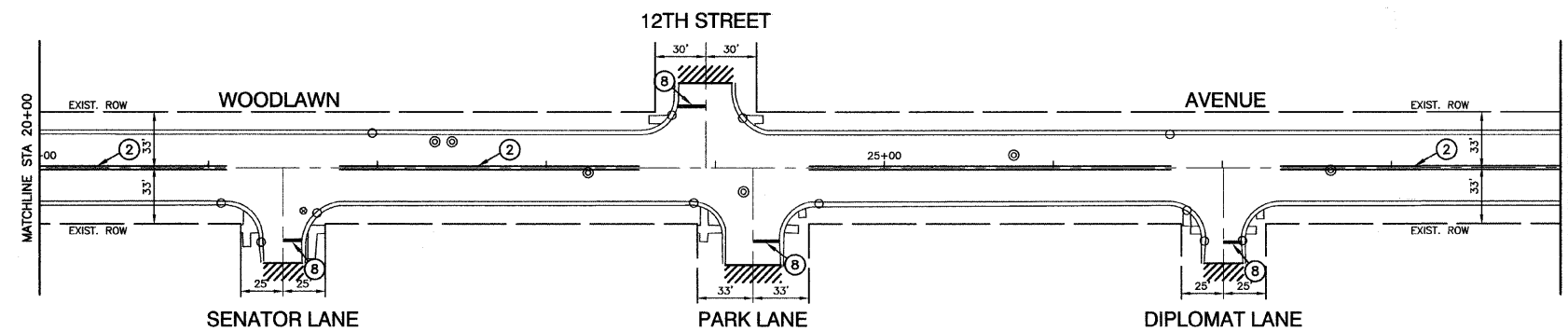
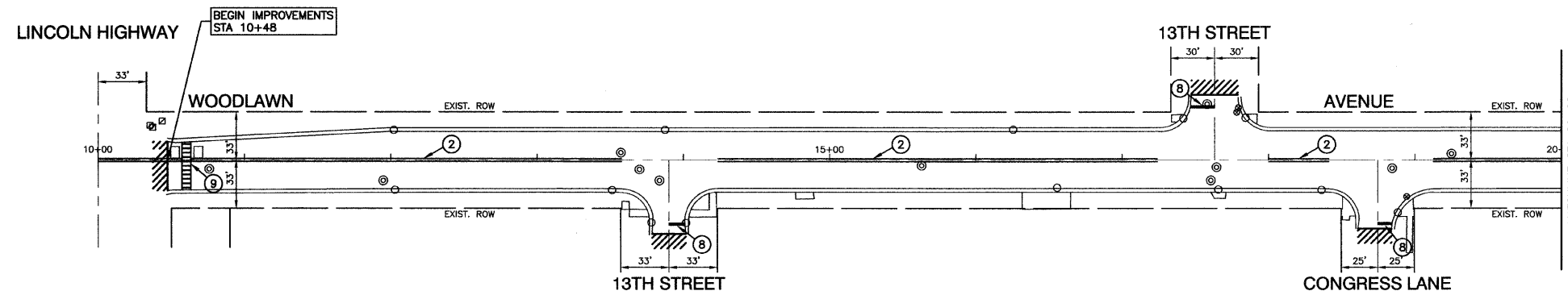

PAVEMENT MARKING LEGEND

- ① WHITE LETTERS & SYMBOLS
- ② DOUBLE 4" YELLOW CENTERLINE (11" C/C)
- ③ DOUBLE YELLOW MEDIAN OUTLINE (11" C/C)
- ④ 4" YELLOW LINE
- ⑤ 4" WHITE EDGE LINE
- ⑥ 6" WHITE LANE LINE
- ⑦ 6" WHITE SKIP-DASH LINE (2' LINE - 6' SPACE)
- ⑧ 12" YELLOW DIAGONAL LINE (20' C/C)
- ⑨ 24" WHITE STOP BAR
- ⑩ 6" WHITE CROSSWALK (6' C/C)
- ⑪ 6" WHITE CROSSWALK (10' C/C)
- ⑫ 12" WHITE LINE (45° ANGLE, 20' C/C)
- ⑬ 4" WHITE SKIP - DASH LINE (10' LINE - 30' SPACE)
- ⑭ 4" YELLOW SKIP - DASH LINE (10' LINE - 30' SPACE)
- ◀ ONE-WAY AMBER MARKER
40' C/C UNLESS OTHERWISE INDICATED
- ◀ ONE-WAY CRYSTAL MARKER
80' C/C UNLESS OTHERWISE INDICATED
- ◀ TWO-WAY AMBER MARKER
40' C/C UNLESS OTHERWISE INDICATED
- ◀ TRAFFIC SIGN

FILE NAME = 09225-PLAN-01 - PVMK 01	USER NAME =	DESIGNED -- RES	REVISED --
		CHECKED -- JMN	REVISED --
	PLOT SCALE =	DRAWN -- MJD	REVISED --
	PLOT DATE = 10-13-09	CHECKED -- RES	REVISED --

**STATE OF ILLINOIS
DEPARTMENT OF TRANSPORTATION**

WOODLAWN AVENUE STREET RESURFACING PAVEMENT MARKING PLAN		F.A.U. RTE. 2927	SECTION 09-00012-00-RS	COUNTY COOK	TOTAL SHEETS 13	SHEET NO. 6
SCALE: 1"=50'		SHEET NO. 6 OF 13 SHEETS		STA. 10+48 TO STA. 29+00		FED. ROAD DIST. NO. 1 ILLINOIS FED. AID PROJECT ARA-9003 (429)

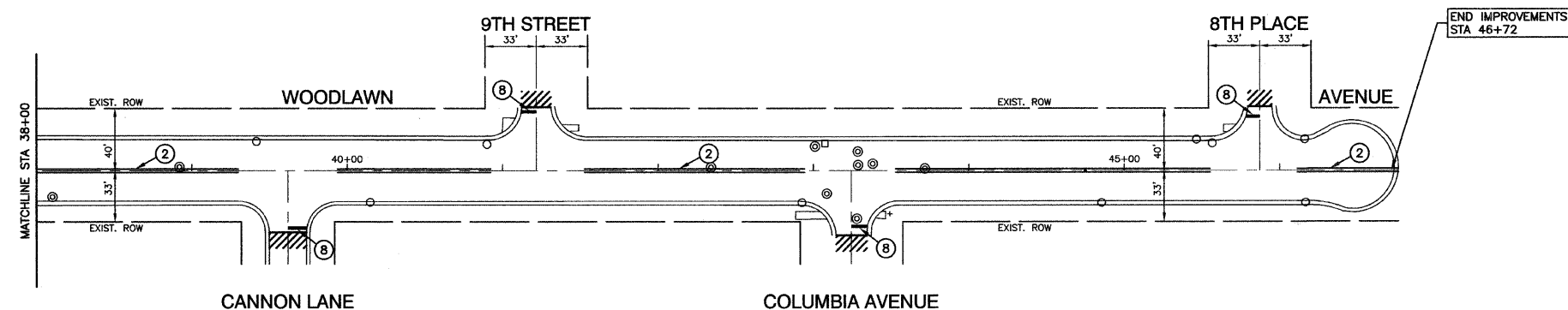
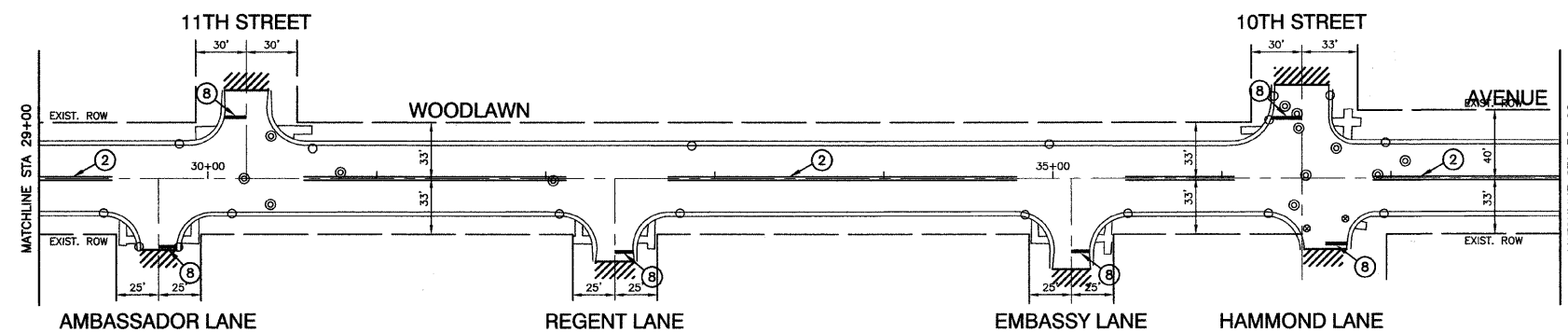
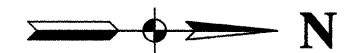

PAVEMENT MARKING LEGEND

- ① WHITE LETTERS & SYMBOLS
- ② DOUBLE 4" YELLOW CENTERLINE (11" C/C)
- ③ DOUBLE YELLOW MEDIAN OUTLINE (11" C/C)
- ④ 4" YELLOW LINE
- ⑤ 4" WHITE EDGE LINE
- ⑥ 6" WHITE LANE LINE
- ⑦ 6" WHITE SKIP-DASH LINE (2' LINE - 6' SPACE)
- ⑧ 12" YELLOW DIAGONAL LINE (20' C/C)
- ⑨ 24" WHITE STOP BAR
- ⑩ 6" WHITE CROSSWALK (6' C/C)
- ⑪ 6" WHITE CROSSWALK (10' C/C)
- ⑫ 12" WHITE LINE (45° ANGLE, 20' C/C)
- ⑬ 4" WHITE SKIP - DASH LINE (10' LINE - 30' SPACE)
- ⑭ 4" YELLOW SKIP - DASH LINE (10' LINE - 30' SPACE)
- ◀ ONE-WAY AMBER MARKER
40' C/C UNLESS OTHERWISE INDICATED
- ◀ ONE-WAY CRYSTAL MARKER
80' C/C UNLESS OTHERWISE INDICATED
- ◆ TWO-WAY AMBER MARKER
40' C/C UNLESS OTHERWISE INDICATED
- ⊠ TRAFFIC SIGN

FILE NAME = 06325-PLAN-01 - PVMK 02	USER NAME =	DESIGNED -- RES	REVISED --
		CHECKED -- JMN	REVISED --
	PLOT SCALE =	DRAWN -- MJD	REVISED --
	PLOT DATE = 10-13-09	CHECKED -- RES	REVISED --

**STATE OF ILLINOIS
DEPARTMENT OF TRANSPORTATION**

WOODLAWN AVENUE STREET RESURFACING PAVEMENT MARKING PLAN		F.A.U. RTE. 2927	SECTION 09-00012-00-RS	COUNTY COOK	TOTAL SHEETS 13	SHEET NO. 7
SCALE: 1"=50'		SHEET NO. 7 OF 13 SHEETS		STA. 29+00 TO STA. 46+72		FED. ROAD DIST. NO. 1 ILLINOIS FED. AID PROJECT ARA-9003 (429)

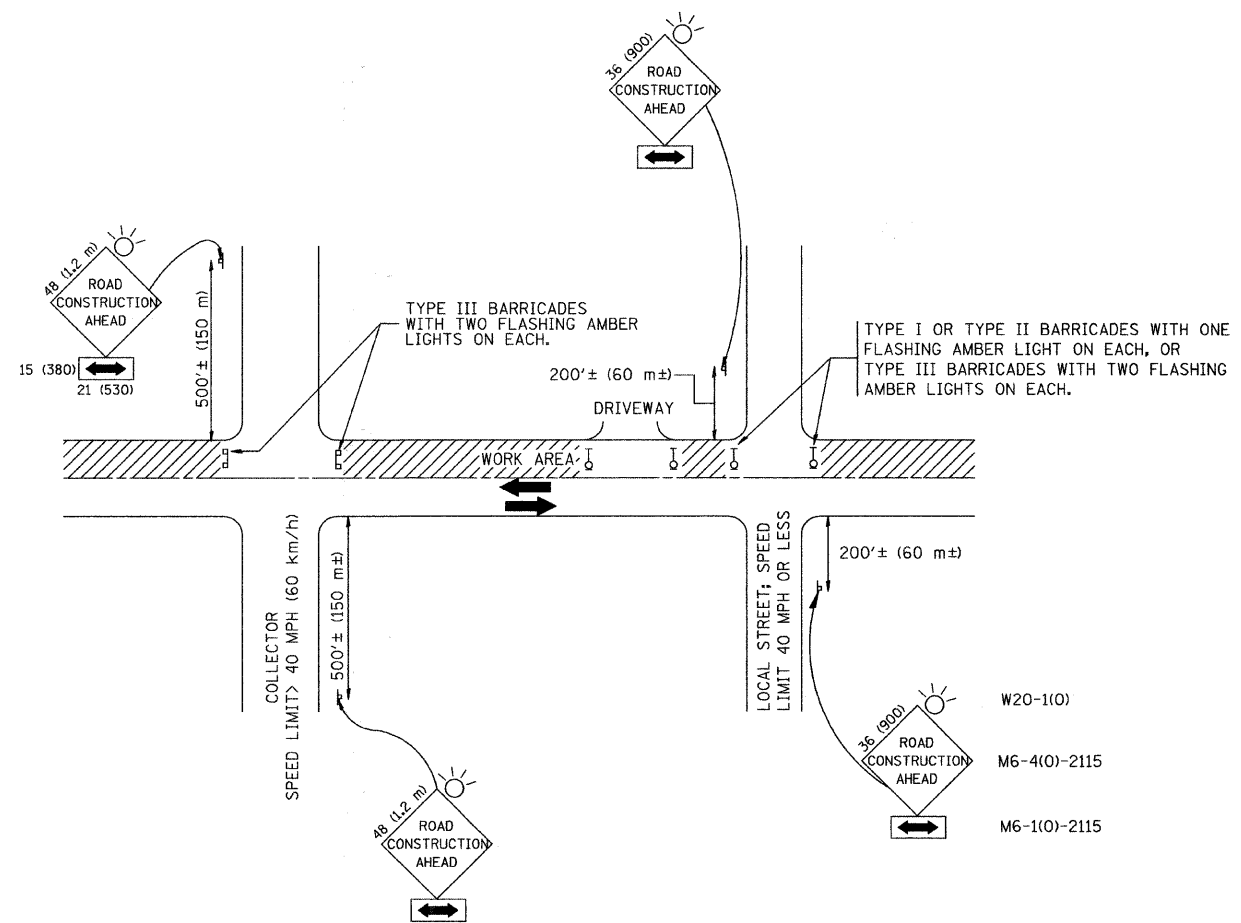

TRAFFIC CONTROL AND PROTECTION FOR SIDE ROADS, INTERSECTIONS, AND DRIVEWAYS

NOTES:

- A. FOR NO LANE RESTRICTION ON THE SIDE ROAD OR DRIVEWAYS
 1. SIDE ROAD WITH A SPEED LIMIT OF 40 MPH (60 km/h) OR LESS AS SHOWN ON THE DRAWING AND AS DIRECTED BY THE ENGINEER:
 - a) ONE **ROAD CONSTRUCTION AHEAD** SIGN 36 x 36 (900x900) WITH A FLASHER AND FLAG MOUNTED ON IT APPROXIMATELY 200' (60 m) IN ADVANCE OF THE MAIN ROUTE.
 - b) THE CLOSED PORTION OF THE MAIN ROUTE SHALL BE PROTECTED BY BLOCKING WITH TYPE I, TYPE II OR TYPE III BARRICADES, 1/3 OF THE CROSS SECTION OF THE CLOSED PORTION.
 2. SIDE ROAD WITH A SPEED LIMIT GREATER THAN 40 MPH (60 km/h) AS SHOWN ON THE DRAWING AND AS DIRECTED BY THE ENGINEER:
 - a) ONE **ROAD CONSTRUCTION AHEAD** SIGN 48 x 48 (1.2 m x 1.2 m) WITH A FLASHER MOUNTED ON IT APPROXIMATELY 500' (150 m) IN ADVANCE OF THE MAIN ROUTE.
 - b) THE CLOSED PORTION OF THE MAIN ROUTE SHALL BE PROTECTED BY BLOCKING WITH TYPE III BARRICADES, 1/2 OF THE CROSS SECTION OF THE CLOSED PORTION.
 3. WHEN THE SIDE ROAD LIES BETWEEN THE BEGINNING OF THE MAINLINE SIGNING AND THE WORK ZONE, A SINGLE HEADED ARROW (M6-1) SHALL BE USED IN LIEU OF THE DOUBLE HEADED ARROW (M6-4).
- B. FOR A LANE CLOSURE ON A SIDE ROAD OR DRIVEWAY:

USE APPLICABLE PORTIONS OF THE TYPICAL APPLICATION OF TRAFFIC CONTROL DEVICES (STD. 701501, STD. 701606 OR THE APPROPRIATE STANDARD). THE SPACING OF SIGNS AND BARRICADES SHALL BE ADJUSTED FOR FIELD CONDITIONS AS DIRECTED BY THE ENGINEER. THE DIRECTIONAL ARROW SHALL BE COVERED OR REMOVED WHEN NO LONGER CONSISTENT WITH THE SIDE ROAD LANE CLOSURE.
- C. ADVANCE WARNING SIGNS ARE TO BE OMITTED ON DRIVEWAY UNLESS OTHERWISE NOTED.
- D. THE TRAFFIC CONTROL AND PROTECTION FOR SIDE ROADS, INTERSECTIONS, AND DRIVEWAYS SHALL BE INCIDENTAL TO THE COST OF SPECIFIED TRAFFIC CONTROL STANDARDS OR ITEMS.

All dimensions are in millimeters (inches) unless otherwise shown.

FILE NAME = 09225-DT18-01 - TC-10	USER NAME = gegliuabst	DESIGNED = LHA	REVISED = J. OBERLE 10-18-95
		CHECKED =	REVISED = A. HOUSEH 03-06-96
	PLOT SCALE = 50.000 / / IN.	DRAWN =	REVISED = A. HOUSEH 10-15-96
	PLOT DATE = 1/4/2008	CHECKED = 06-89	REVISED = T. RAMMACHER 01-06-00

STATE OF ILLINOIS
DEPARTMENT OF TRANSPORTATION

TRAFFIC CONTROL AND PROTECTION FOR SIDE ROADS, INTERSECTIONS, AND DRIVEWAYS		F.A.U. RTE.	SECTION	COUNTY	TOTAL SHEETS	SHEET NO.
		2827	09-00012-00-RS	COOK	13	8
SCALE:		SHEET NO. 8 OF 13 SHEETS		STA. N/A	TO STA. N/A	
		TC-10		CONTRACT NO. 63305		
		FED. ROAD DIST. NO. 1	ILLINOIS	FED. AID PROJECT ARA-9003 (429)		

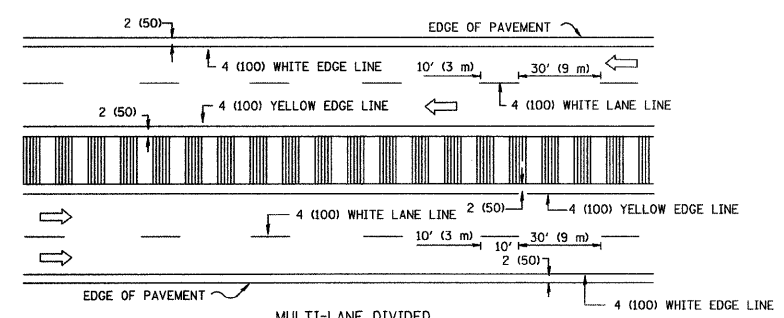
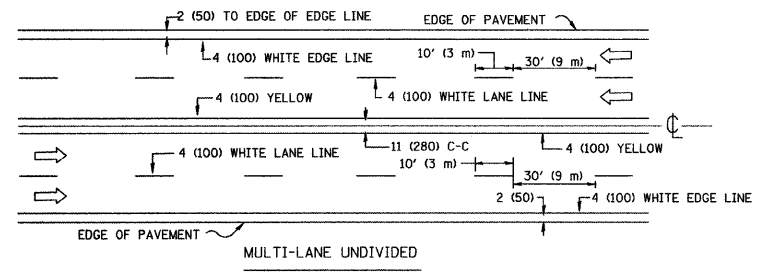
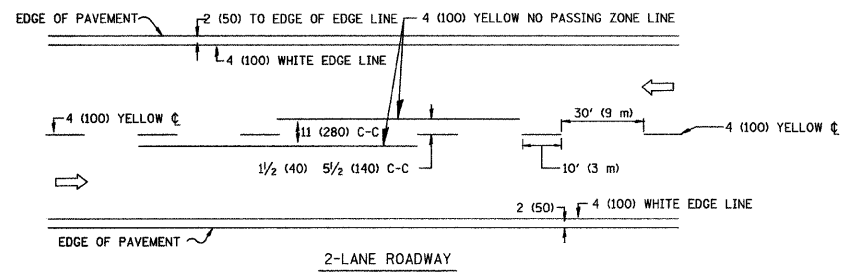

NOTE: MEDIANS WITH BARRIER CURB DO NOT REQUIRE AN EDGE LINE

TYPICAL LANE AND EDGE LINE MARKING

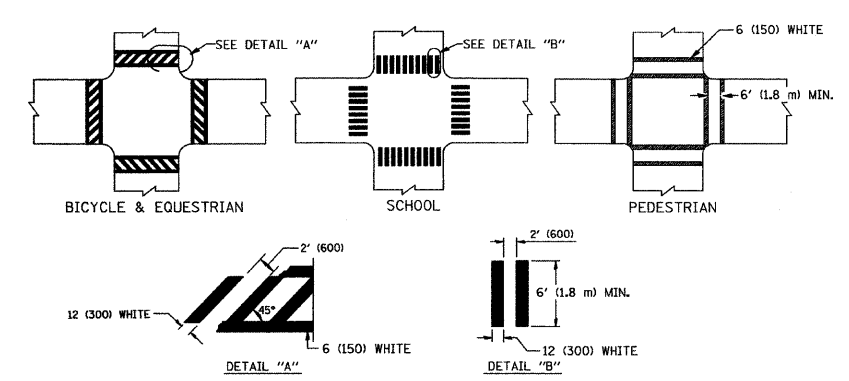

TYPICAL CROSSWALK MARKING

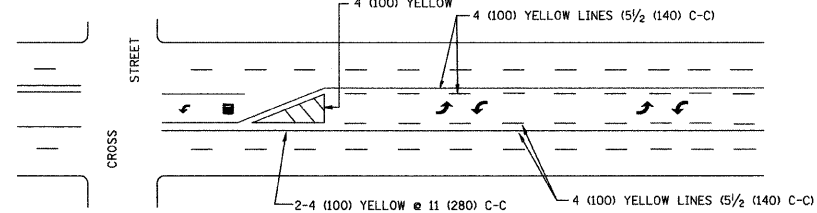
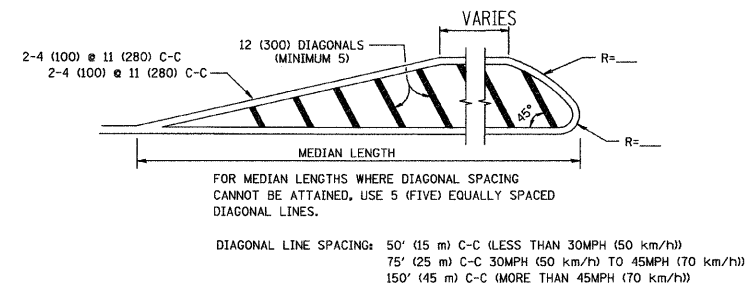
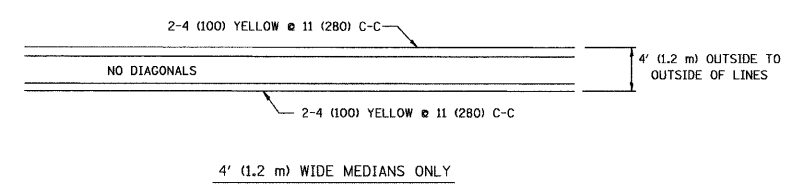

A MINIMUM OF TWO PAIRS OF TURN ARROWS SHALL BE USED, WHITE IN COLOR. ADDITIONAL PAIRS SHALL BE PLACED AT 200' (60 m) TO 300' (90 m) INTERVALS.

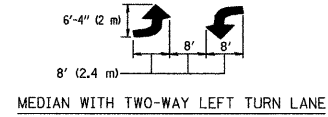

TYPICAL PAINTED MEDIAN MARKING

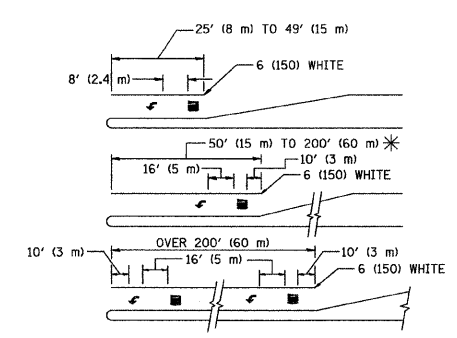

FULL SIZE LETTERS 8' (2.4 m) AND ARROWS SHALL BE USED.
 * AREA = 15.6 SQ. FT. (1.5 m²) * AREA = 20.8 SQ. FT. (1.9 m²)
 * TURN LANES IN EXCESS OF 400' (120 m) IN LENGTH MAY HAVE AN ADDITIONAL SET OF ARROW - "ONLY" INSTALLED MIDWAY BETWEEN THE OTHER TWO SETS OF ARROW - "ONLY".

TYPICAL LEFT (OR RIGHT) TURN LANE

TYPICAL TURN LANE MARKING

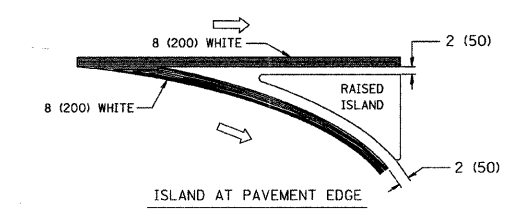
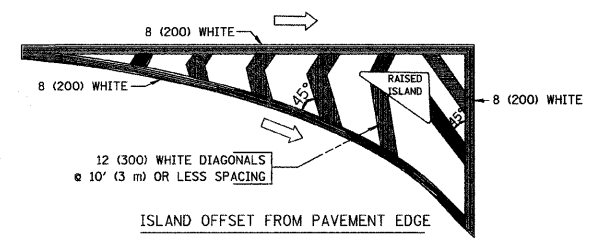

TYPICAL ISLAND MARKING

TYPE OF MARKING	WIDTH OF LINE	PATTERN	COLOR	SPACING / REMARKS
CENTERLINE ON 2 LANE PAVEMENT	4 (100)	SKIP-DASH	YELLOW	10' (3 m) LINE WITH 30' (9 m) SPACE
CENTERLINE ON MULTI-LANE UNDIVIDED PAVEMENT	2 @ 4 (100)	SOLID	YELLOW	11 (280) C-C
NO PASSING ZONE LINES: FOR ONE DIRECTION FOR BOTH DIRECTIONS	4 (100) 2 @ 4 (100)	SOLID SOLID	YELLOW YELLOW	5/2 (140) C-C FROM SKIP-DASH CENTERLINE 11 (280) C-C OMIT SKIP-DASH CENTERLINE BETWEEN
LANE LINES	4 (100) 5 (125) ON FREEWAYS	SKIP-DASH SKIP-DASH	WHITE WHITE	10' (3 m) LINE WITH 30' (9 m) SPACE
DOTTED LINES (EXTENSIONS OF CENTER, LANE OR TURN LANE MARKINGS)	SAME AS LINE BEING EXTENDED	SKIP-DASH	SAME AS LINE BEING EXTENDED	2' (600) LINE WITH 6' (1.8 m) SPACE
EDGE LINES	4 (100)	SOLID	YELLOW-LEFT WHITE-RIGHT	OUTLINE MOUNTABLE MEDIANS IN YELLOW; EDGE LINES ARE NOT USED NEXT TO BARRIER CURB
TURN LANE MARKINGS	6 (150) LINES; FULL SIZE LETTERS & SYMBOLS (8' (2.4m))	SOLID	WHITE	SEE TYPICAL TURN LANE MARKING DETAIL
TWO WAY LEFT TURN MARKING	2 @ 4 (100) EACH DIRECTION 8' (2.4m) LEFT ARROW	SKIP-DASH AND SOLID IN PAIRS	YELLOW WHITE	10' (3 m) LINE WITH 30' (9 m) SPACE FOR SKIP-DASH; 5/2 (140) C-C BETWEEN SOLID LINE AND SKIP-DASH LINE SEE TYPICAL TWO-WAY LEFT TURN MARKING DETAIL
CROSSWALK LINES (PEDESTRIAN) A. DIAGONALS (BIKE & EQUESTRIAN) B. LONGITUDINAL BARS (SCHOOL)	2 @ 6 (150) 12 (300) @ 45° 12 (300) @ 90°	SOLID SOLID SOLID	WHITE WHITE WHITE	NOT LESS THAN 6' (1.8 m) APART 2' (600) APART 2' (600) APART SEE TYPICAL CROSSWALK MARKING DETAILS.
STOP LINES	24 (600)	SOLID	WHITE	PLACE 4' (1.2 m) IN ADVANCE OF AND PARALLEL TO CROSSWALK, IF PRESENT. OTHERWISE, PLACE AT DESIRED STOPPING POINT. PARALLEL TO CROSSROAD CENTERLINE, WHERE POSSIBLE
PAINTED MEDIANS	2 @ 4 (100) WITH 12 (300) DIAGONALS @ 45° NO DIAGONALS USED FOR 4' (1.2 m) WIDE MEDIANS	SOLID	YELLOW; TWO WAY TRAFFIC WHITE; ONE WAY TRAFFIC	11 (280) C-C FOR THE DOUBLE LINE SEE TYPICAL PAINTED MEDIAN MARKING.
GORE MARKING AND CHANNELIZING LINES	8 (200) WITH 12 (300) DIAGONALS @ 45°	SOLID	WHITE	DIAGONALS: 15' (4.5 m) C-C (LESS THAN 30MPH (50 km/h)) 20' (6 m) C-C (30MPH (50 km/h) TO 45MPH (70 km/h)) 30' (9 m) C-C (OVER 45MPH (70 km/h))
RAILROAD CROSSING	24 (600) TRANSVERSE LINES; "RR" IS 6' (1.8 m) LETTERS; 16 (400) LINE FOR "X"	SOLID	WHITE	SEE STATE STANDARD 780001 AREA OF: "R"=3.5 SQ. FT. (0.33 m ²) EACH "X"=54.0 SQ. FT. (5.0 m ²)
SHOULDER DIAGONALS	12 (300) @ 45°	SOLID	WHITE - RIGHT YELLOW - LEFT	50' (15 m) C-C (LESS THAN 30MPH (50 km/h)) 75' (25 m) C-C (30 MPH (50 km/h) TO 45MPH (70 km/h)) 150' (45 m) C-C (OVER 45MPH (70 km/h))

FOR FURTHER DETAILS ON PAVEMENT MARKING REFER TO STANDARD SPECIFICATIONS FOR ROAD AND BRIDGE CONSTRUCTION AND STATE STANDARD 780001.

All dimensions are in inches (millimeters) unless otherwise shown.

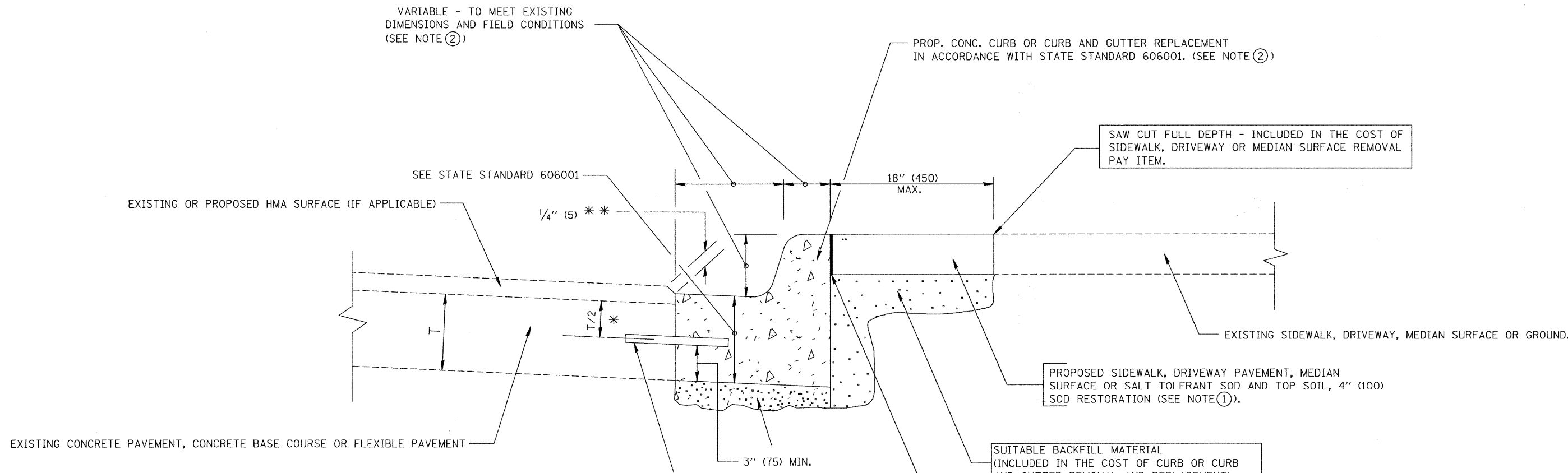

- * 3" (75) MINIMUM FROM TOP AND BOTTOM OF THE CONCRETE PAVEMENT OR BASE COURSE.
- ** IF THE FINAL SURFACE OF THE PAVEMENT IS CONCRETE, THE GUTTER IS TO BE FLUSH WITH THE PAVEMENT.

NOTE: ① SIDEWALK, DRIVEWAY PAVEMENT OR MEDIAN SURFACE SHALL BE SIMILAR TO THE MATERIAL BEING REMOVED AND WILL BE PAID FOR SEPARATELY.

SALT TOLERANT SOD AND TOP SOIL, 4" (100) RESTORATION WILL NOT BE PAID FOR SEPARATELY, BUT SHALL BE INCLUDED IN THE COST OF CURB OR CURB AND GUTTER REMOVAL AND REPLACEMENT.

- ② CURB OR CURB AND GUTTER REPLACEMENT SHALL MATCH THE SHAPE OF THE EXISTING CURB OR CURB AND GUTTER UNLESS OTHERWISE SPECIFIED.
- ③ FOR CURB OR CURB AND GUTTER REMOVAL AND REPLACEMENT ADJACENT TO FLEXIBLE PAVEMENT DELETE EPOXY COATED TIE BARS.
- ④ LONGITUDINAL BARS, IF ENCOUNTERED IN THE EXISTING CURB OR CURB AND GUTTER, ARE NOT TO BE REPLACED. CUTTING AND REMOVING LONGITUDINAL BARS SHALL BE INCLUDED IN THE COST OF CURB OR CURB AND GUTTER REMOVAL AND REPLACEMENT.
- ⑤ THE COST OF HMA SURFACE REMOVAL IN THE EXISTING GUTTER FLAG SHALL BE INCLUDED IN THE COST OF THE CURB AND GUTTER REMOVAL AND REPLACEMENT.
- ⑥ THE REMOVAL AND REPLACEMENT OF THE EXISTING CURB OR CURB AND GUTTER SHALL BE DONE IN ACCORDANCE WITH THE APPLICABLE PORTIONS OF SECTION 440 AND 606 OF THE STANDARD SPECIFICATIONS.
- ⑦ THE LOCATIONS OF REMOVAL AND REPLACEMENT OF EXISTING CURB OR CURB AND GUTTER SHALL BE DETERMINED BY THE RESIDENT ENGINEER AT THE TIME OF CONSTRUCTION.

- UNSUITABLE SUB-BASE MATERIAL TO BE REMOVED, IF DIRECTED BY THE ENGINEER, SHALL BE REPLACED WITH EITHER SUB-BASE GRANULAR MATERIAL, TYPE B OR ADDITIONAL THICKNESS OF CONCRETE.
- REMOVAL AND REPLACEMENT 4" (100) OR LESS IS INCLUDED IN THE COST OF CURB OR CURB AND GUTTER REMOVAL AND REPLACEMENT.
- REMOVAL AND REPLACEMENT IN EXCESS OF 4" (100) WILL BE PAID FOR IN ACCORDANCE WITH ARTICLE 109.04 OF THE STANDARD SPECIFICATIONS.
- PROPOSED #6 (20) EPOXY COATED TIE BARS 24" (600) LONG AT 24" (600) CENTERS WILL NOT BE PAID FOR SEPARATELY. DELETE EPOXY COATED TIE BARS IF EXISTING TIE BARS ARE USABLE AS DETERMINED BY THE ENGINEER. (SEE NOTE ③).

BASIS OF PAYMENT:
 THIS WORK WILL BE PAID FOR AT THE CONTRACT UNIT PRICE PER FOOT (METER) FOR "CURB REMOVAL AND REPLACEMENT" OR "COMBINATION CONCRETE CURB AND GUTTER REMOVAL AND REPLACEMENT".

CURB OR CURB AND GUTTER REMOVAL AND REPLACEMENT

ALL DIMENSIONS ARE IN INCHES (MILLIMETERS) UNLESS OTHERWISE SHOWN.

FILE NAME = 09325-DTIS-03 - 8D-24	USER NAME = geglienobt	DESIGNED - A. HOUSEH	REVISED - R. SHAH 10-03-96	STATE OF ILLINOIS DEPARTMENT OF TRANSPORTATION	CURB OR CURB AND GUTTER REMOVAL AND REPLACEMENT	F.A.U. RTE.	SECTION	COUNTY	TOTAL SHEETS	SHEET NO.			
		CHECKED -	REVISED - A. ABBAS 03-21-97			2927	09-00012-00-RS	COOK	13	10			
	PLOT SCALE = 50.000' / IN.	DRAWN -	REVISED - M. GOMEZ 01-22-01			BD600-06 (RD-24)							
	PLOT DATE = 1/4/2008	CHECKED - 03-11-94	REVISED - R. BORO 01-01-07			CONTRACT NO. 63305							
						SCALE:		SHEET NO. 10 OF 13 SHEETS		STA. N/A TO STA. N/A		FED. ROAD DIST. NO. 1 ILLINOIS FED. AID PROJECT ARA-9003 (429)	

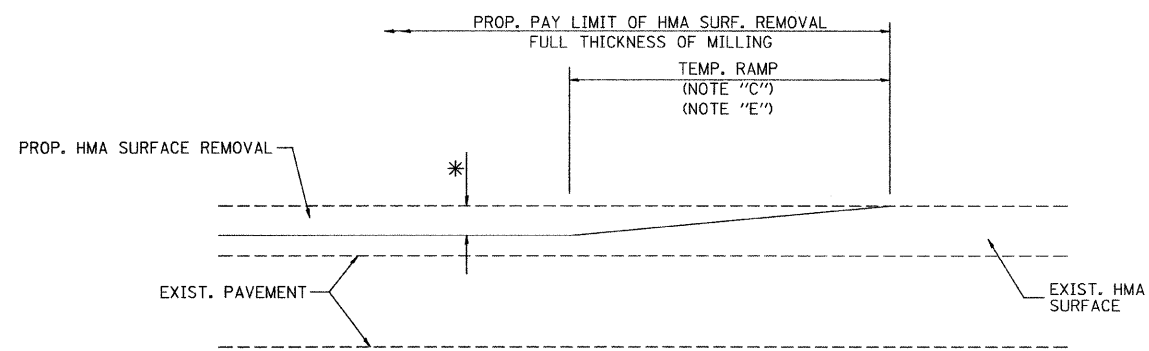

MILLED TEMPORARY RAMP
(FOR BUTT JOINT AND HMA TAPER SEE DETAIL BELOW)

OPTION 1

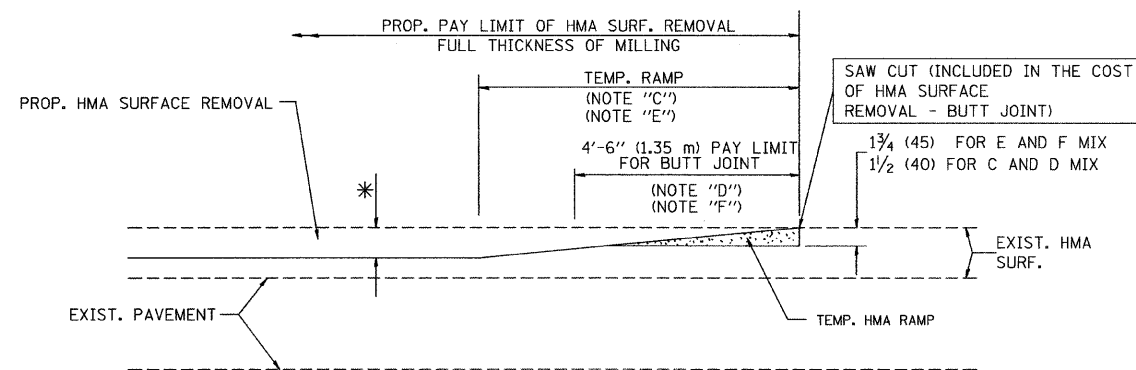

HMA CONSTRUCTED TEMPORARY RAMP
(FOR BUTT JOINT AND HMA TAPER SEE DETAIL BELOW)

OPTION 2

TYPICAL TEMPORARY RAMP

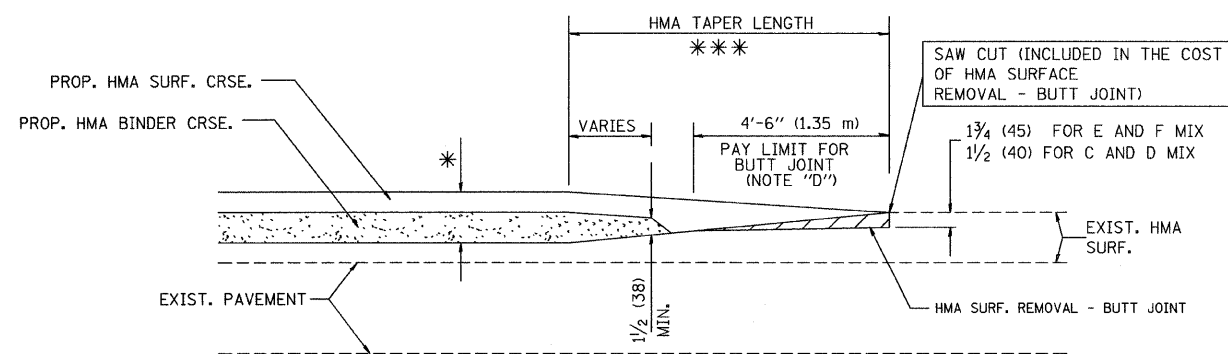

BUTT JOINT AND HMA TAPER
TYPICAL BUTT JOINT AND HMA TAPER
FOR MILLING AND RESURFACING

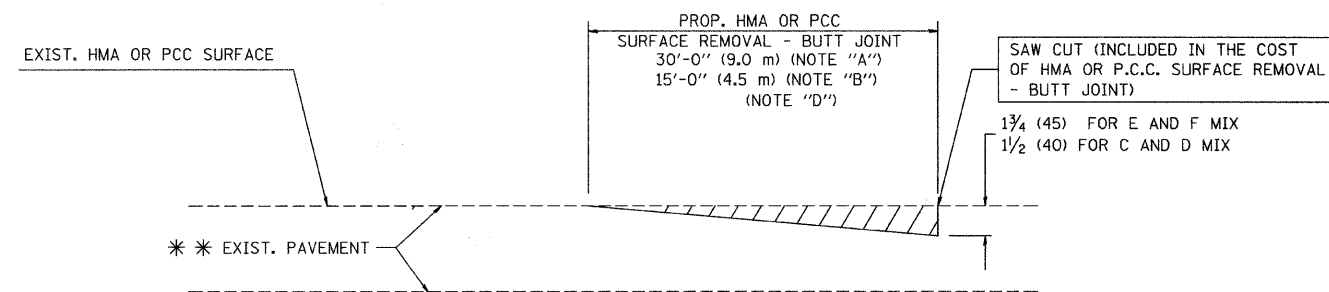

BUTT JOINT DETAIL

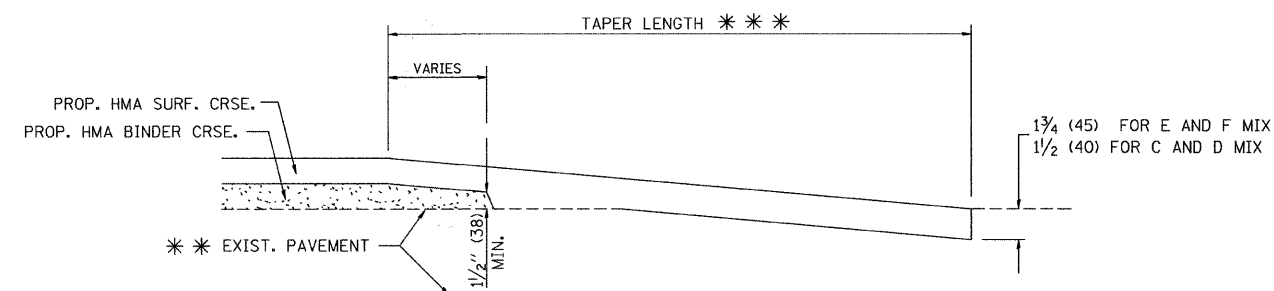

HMA TAPER DETAIL

TYPICAL BUTT JOINT AND HMA TAPER
FOR RESURFACING ONLY

*** PC CONCRETE, HMA OR HMA RESURFACED PAVEMENT.

NOTES

- A: MAINLINE ROADWAYS AND MAJOR SIDE ROADS.
 - B: MINOR SIDE ROADS.
 - C: THE TEMP. RAMP SHALL BE CONSTRUCTED IMMEDIATELY UPON REMOVAL OF THE EXISTING HMA SURFACE.
 - D: THE BUTT JOINT SHALL BE CONSTRUCTED IMMEDIATELY PRIOR TO PLACING THE PROPOSED HMA COURSES.
 - E: TAPER THE TEMP. RAMP AT A RATE OF 3'-0" (900 mm) PER 1 INCH (25 mm) OF MILLING THICKNESS.
 - F: INSTALLATION AND REMOVAL OF THE 4'-6" (1.35 m) TEMP. RAMP IS INCLUDED IN COST OF HMA SURFACE REMOVAL - BUTT JOINT
 - G: SEE ARTICLE 406.08 AND 406.14 OF THE STANDARD SPECIFICATIONS FOR "HMA AND/OR PCC SURFACE REMOVAL, BUTT JOINT".
- * SEE TYPICAL SECTIONS FOR MILLING THICKNESS.
- *** 20'-0" (6.1 m) PER 1 (25) RESURFACING (NOTE "A")
10'-0" (3.0 m) PER 1 (25) RESURFACING (NOTE "B")

BASIS OF PAYMENT:

THE BUTT JOINT WILL BE PAID FOR AT THE CONTRACT UNIT PRICE PER SQUARE YARD (SQUARE METER) FOR "HOT-MIX ASPHALT SURFACE REMOVAL - BUTT JOINT" OR FOR "PORTLAND CEMENT CONCRETE SURFACE REMOVAL - BUTT JOINT".

ALL DIMENSIONS ARE IN INCHES (MILLIMETERS) UNLESS OTHERWISE SHOWN.

FILE NAME = 09325-DTLS-04 - BD-32	USER NAME = gagl1enobt	DESIGNED -- M. DE YONG	REVISED -- R. SHAH 10-25-94
		CHECKED --	REVISED -- A. ABBAS 03-21-97
	PLOT SCALE = 50.0000' / IN.	DRAWN --	REVISED -- M. GOMEZ 04-06-01
	PLOT DATE = 1/4/2008	CHECKED -- 06-13-90	REVISED -- R. BORO 01-01-07

STATE OF ILLINOIS
DEPARTMENT OF TRANSPORTATION

SCALE:		SHEET NO. 11 OF 13 SHEETS		STA. N/A TO STA. N/A		F.A.U. RTE.		SECTION	COUNTY	TOTAL SHEETS	SHEET NO.
						2927	09-00012-00-RS	COOK	13	11	
						BD400-05 BD32		CONTRACT NO. 63305			
						FED. ROAD DIST. NO. 1		ILLINOIS		FED. AID PROJECT ARA-9003 (429)	

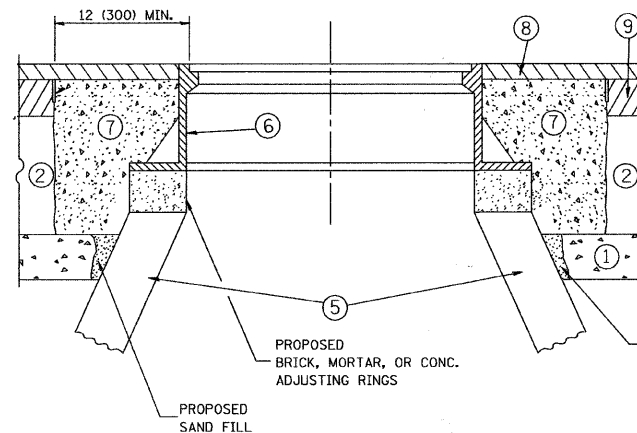
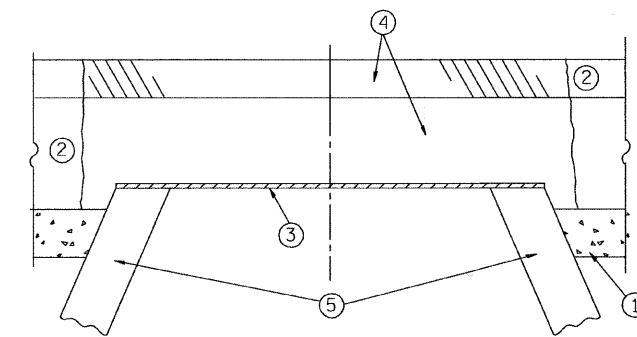

CONSTRUCTION PROCEDURES

STAGE 1 (BEFORE PAVEMENT MILLING)

- A) REMOVE A MINIMUM OF 12 (300) OF THE PAVEMENT FROM AROUND THE STRUCTURE.
- B) REMOVE THE EXISTING FRAME AND LID FROM THE STRUCTURE.
- C) COVER THE STRUCTURE OPENING WITH A 36 (900) DIAMETER METAL PLATE.
- D) BACKFILL WITH CRUSHED STONE AND A MINIMUM 1 1/2 (40) THICK HMA SURFACE MIX APPROVED BY THE ENGINEER.

STAGE 2 (AFTER PAVEMENT MILLING)

- A) REMOVE THE HMA SURFACE MIX AND CRUSHED STONE.
- B) INSTALL THE FRAME AND LID; ADJUST THE FRAME TO ITS FINAL SURFACE ELEVATION.
- C) THE SURROUNDING SPACE SHALL BE FILLED WITH CLASS SI CONCRETE, OR HMA SURFACE COURSE OR HMA BINDER COURSE TO THE ELEVATION OF THE SURFACE OF THE EXISTING BASE COURSE OR THE BINDER COURSE.

THE PROCEDURE EXPLAINED ABOVE SHALL CONFORM TO THE APPLICABLE PORTIONS OF SECTIONS 353, 406, 602, AND 603 OF THE STANDARD SPECIFICATIONS.

LEGEND

- ① SUB-BASE GRANULAR MATERIAL
- ② EXISTING PAVEMENT
- ③ 36 (900) DIAMETER METAL PLATE
- ④ PROPOSED CRUSHED STONE AND HMA SURFACE MIX
- ⑤ EXISTING STRUCTURE
- ⑥ FRAME AND LID (SEE NOTES)
- ⑦ CLASS SI CONCRETE, HMA SURFACE COURSE OR HMA BINDER COURSE
- ⑧ PROPOSED HMA SURFACE COURSE
- ⑨ PROPOSED HMA BINDER COURSE

LOCATION OF STRUCTURES:

THE CONTRACTOR WILL BE REQUIRED TO KEEP A RECORD OF THE LOCATIONS OF THE BURIED STRUCTURES ACCORDING TO THE STATION AND DISTANCE LEFT OR RIGHT OF THE CENTERLINE OF PAVEMENT. UPON COMPLETION OF THE WORK, THE CONTRACTOR WILL DELIVER THE RECORD TO THE ENGINEER.

BASIS OF PAYMENT: THIS WORK WILL BE PAID FOR AT THE CONTRACT UNIT PRICE PER EACH FOR "FRAMES AND LIDS TO BE ADJUSTED, SPECIAL"

NEW FRAMES AND LIDS, WHEN SPECIFIED, WILL BE PAID FOR SEPARATELY.

NOTES:

EXISTING BROKEN FRAMES AND LIDS SHALL BE REMOVED AND DISPOSED OF BY THE CONTRACTOR AND SHALL BE REPLACED AS DIRECTED BY THE ENGINEER. REPLACEMENT FRAMES AND LIDS WILL BE PAID FOR IN ACCORDANCE WITH ARTICLE 109.04 OF THE STANDARD SPECIFICATIONS UNLESS A SEPARATE PAY ITEM HAS BEEN PROVIDED.

IF THE EXISTING LIDS ARE OPEN, THE FRAME WILL BE ADJUSTED TO THE ELEVATION OF THE MILLED PAVEMENT SURFACE PRIOR TO THE MILLING OPERATION. THE FRAME WILL NOT BE REMOVED AND COVERED BY THE METAL PLATE.

CITY OF CHICAGO CASTINGS ARE THE PROPERTY OF THE CITY AND THE CONTRACTOR SHALL NOTIFY THE CITY FOR REMOVAL AND DISPOSITION OF THE CASTINGS.

THE METAL PLATE USED TO COVER THE STRUCTURE SHALL REMAIN THE PROPERTY OF THE CONTRACTOR.

WHEN STRUCTURES ARE TO BE ADJUSTED OR RECONSTRUCTED, THE LOWERING AND RAISING OF THE FRAMES AND LIDS WILL NOT BE PAID FOR SEPARATELY BUT WILL BE INCLUDED IN THE COST OF THE CORRESPONDING PAY ITEM.

DETAILS FOR FRAMES AND LIDS ADJUSTMENT WITH MILLING

ALL DIMENSIONS ARE IN INCHES (MILLIMETERS) UNLESS OTHERWISE SHOWN

FILE NAME = 09225-DTLS-05 - BD-08	USER NAME = geglenobt	DESIGNED — R. SHAH	REVISED —R. SHAH 03-10-95
		CHECKED —	REVISED — A. ABBAS 03-21-97
	PLOT SCALE = 50.0000' / IN.	DRAWN —	REVISED —R. WIEDEMAN 05-14-04
	PLOT DATE = 1/4/2008	CHECKED — 10-25-94	REVISED — R. BORO 01-01-07

STATE OF ILLINOIS
DEPARTMENT OF TRANSPORTATION

SCALE:		SHEET NO. 12 OF 13 SHEETS		STA. N/A TO STA. N/A		F.A.U. RTE.		SECTION		COUNTY		TOTAL SHEETS		SHEET NO.	
						2927		09-00012-00-RS		COOK		13		12	
						BD000-03 (BD-9)		CONTRACT NO. 63305							
						FED. ROAD DIST. NO. 1		ILLINOIS		FED. AID PROJECT		ARA-9003 (429)			

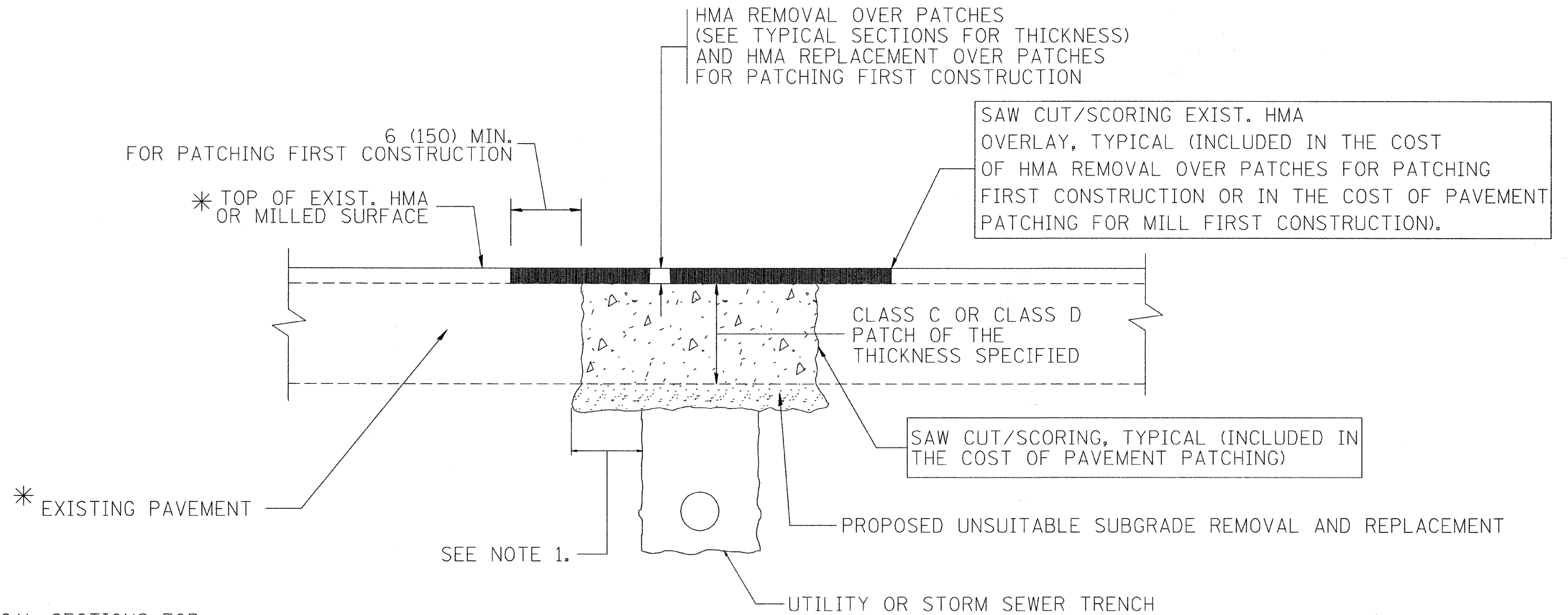

* SEE TYPICAL SECTIONS FOR THICKNESS AND MATERIALS

NOTES:

1. THE WIDTH OF THE FULL DEPTH PATCH OVER A TRENCH SHALL BE 12 (300) WIDER ON EACH SIDE OF THE TRENCH.
2. FOR METHOD OF MEASUREMENT AND BASIS OF PAYMENT, SEE RECURRING SPECIAL PROVISION "PATCHING WITH HOT-MIX ASPHALT OVERLAY REMOVAL".

SEQUENCE OF CONSTRUCTION (PATCHING FIRST)

1. REMOVE THE EXISTING HMA MATERIAL OVER THE AREA TO BE PATCHED.
2. REMOVE AND REPLACE WITH CLASS C OR D PATCH.
3. REPLACE HMA MATERIAL OVER THE AREA TO BE PATCHED.

SEQUENCE OF CONSTRUCTION (MILLING FIRST)

1. MILL HMA FIRST IF THERE IS AT LEAST 4 1/2 INCHES OR MORE OF HMA MATERIAL ON TOP OF THE EXISTING PAVEMENT OR IF THE PAVEMENT IS FULL DEPTH HMA. A MINIMUM OF 2 INCHES OF HMA MATERIAL SHALL BE IN PLACE AFTER MILLING.
2. REMOVE AND REPLACE WITH FULL DEPTH CLASS D PATCHES TO TOP OF MILLED SURFACE.

ALL DIMENSIONS ARE IN INCHES (MILLIMETERS) UNLESS OTHERWISE SHOWN.

FILE NAME = 06025-DTIS-06 - BD-22	USER NAME = bauer.dl	DESIGNED - R. SHAH	REVISED - A. ABBAS 04-27-98	STATE OF ILLINOIS DEPARTMENT OF TRANSPORTATION	PAVEMENT PATCHING FOR HMA SURFACED PAVEMENT			F.A.U. RTE.	SECTION	COUNTY	TOTAL SHEETS	SHEET NO.	
		CHECKED -	REVISED - R. BORO 01-01-07		SCALE:	SHEET NO. 13 OF 13 SHEETS	STA. N/A	TO STA. N/A	2927	09-00012-00-RS	COOK	13	13
		PLOT SCALE = 50,000' / IN.	DRAWN -		REVISED - R. BORO 09-04-07				BD400-04 (BD-22)				
		PLOT DATE = 10/27/2008	CHECKED - 10-25-94		REVISED - K. ENG 10-27-08				CONTRACT NO. 63305				
								FED. ROAD DIST. NO. 1 ILLINOIS FED. AID PROJECT ARA-9003 (429)					