

F.A.U. RTE.	SECTION	COUNTY	TOTAL SHEETS	SHEET NO.
09-00092-00-RS		COOK	18	8
STA. 130+00 TO STA. 136+00				
FED. ROAD DIST. NO. C-91-743-09	ILLINOIS	FED. AID PROJECT ARA-900315371		
FAU 2836 ORCHARD DRIVE CONTRACT NO. 63310				

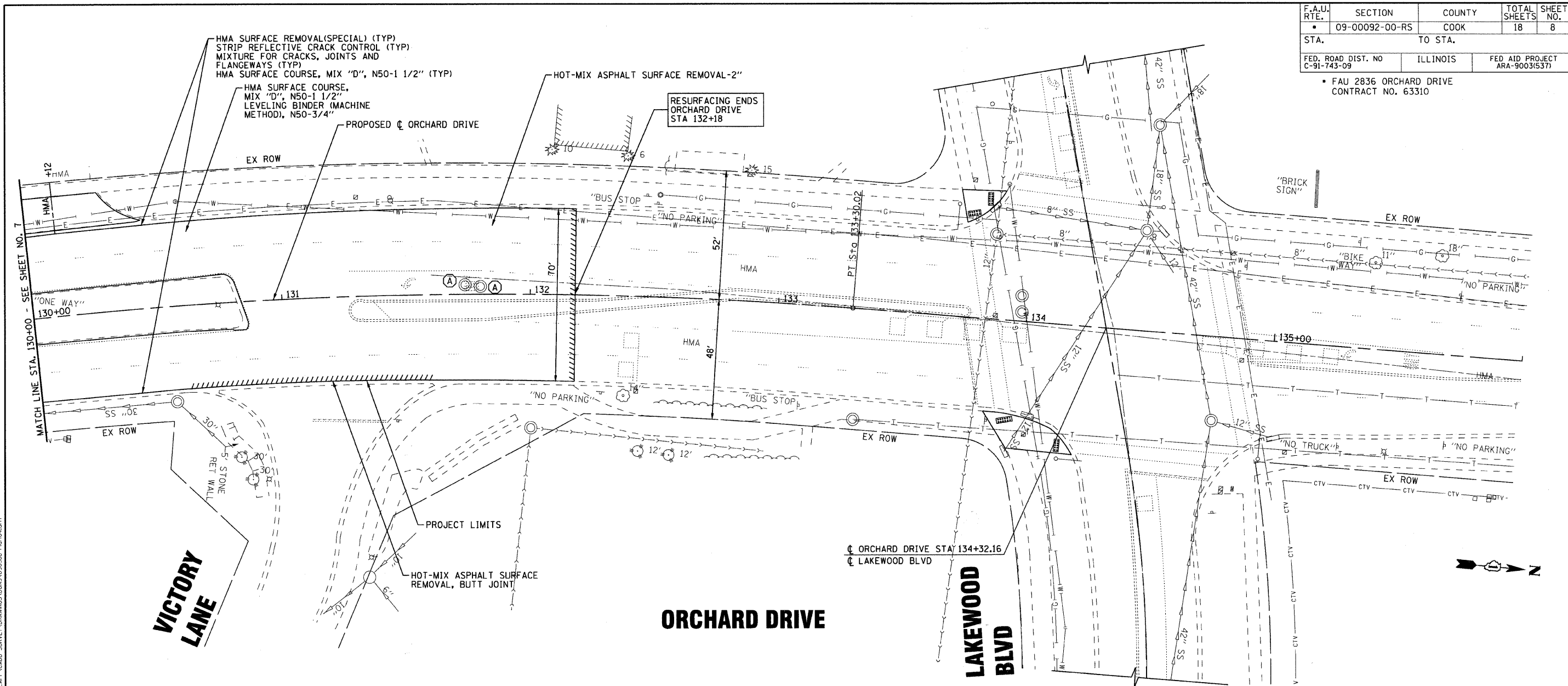

LEGEND

- ////// BUTT JOINT OR DRIVEWAY BUTT JOINT
- (S) FRAME AND LIDS TO BE REPLACED
- (A) DRAINAGE & UTILITY STRUCTURES TO BE ADJUSTED
- (R) SEWER STRUCTURES TO BE RECONSTRUCTED
- o MANHOLE

NOTE:

1. AT THE LOCATIONS OF THE PROPOSED DETECTABLE WARNINGS AND CURB RAMPS THE CURB AND GUTTER SHALL BE DEPRESSED.

COPYRIGHT © 2009 BY BAXTER & WOODMAN, INC.
 STATE OF ILLINOIS - PROFESSIONAL DESIGN FIRM
 No. 184-07/27/2009
 4866cc
 ...\\projects\lapp\2836\plan04.shp
 ...\\projects\lapp\2836\plan04.dwg
 ...\\projects\lapp\2836\plan04.plt
 ...\\projects\lapp\2836\plan04.prt
 ...\\projects\lapp\2836\plan04.shx
 ...\\projects\lapp\2836\plan04.spl
 ...\\projects\lapp\2836\plan04.stb
 ...\\projects\lapp\2836\plan04.stm
 ...\\projects\lapp\2836\plan04.syd
 ...\\projects\lapp\2836\plan04.tlb
 ...\\projects\lapp\2836\plan04.tli
 ...\\projects\lapp\2836\plan04.tlx
 ...\\projects\lapp\2836\plan04.tly
 ...\\projects\lapp\2836\plan04.tlz
 ...\\projects\lapp\2836\plan04.tzr
 ...\\projects\lapp\2836\plan04.tzshp
 ...\\projects\lapp\2836\plan04.tzshx
 ...\\projects\lapp\2836\plan04.tzshl
 ...\\projects\lapp\2836\plan04.tzshp
 ...\\projects\lapp\2836\plan04.tzshx
 ...\\projects\lapp\2836\plan04.tzshl
 ...\\projects\lapp\2836\plan04.tzshp
 ...\\projects\lapp\2836\plan04.tzshx
 ...\\projects\lapp\2836\plan04.tzshl



DESIGNED	JGH/CAC	REVISED	PER IDOT 10-06-09
DRAWN	BCD	REVISED	
CHECKED	NJP	REVISED	
DATE	5-22-09	FILE	090388-Plan04.shp

VILLAGE OF PARK FOREST, ILLINOIS
FAU 2836 ORCHARD DRIVE LAPP RESURFACING
SECTION 09-00092-00-RS

ORCHARD DRIVE PLAN

SCALE: 1"=20'

STA. 130+00 TO STA. 136+00

F.A.U. RTE.	SECTION	COUNTY	TOTAL SHEETS	SHEET NO.
09-00092-00-RS		COOK	18	8
STA. 130+00 TO STA. 136+00				
FED. ROAD DIST. NO.	ILLINOIS	FED. AID PROJECT		
CONTRACT NO. 63310				