

F.A.U. RTE.	SECTION	COUNTY	TOTAL SHEETS	SHEET NO.
09-00092-00-RS		COOK	18	10
STA.	TO STA.			
FED. ROAD DIST. NO. C-91-743-09	ILLINOIS	FED AID PROJECT ARA-90031537		

FAU 2836 ORCHARD DRIVE
CONTRACT NO. 63310

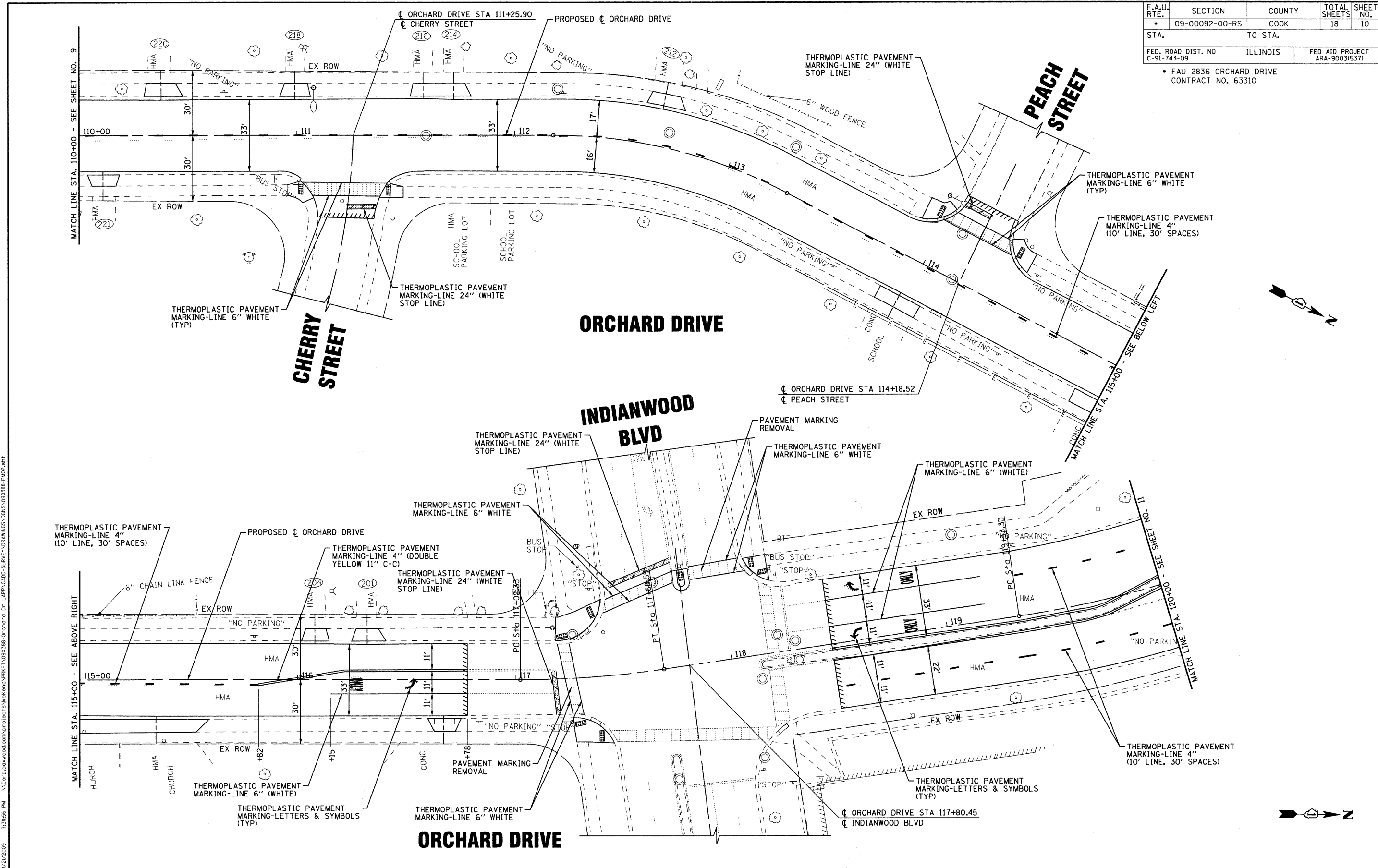

COPYRIGHT © 2009, BY BAXTER & WOODMAN, INC.
 STATE OF ILLINOIS - PROFESSIONAL DESIGN FIRM
 48650C
 10/21/2009
 L:\Projects\090388-Orchard Dr. LAPP\CADD-SURVEY\DRAWINGS\090388-PM02.sht



DESIGNED -	JGH/CAC	REVISED -	PER IDOT 10-06-09
DRAWN -	BCD	REVISED -	
CHECKED -	NJP	REVISED -	
DATE -	5-22-09	FILE -	090388-PM02.sht

VILLAGE OF PARK FOREST, ILLINOIS
FAU 2836 ORCHARD DRIVE LAPP RESURFACING
SECTION 09-00092-00-RS

PAVEMENT MARKING PLAN

SCALE: 1"=20' STA. 110+00 TO STA. 120+00

F.A.U. RTE.	SECTION	COUNTY	TOTAL SHEETS	SHEET NO.
09-00092-00-RS		COOK	18	10
FED. ROAD DIST. NO.		ILLINOIS	FED. AID PROJECT	
		CONTRACT NO. 63310		