

| | | | | |
|---------------------------------|----------|-------------------------------|--------------|-----------|
| F.A.U. RTE. | SECTION | COUNTY | TOTAL SHEETS | SHEET NO. |
| 09-00092-00-RS | | COOK | 18 | 12 |
| STA. | TO STA. | | | |
| FED. ROAD DIST. NO. C-91-743-09 | ILLINOIS | FED AID PROJECT ARA-9003(537) | | |

FAU 2836 ORCHARD DRIVE
CONTRACT NO. 63310

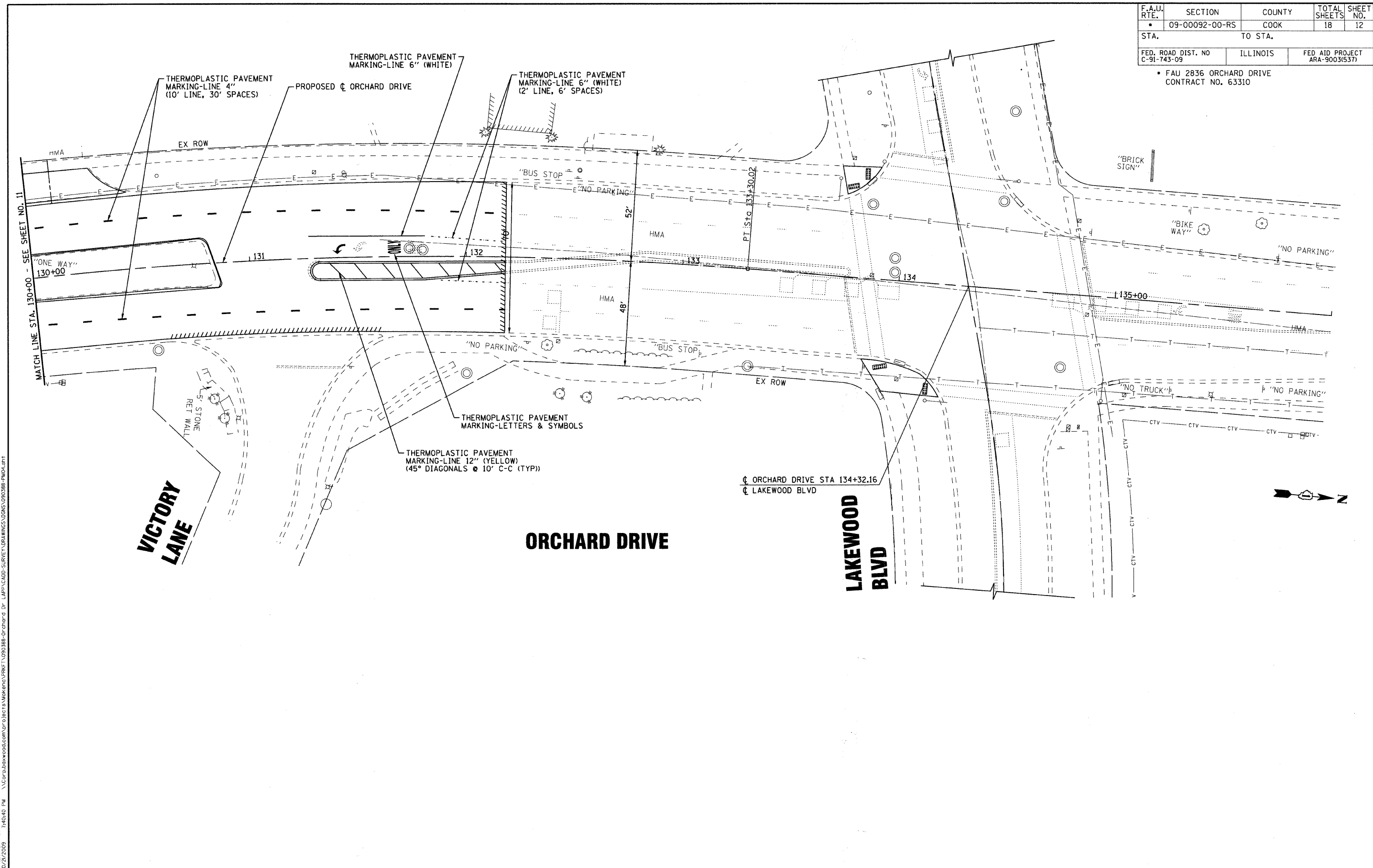

COPYRIGHT © 2009 BY BAXTER & WOODMAN, INC.
 STATE OF ILLINOIS - PROFESSIONAL DESIGN FIRM
 4882CC
 10/21/2009
 \\C:\p\l\wood\lpp\090388-0r-orchd\prk\090388-0r-orchd.dwg
 \\C:\p\l\wood\lpp\090388-0r-orchd\prk\090388-0r-orchd.dwg



| | |
|--------------------|-----------------------------|
| DESIGNED - JGH/CAC | REVISED - PER IDOT 10-06-09 |
| DRAWN - BCD | REVISED - |
| CHECKED - NJP | REVISED - |
| DATE - 5-22-09 | FILE - 090388-PM04.sht |

VILLAGE OF PARK FOREST, ILLINOIS
FAU 2836 ORCHARD DRIVE LAPP RESURFACING
SECTION 09-00092-00-RS

PAVEMENT MARKING PLAN
 SCALE: 1"=20'
 STA. 130+00 TO STA. 136+00

| | | | | |
|---------------------|----------|------------------|--------------|-----------|
| F.A.U. RTE. | SECTION | COUNTY | TOTAL SHEETS | SHEET NO. |
| 09-00092-00-RS | | COOK | 18 | 12 |
| FED. ROAD DIST. NO. | ILLINOIS | FED. AID PROJECT | | |