

F.A.U. RTE.	SECTION	COUNTY	TOTAL SHEETS	SHEET NO.
1638*	**	WILL	38	30
STA. 67+00		TO STA. 70+50		
FED. ROAD DIST. NO. _		ILLINOIS	FED. AID PROJECT	
CONTRACT NO. 63316		* EXCHANGE STREET ** 09-00044-01-TL		

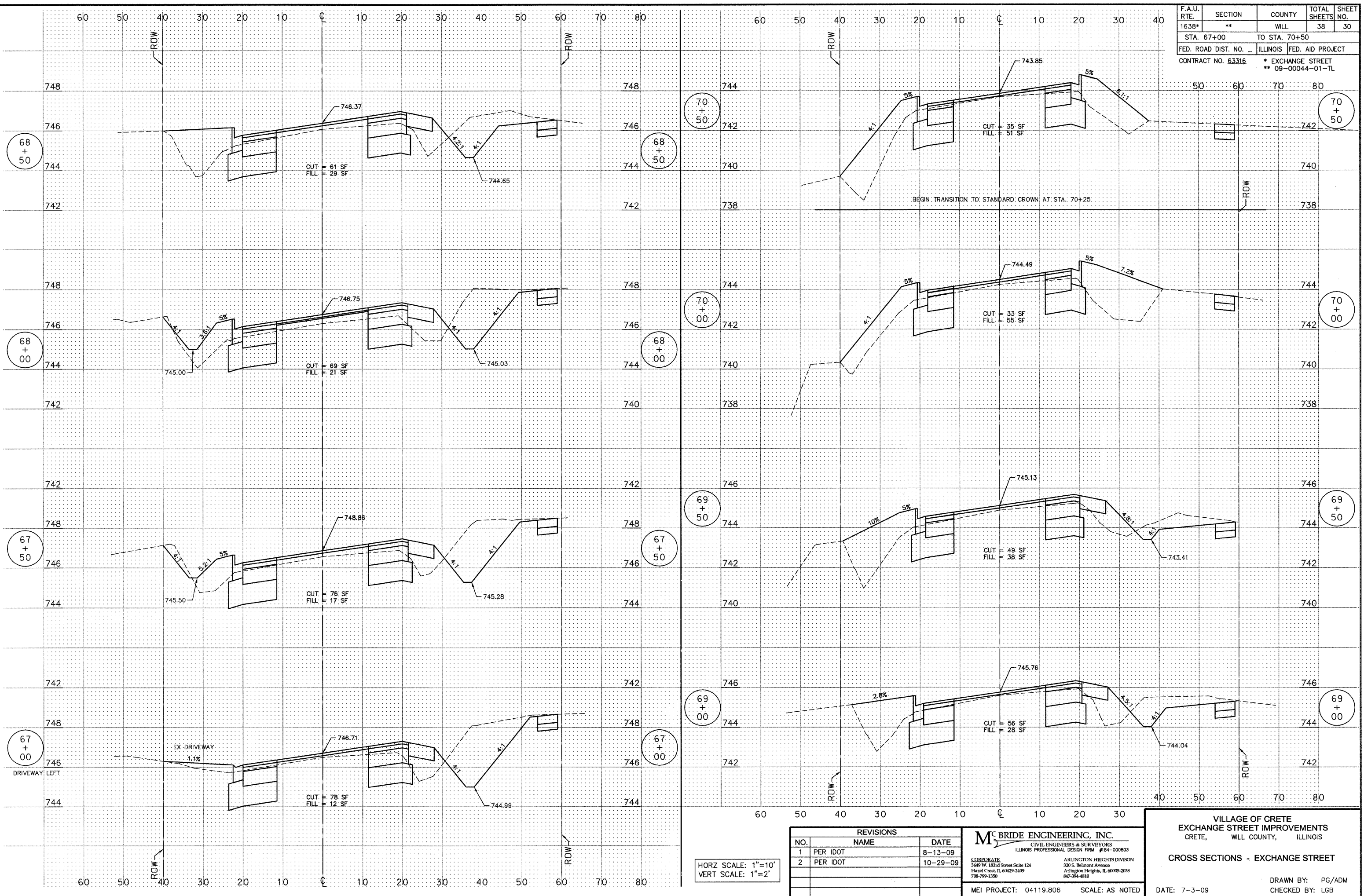

M:\2004\04119_4\dwg\04119.806_CROSS_SECTIONS.dwg 10/29/2009 11:42:31 AM CDT

HORZ SCALE: 1"=10'
VERT SCALE: 1"=2'

REVISIONS		
NO.	NAME	DATE
1	PER IDOT	8-13-09
2	PER IDOT	10-29-09

McBRIDE ENGINEERING, INC.
 CIVIL ENGINEERS & SURVEYORS
 ILLINOIS PROFESSIONAL DESIGN FIRM #184-000803

CORPORATE
 3649 W. 183rd Street Suite 124
 Hazel Crest, IL 60429-2409
 708-799-1350

ARLINGTON HEIGHTS DIVISION
 320 S. Belmont Avenue
 Arlington Heights, IL 60005-2038
 847-394-4810

MEI PROJECT: 04119.806 SCALE: AS NOTED

VILLAGE OF CRETE
 EXCHANGE STREET IMPROVEMENTS
 CRETE, WILL COUNTY, ILLINOIS

CROSS SECTIONS - EXCHANGE STREET

DATE: 7-3-09

DRAWN BY: PG/ADM
 CHECKED BY: LGB