

- NOTES:**
- TRENCH SHALL BE IN ACCORDANCE WITH OSHA SAFETY STANDARDS.
 - BEDDING SHALL BE REQUIRED TO BE A MINIMUM THICKNESS EQUAL TO 1/4 OF THE OUTSIDE DIAMETER OF THE PIPE BUT SHALL NOT BE MORE THAN 6\" AND LESS THAN 4\". AS A MINIMUM, BEDDING AND HAUNCHING MATERIAL SHALL CONFORM TO THE REQUIREMENTS OF THE \"STANDARD SPECIFICATIONS FOR ROAD AND BRIDGE CONSTRUCTION.\" THE GRADATIONS SHALL EITHER BE FA-1 OR FA-2.
 - WHEN STORM SEWER CONSTRUCTION OCCURS IN COMBINED SEWER AREAS, BEDDING AND HAUNCHING MATERIAL SHALL CONFORM TO THE REQUIREMENTS OF THE \"METROPOLITAN WATER RECLAMATION DISTRICT OF GREATER CHICAGO.\" THE GRADATIONS SHALL EITHER BE CA-11 OR CA-13.

TRENCH BACKFILL DETAIL FOR STORM SEWER

NOTES

- ALL RIM ELEVATIONS OF STRUCTURES IN THE CURB LINE ARE GIVEN TO THE EDGE OF PAVEMENT. ALL OTHER RIM ELEVATIONS ARE GIVEN TO THE CENTER OF STRUCTURES.

BENCH MARK:

DESCRIPTION: SQUARE CUT ON SW CORNER OF CONC. BASE FOR FLAGPOLE AT THE NE CORNER OF CHICAGO HEIGHTS-GLENWOOD RD & HOLBROOK RD., ON N. SIDE OF BIT DRIVE TO NICOR GAS.
 NGVD 2' ELEVATION = 630.227

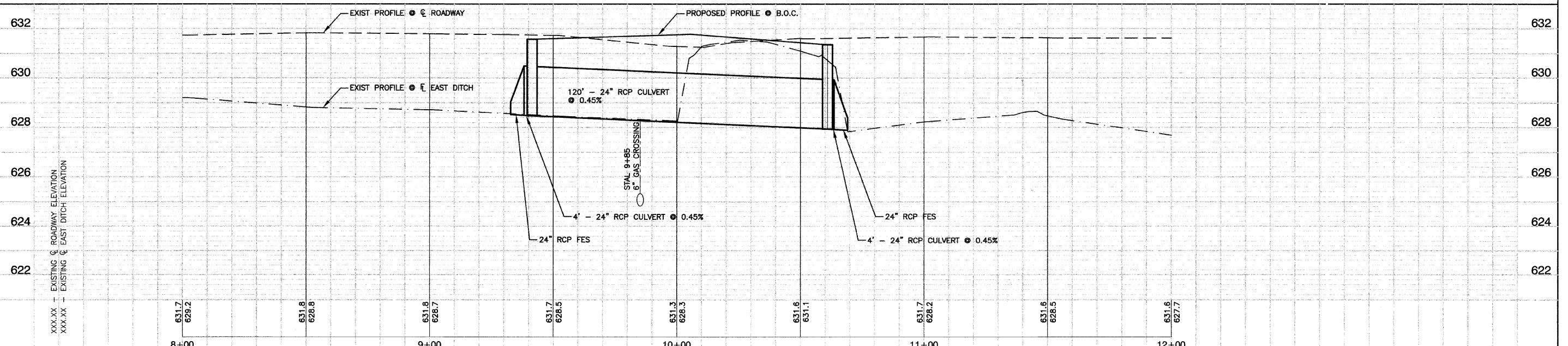

FILE NAME = 05567-STRM-01 - PROP	USER NAME =	DESIGNED = BDB/JRA	REVISED =	STATE OF ILLINOIS DEPARTMENT OF TRANSPORTATION	CHICAGO HEIGHTS-GLENWOOD ROAD AND HOLBROOK ROAD INTERSECTION IMPROVEMENTS PROPOSED DRAINAGE & UTILITIES PLAN AND PROFILE	F.A./RTE = 3603	SECTION = 09-00050-00-TL	COUNTY = COOK	TOTAL SHEETS = 31	SHEET NO. = 9	
	PLOT SCALE =	CHECKED = PKB	REVISED =			CONTRACT NO. 63320					
	PLOT DATE = 10-29-09	DRAWN = JJB	REVISED =			SCALE: H:1\"=20' V:1\"=2'					
		CHECKED = JRA	REVISED =			SHEET NO. 9 OF 31 SHEETS STA. TO STA.					