

PROP. WALL ELEVATIONS

STATION	T/W	F/G
0+54	602.80	601.50
1+00	603.50	602.00
1+30	603.00	602.50

SIDEWALK CROSS-GRADES AT DRIVEWAYS

STATION	DRIVE GRADE	WALK GRADE
1+51 R	9.4%	2% & 5%
1+96 R	0.4%	0.5%
2+91 R	4.8%	2%
3+80 R	7.2%	2% & 5%
5+08 R	10.7%	2% & 5%
10+13 L	10.9%	2% & 5%

NOTE: WHERE WALK GRADE IS 2% & 5%, THE FIRST THREE FEET ARE AT 2% AND THE LAST TWO FEET ARE AT 5%.

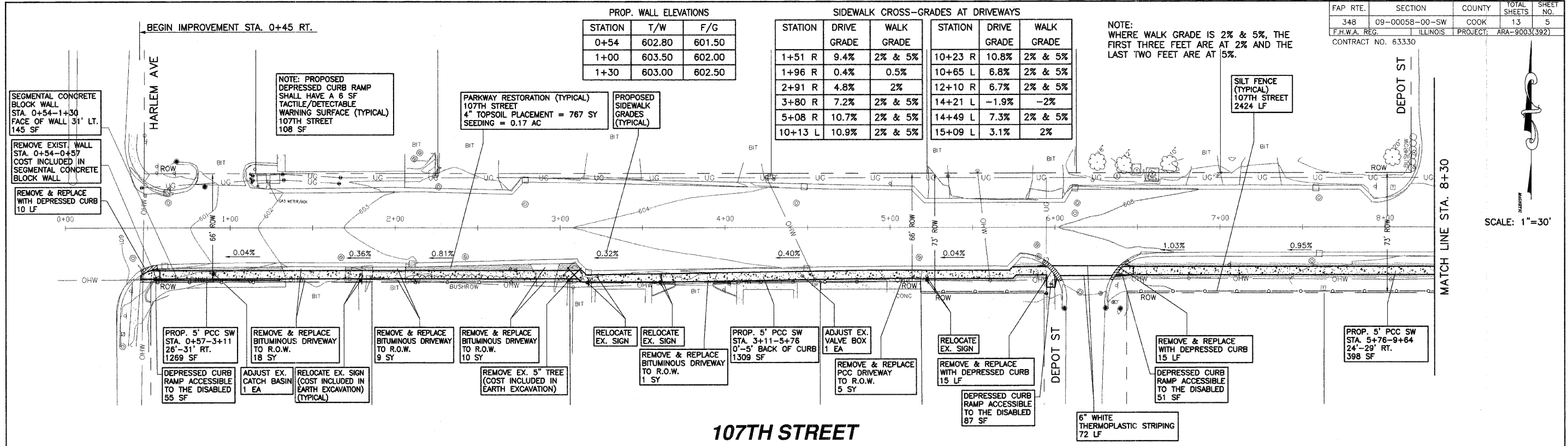

SCALE: 1"=30'

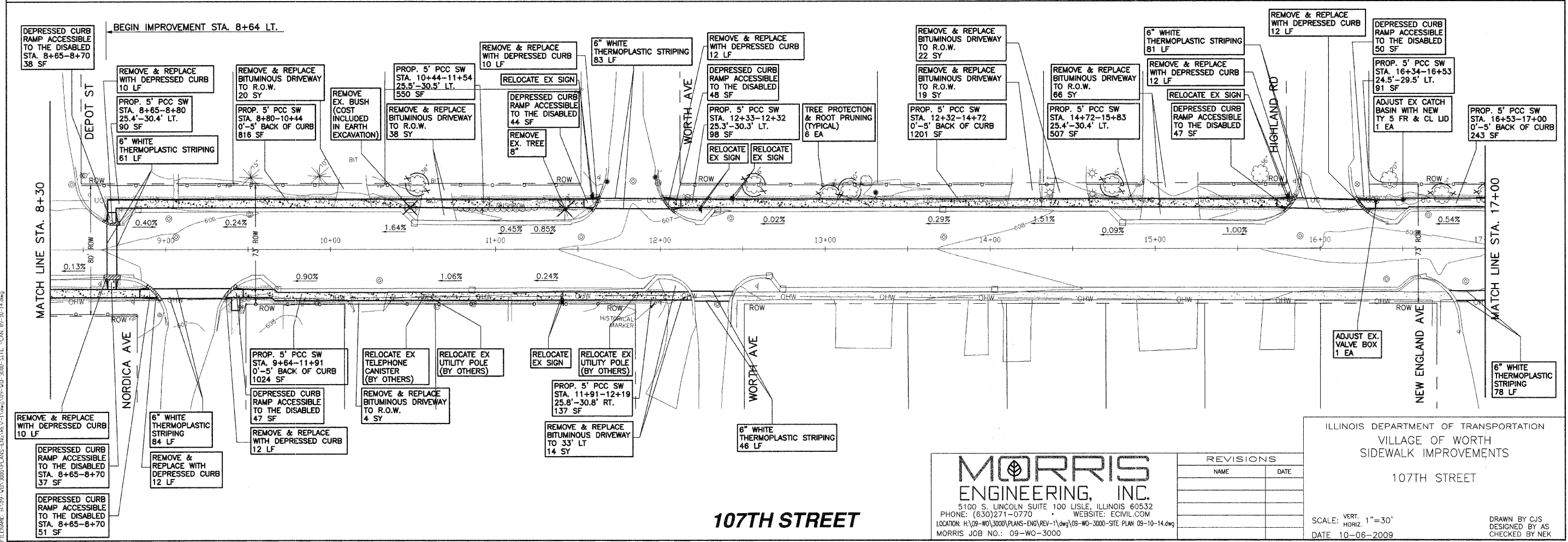

107TH STREET

**MORRIS ENGINEERING, INC.**  
 5100 S. LINCOLN SUITE 100 LISLE, ILLINOIS 60532  
 PHONE: (630)271-0770 WEBSITE: ECIVIL.COM  
 LOCATION: H:\09-WO\3000\PLANS-ENG\REV-1\dwg\09-WO-3000-SITE PLAN 09-10-14.dwg  
 MORRIS JOB NO.: 09-WO-3000

REVISIONS

NAME	DATE

ILLINOIS DEPARTMENT OF TRANSPORTATION  
 VILLAGE OF WORTH  
 SIDEWALK IMPROVEMENTS  
 107TH STREET

SCALE: VERT. 1"=30'  
 HORIZ. 1"=30'  
 DATE 10-06-2009

DRAWN BY CJS  
 DESIGNED BY AS  
 CHECKED BY NEK

PLOT DATE: NOV 05 2009  
 FILENAME: H:\09-WO\3000\PLANS-ENG\REV-1\dwg\09-WO-3000-SITE PLAN 09-10-14.dwg