

TEMPORARY CABLE PLAN LEGEND

- R TEMPORARY TRAFFIC SIGNAL SECTION OR PEDESTRIAN SIGNAL SECTION 12"
- TEMPORARY CONTROLLER CABINET
- TEMPORARY SERVICE INSTALLATION
- ⑤ INDICATES NUMBER OF CONDUCTORS IN CABLE. ALL CONDUCTORS TO BE NUMBER 14 AWG WIRE UNLESS OTHERWISE NOTED.
- EMERGENCY VEHICLE LIGHT DETECTOR
- CONFIRMATION BEACON
- VEHICLE DETECTOR, INDUCTION LOOP
- PEDESTRIAN PUSHBUTTON DETECTOR
- PEDESTRIAN SIGNAL HEAD
- VIDEO DETECTION CAMERA
- PTZ CAMERA

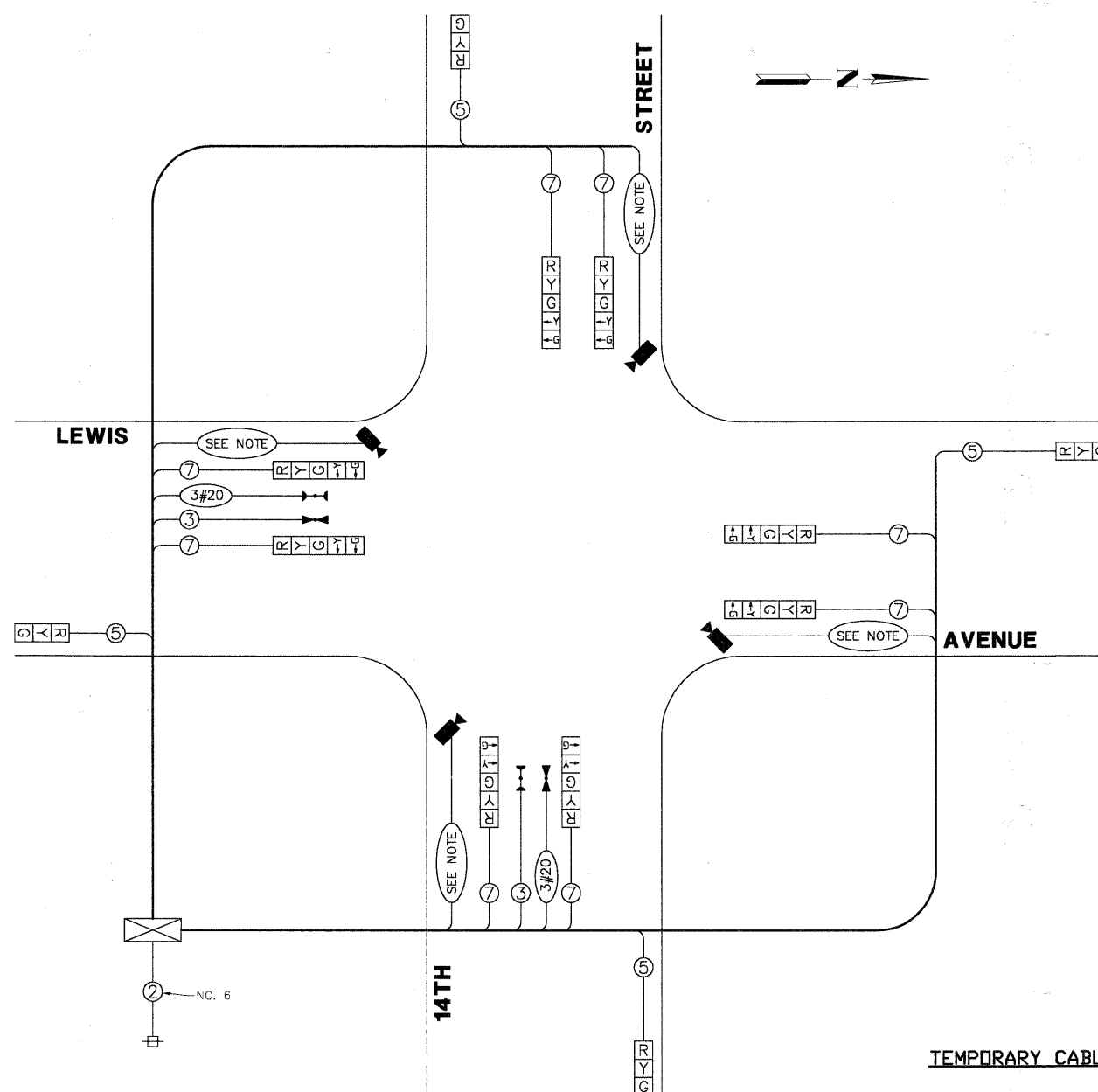

NOTE:
IF THE CONTRACTOR DECIDES TO USE THEIR OWN VIDEO DETECTION CAMERAS FOR THE TEMPORARY TRAFFIC SIGNAL, THE CABLE TO SERVICE THE CAMERA CAN BE NO. 16, 5 1/2 PAIR OR NO. 18, 3/C. IF THE CONTRACTOR DECIDES TO USE NEW VIDEO DETECTION CAMERAS FOR THE TEMPORARY TRAFFIC SIGNAL THAT WILL BE RELOCATED TO THE PERMANENT TRAFFIC SIGNAL, THE CABLE TO SERVICE THE NEW CAMERA SHALL BE NO. 18, 3/C.

TEMPORARY CABLE PLAN

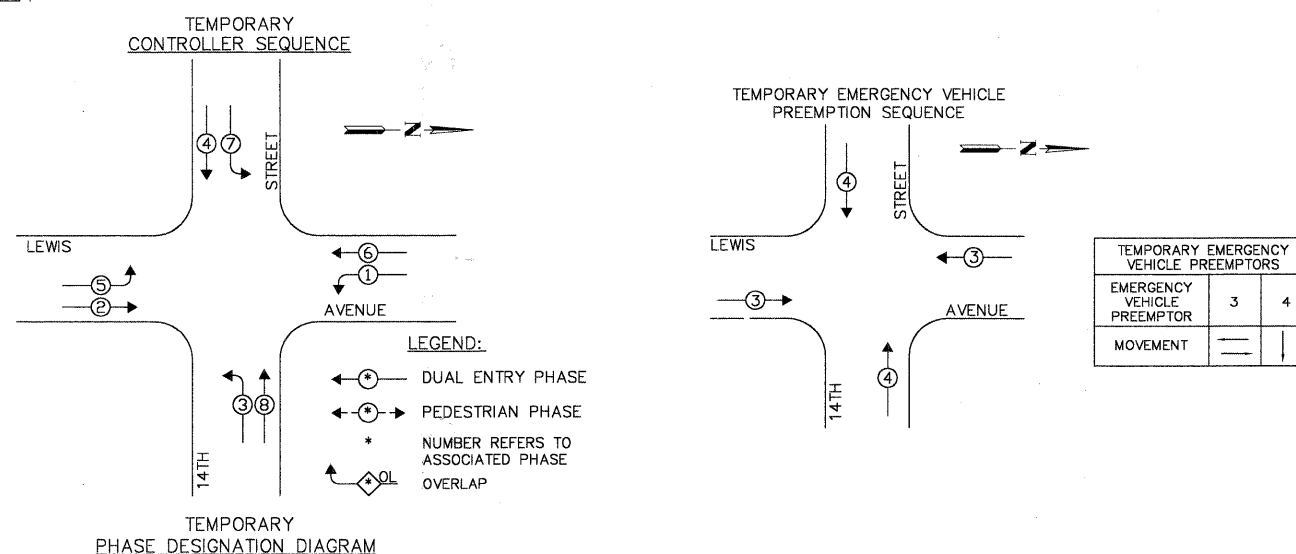

TEMPORARY EMERGENCY VEHICLE PREEMPTORS	
EMERGENCY VEHICLE PREEMPTOR	3 4
MOVEMENT	=

L.C.D.O.T. TRAFFIC SIGNAL INSTALLATION ELECTRICAL SERVICE REQUIREMENTS					TOTAL WATTAGE
TYPE	NO LAMPS	INCAND.	L.E.D.	% OPERATION	
SIGNAL (RED)	12	135	10	0.50	60.0
SIGNAL (YELLOW)	12	135	19	0.10	22.8
SIGNAL (GREEN)	12	135	11	0.40	52.8
ARROW	16	135	9	0.10	14.4
FED. SIGNAL	-	90	9	1.00	-
CONTROLLER	1	100	100	1.00	100.0
LUMINAIRE	-	150	250	0.50	-
L.E.D. ST. NAME SIGN	-	-	64	0.50	-
VIDEO SYSTEM	1	150	150	1.00	150.0
BATTERY BACKUP	-	-	25	-	-
TOTAL =					400.0

ENERGY COSTS - BILLED TO: CITY OF WAUKEGAN
(ADDRESS) 100 N. M.L.K. JR. AVENUE
(ADDRESS) WAUKEGAN, IL

ENERGY SUPPLY - CONTACT: NEW BUSINESS
PHONE: 1-866-639-3552
COMPANY: COMED