

DATE	BY	REVISIONS	CHECKED	PLANNED
PLAN	NO. 1	NO. 2	NO. 3	NO. 4

DATE	BY	REVISIONS	CHECKED	PLANNED
PROFILE	NO. 1	NO. 2	NO. 3	NO. 4

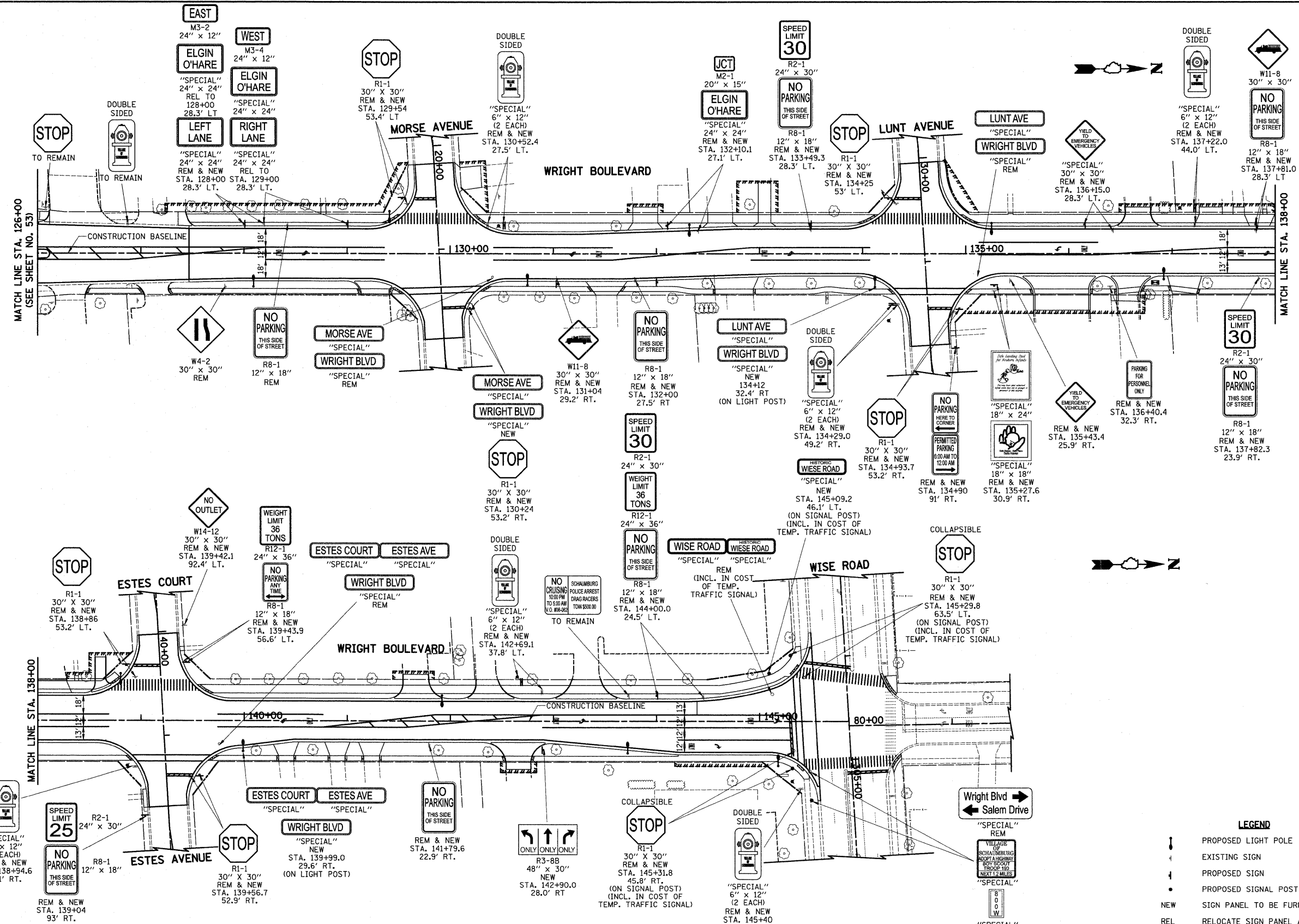

NOTE

1) ALL SIGNS DESIGNATED AS "NEW" SHALL BE PROVIDED BY THE VILLAGE. THE VILLAGE SHALL ALSO PROVIDE THE REQUIRED SIGN POSTS. THE CONTRACTOR SHALL INSTALL THE SIGN POSTS AT THE LOCATIONS NOTED AND INSTALL THE SIGN PANELS ON THE SIGN SUPPORTS. THE CONTRACTOR SHALL BE RESPONSIBLE FOR CONTACTING THE VILLAGE AT LEAST 48 HOURS PRIOR TO THE TIME OF INSTALLATION TO COORDINATE PICK-UP OF THE SIGN PANELS AND SUPPORTS FROM THE VILLAGE'S PUBLIC WORKS FACILITY. THIS WORK SHALL BE PAID FOR AS "INSTALL EXISTING SIGN PANEL".

2) WHEN A SIGN THAT IS SHOWN TO REMAIN CONFLICTS WITH THE CONTRACTOR'S CONSTRUCTION OPERATIONS, THE CONTRACTOR SHALL RELOCATE THE SIGN PANEL ASSEMBLY AND POST TO A TEMPORARY LOCATION APPROVED BY THE ENGINEER. THE SIGN PANEL ASSEMBLY AND POST SHALL BE RELOCATED TO THE PERMANENT LOCATION AS SOON AS CONSTRUCTION OPERATIONS PERMIT. THIS WORK SHALL BE INCLUDED IN THE COST OF THE VARIOUS TRAFFIC CONTROL AND PROTECTION ITEMS.

3) SIGNS DESIGNATED AS "REL" SHALL BE RELOCATED BY THE CONTRACTOR. THE ENGINEER SHALL DETERMINE IF THE EXISTING POST CAN BE RE-USED IN THE PERMANENT LOCATION. IF A REPLACEMENT POST IS REQUIRED, THE VILLAGE SHALL PROVIDE THE POSTS. THE CONTRACTOR SHALL BE RESPONSIBLE FOR CONTACTING THE VILLAGE AT LEAST 48 HOURS PRIOR TO THE TIME OF INSTALLATION TO COORDINATE PICK-UP OF THE POSTS FROM THE VILLAGE'S PUBLIC WORKS FACILITY.

LEGEND

	PROPOSED LIGHT POLE
	EXISTING SIGN
	PROPOSED SIGN
	PROPOSED SIGNAL POST
	NEW SIGN PANEL TO BE FURNISHED BY OTHERS (SEE NOTE)
	REL RELOCATE SIGN PANEL ASSEMBLY, TYPE A OR B
	REMAIN SIGN PANEL TO REMAIN IN SAME LOCATION
	REM REMOVE SIGN PANEL ASSEMBLY, TYPE A OR B

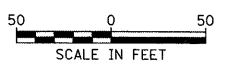

FILE NAME = ...oad\shets\2215_SIGNING_02.dgn

USER NAME = krk	DESIGNED - JAT	REVISED -
PLOT SCALE = 50.0000' / IN.	DRAWN - JAT/CDC	REVISED -
PLOT DATE = 10/29/2009	CHECKED - DJK	REVISED -
	DATE - 10-16-09	REVISED -

**STATE OF ILLINOIS
DEPARTMENT OF TRANSPORTATION**

**WRIGHT BOULEVARD
SIGNING PLAN**

SHEET NO. 2 OF 2 SHEETS STA. 126+00 TO STA. 146+00

F.A.U. R.T.E.	SECTION	COUNTY	TOTAL SHEETS	SHEET NO.
1351	06-0090-00-PV	COOK	137	68
CONTRACT NO. 63378				
FED. ROAD DIST. NO. 1 ILLINOIS FED. AID PROJECT ARA-M-8003 (809)				