

STAGE 2 NOTES

SEE SCHEDULE OF QUANTITIES FOR LOCATIONS OF TEMPORARY DITCH CHECKS.

EROSION CONTROL -
UNLESS NOTED OTHERWISE BELOW, MULCH, METHOD 2 SHALL BE USED WITH ALL SEEDING OPERATIONS.

- EROSION CONTROL BLANKET SHALL BE USED ON ALL SLOPES STEEPER THAN 3:1 AND ON THE BOTTOM OF ALL DITCHES.

SEEDING -
UNLESS NOTED OTHERWISE BELOW, SEEDING SHALL BE IN ACCORDANCE WITH GENERAL NOTE REGARDING SEEDING.

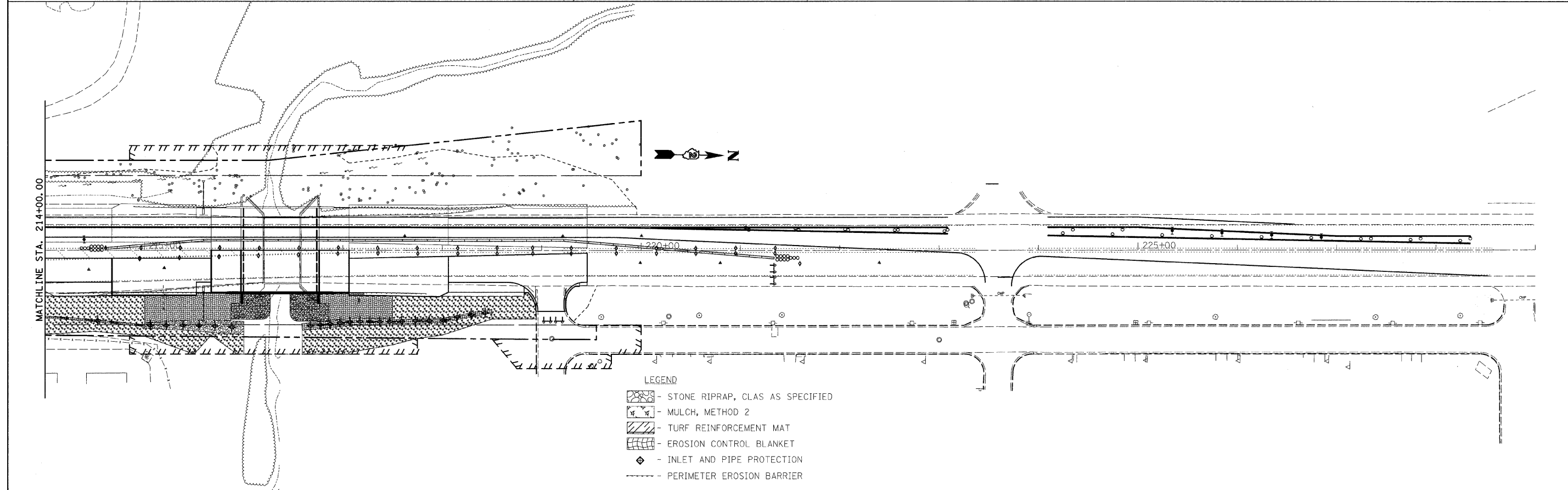
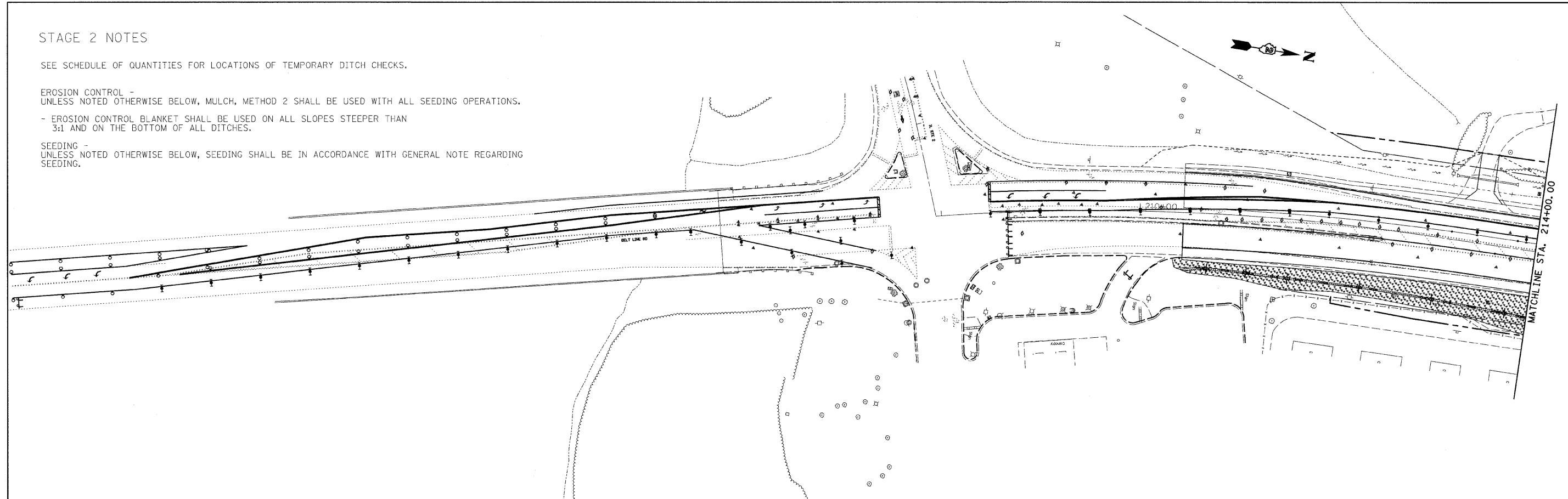

- LEGEND
- STONE RIPRAP, CLAS AS SPECIFIED
 - MULCH, METHOD 2
 - TURF REINFORCEMENT MAT
 - EROSION CONTROL BLANKET
 - INLET AND PIPE PROTECTION
 - PERIMETER EROSION BARRIER

FILE NAME = #FILE#	USER NAME = #USER#	DESIGNED -	REVISED -
		DRAWN -	REVISED -
	PLOT SCALE = #SCALE#	CHECKED -	REVISED -
	PLOT DATE = #DATE#	DATE -	REVISED -

**STATE OF ILLINOIS
DEPARTMENT OF TRANSPORTATION**

**EROSION CONTROL
STAGE 2**

SCALE: 1:50 SHEET NO. 1 OF 1 SHEETS STA. 206+50 TO STA. 229+00

F.A.P. RTE.	SECTION	COUNTY	TOTAL SHEETS	SHEET NO.
742	34BR-1	WINNEBAGO	78	34
CONTRACT NO. 64E68				
ILLINOIS FED. AID PROJECT				