

STAGE 3 NOTES

SEE SCHEDULE OF QUANTITIES FOR LOCATIONS OF TEMPORARY DITCH CHECKS.

EROSION CONTROL -  
UNLESS NOTED OTHERWISE BELOW, MULCH, METHOD 2 SHALL BE USED WITH ALL SEEDING OPERATIONS.

- EROSION CONTROL BLANKET SHALL BE USED ON ALL SLOPES STEEPER THAN 3:1 AND ON THE BOTTOM OF ALL DITCHES.

SEEDING -  
UNLESS NOTED OTHERWISE BELOW, SEEDING SHALL BE IN ACCORDANCE WITH GENERAL NOTE REGARDING SEEDING.

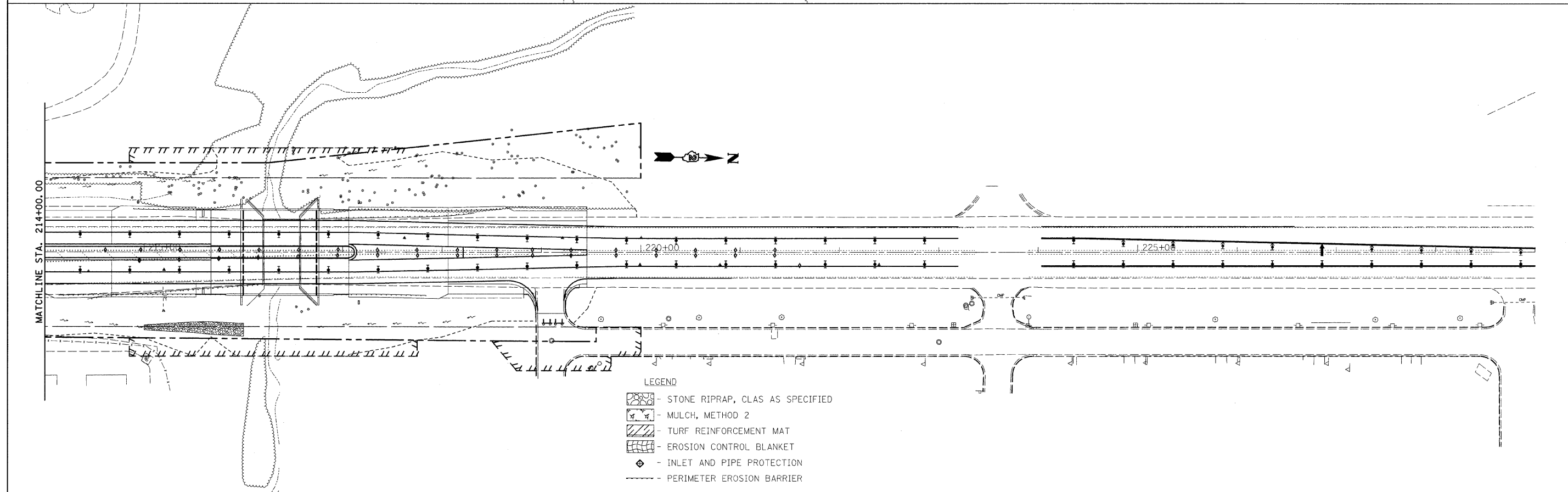
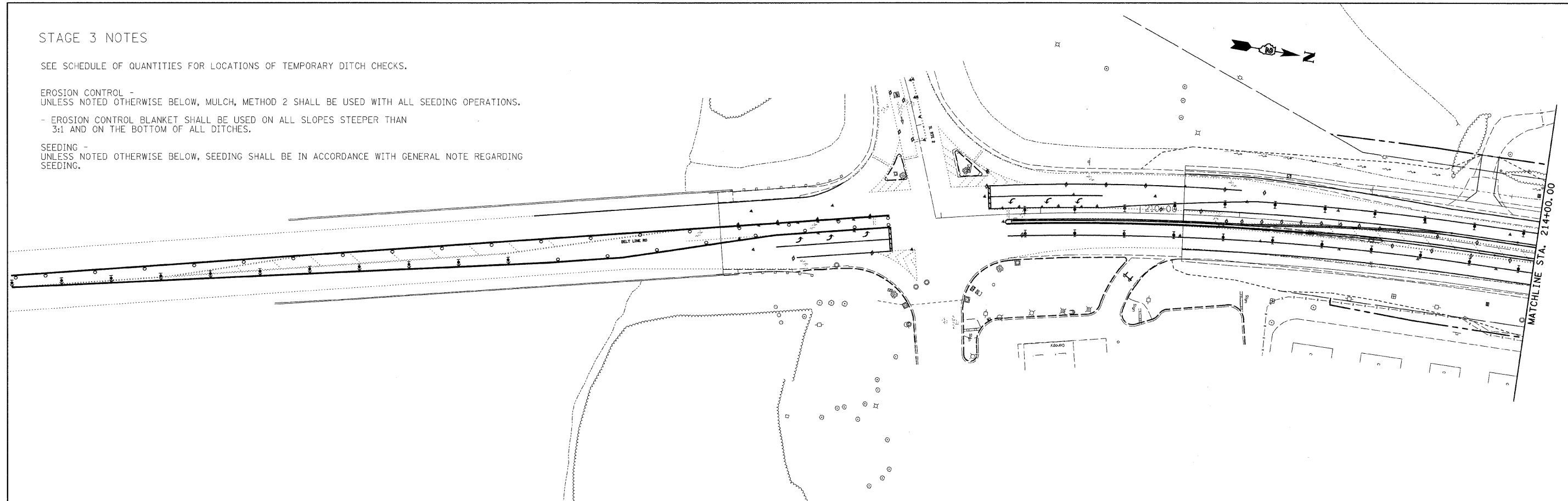

FILE NAME =	USER NAME = #USER#	DESIGNED -	REVISED -	<b>STATE OF ILLINOIS DEPARTMENT OF TRANSPORTATION</b>	<b>EROSION CONTROL STAGE 3</b>			F.A.P. RTE.	SECTION	COUNTY	TOTAL SHEETS	SHEET NO.
#FILE#		DRAWN -	REVISED -		SCALE: 1:50	SHEET NO. 1 OF 1 SHEETS	STA. 206+50 TO STA. 229+00	742	34BR-1	WINNEBAGO	78	35
	PLOT SCALE = #SCALE#	CHECKED -	REVISED -		CONTRACT NO. 64E68							
	PLOT DATE = #DATE#	DATE -	REVISED -		ILLINOIS FED. AID PROJECT							